



Repair Parts Sheet

RC306A
S.A. CENTER HOLE

54655 Rev. C 01/2021

Product Date Code Beginning With "A"

To Protect Your Warranty, Use Only SIMPLEX Hydraulic Oil.

Simplex recommends that all kit components be installed to ensure optimum performance of the repaired product.

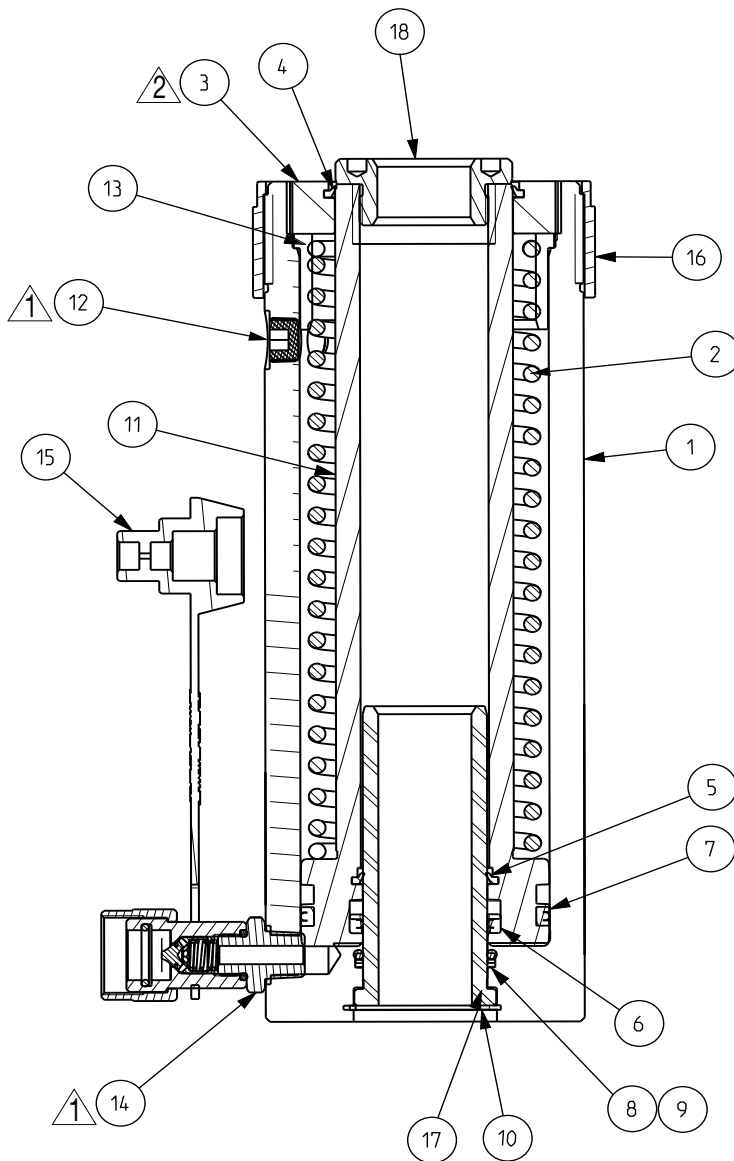

Notes:
▲ 1 Torque to 40 - 60 ft-lbs [55 - 81 Nm].
▲ 2 Secure per EES 115-16.

Figure 1

Repair Parts List for Figure 1			
Item No.	Description	Qty.	Part Number
1	Cylinder base	1	N/A
2	Spring	1	CR514110
3	Stop ring	1	DA3464044
4	Wiper ring	1	●
5	Wiper ring	1	●
6	G.T.Ring	1	●
7	G.T.Ring	1	●
8	O-Ring	1	●
9	Backup ring	1	●
10	Retaining ring	1	A1006049
11	Plunger	1	DA3472040
12	Plug flush	2	A1009245
13	Piston sleeve	1	6110387
14	Female coupler	1	DD6932900
15	Dust cap	1	CR215
16	Thread protector	1	CL402271
17	Tube weldment	1	DA3468900
18	Saddle	1	CF698045
19	Simplex logo (not shown)	1	●
20	Warning decal (not shown)	1	●
Notes:			
● Indicated item included in and available only as a part of the Repair Kit 54643			



N86 W12500 Westbrook Crossing
Menomonee Falls, WI 53051
Phone - USA Only: 1 (800) 323-9114
Phone - Inside/Outside USA: 1 (262) 293-1575
Fax: 1 (262) 597-1127
www.tksimplex.com