

Specifications

Units:

Imperial

Metric

Maximum Operating Pressure (psi)	10,000
Capacity Class (tonnage)	75
Maximum Cylinder Capacity Advance (tons)	79.5
Stroke (in)	6.13
Collapsed Height A (in)	11.25
Extended Height B (in)	17.38
Return Type	Single-Acting, Spring Return
Plunger Type	Solid
Material	Steel
Cylinder Effective Area Advance (in ²)	15.9
Oil Capacity Advance (in ³)	97.41
Surface Treatment	Paint
Coupler	CR400 Coupler
Weight (lbs)	65

Dimensions

Units:

Imperial

Metric

Collapsed Height A (in)	11.25
Optional Tilt Saddle Addition To Collapsed Height A1 (in)	0.59
Optional Tilt Saddle Diameter J1 (in)	2.81
Extended Height B (in)	17.38
Outside Diameter D (in)	5.75
Cylinder Bore Diameter E (in)	4.5
Plunger Diameter F (in)	3.75
Base to Advance Port H (in)	1.19
Saddle Diameter J1 (in)	2.8
Saddle Protrusion from Plunger K (in)	0.11
Plunger Internal Thread O (in)	'-
Plunger Thread Length P (in)	'-
Saddle Maximum Tilt Angle Radius (degrees)	5
Base Mounting Holes Bolt Circle U (in)	4.5
Base Mounting Holes Thread V	5/8"-11 UNC
Collar Thread Size W	5 3/4" - 12 un
Collar Thread W (in)	5 3/4" - 12 UN
Collar Thread Length X (in)	1.75
Base Mounting Holes Thread Depth Z (in)	0.63

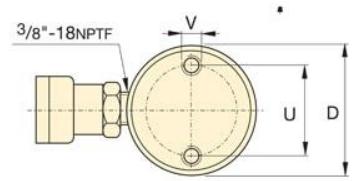
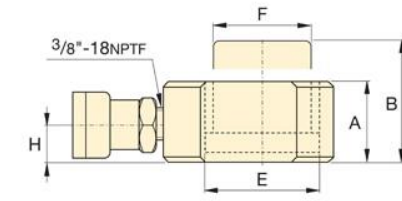
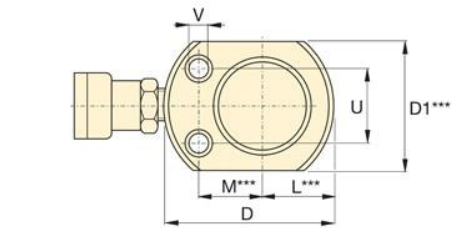
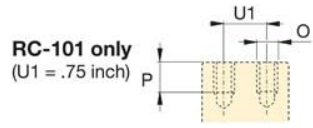
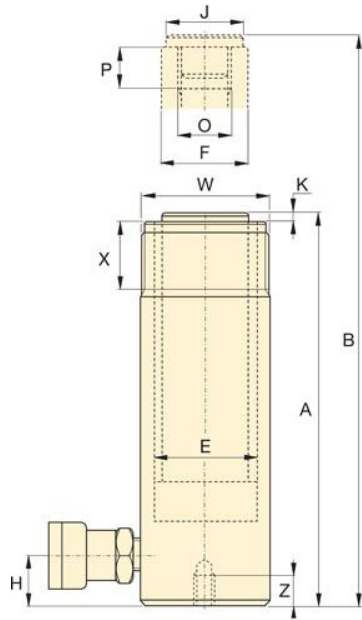

RC-51 to RC-5013 models

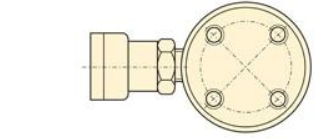

RC-1006 and RC-10010 models