

# Ultra High-Pressure Hand Pumps

## ▼ Optional Ultra-High Pressure Fittings and Tubing

| Description   | Connection   | Model No.                  |
|---|--|----------------------------|
| <b>40,000 psi</b>   |  |                            |
| Gland Nut Plug  | 0.38" cone   | 43-001                     |
| Elbow   | 0.38" cone   | 43-200                     |
| Tee   | 0.38" cone   | 43-300                     |
| Gauge Tee   | 0.38" cone side/<br>0.25" cone gauge port                                | 43-301                     |
| Gauge Adaptor   | 0.38" cone side/<br>0.25" cone gauge port                                | 83-011                     |
| Coupling  | 0.38" cone   | 43-400                     |
| Cross   | 0.38" cone   | 43-600                     |
| Gland Nut with Sleeve   | 0.38" cone   | 43-701                     |
| Gauge Connector   | 0.25" cone   | 43-704                     |
| Tubing  | 4" tube, O.D. 0.38" *<br>8" tube, O.D. 0.38" *<br>12" tube, O.D. 0.38" * | 45-116<br>45-126<br>45-136 |
|  <b>WARNING: Maximum working pressure: 10,000 psi only</b> |  |                            |
| Adaptor   | 0.38" F cone to 1/4" M NPTF  | 41-146                     |
|   | 0.38" F cone to 3/8" M NPTF  | 41-166                     |
| Adaptor   | 0.38" F cone to 1/4" F NPTF  | 41-246                     |
|   | 0.38" F cone to 3/8" F NPTF  | 41-266                     |
| Adaptor   | 0.38" M cone to 3/8" F NPTF  | 41-366                     |

Note: 0.25" cone fittings use 9/16"-18 threads, 3/8" cone fittings use 3/4"-16 threads.

\* Actual tubing lengths are 0.75" less than nominal size shown. These dimensions make distance between centers of valves and fittings multiples of 4" spaces.

## P/11 Series



Reservoir Capacity:

**45 - 60 in<sup>3</sup>**

Flow at Rated Pressure:

**0.037 - 0.152 in<sup>3</sup>/stroke**

Maximum Operating Pressure:

**10,000 - 40,000 psi**



**Ultra-High Pressure pumps DO NOT have an internal safety pressure relief valve.**



### Stainless Steel Construction

Ultra-high pressure fittings feature all stainless-steel construction except adaptor 41-366, which features nickel plated carbon steel construction.

11-100\*, 11-400

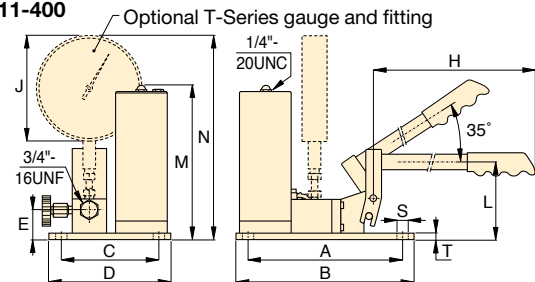

\*NOTE: Maximum operating pressure for model 11-100 is 10,000 psi.

P2282

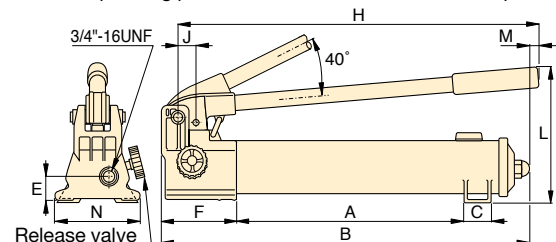

| Piston Stroke | Dimensions (in) |       |      |      |      |      |       |      |      |      |       |      |      |    | Weight (lbs) | Model Number |
|---------------|-----------------|-------|------|------|------|------|-------|------|------|------|-------|------|------|----|--------------|--------------|
|               | (in)            | A     | B    | C    | D    | E    | F     | H    | J    | L    | M     | N    | S    | T  |              |              |
| 1.00          | 13.56           | 22.00 | 1.40 | -    | 1.24 | 5.25 | 20.75 | 1.16 | 9.00 | 0.28 | 4.74  | -    | -    | 14 | P2282        |              |
| 0.78          | 9.45            | 10.50 | 5.98 | 7.00 | 1.77 | -    | 25.00 | 6.41 | 4.50 | 9.33 | 12.38 | 0.31 | 0.37 | 22 | 11-100       |              |
| 0.78          | 9.45            | 10.50 | 5.98 | 7.00 | 1.77 | -    | 25.00 | 6.41 | 4.50 | 9.33 | 12.38 | 0.31 | 0.37 | 22 | 11-400       |              |