

Specifications

Units: **Imperial** Metric

Maximum Operating Pressure (psi)	10,000
Capacity (imperial tons)	10
Maximum Vertical Daylight (in)	9.06
Maximum Bed Width (in)	5.31
Compatible Cylinders	RC101,RC102,RC104,RC106,RC108,RC1010,RC1012,RC1014
Weight (lbs)	62

Dimensions

Units: **Imperial** Metric

Dimension A (in)	16.31
Dimension B (in)	11.06
Dimension C (in)	9.06
Dimension D (in)	7.25
Dimension E (in)	5.94
Dimension F (in)	2 1/4 - 14 un
Dimension G (in)	2.5
Dimension H (in)	4.81
Dimension J (in)	0.75
Dimension K (in)	3.75
Dimension L (in)	6.88
Dimension M (in)	2.56
Dimension N (in)	2.13
Dimension O (in)	8.63

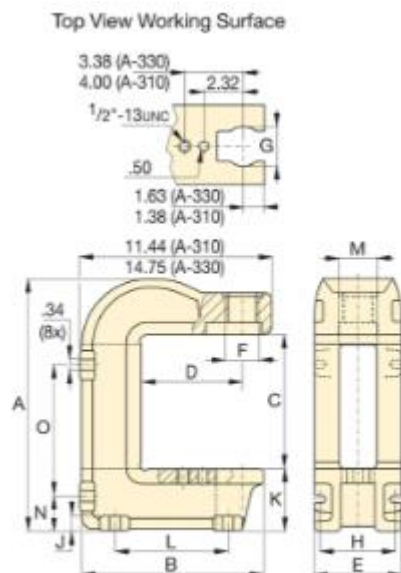

Arbor Press A-310, A-330