

## Specifications

Units: **Imperial** Metric

Maximum Operating Pressure (psi)	10,000
Capacity (imperial tons)	30
Maximum Vertical Daylight (in)	10
Maximum Bed Width (in)	7
Compatible Cylinders	RC308
Weight (lbs)	220

## Dimensions

Units: **Imperial** Metric

Dimension A (in)	22.18
Dimension B (in)	14.02
Dimension C (in)	10
Dimension D (in)	7.4
Dimension E (in)	7
Dimension F (in)	3 5/16 - 12 un
Dimension G (in)	2.5
Dimension H (in)	5.5
Dimension J (in)	1.1
Dimension K (in)	6.63
Dimension L (in)	8
Dimension M (in)	2.63
Dimension N (in)	3.88
Dimension O (in)	10.88

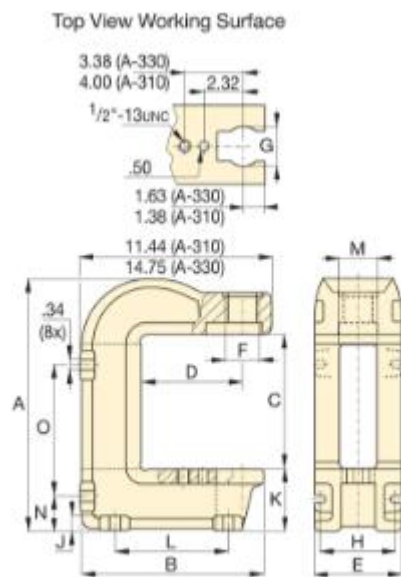

Arbor Press A-310, A-330