



WWW.TKSIMPLEX.COM

TECHNICAL REPAIR PART SHEET
G1 Series
G1 Series Torque Pump

PART SHEET NUMBER	REVISION NUMBER	DATE CODE RANGE	DOCUMENT DATE
TD054	B	N/A	04/13

This illustration is for reference purposes only. The appearance of your unit may differ from the unit shown.

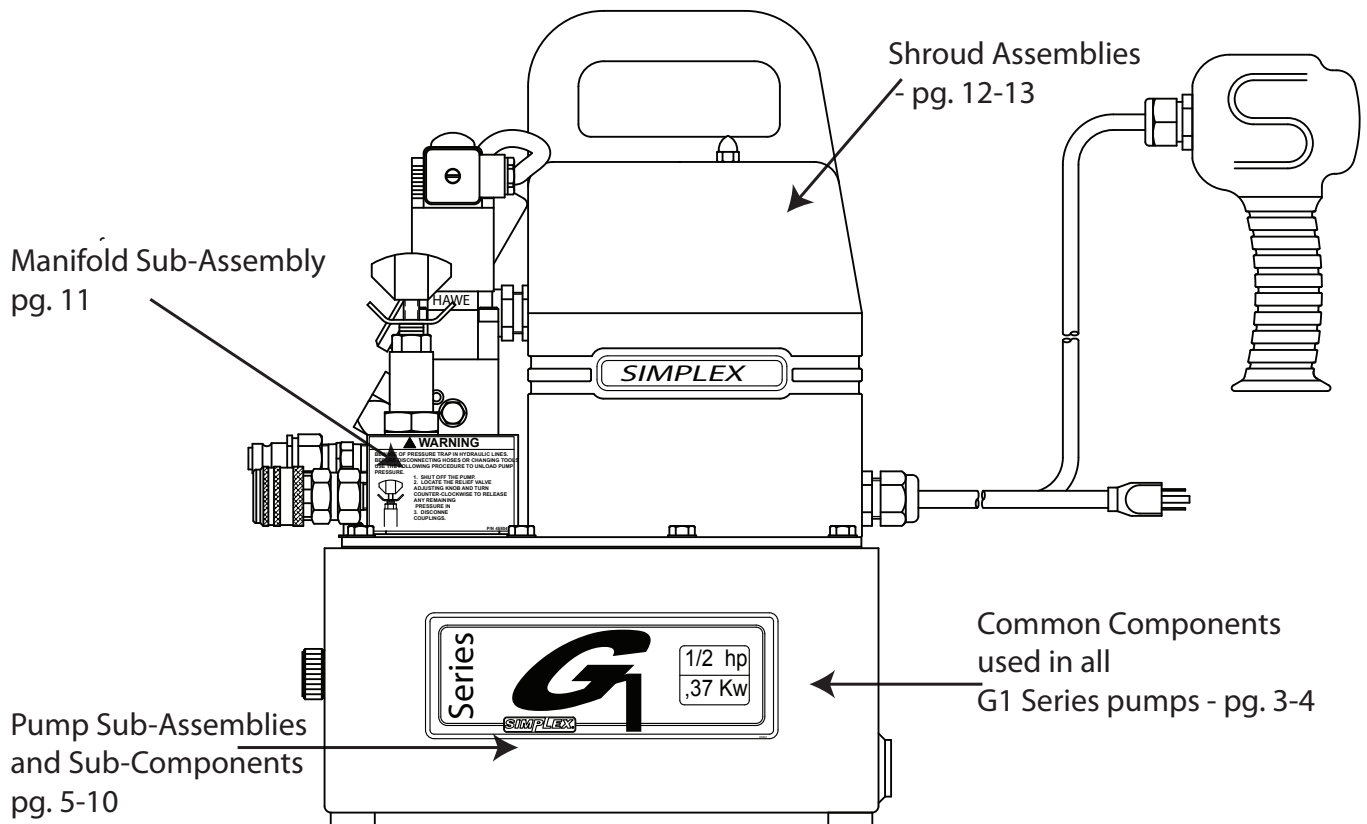

G1 Torque Wrench Power Pump

How to Identify Parts for Your Model

MODEL MATRIX - Understanding our model number configurations:

PUMP CLASS		PUMP TYPE			OPTION 1
G	1	1	7	1	T
MODEL	PERFORMANCE SERIES	POWER CONSUMPTION	VALVE FUNCTION	RESERVOIR SIZE	OPTIONS
G = GEN 11 PUMP	1 = 1/2 HP PUMP	1 = 115 VAC 2 = 230 VAC	7 = TORQUE WRENCH	1 = 1 GAL. METAL	T = TORQUE WRENCH

MODEL NUMBER & DATE CODE LOCATION

For example, the date code and serial number

J = **OCTOBER**

07 = **YEAR 2007**

42 = **WEEK NUMBER IN YEAR**

J0742

A	B	C	D	E	F	G	H	I	J	K	L
1	2	3	4	5	6	7	8	9	10	11	12

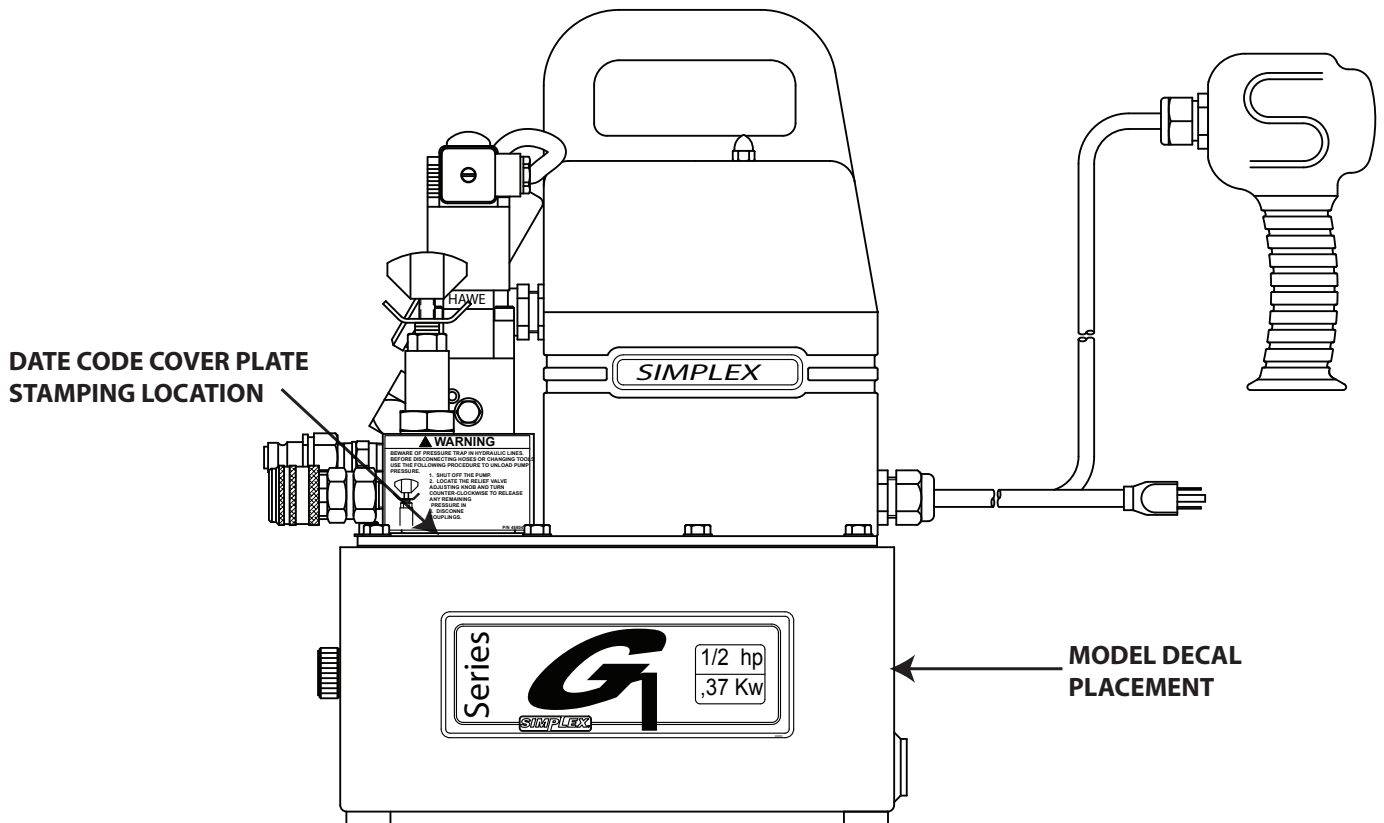

G1 Torque Wrench Power Pump

How to Identify Parts for Your Model

NOTE: This illustration is for reference only. The appearance of your unit may differ from the unit shown.

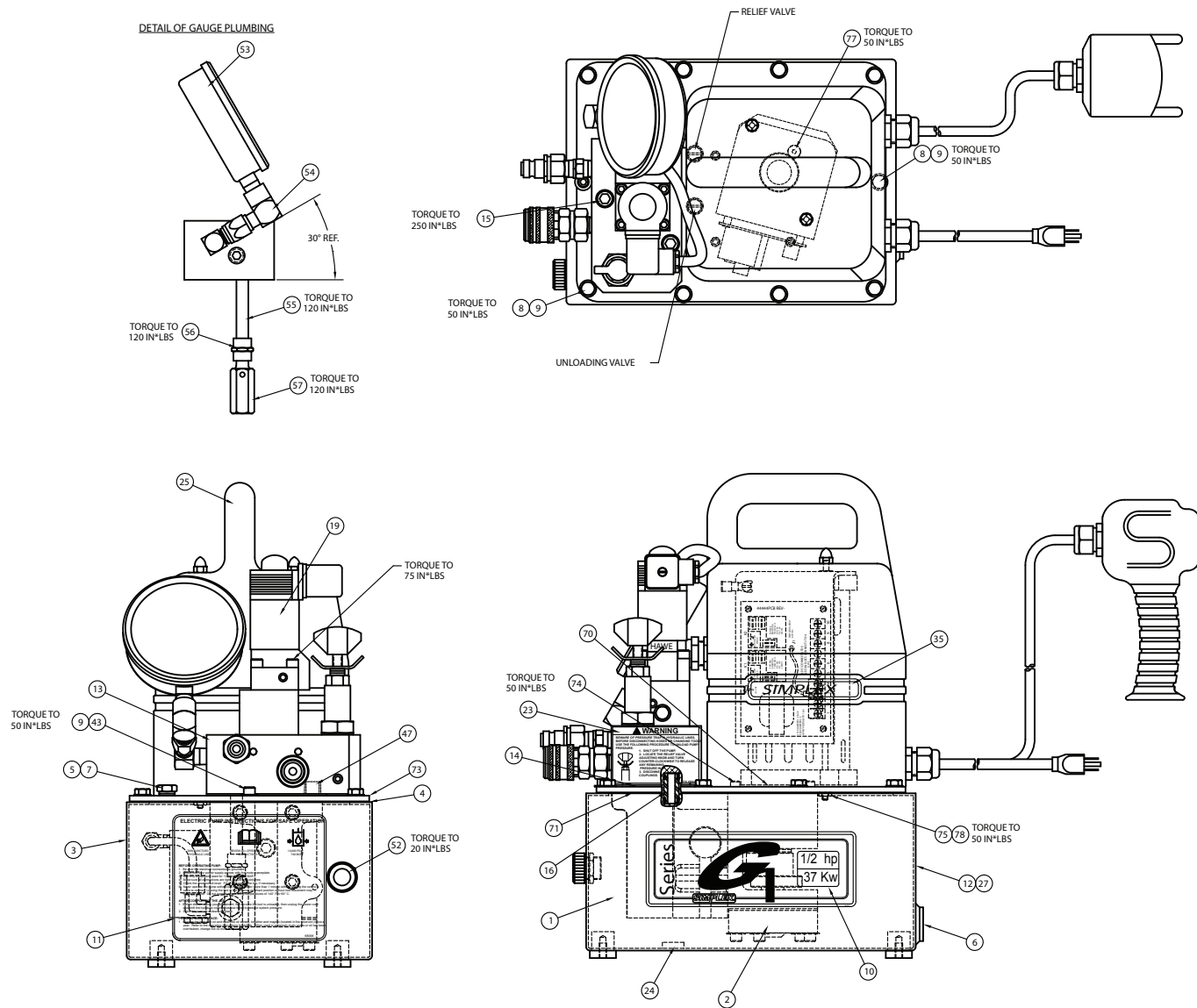

G1 Torque Wrench Power Pump

Common components used in pumps

ITEM #	DESCRIPTION	115 V.	230 V.	QTY.
002	PUMP ASSEMBLY G1	SEE PAGE 5		1.00
003	RESERVOIR 1 GALLON BLACK	46109P	46109P	1.00
004	RESERVOIR GASKET 1 GALLON	46476	46476	1.00
005	BREATHER VENT	69264	69264	1.00
006	PIPE PLUG 1/2" FLUSH W/ COATING	46697	46697	1.00
007	HEX PIPE PLUG 1/4" W/ COATING	46512	46512	1.00
008	HHCS 1/4-20 X .75 PLT	65891	65891	9.00
009	SEALING WASHER	65892	65892	10.00
010	RESERVOIR DECAL G1	46692	46692	2.00
011	LABEL SAFE USE ELEC	68068	68068	1.00
012	BLANK DECAL 3 X 4	87305	87305	1.00
013	VALVE TORQUE WRENCH MANIFOLD ASSEMBLY	SEE PAGE 11		1.00
014	VALVE GASKET	69242	69242	1.00
015	SHCS 3/8-16 X 2 1/4	93598	93598	3.00
016	ADAPTER ASSY.	68963SS	68963SS	1.00
019	DIRECTIONAL CONTROL VALVE	45424	45429	1.00
023	WARNING LABEL PRESSURE TRAP	45804	45804	1.00
024	MAGNET	66021	66021	1.00
25	SHROUD ASSEMBLY 115 / 230 V	SEE PAGE 12-13		1.00
027	DECAL OVERLAY	46539	46539	1.00
035	SIMPLEX LOGO	88186	88186	2.00
043	SHCS 1/4-20 X 3/4 LG	93582	93582	1.00
047	PIPE PLUG 1/4" FLUSH	82552	82552	1.00
052	SIGHT GAUGE	46009	46009	1.00
053	700 BAR PRS. GAGE	G7	G7	1.00
054	PIPE 1/4" FEMALE ELBOW JIC MALE	45639	45639	1.00
055	PIPE NIPPLE 1/8 NPT	68917	68917	1.00
056	PIPE COUPLING 1/8	68918	68918	1.00
057	INT.RELIEF ASM HF	68999SS	68999SS	1.00
070	MOTOR GASKET POW'R BUDDY	45532	45532	1.00
071	GASKET POW'R BUDDY PUMP	45902	45902	1.00
073	COVER PLATE POW'R BUDDY TORQUE WRENCH	46250	46250	1.00
074	SHCS #10-24 X 0.50 LG	85009	85009	3.00
075	HEX JAM NUT #10-32	89958	89958	2.00
077	FHCS 10-24 X 0.50LG	43557	43557	1.00
078	LOCKWASHER EXTERNAL TOOTH #10	Y0010765	Y0010765	2.00

G1 Torque Wrench Power Pump

Pump Assembly

(46693SS) PUMP ASM.

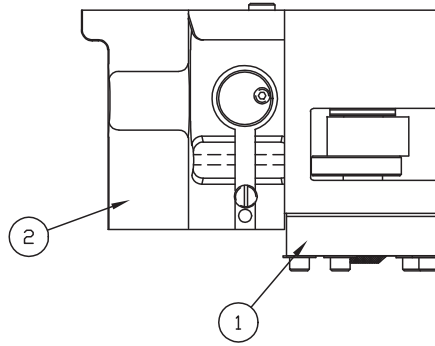
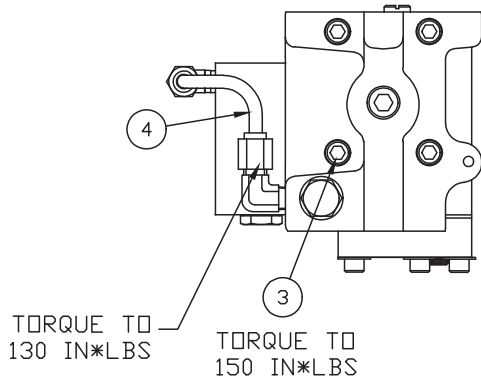

ITEM #	DESCRIPTION	PART #	QTY.
001	POW'R BUD PUMP ASM	SEE PAGE 6-7	1.00
002	POW'R BUD VLV BODY ASM.	SEE PAGE 9-10	1.00
003	SHCS 5/16-24 X 1" LG	84188	4.00
004	POW'R BUD TUBE	43542	1.00

G1 Torque Wrench Power Pump

Pump Sub Assembly

(43544SS) PUMP SUB ASM.

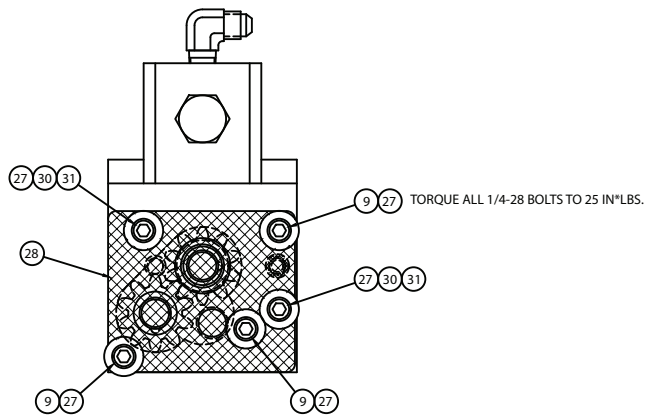
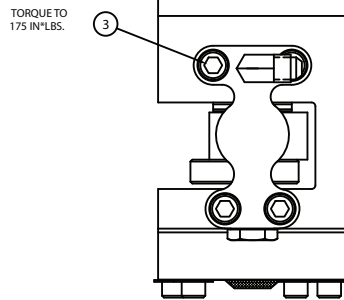
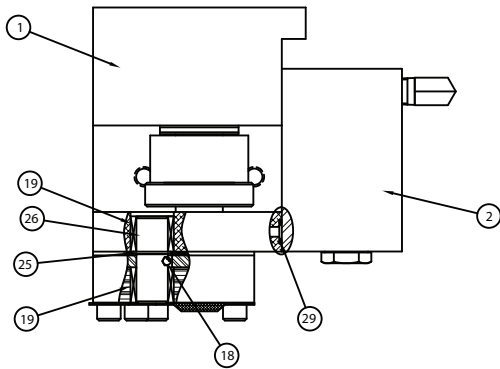
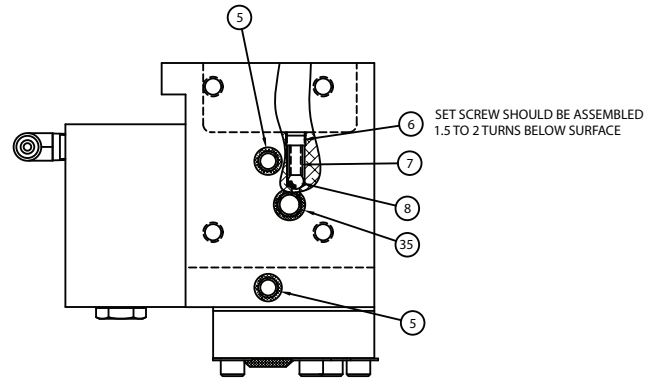
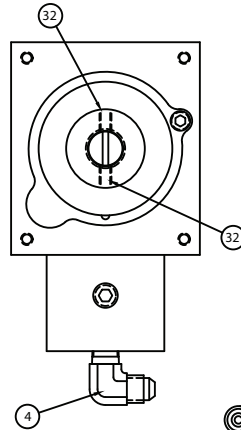
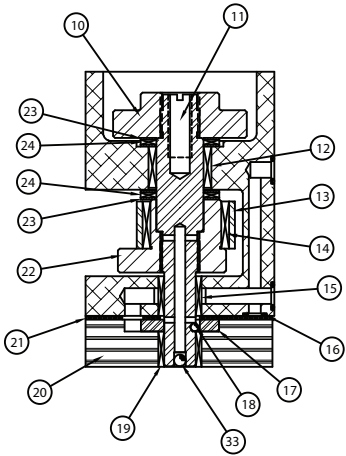

G1 Torque Wrench Power Pump

Pump Sub Assembly

(43544SS) PUMP SUB ASM.

ITEM #	DESCRIPTION	PART #	QTY.
001	POW'R BUD C PUMP MAC	43270	1.00
002	POW'R BUDDY PISTON BLOCK ASSEMBLY	SEE PAGE 8	1.00
003	SHCS 5/16-24 X 1.75	69392	4.00
004	MALE ELBOW 1/8 PIPE	69354	1.00
005	O-RING 5/16X7/16	5602011	2.00
006	SET SCREW 5/16-24 X 5/32 HOLLOW	43280	1.00
007	POW'R BUDDY RESTRICTOR SPRING	43281	1.00
008	BALL 1/4"	92549	1.00
009	SHCS 1/4-28 X 1.25LG	40118	3.00
010	REDUCING GEAR	43520	1.00
011	POW'R BUDDY PUMP SHAFT	43278	1.00
012	ROLL BRG 3/4ID X 5/8	43346	1.00
013	POW'R BUD ECC RING	43353	1.00
014	ROLL BRG 1 1/8 X 3/4	43347	1.00
015	BEARING ROLLER 1/2x11/16x1/2 WIDE	68891	1.00
016	O RING 1/4X3/8	5602010	1.00
017	GEAR-SET G1 PUMP	DS1245228	1.00
018	BALL 1/8"	90906	2.00
019	ROLL BEAR 1/2IDX1/2	43345	3.00
020	POW'R BUD BOTTOM PLATE	45536	1.00
021	POW'R BUDDY WEAR PLATE	43279	1.00
022	POW'R BUDDY ECCENCTRIC RING	43275	1.00
023	THRUST WASHER 3/4"ID	43349	4.00
024	THRUST BRG 3/4" ID	43348	2.00
025	POW'R BUDDY IDLER SHAFT	43276	1.00
026	RING-RETAINING	68892	1.00
027	WASHER 1/4" SS	88429	5.00
028	POW'R BUDDY SCREEN	43548	1.00
029	O-RING 3/16X5/16	5602008	1.00
030	TUBE-GUIDE .11	68894	2.00
031	SHCS 1/4-28 X 1 1/2	89148	2.00
032	SET SCREW #10-24 X 1/4 CUP	44596	2.00
033	BALL 3/16"	90548	1.00
035	O-RING 3/8X1/2	5602012	1.00

G1 Torque Wrench Power Pump

Sub Component Assemblies

(43687SS) UNLOADING PISTON ASM.

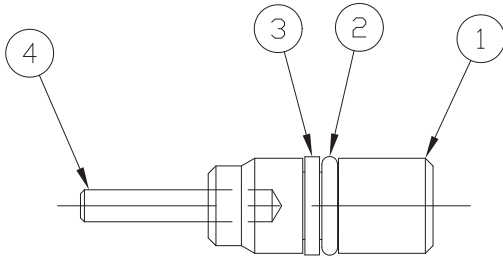

ITEM #	DESCRIPTION	PART #	QTY.
000	LOCTITE #RC/609	41828	0.01
001	UNLOAD PISTON	68209	1.00
002	O RING 1/4X3/8	5602010	1.00
003	BACKUP WASHER	68145	1.00
004	DOWEL PIN 1/8 DIA X 3/4	43686	1.00

(43547SS) PISTON BLOCK ASM.

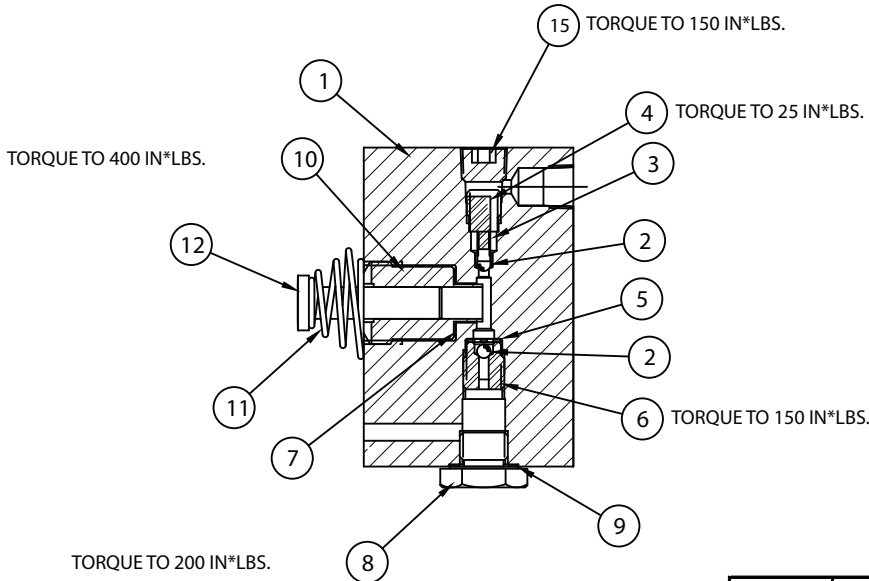

ITEM #	DESCRIPTION	PART #	QTY.
001	POW'R BUDDY PISTON BLOCK	43273	1.00
002	BALL 1/8"	90906	2.00
003	SPRING	66042	1.00
004	BALL STOP	68810	1.00
005	BALL RETAINER	66043	1.00
006	INTAKE SEAT	66046	1.00
007	GASKET 29/64 X 5/8	86269	1.00
008	PLUG PISTON BLOCK	68825	1.00
009	GASKET 25/64X19/32	85726	1.00
010	ADAPTER-.290 PISTON	68820	1.00
011	SPRING, PISTON	68340	1.00
012	PISTON-.290 DIA	68819	1.00
015	PIPE PLUG 1/8" FLUSH W/ COATING	46508	1.00

G1 Torque Wrench Power Pump

Pump Sub Assembly

(43570SS) VALVE BODY ASM.

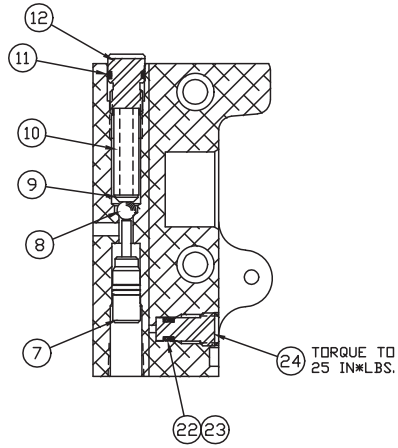

SECTION B-B

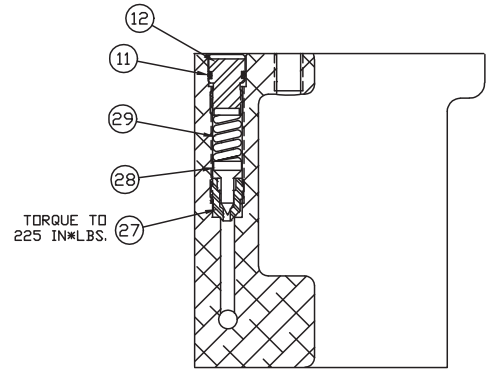
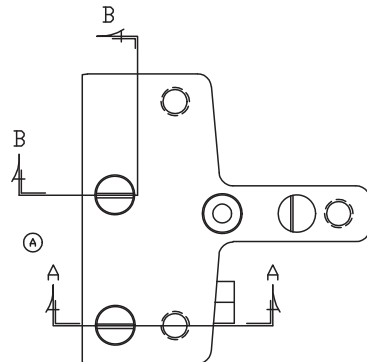

SECTION A-A

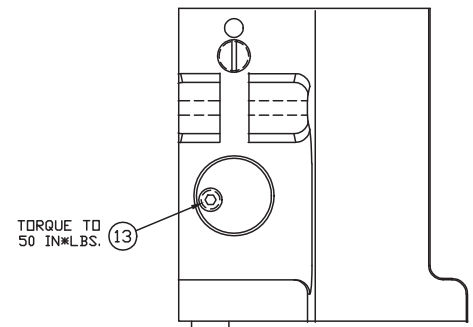
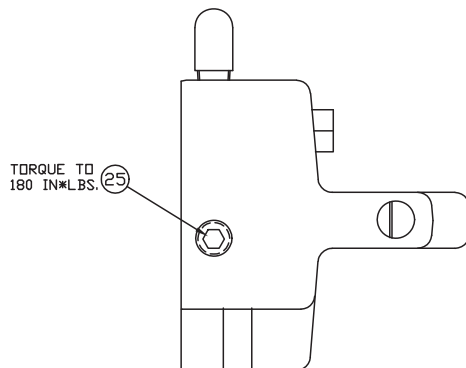
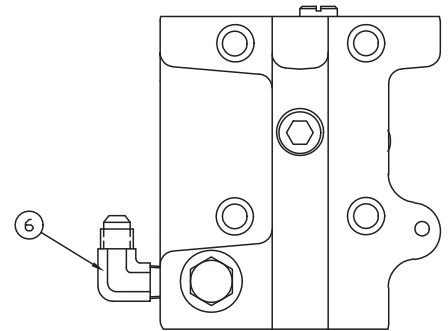
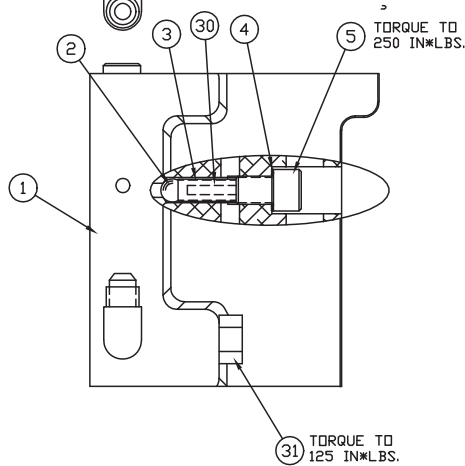
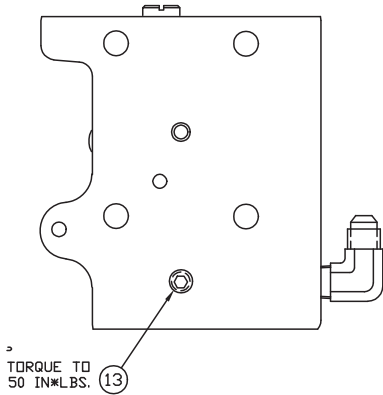

G1 Torque Wrench Power Pump

Pump Sub Assembly

(43570SS) VALVE BODY ASM.

ITEM #	DESCRIPTION	PART #	QTY.
001	PB VALVE BODY SECT.	43269	1.00
002	BALL 5/16"	91701	1.00
003	POW'R BUDDY JUNCTION SPRING	43282	1.00
004	GASKET 25/64X19/32	85726	1.00
005	SCREW, BALL STOP	68226	1.00
006	MALE ELBOW 1/8 PIPE	69354	1.00
007	UNLOADING PISTON ASM	SEE PAGE 8	1.00
008	BALL 1/4"	92549	1.00
009	POW'R BUDDY SPRING CAP	43277	1.00
010	SPRING UNLOADING VLV	68981	1.00
011	O-RING 3/8X1/2	5602012	2.00
012	POW'R BUDDY ADJUSTING SCREW	43274	2.00
013	1/16 SOC PIPE PLUG	97641	2.00
022	O-RING 3/16X5/16	5602008	1.00
023	BACKUP WASHER	56080087	1.00
024	POW'R BUD DUMP PLUG	43283	1.00
025	1/4 SOC PIPE PLUG	93950	1.00
027	SEAT - EXT RELIEF	68004	1.00
028	CONE - EXT RELIEF	68003	1.00
029	SPRING - RELIEF VALVE	66085	1.00
030	ROLL PIN 1/8 X 15/16	81332	1.00
031	PLUG SAE #4	68258	1.00

G1 Torque Wrench Power Pump

Common components used in pumps

(45421SS) MANIFOLD ASM.

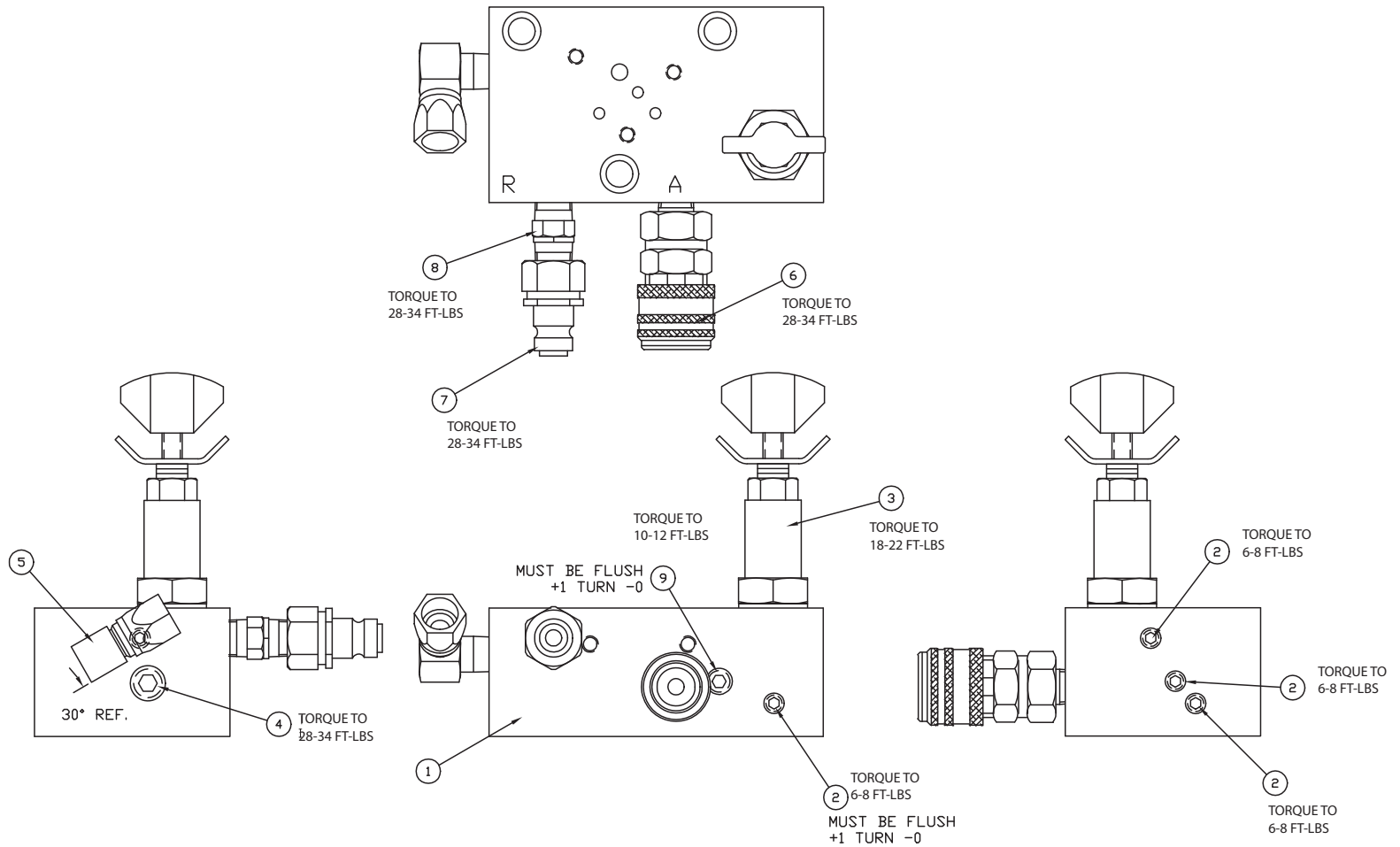

ITEM #	DESCRIPTION	PART #	QTY.
001	TORQUE WRENCH MANIFOLD	45422	1.00
002	PIPE PLUG FLUSH 1/16 W/ COATING	40049	5.00
003	CARTRIDGE RELIEF VALVE	45423	1.00
004	PIPE PLUG 1/4" FLUSH	82552	1.00
005	PIPE 1/4" MALE ELBOW JIC FEMALE SWIVEL	45638	1.00
006	1/4" SELF-LOCKING COUPLER	45765	1.00
007	1/4" NIPPLE	CT210	1.00
008	1/4 IN NIPPLE	4100067	1.00
009	PIPE PLUG 1/8" FLUSH W/ COATING	46508	1.00

G1 Torque Wrench Power Pump

DS1227900SS (115V. ASSEMBLY)

Shroud Assembly

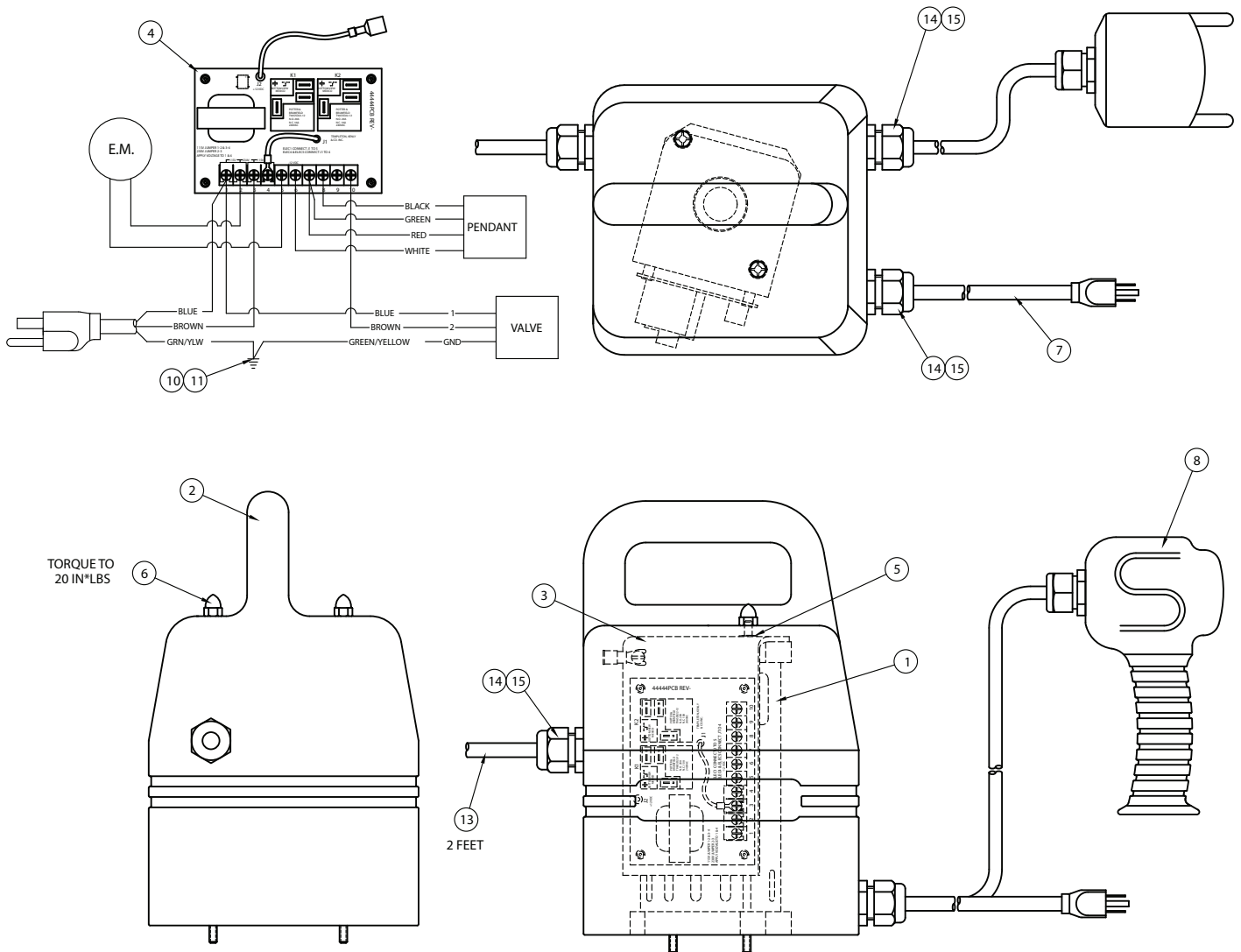

ITEM #	DESCRIPTION	PART #	QTY
1	POWER BUD MOTOR 115V	43516	1
2	POWER BUDDY SHROUD	44790	1
3	POWER BUD BRACKET	43546	1
4	CIRCUIT BOARD ASM 12 VDC	44444	1
5	PUSH NUT BOLT RET#10	44911	2
6	ACORN NUT 10-32 PLTD	43558	2
7	PLUG AND CORD 16-3 IEC	43562	1
8	PENDANT	69365SS	1
10	SPADE, TERMINAL	65887	1
11	SCREW, FILL HD MACH	98250	1
13	POWER CORD IEC	43561	2ft.
14	FITTING CORD L-TIGHT	68375	3
15	LOCK NUT 1/2 INCH	85510	3

G1 Torque Wrench Power Pump

DS1228900SS (230V. ASSEMBLY)

Shroud Assembly

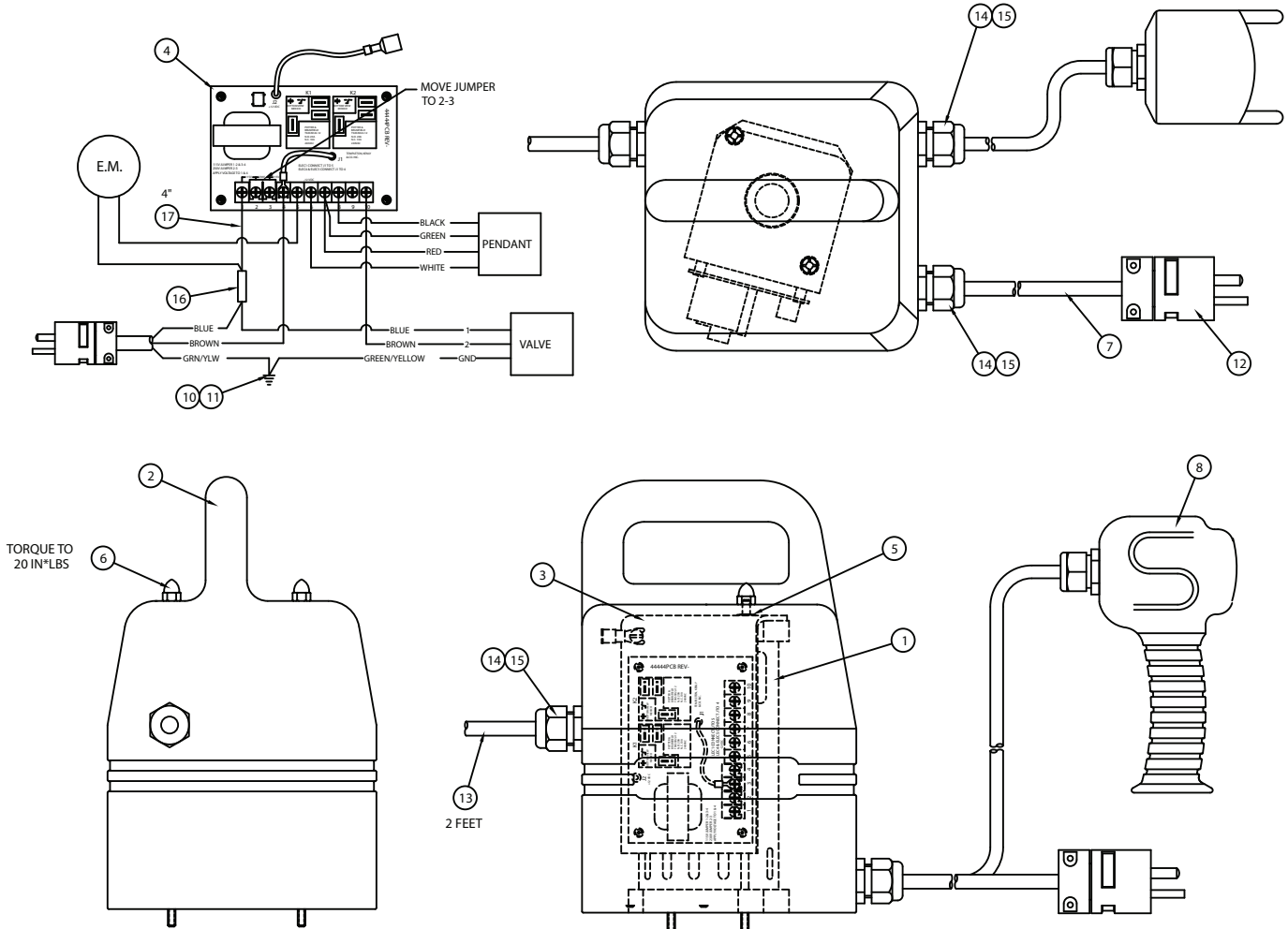

ITEM #	DESCRIPTION	PART #	QTY
1	POWER BUDDY MOTOR 115V	44542	1
2	POWER BUDDY SHROUD	44790	1
3	POWER BUDDY BRACKET	43546	1
4	CIRCUIT BOARD ASM 12 VDC	44444	1
5	PUSH NUT BOLT RET#10	44911	2
6	ACORN NUT 10-32 PLTD	43558	2
7	CORD AWG16	68468R	7ft.
8	PENDANT	69365SS	1
10	SPADE, TERMINAL	65887	1
11	SCREW, FILL HD MACH	98250	1
12	PLUG 20 AMP 250V	87903	1
13	POWER CORD IEC	43561	2ft.
14	FITTING CORD L-TIGHT	68375	3
15	LOCK NUT 1/2 INCH	85510	3
16	BUTT CONNECTOR	85510	1