

Specifications

Units:

Imperial

Metric

Capacity Class (tonnage)	100
Maximum Cylinder Capacity Advance (tons)	113
Collapsed Height A (in)	14.92
Extended Height B (in)	22.8
Return Type	Double-Acting, Hydraulic Return
Plunger Type	Solid
Material	Steel
Cylinder Effective Area Advance (in ²)	22.19
Oil Capacity Advance (in ³)	174.7
Oil Capacity Retract (in ³)	88.19
Sideload Resistance of Maximum Capacity (percentage)	10%
Surface Treatment	Nitride
Coupler	CR400 Coupler

Dimensions

Units:

Imperial

Metric

Collapsed Height A (in)	14.92
Collapsed Height With Optional Tilt Saddle A1 (in)	15.31
Optional Tilt Saddle Addition To Collapsed Height A1 (in)	0.39
Optional Tilt Saddle Diameter J1 (in)	2.8
Extended Height B (in)	22.8
Outside Diameter D (in)	6.89
Cylinder Bore Diameter E (in)	5.31
Plunger Diameter F (in)	3.74
Base to Advance Port H (in)	1.5
Top to Retract Port (in)	3.15
Saddle Diameter J1 (in)	2.95
Saddle Protrusion from Plunger K (in)	0.12
Saddle Maximum Tilt Angle Radius (degrees)	5
Base Mounting Holes Thread V	M12 x 1,75
Collar Thread Size W	M175 x 3
Collar Thread Length X (in)	1.81

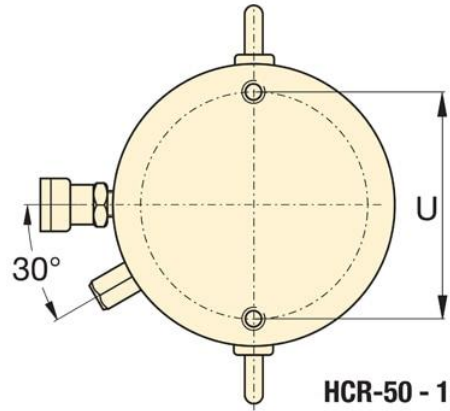
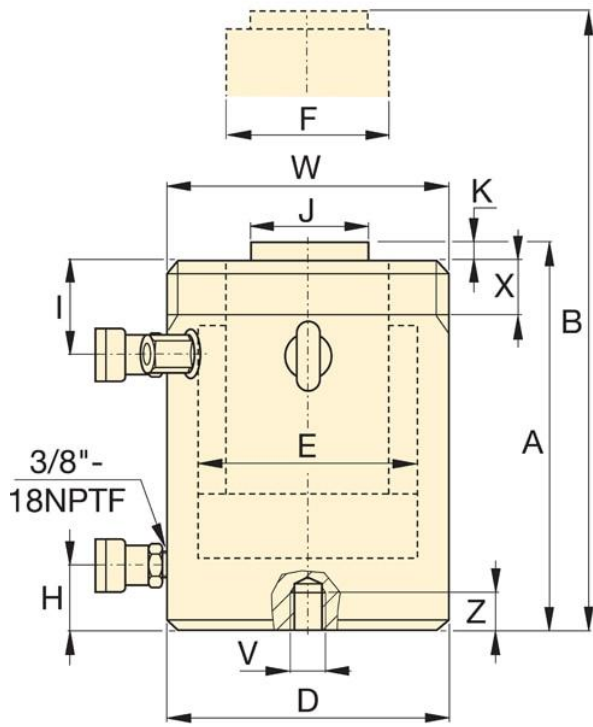

HCR-50 - 150 ton

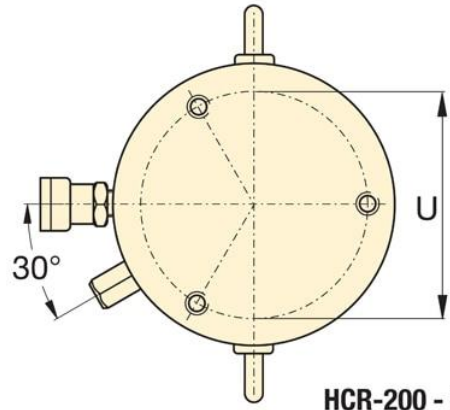

HCR-200 - 300 ton