

## Specifications

Units:

**Imperial**

Metric

Capacity Class (tonnage)	150
Maximum Cylinder Capacity Advance (tons)	168
Collapsed Height A (in)	10.63
Extended Height B (in)	14.57
Return Type	Double-Acting, Hydraulic Return
Plunger Type	Solid
Material	Steel
Cylinder Effective Area Advance (in <sup>2</sup> )	33.14
Oil Capacity Advance (in <sup>3</sup> )	130.48
Oil Capacity Retract (in <sup>3</sup> )	61.47
Sideload Resistance of Maximum Capacity (percentage)	10%
Surface Treatment	Nitride
Coupler	CR400 Coupler

## Dimensions

Units:

**Imperial**

Metric

Collapsed Height A (in)	10.63
Collapsed Height With Optional Tilt Saddle A1 (in)	11.38
Optional Tilt Saddle Addition To Collapsed Height A1 (in)	0.75
Optional Tilt Saddle Diameter J1 (in)	3.82
Extended Height B (in)	14.57
Outside Diameter D (in)	8.46
Cylinder Bore Diameter E (in)	6.5
Plunger Diameter F (in)	4.72
Base to Advance Port H (in)	1.61
Top to Retract Port (in)	2.76
Saddle Diameter J1 (in)	3.7
Saddle Protrusion from Plunger K (in)	0.12
Saddle Maximum Tilt Angle Radius (degrees)	5
Base Mounting Holes Thread V	M12 x 1,75
Collar Thread Size W	M215 x 3
Collar Thread Length X (in)	2.17

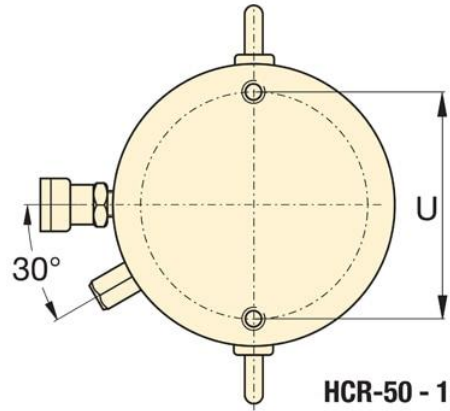
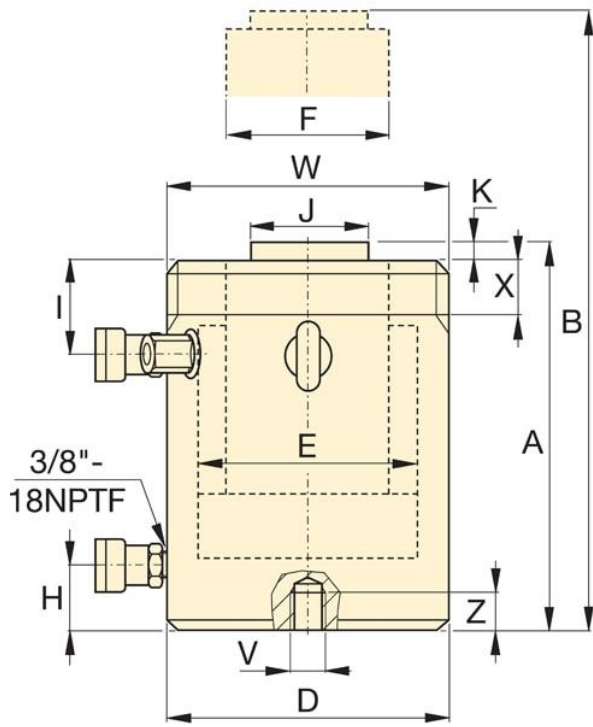

**HCR-50 - 150 ton**

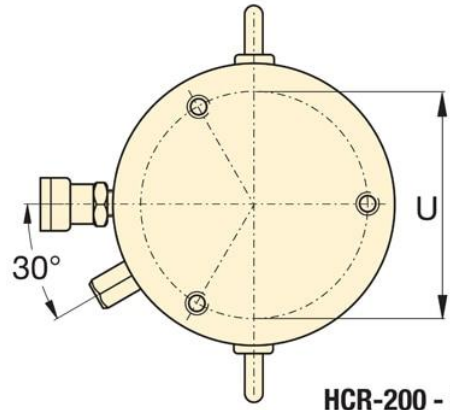

**HCR-200 - 300 ton**