

LCAS models Standard Arm

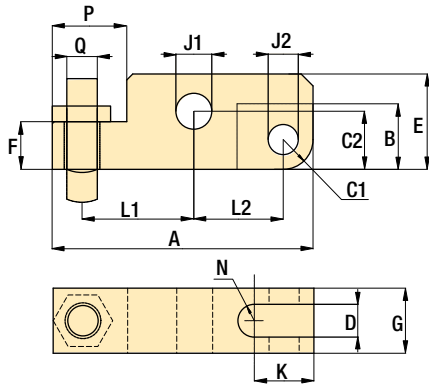

Dimensions in inches []

Clamp capacity lbs	Model number	A	B	C1	C2	D	E	F	G
▼ Standard clamp arms									
700	LCAS-32	2.13	0.51	0.24	0.37	0.24	0.63	0.31	0.47
1800	LCAS-82	2.93	0.69	0.31	0.61	0.39	0.98	0.51	0.74
2700	LCAS-122	3.44	0.87	0.39	0.77	0.43	1.26	0.63	0.86
4300	LCAS-192	4.04	1.02	0.43	0.94	0.51	1.50	0.87	0.98
6300	LCAS-282	4.92	1.20	0.51	1.14	0.63	1.77	1.06	1.25

Clamp capacity lbs	Model number	J1	J2	K	L1	L2	N	P	Q
		mm							
▼ Standard clamp arms									
700	LCAS-32	0.237-0.239	0.237-0.239	0.51	0.93	0.73	0.12	0.51	M6 x 1,0
1800	LCAS-82	0.396-0.398	0.317-0.319	0.63	1.26	0.96	0.20	0.87	M10 x 1,5
2700	LCAS-122	0.474-0.476	0.396-0.398	0.79	1.48	1.18	0.22	0.98	M12 x 1,75
4300	LCAS-192	0.593-0.595	0.474-0.476	0.94	1.63	1.42	0.26	1.22	M16 x 2,0
6300	LCAS-282	0.711-0.713	0.593-0.595	1.10	2.01	1.73	0.31	1.50	M20 x 2,5

LCAL models Long Arm

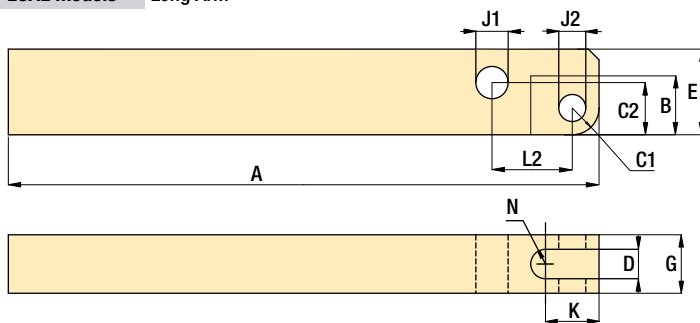

NOTE: Custom arms should be manufactured using this print. Make sure to follow all precautions listed.

Dimensions in inches []

Clamp capacity lbs	Model number	A	B	C1	C2	D	E	G	J1	J2	K	L2	N
▼ Long clamp arms													
800	LCAL-32	3.35	0.51	0.24	0.37	0.24	0.63	0.47	0.237-0.239	0.237-0.239	0.51	0.73	0.12
1800	LCAL-82	4.13	0.69	0.31	0.61	0.39	0.98	0.74	0.396-0.398	0.317-0.319	0.63	0.96	0.20
2700	LCAL-122	4.33	0.87	0.39	0.77	0.43	1.26	0.86	0.474-0.476	0.396-0.398	0.79	1.18	0.22
4300	LCAL-192	6.30	1.02	0.43	0.94	0.51	1.50	0.98	0.593-0.595	0.474-0.476	0.94	1.42	0.26
6300	LCAL-282	8.66	1.20	0.51	1.14	0.63	1.77	1.25	0.711-0.713	0.593-0.595	1.10	1.73	0.31

Force: 700-6300 lbs

Pressure: 500-5000 psi

- E** Brazos de amarre
- F** Bras de bridage
- D** Spannarme

Options

Work supports

43

Accessories

86

Important

Clamp arm should be parallel to cylinder mounting surface within 3° to avoid damage to cylinder and linkage. Use the included set screw to adjust clamp arm alignment.

