

Maximum Operating Pressure (psi)	10,150
Capacity Class (tonnage)	300
Maximum Cylinder Capacity Advance (short tons)	341
Stroke (in)	11.81
Collapsed Height A (in)	21.5
Extended Height B (in)	33.31
Return Type	Double-Acting, Hydraulic Return
Plunger Type	Solid
Material	Steel
Cylinder Effective Area Advance (in <sup>2</sup> )	67.23
Oil Capacity Advance (in <sup>3</sup> )	794.05
Oil Capacity Retract (in <sup>3</sup> )	218.91
Sideload Resistance of Maximum Capacity (percentage)	10%
Surface Treatment	Nitride
Coupler	CR400 Coupler
Weight (lbs)	620

Collapsed Height A (in)	21.5
Collapsed Height With Optional Tilt Saddle A1 (in)	23.03
Optional Tilt Saddle Addition To Collapsed Height A1 (in)	1.54
Optional Tilt Saddle Diameter J1 (in)	6.89
Extended Height B (in)	33.31
Outside Diameter D (in)	12.01
Cylinder Bore Diameter E (in)	9.25
Plunger Diameter F (in)	7.87
Base to Advance Port H (in)	2.28
Top to Retract Port (in)	3.98
Saddle Diameter J1 (in)	5.51
Saddle Protrusion from Plunger K (in)	0.16
Saddle Maximum Tilt Angle Radius (degrees)	5
Base Mounting Holes Thread V	M16 x 2

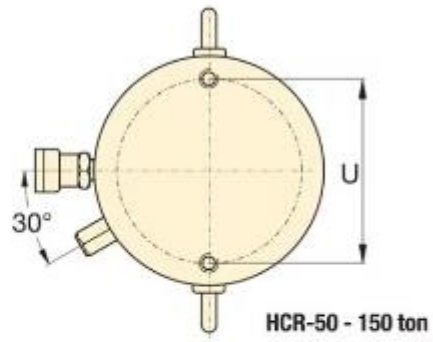

HCR-50 - 150 ton

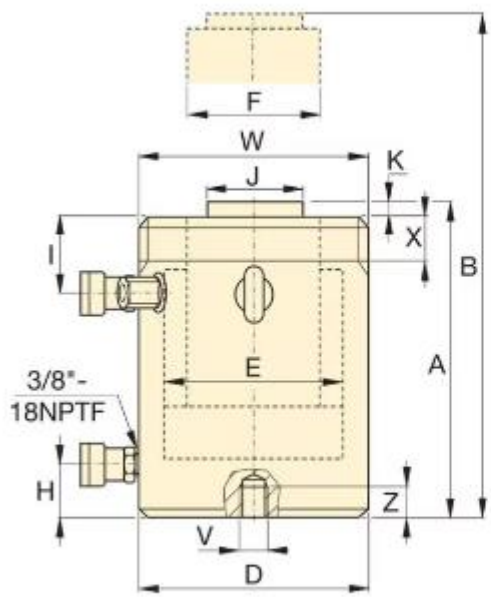
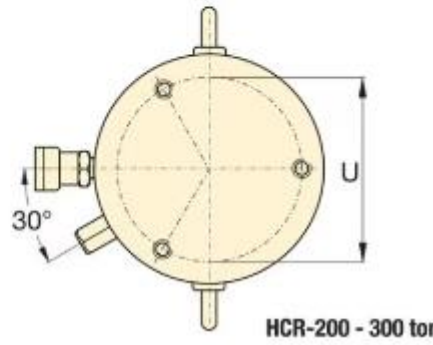

HCR-200 - 300 ton