

# MECHANICAL JACKS

PJ Series Planer Jacks



PJ1P, PJ2P, PJ3P & PJ4P Shown

- Sustaining Capacity .....▶ 2 - 8 tons
- Weight .....▶ 1.5 - 12 lbs.
- Operable Rise .....▶ 1 - 4 in.

- ▶ Side locking screw keeps the jack extended and prevents lowering due to vibration.
- ▶ Screw operation provides countless adjustments for exact leveling.
- ▶ Ideal jack for leveling plane beds, millers and machinery.
- ▶ Ball and socket cap swivels to center load forces.
- ▶ Notched base fastens easily to machine beds.

Mechanical Jacks



### THINK SAFETY

Please refer to pages 4&5 for a complete list of safety tips and recommendations.



### LOAD CAP

Slotted load cap prevents the load from possible slippage with inline applications.



### CE COMPLIANT

Our Jack design specifications meet or exceed ANSI /ASME B30.1 Safety Standards.

The notched base and swivel socket cap makes the versatile Planer Jack the perfect choice for repair & maintenance. ▼

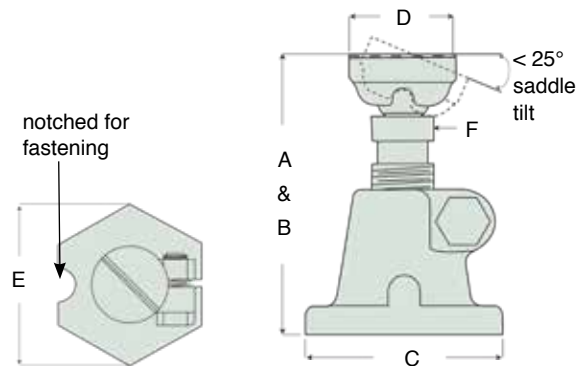

Model	Sustaining Capacity (tons)	Operable Rise (in)	Dimensions (in)						Weight (lbs)
			A	B	C	D	E	F	
			Minimum Height	Maximum Height	Across Flats	Cap Diameter	Across Points	Hex Across Flats	
PJ1P	2	1	2.75	3.75	2.38	1.25	2.75	.75	1.5
PJ2P	4	1.5	3.75	5.25	3.13	1.68	3.62	1	3
PJ3P	6	2.25	5.25	7.5	4	2.06	4.62	1.25	6
PJ4P	8	4	7.5	11.5	5.38	2.5	6.19	1.5	12