

## Specifications

Units: **Imperial** Metric

Maximum Operating Pressure (psi)	10,000
Capacity Class (tonnage)	15
Capacity (imperial tons)	15
Stroke (in)	14.38
Collapsed Height A (in)	18.69
Extended Height B (in)	33.07
Return Type	Single-Acting, Spring Return
Plunger Type	Solid
Material	Steel
Cylinder Effective Area (in <sup>2</sup> )	3.14
Oil Capacity Required (in <sup>3</sup> )	44
Ram Bore Diameter (in)	2.00
Pressure at Capacity (psi)	9554
Bolt Circle (in)	1.88
Thread (in)	.38 - 16 UNC
Thread Depth (in)	0.50
Weight (lbs)	26.0

## Dimensions

Units: **Imperial** Metric

Collapsed Height A (in)	18.69
Extended Height B (in)	33.07
Body Outside Diameter C (in)	2.75
Piston Outside Diameter D (in)	1.63
Base to Port Center Line E (in)	1.00
Piston Internal Diameter Threads F (in)	1 - 8
Piston Thread Depth F (in)	1.00
Collar Threads G (in)	2.75 - 16
Collar Threads Length G (in)	1.19

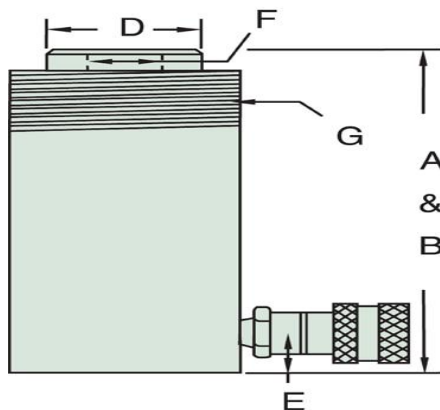

\* R50 Base Mounting hole 7/32 through x 23/64 "C" bore (1/4" depth).

