

Specifications

Units:

Imperial

Metric

Maximum Operating Pressure (psi)	10,000
Capacity Class (tonnage)	55
Capacity (imperial tons)	55
Stroke (in)	2.00
Collapsed Height A (in)	6.94
Extended Height B (in)	8.94
Return Type	Single-Acting, Spring Return
Plunger Type	Solid
Material	Steel
Cylinder Effective Area (in ²)	11.04
Oil Capacity Required (in ³)	22.08
Ram Bore Diameter (in)	3.75
Pressure at Capacity (psi)	9960
Bolt Circle (in)	3.75
Thread (in)	.5 - 13 UNC
Thread Depth (in)	0.75
Weight (lbs)	33.0

Dimensions

Units: **Imperial** Metric

Collapsed Height A (in)	6.94
Extended Height B (in)	8.94
Body Outside Diameter C (in)	5.00
Piston Outside Diameter D (in)	3.13
Base to Port Center Line E (in)	1.38
Collar Threads G (in)	5 - 12
Collar Threads Length G (in)	2.81

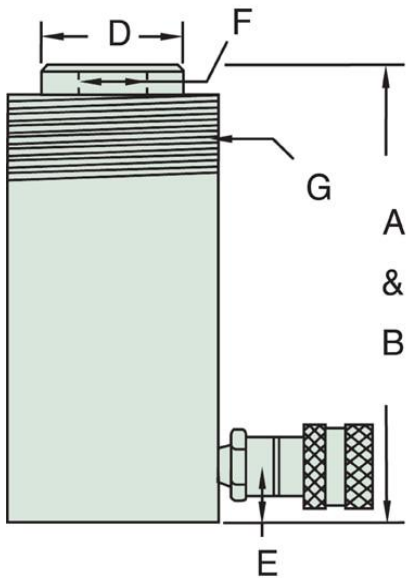

** R50 Base Mounting hole 7/32 through x 23/64 "C" bore (1/4" depth).*

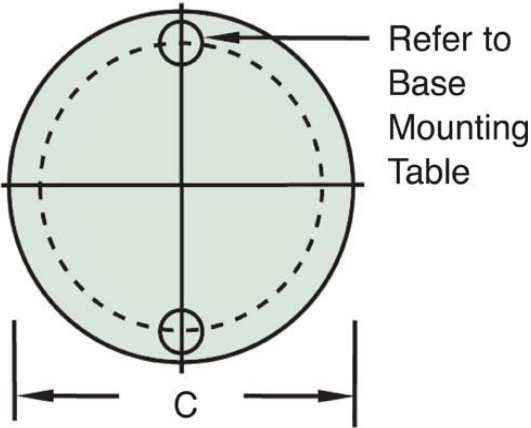

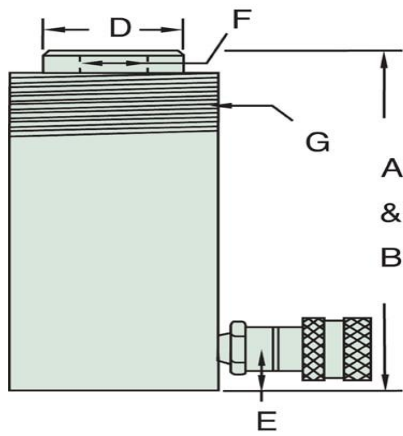

** R50 Base Mounting hole 5.56 mm
through x 9.13 mm "C" bore
(10.64 mm depth).*

