

Specifications

Units:

Imperial

Metric

Maximum Operating Pressure (psi)	10,000
Capacity Class (tonnage)	100
Maximum Cylinder Capacity Advance (tons)	110.9
Stroke (in)	1.97
Collapsed Height A (in)	8.71
Extended Height B (in)	10.68
Return Type	Single-Acting, Spring Return
Plunger Type	Solid
Material	Aluminum
Cylinder Effective Area Advance (in ²)	22.19
Oil Capacity Advance (in ³)	43.71
Surface Treatment	Anodized
Coupler	CR400 Coupler
Weight (lbs)	38.1

Dimensions

Units:

Imperial

Metric

Collapsed Height A (in)	8.71
Optional Tilt Saddle Addition To Collapsed Height A1 (in)	0.75
Optional Tilt Saddle Diameter J1 (in)	3.82
Extended Height B (in)	10.68
Outside Diameter D (in)	7.09
Cylinder Bore Diameter E (in)	5.32
Plunger Diameter F (in)	4.33
Base to Advance Port H (in)	1.82
Saddle Diameter J1 (in)	3.7
Saddle Protrusion from Plunger K (in)	0.12
Saddle Maximum Tilt Angle Radius (degrees)	5
Base Mounting Holes Bolt Circle U (in)	5.91
Base Mounting Holes Thread V	M10

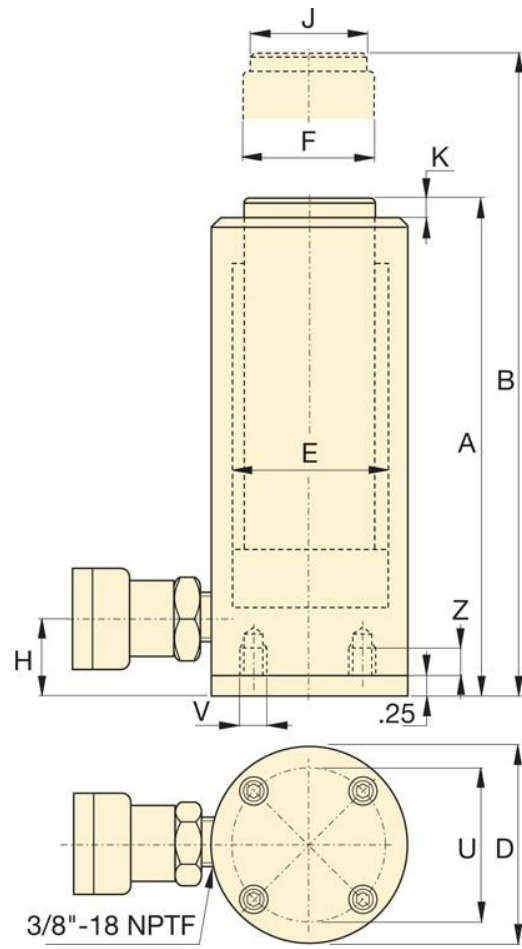

b