

# ALUMINUM CYLINDERS

RAL Series - Locknut Spring Return



RAL502 Shown

Capacity Range .....▶ 50 - 150 tons

Stroke Range .....▶ 2 - 10 in.

Maximum Pressure .....▶ 10,000 psi

- ▶ Technical coating reduces wear & corrosion.
- ▶ Carrying handles standard on all models.
- ▶ Half the weight of steel cylinders.
- ▶ Locknuts offer extended load holding.
- ▶ Stop rings for piston blow out protection.
- ▶ Heavy duty spring for fast & full retraction.



### COUPLERS - pages 74 - 75

High flow quick disconnect couplers provide a quick change to a variety of pumps.



### HOSES - pages 78 - 79

Heavy duty and thermo plastic hydraulic hoses to meet your requirements and safety factor.

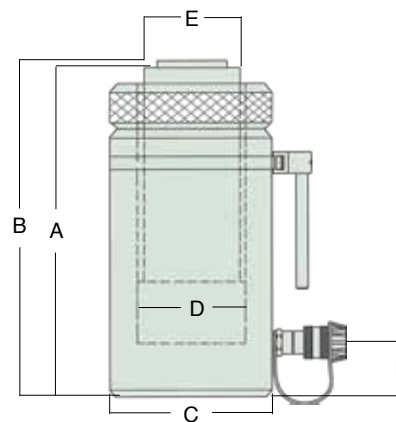

Model	Cap. (tons)	Stroke (in)	Oil Capacity Required (cu.in.)	Effect Area (sq.in.)	Pressure @ Capacity (psi)	A	B	C	D	E	F	Wgt. (lbs)
						Minimum Height (in)	Extended Height (in)	Body O.D. (in)	Cylinder Bore Diameter (in)	Piston O.D. (in)	Base to Port C/L (in)	
<b>RAL502</b>	50	2	21.65	11.04	9058	8.13	10.13	5.5	3.75	3.13	1.5	20
<b>RAL504</b>	50	4	43.3	11.04	9058	10.13	14.13	5.5	3.75	3.13	1.5	25
<b>RAL506</b>	50	6	64.92	11.04	9058	12.13	18.13	5.5	3.75	3.13	1.5	30
<b>RAL5010</b>	50	10	108.2	11.04	9058	16.13	26.13	5.5	3.75	3.13	1.5	40
<b>RAL1002</b>	100	2	40.51	20.68	9671	8.38	10.38	8	5.13	4.25	1.5	45
<b>RAL1004</b>	100	4	81	20.68	9671	10.38	14.38	8	5.13	4.25	1.5	55
<b>RAL1006</b>	100	6	121.5	20.68	9671	12.38	18.38	8	5.13	4.25	1.5	64
<b>RAL10010</b>	100	10	202.5	20.68	9671	16.38	26.38	8	5.13	4.25	1.5	82
<b>RAL1502</b>	150	2	60.6	30.68	9778	8.38	10.38	10	6.25	5	1.5	65
<b>RAL1506</b>	150	6	181.8	30.68	9778	12.38	18.38	10	6.25	5	1.5	101
<b>RAL15010</b>	150	10	303	30.68	9778	16.38	26.38	10	6.25	5	1.5	156