

Specifications

Units:

Imperial

Metric

Maximum Operating Pressure (psi)	10,000
Capacity Class (tonnage)	150
Maximum Cylinder Capacity Advance (tons)	153.5
Maximum Cylinder Capacity Retract (tons)	74
Stroke (in)	6.13
Collapsed Height A (in)	15.19
Extended Height B (in)	21.31
Return Type	Double-Acting, Hydraulic Return
Plunger Type	Solid
Material	Steel
Cylinder Effective Area Advance (in ²)	30.71
Cylinder Effective Area Retract (in ²)	14.8
Oil Capacity Advance (in ³)	188.28
Oil Capacity Retract (in ³)	91
Surface Treatment	Paint
Coupler	CR400 Coupler
Weight (lbs)	205

Dimensions

Units:

Imperial

Metric

Collapsed Height A (in)	15.19
Extended Height B (in)	21.31
Outside Diameter D (in)	8
Cylinder Bore Diameter E (in)	6.25
Plunger Diameter F (in)	4.5
Base to Advance Port H (in)	1.94
Top to Retract Port (in)	3.31
Saddle Diameter J1 (in)	4.49
Saddle Protrusion from Plunger K (in)	0.75
Plunger Internal Thread O (in)	33/8"- 16
Plunger Thread Length P (in)	1.38
Base Mounting Holes Bolt Circle U (in)	6.25
Base Mounting Holes Thread V	3/4"- 16
Collar Thread Size W	8"- 12
Collar Thread W (in)	8" - 12
Collar Thread Length X (in)	2.36
Base Mounting Holes Thread Depth Z (in)	1

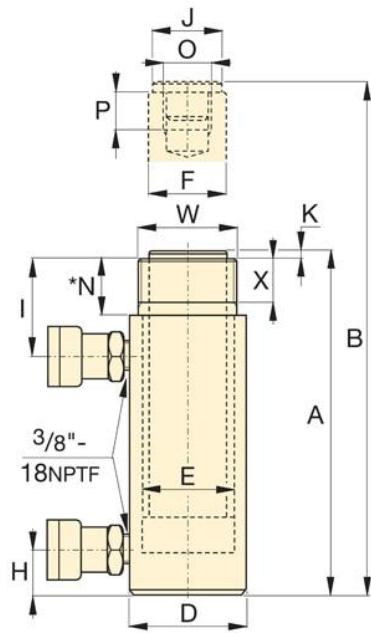

RR-1010 to RR-3014 models

* For RR-1010 and RR-1012:
N = 1.26 inch; for RR-308 and
RR-3014: N = 2.20 inch.

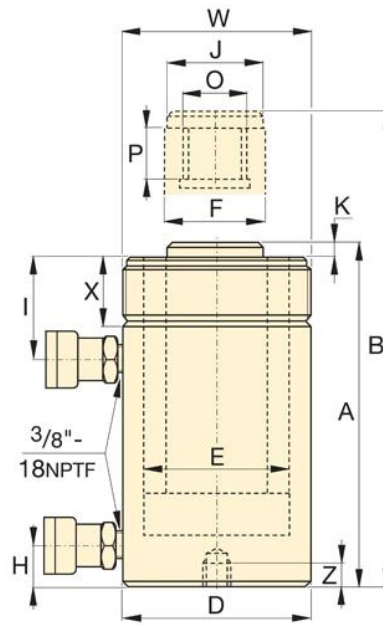

RR-506 to RR-50048 models

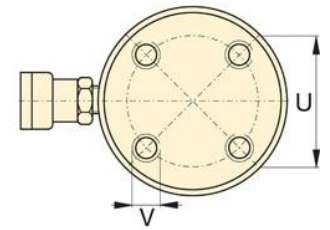

RR-1006 to RR-30048

No mounting holes:

RR-506, 5013
RR-756, 7513
RR-1502, 15032

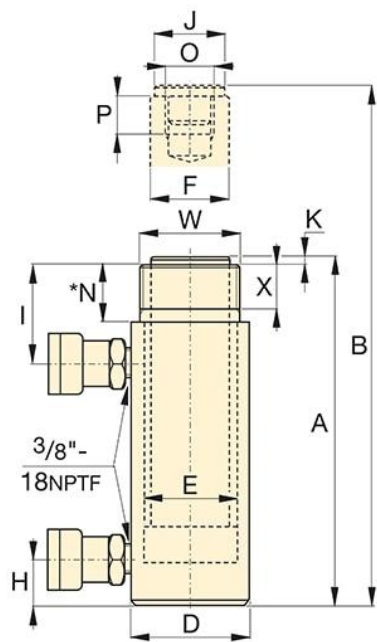

RR-1010 to RR-3014 models

* For RR-1010 and RR-1012:
 N = 32 mm; for RR-308 and
 RR-3014: N = 56 mm

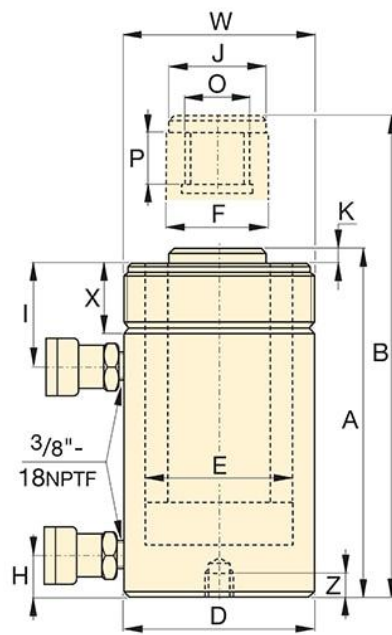

RR-506 to RR-50048 models

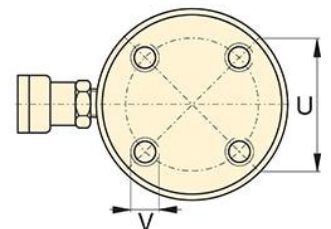

RR-1006 to RR-30048

No mounting holes:
 RR-506, 5013
 RR-756, 7513
 RR-1502, 15032