

Specifications

Units: Imperial Metric

Maximum Operating Pressure (psi)	10,000
Capacity Class (tonnage)	300
Maximum Cylinder Capacity Advance (tons)	354.6
Maximum Cylinder Capacity Retract (tons)	190
Stroke (in)	6
Collapsed Height A (in)	19.13
Extended Height B (in)	25.13
Return Type	Double-Acting, Hydraulic Return
Plunger Type	Solid
Material	Steel
Cylinder Effective Area Advance (in ²)	70.93
Cylinder Effective Area Retract (in ²)	38
Oil Capacity Advance (in ³)	425.56
Oil Capacity Retract (in ³)	228
Surface Treatment	Paint
Coupler	CR400 Coupler
Weight (lbs)	441

Dimensions

Units: Imperial Metric

Collapsed Height A (in)	19.13
Extended Height B (in)	25.13
Outside Diameter D (in)	12.25
Cylinder Bore Diameter E (in)	9.5
Plunger Diameter F (in)	6.5
Base to Advance Port H (in)	3.5
Top to Retract Port (in)	4.5
Saddle Diameter J1 (in)	6.5
Saddle Protrusion from Plunger K (in)	1.13
Plunger Internal Thread O (in)	2½" - 12
Plunger Thread Length P (in)	3.25
Base Mounting Holes Bolt Circle U (in)	6.25
Base Mounting Holes Thread V	1¼" - 7
Collar Thread Size W	12¼" - 12
Collar Thread W (in)	12 1/4" - 12
Collar Thread Length X (in)	2.31
Base Mounting Holes Thread Depth Z (in)	1.75

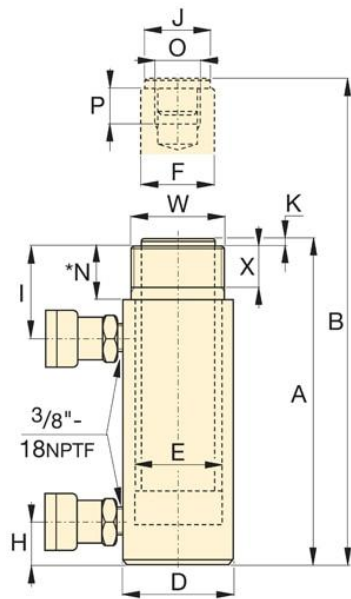

RR-1010 to RR-3014 models

* For RR-1010 and RR-1012:
N = 1.26 inch; for RR-308 and
RR-3014: N = 2.20 inch.

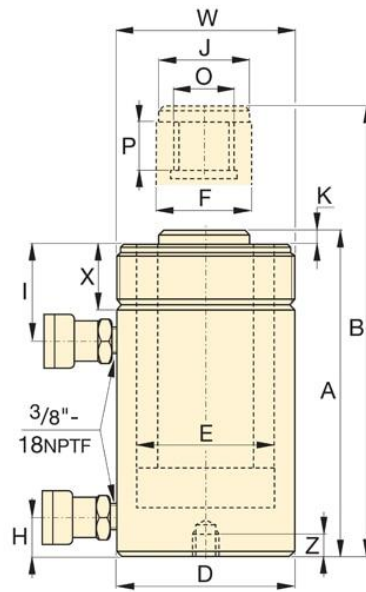

RR-506 to RR-50048 models

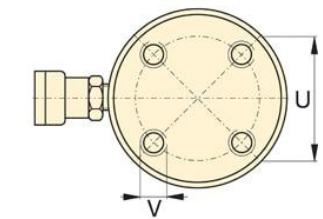

RR-1006 to RR-30048

No mounting holes:
RR-506, 5013
RR-756, 7513
RR-1502, 15032

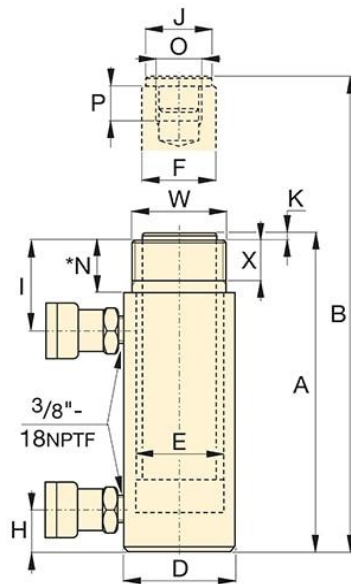

RR-1010 to RR-3014 models

* For RR-1010 and RR-1012:
N = 32 mm; for RR-308 and
RR-3014: N = 56 mm

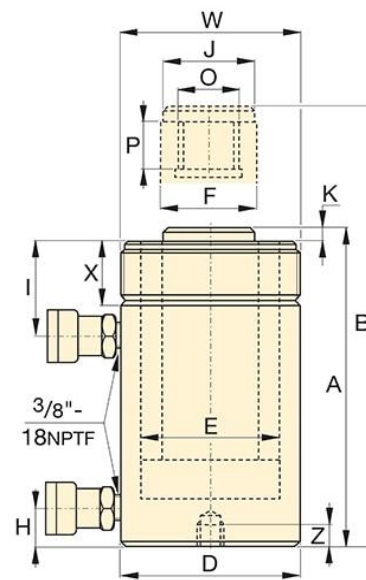

RR-506 to RR-50048 models

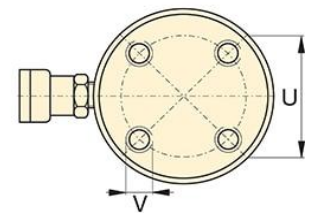

RR-1006 to RR-30048

No mounting holes:
RR-506, 5013
RR-756, 7513
RR-1502, 15032