

## Specifications

Units: **Imperial** Metric

|  |                                 |
|--|---------------------------------|
| Maximum Operating Pressure (psi)                   | 10,000                          |
| Capacity Class (tonnage)                           | 30                              |
| Maximum Cylinder Capacity Advance (tons)           | 32.5                            |
| Maximum Cylinder Capacity Retract (tons)           | 6                               |
| Stroke (in)  | 14.5                            |
| Collapsed Height A (in)                            | 21.63                           |
| Extended Height B (in)                             | 36.13                           |
| Return Type  | Double-Acting, Hydraulic Return |
| Plunger Type                                       | Solid                           |
| Material   | Steel                           |
| Cylinder Effective Area Advance (in <sup>2</sup> ) | 6.51                            |
| Cylinder Effective Area Retract (in <sup>2</sup> ) | 3                               |
| Oil Capacity Advance (in <sup>3</sup> )            | 92.7                            |
| Oil Capacity Retract (in <sup>3</sup> )            | 43                              |
| Surface Treatment                                  | Paint                           |
| Coupler  | CR400 Coupler                   |
| Weight (lbs)                                       | 64                              |

## Dimensions

Units: **Imperial** Metric

|   |              |
|---|--------------|
| Collapsed Height A (in)                                   | 21.63        |
| Optional Tilt Saddle Addition To Collapsed Height A1 (in) | 0.98         |
| Optional Tilt Saddle Diameter J1 (in)                     | 2            |
| Extended Height B (in)                                    | 36.13        |
| Outside Diameter D (in)                                   | 4            |
| Cylinder Bore Diameter E (in)                             | 2.88         |
| Plunger Diameter F (in)                                   | 2.13         |
| Base to Advance Port H (in)                               | 1.56         |
| Top to Retract Port (in)                                  | 3.19         |
| Saddle Diameter J1 (in)                                   | 1.97         |
| Saddle Protrusion from Plunger K (in)                     | 0.41         |
| Plunger Internal Thread O (in)                            | 1½" - 16     |
| Plunger Thread Length P (in)                              | 1            |
| Saddle Maximum Tilt Angle Radius (degrees)                | 5            |
| Base Mounting Holes Thread V                              | -            |
| Collar Thread Size W                                      | 35/16" - 12  |
| Collar Thread W (in)                                      | 3 5/16" - 12 |
| Collar Thread Length X (in)                               | 1.94         |

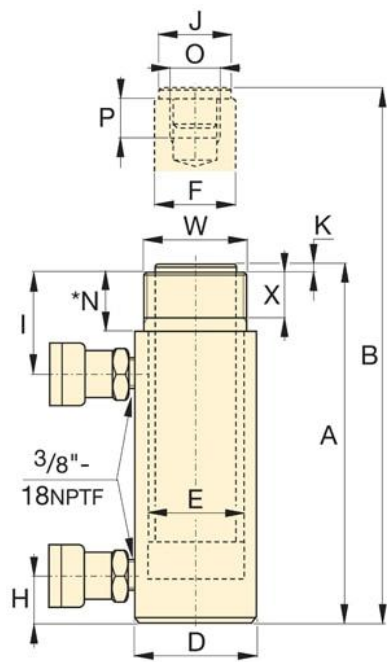

**RR-1010 to RR-3014 models**

\* For RR-1010 and RR-1012:  
N = 1.26 inch; for RR-308 and  
RR-3014: N = 2.20 inch.

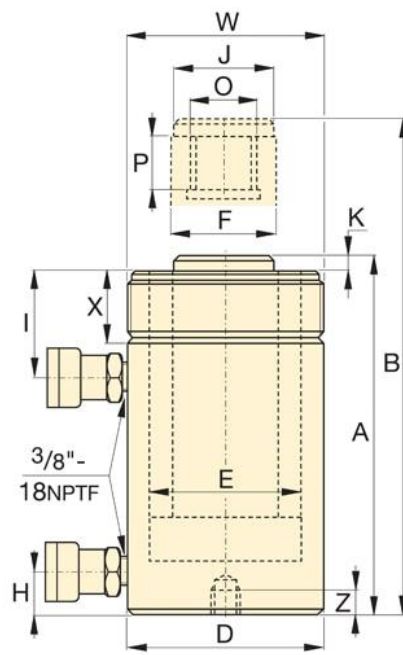

**RR-506 to RR-50048 models**

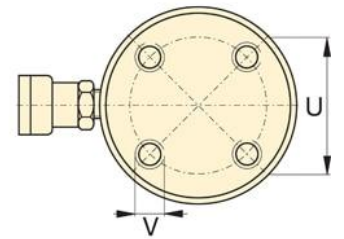

**RR-1006 to RR-30048**

**No mounting holes:**

RR-506, 5013  
RR-756, 7513  
RR-1502, 15032

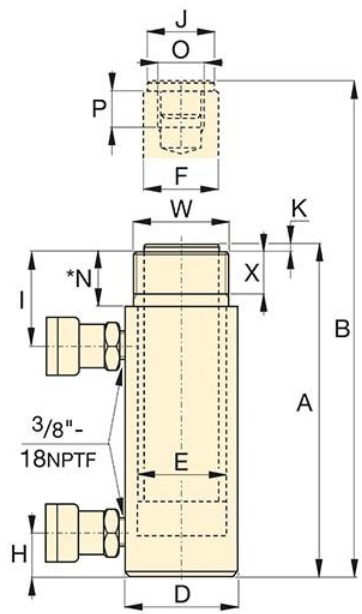

**RR-1010 to RR-3014 models**

\* For RR-1010 and RR-1012:  
N = 32 mm; for RR-308 and  
RR-3014: N = 56 mm

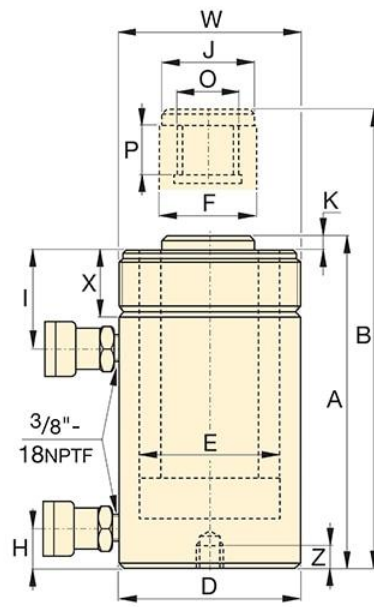

**RR-506 to RR-50048 models**

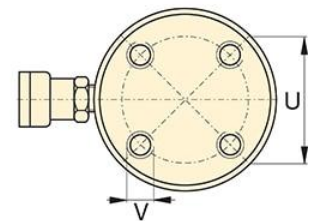

**RR-1006 to RR-30048**

**No mounting holes:**

RR-506, 5013  
RR-756, 7513  
RR-1502, 15032