

Specifications

Units:

Imperial

Metric

Maximum Operating Pressure (psi)	10,000
Capacity Class (tonnage)	50
Maximum Cylinder Capacity Advance (tons)	55.3
Maximum Cylinder Capacity Retract (tons)	11.8
Stroke (in)	6.13
Collapsed Height A (in)	13.06
Extended Height B (in)	19.19
Return Type	Double-Acting, Hydraulic Return
Plunger Type	Solid
Material	Steel
Cylinder Effective Area Advance (in ²)	11.06
Cylinder Effective Area Retract (in ²)	3.4
Oil Capacity Advance (in ³)	67.77
Oil Capacity Retract (in ³)	21
Surface Treatment	Paint
Coupler	CR400 Coupler
Weight (lbs)	67

Dimensions

Units:

Imperial

Metric

Collapsed Height A (in)	13.06
Optional Tilt Saddle Addition To Collapsed Height A1 (in)	0.59
Optional Tilt Saddle Diameter J1 (in)	2.81
Extended Height B (in)	19.19
Outside Diameter D (in)	5
Cylinder Bore Diameter E (in)	3.75
Plunger Diameter F (in)	3.13
Base to Advance Port H (in)	1.13
Top to Retract Port (in)	3
Saddle Diameter J1 (in)	2.8
Saddle Protrusion from Plunger K (in)	0.11
Plunger Internal Thread O (in)	1"- 12
Plunger Thread Length P (in)	1
Saddle Maximum Tilt Angle Radius (degrees)	5
Base Mounting Holes Thread V	–
Collar Thread Size W	5"- 12
Collar Thread Length X (in)	2

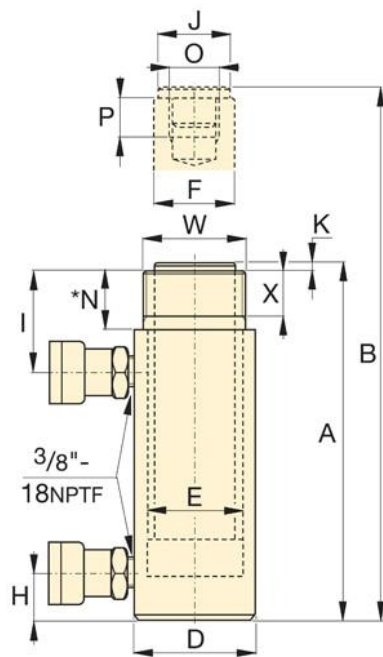

RR-1010 to RR-3014 models

* For RR-1010 and RR-1012:
N = 1.26 inch; for RR-308 and
RR-3014: N = 2.20 inch.

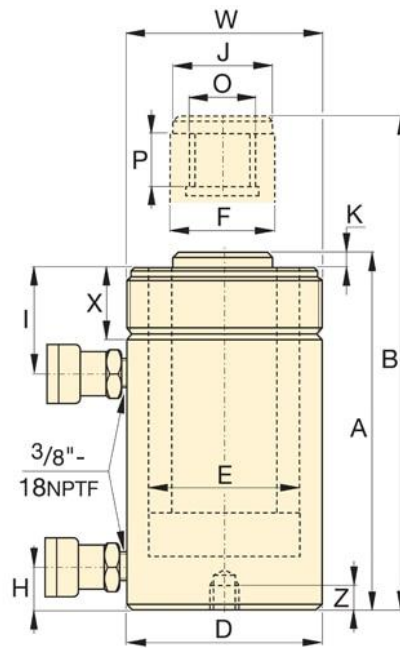

RR-506 to RR-50048 models

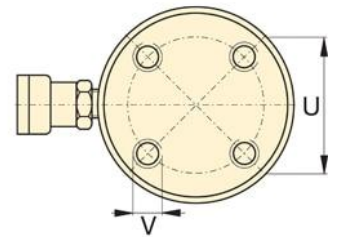

RR-1006 to RR-30048

No mounting holes:

RR-506, 5013
RR-756, 7513
RR-1502, 15032

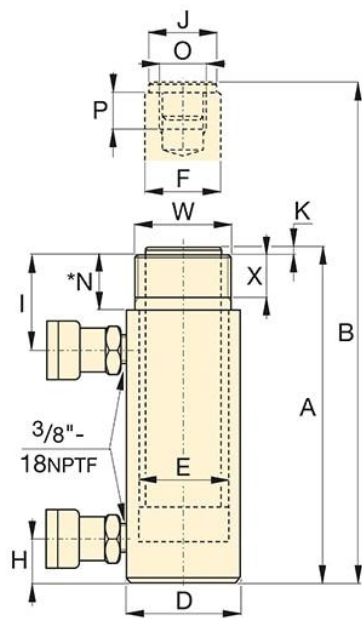

RR-1010 to RR-3014 models

* For RR-1010 and RR-1012:
N = 32 mm; for RR-308 and
RR-3014: N = 56 mm

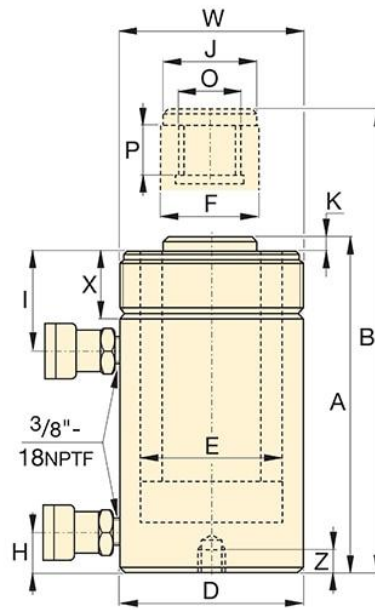

RR-506 to RR-50048 models

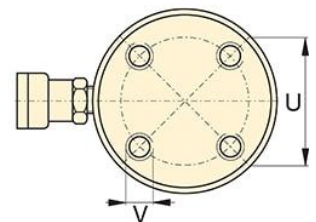

RR-1006 to RR-30048

No mounting holes:

RR-506, 5013
RR-756, 7513
RR-1502, 15032