

## Specifications

Units: **Imperial** Metric

Maximum Operating Pressure (psi)	10,000
Capacity Class (tonnage)	75
Maximum Cylinder Capacity Advance (tons)	79.6
Maximum Cylinder Capacity Retract (tons)	17.6
Stroke (in)	13.13
Collapsed Height A (in)	20.69
Extended Height B (in)	33.81
Return Type	Double-Acting, Hydraulic Return
Plunger Type	Solid
Material	Steel
Cylinder Effective Area Advance (in <sup>2</sup> )	15.92
Cylinder Effective Area Retract (in <sup>2</sup> )	4.9
Oil Capacity Advance (in <sup>3</sup> )	209
Oil Capacity Retract (in <sup>3</sup> )	64
Surface Treatment	Paint
Coupler	CR400 Coupler
Weight (lbs)	150

## Dimensions

Units: **Imperial** Metric

Collapsed Height A (in)	20.69
Optional Tilt Saddle Addition To Collapsed Height A1 (in)	0.59
Optional Tilt Saddle Diameter J1 (in)	2.81
Extended Height B (in)	33.81
Outside Diameter D (in)	5.75
Cylinder Bore Diameter E (in)	4.5
Plunger Diameter F (in)	3.75
Base to Advance Port H (in)	1.19
Top to Retract Port (in)	3.19
Saddle Diameter J1 (in)	2.8
Saddle Protrusion from Plunger K (in)	0.25
Plunger Internal Thread O (in)	1"- 12
Plunger Thread Length P (in)	1.5
Saddle Maximum Tilt Angle Radius (degrees)	5
Base Mounting Holes Thread V	-
Collar Thread Size W	5¼"- 12
Collar Thread W (in)	5 3/4" - 12
Collar Thread Length X (in)	1.5

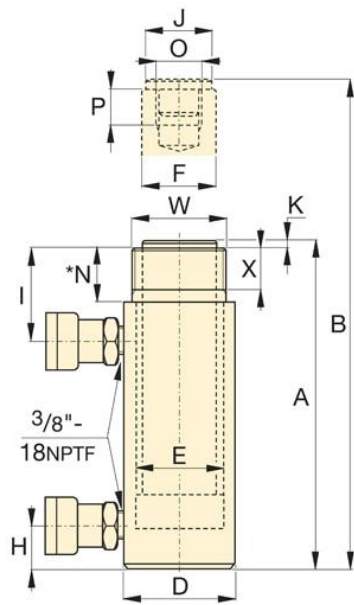

**RR-1010 to RR-3014 models**

\* For RR-1010 and RR-1012:  
N = 1.26 inch; for RR-308 and  
RR-3014: N = 2.20 inch.

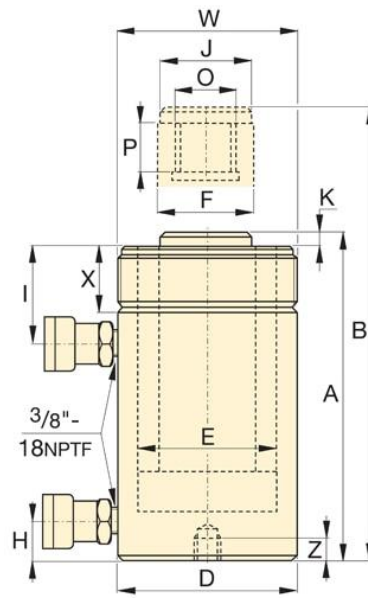

**RR-506 to RR-50048 models**

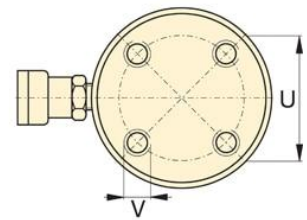

**RR-1006 to RR-30048**

**No mounting holes:**  
RR-506, 5013  
RR-756, 7513  
RR-1502, 15032

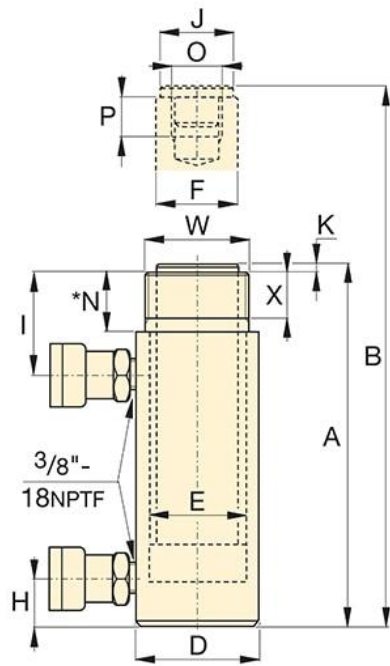

**RR-1010 to RR-3014 models**

\* For RR-1010 and RR-1012:  
N = 32 mm; for RR-308 and  
RR-3014: N = 56 mm

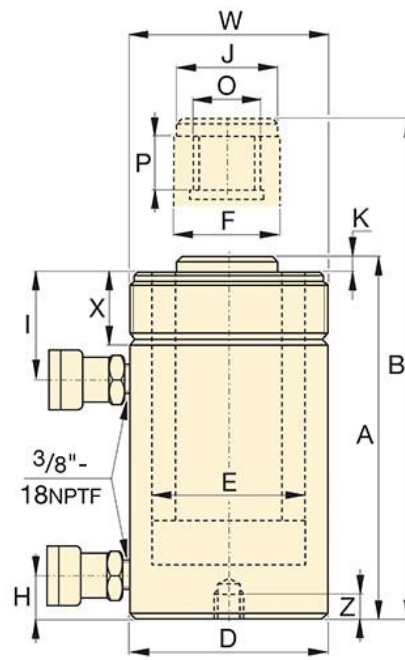

**RR-506 to RR-50048 models**

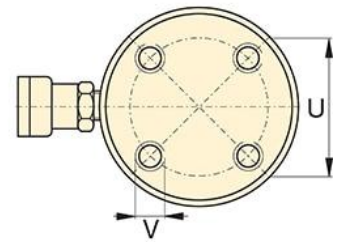

**RR-1006 to RR-30048**

**No mounting holes:**

RR-506, 5013  
RR-756, 7513  
RR-1502, 15032