

205 Westwood Ave, Long Branch, NJ 07740  
Phone: 866-94 BOARDS (26273) / (732)-222-1511  
Fax: (732)-222-7088 | E-mail: sales@touchboards.com

## Ergotron®

### Neo-Flex® WideView WorkSpace Neo-Flex Dual WideView WorkSpace



#### Highlights

- Flexible, open-architecture design is scalable for future videoconferencing or computer equipment. Features a fleet of accessories to meet individualized computing needs
- Easily moves through small doorways and over thresholds
- Use inside an office cubicle or small meeting space; compact design offers personalized video or computing
- Work sitting or standing with ergonomic 20" (51 cm) height-adjustment range
- Patented Constant Force lift technology provides fluid, one-touch adjustment
- Safe and neat routing of cables through the expansive cable management storage area
- Use a laptop or CPU for computing flexibility

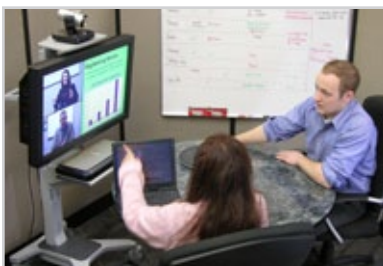

#### Compact and agile mobile display hub for two screens or one larger screen

Widen your view—and move it too! Configure this compact, low-cost, height-adjustable cart to your needs: Its flexible open architecture supports dual displays or a mid-size display, making it perfect for web conferencing or any other image-intensive mobile computing application. Select the dual-screen or the mid-sized screen cart and add the optional camera shelf as needed. The Neo-Flex WideView WorkSpace is designed for telemedicine, radiology, clinical PACS access, labs, manufacturing floors, distribution centers, distant-learning facilities, corporate settings and more.

Features include 20" (51 cm) height adjustment (work sitting or standing), compact footprint and a fleet of accessories. The small platform creates engaging environments for personalized 1-to-1 video viewing or small-group learning sessions. Integrated Constant Force technology improves viewing comfort and enhances productivity with effortless height adjustment.

- Durable, easy-to-clean exterior composed of aluminum, high-grade plastic and powder coated painted steel
- Four dual casters—lockable front casters
- Worksurface: 16.5" W x 14" D (42 x 36 cm)
- Wheel-to-wheel base dimensions: 17" x 20.5" (43 x 52 cm)
- Add the WideView Camera Shelf Kit (97-500-055) to place adjustable camera shelf above the display (order separately)
- Warranty: three (3) years

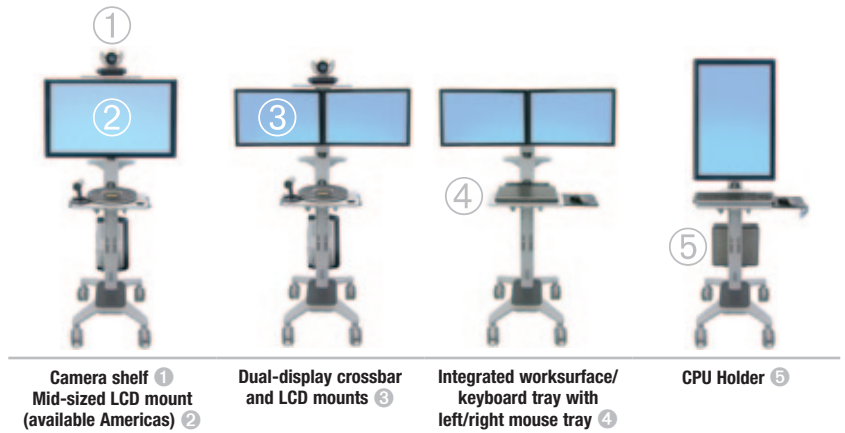

Camera shelf ①  
Mid-sized LCD mount (available Americas) ②  
Dual-display crossbar and LCD mounts ③  
Integrated worksurface/keyboard tray with left/right mouse tray ④  
CPU Holder ⑤

## Many configuration options!

Product Name Part Number (Color)	Neo-Flex WideView WorkSpace 24-189-055 (two-tone grey), available Americas Neo-Flex Dual WideView WorkSpace 24-194-055 (two-tone grey)
Includes	24-189-055: Cart, LCD pivot, integrated worksurface/keyboard tray with left/right mouse tray, scanner holder bracket, mouse holder, rear handle, cable storage box, CPU holder, four dual casters (two locking) 24-194-055: Cart, crossbar with two (2) LCD mounts, integrated worksurface/keyboard tray with left/right mouse tray, scanner holder bracket, mouse holder, rear handle, cable storage box, CPU holder, four dual casters (two locking)
Shipping Dimensions	45.5"H x 19.75"W x 24"D (1156 x 502 x 610 mm)
Shipping Weight	24-189-055: 82 lbs (37 kg) 24-194-055: 88 lbs (40 kg)
Compatible Display(s)	See <a href="http://www.ergotron.com">www.ergotron.com</a> for details

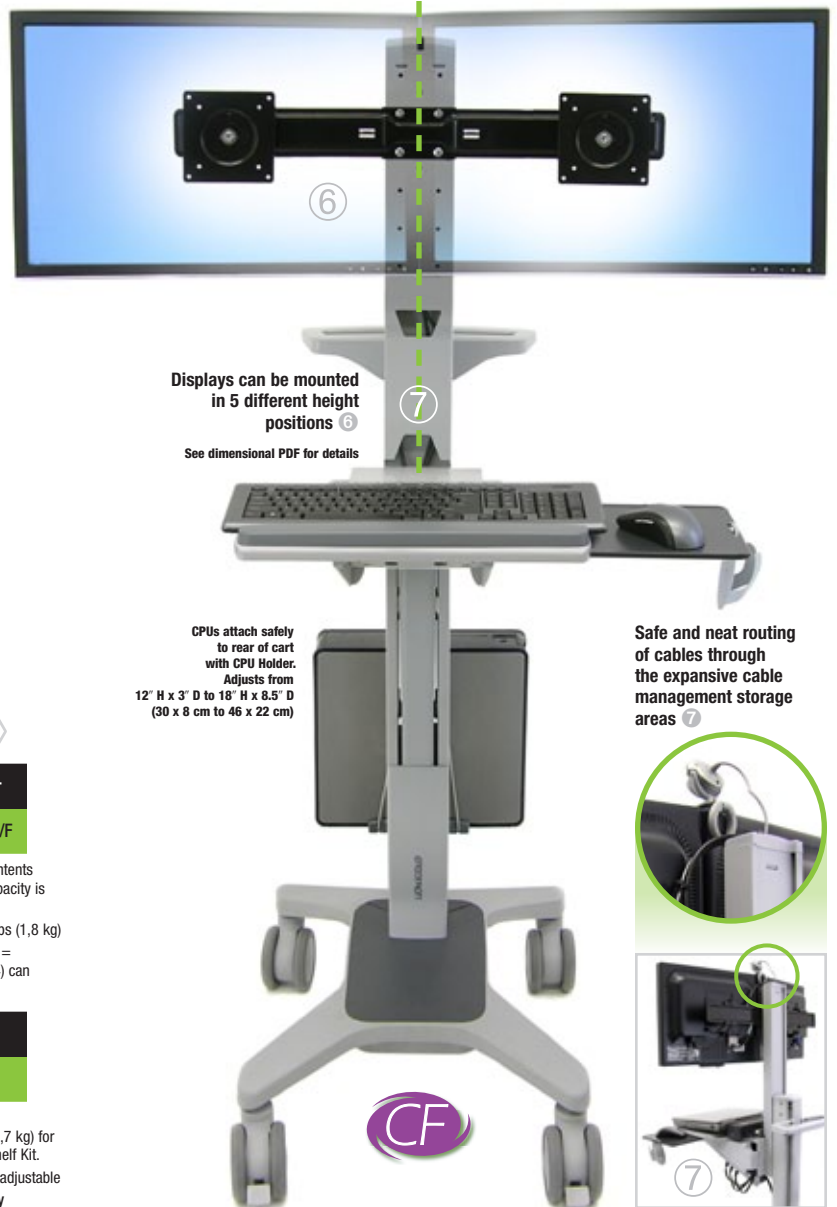

Displays can be mounted in 5 different height positions ⑥  
See dimensional PDF for details

CPUs attach safely to rear of cart with CPU Holder. Adjusts from 12" H x 3" D to 18" H x 8.5" D (30 x 8 cm to 46 x 22 cm)

Safe and neat routing of cables through the expansive cable management storage areas ⑦

Save time and money utilizing a network of certified professionals to deploy Ergotron's fleet of Neo-Flex carts. See our Service Program page on Ergotron.com for more information.



24-189-055 LCD Size	LCD Weight*	Lift	Tilt	Pan	Rotation**	VESA†
≤ 30"	16–30 lbs 7,3–13,6 kg	20" 51 cm	30°	—	90° P/L	MIS-D/E/F

\* Maximum load on height-adjustment assembly = 40 lbs (18 kg). Includes weight of display in addition to contents on Worksurface and in Cable Storage Box. LCD pivot capacity = 16–30 lbs (7,3–13,6 kg). Display weight capacity is diminished by 5 lbs (2,3 kg) plus weight of camera with Camera Shelf Kit.

\*\* Portrait orientation of display may not be compatible with Camera Shelf. Shelf maximum weight capacity 4 lbs (1,8 kg)

† VESA FDMI, MIS-D, 75/100 (hole patterns = 100 x 100 mm and 75 x 75 mm); VESA FDMI, MIS-E (hole pattern = 200 x 100 mm); VESA FDMI, MIS-F (hole pattern = 200 x 200 mm). Optional VESA Bracket Adaptor Kit (97-474) can be ordered separately for display interface that uses a VESA FDMI, MIS-F 400 x 200 mm hole pattern

24-194-055 LCD Size	LCD Weight*	Lift	Tilt**	Pan	Rotation†	VESA
two ≤ 22"	12–28 lbs 5,4–12,7 kg	20" 51 cm	—	—	90° P/L	MIS-D

\* Maximum load of height-adjustment assembly = 40 lbs (18 kg). Includes weight of displays and contents on Worksurface and in Cable Storage Box. LCD capacity = 6–14 lbs (2,7–6,4 kg) per mount. 12–28 lbs (5,4–12,7 kg) for both displays. Display weight capacity is diminished by 5 lbs (2,3 kg) plus weight of camera with Camera Shelf Kit.

\*\* Install dual displays at 3.5° or 8.5° upward angle for optimized viewing conditions. Dual displays are not tilt adjustable

† Portrait orientation of display may not be compatible with Camera Shelf. Shelf maximum weight capacity 4 lbs (1,8 kg)

© 2011 Ergotron, Inc. rev. 01/18/2011 e-05-088-EA Content is subject to change without notification

# Touchboards

205 Westwood Ave, Long Branch, NJ 07740  
Phone: 866-94 BOARDS (26273) / (732)-222-1511  
Fax: (732)-222-7088 | E-mail: [sales@touchboards.com](mailto:sales@touchboards.com)