



## Ergotron® 100 Series

for low profile systems

### Highlights

- Patented Suspension Technology allows monitors to swing, tilt or rotate
- Slim profile saves space
- Provides smooth adjustment while maintaining touch-screen stability without the need for knobs or levers
- Up to 180° of forward/back LCD tilt and 180° of side-to-side LCD pan
- Internal steel construction for long-lasting durability and easy to clean plastic exterior
- Weight capacity up to 25 lbs (11.3 kg)
- Multiple keyboard tray options provide optimum ergonomic comfort
- Fold up keyboard against the wall when not in use
- Attaches to LCDs that are VESA® MIS-D, 100/75, C compliant
- 5 year warranty



The 100 Series allows flat panel monitors, keyboards and laptops to be mounted with a minimum profile while providing side-to-side and forward-back pivot movement. The patented friction system provides smooth adjustment while maintaining touch-screen stability.

Choose from Single Pivot with Portrait/Landscape (P/L), Double Pivot with P/L and Keyboard/Laptop Pivots to suit your application. Multiple surface attachment and accessory options are available.



Pivot shown mounted to Wall Track. Wall Track can provide a common interface for multiple Pivots.

All 100 Series can be mounted directly to surfaces with appropriate fasteners (Double Pivot with P/L shown).

Single Pivot with P/L shown mounted to Wall Plate.

Keyboard Pivot shown with Keyboard Tray—folds up flat when not in use (see inset photo).

100 Series shown mounted to 2" round pole.



## General Dimensions

Single Pivot with P/L

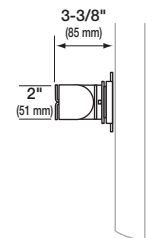

Double Pivot with P/L

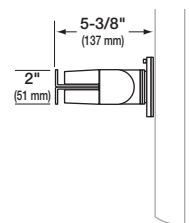

Keyboard/Laptop Pivot

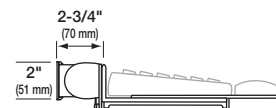

## Range of Motion

Note: Actual range of motion depends on mounting surface and size of monitor.

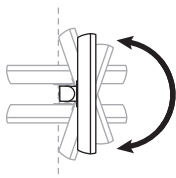

LCD tilts up to 180° forward/back

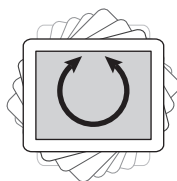

LCD rotates up to 360° portrait/landscape

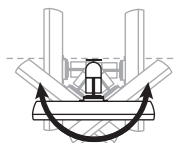

LCD pans up to 180° right/left

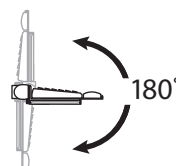

Keyboard tilts up to 180° forward/back

## Basic Specifications

Application Options: Direct to Surface, Wall Track, Wall Plates, Poles, Slatwall, Office Panels, Command Post, Mobile WorkStands

Display Interface Options:

- VESA FDMI MIS-D, 100/75, C (hole pattern: 100 x 100 mm & 75 x 75 mm)

Colors: Available in black and grey\*

\* Black and grey plastic covers are included with each product.

Weight Capacity

- Single Pivot w/ P/L: 25 lbs (11.3 kg)
- Double Pivot w/ P/L: 23 lbs (10.4 kg)
- Keyboard/Laptop Pivot: 7.5 lbs (3.4 kg)

Accessory Options: Extenders, Quick Release Kit, Tamper Resistant Kit, Keyboard Trays, Laptop Trays, Wrist Rests, Mouse Pads, Mouse Pouches, CPU Holders, Surge Suppressors and Power Strips

© 2005 Ergotron, Inc.  
rev. 08/25/2006 870-05-026

Content is subject to change  
without notification.

**Ergotron, Inc.:** St. Paul, MN; (800) 888-8458;  
[www.ergotron.com](http://www.ergotron.com); [sales@ergotron.com](mailto:sales@ergotron.com)

**Ergotron Europe:** Amersfoort, The Netherlands;  
Tel. +31 33 45 45 600; [info.eu@ergotron.com](mailto:info.eu@ergotron.com)

**Ergotron Asia:** (800) 468-3917 ext. 7617;  
[info.apac@ergotron.com](mailto:info.apac@ergotron.com)

