

Step 7

Carefully, rotate the shelf assembly (from Step 5), upside down as shown.

Place the base tube assembly (from Step 6) onto the vertical legs of the shelf assembly.

Attach the base tube to each leg using a total of four 3-1/2" bolts. Tighten all screws and bolts.

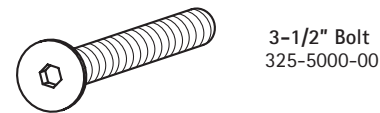

3-1/2" Bolt
325-5000-00

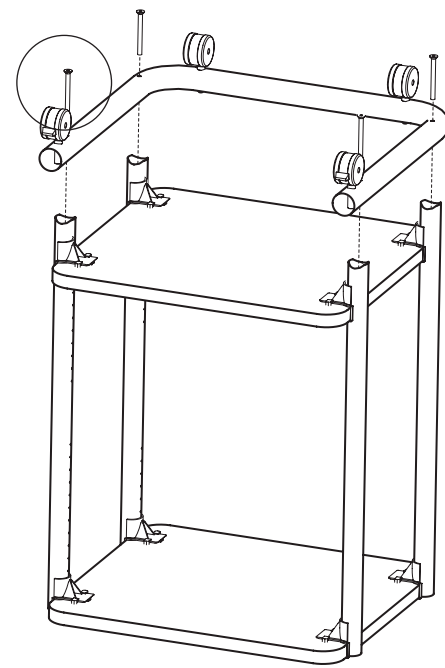

Step 8

Rotate your PrinterCart over onto the casters.

Pop the 1.5" small end caps into the vertical legs and the 1.75" large end caps into the base tube.

After you add your equipment to the cart, select the cable management components that suit.

To install the Cable Alleys, expand each sleeve and fit it over a cart leg. Align the mounting hole(s) in the sleeve with the holes on the leg, then install with self-threading screws.

To install the Cord Handler, snap the large end around any cart leg, then route cables through the small end.

Congratulations! Your assembly is complete.

Please return the enclosed Registration Card to receive our product updates, new catalogs, and sale flyers.

Thank you for choosing Anthro!

1.5" Small End Cap

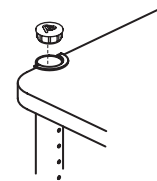

1.75" Large End Cap

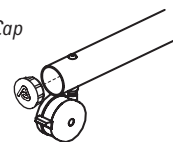

Anthro Equipment Cart Assembly Instructions



Anthro®
Technology Furniture®

Hello! Thank you for choosing Anthro.

Before beginning assembly of your Anthro Equipment Cart, please take a moment to review the parts listed below to verify that your shipment is complete.

Does your cart have 4" casters?
If your cart's part number ends in "4"
(030BK4, for example), you'll have these casters instead of the casters listed below:



4" Locking Caster
150-5011-00



4" Non-Locking Caster
150-5010-00

TOOLS

To make the assembly of your cart even easier, we have included all of the required tools. Use the handy Hex Driver Bit in your electric drill in place of the Hex Driver.

Hex Driver 5/32"..... 375-5000-00
Hex Driver Bit 5/32"..... 375-5003-00
8 oz. Rubber Mallet..... 375-5022-00

Enclosed Parts List

Detailed views of all Hardware are provided with each Assembly Step.

01- Vertical Legs	Qty. 4.....	125-5020-xx
02- Insert Screws	Qty. 4	325-5052-00
03- 1.75" Large End Caps.....	Qty. 2.....	175-5021-xx
04- Caster Inserts	Qty. 4.....	525-1000-00*
05- 2 3/8" Locking Casters	Qty. 2	150-5003-00*
06- Base Tube Screws.....	Qty. 4.....	325-5000-00
07- 2 3/8" Non-Locking Casters	Qty. 2	150-5002-00*
08- Base Tube.....	Qty. 1.....	125-5031-xx
09- 1-5/8" Screws.....	Qty. 8.....	325-5086-03
10- Shelf Supports.....	Qty. 8.....	175-5060-xx
11- Shelf Clamps.....	Qty. 8.....	175-5059-xx
12- PrinterCart Shelf.....	Qty. 2.....	100-6017-xx
13- 1.5" Small End Caps.....	Qty. 4.....	175-5020-xx
14- Self-threading Screws	Qty. 8.....	325-5010-00

All fastener quantities listed here are the minimum needed for your cart assembly. Your shipment may include a few extras.

Cable Management Components

Cable Alley, 9".....	Qty 1	175-5061-03
Cable Alley, 3".....	Qty 1	175-5062-03
Cord Handler.....	Qty 1	175-5001-03
Self-threading Screws	Qty 6.....	325-5010-00

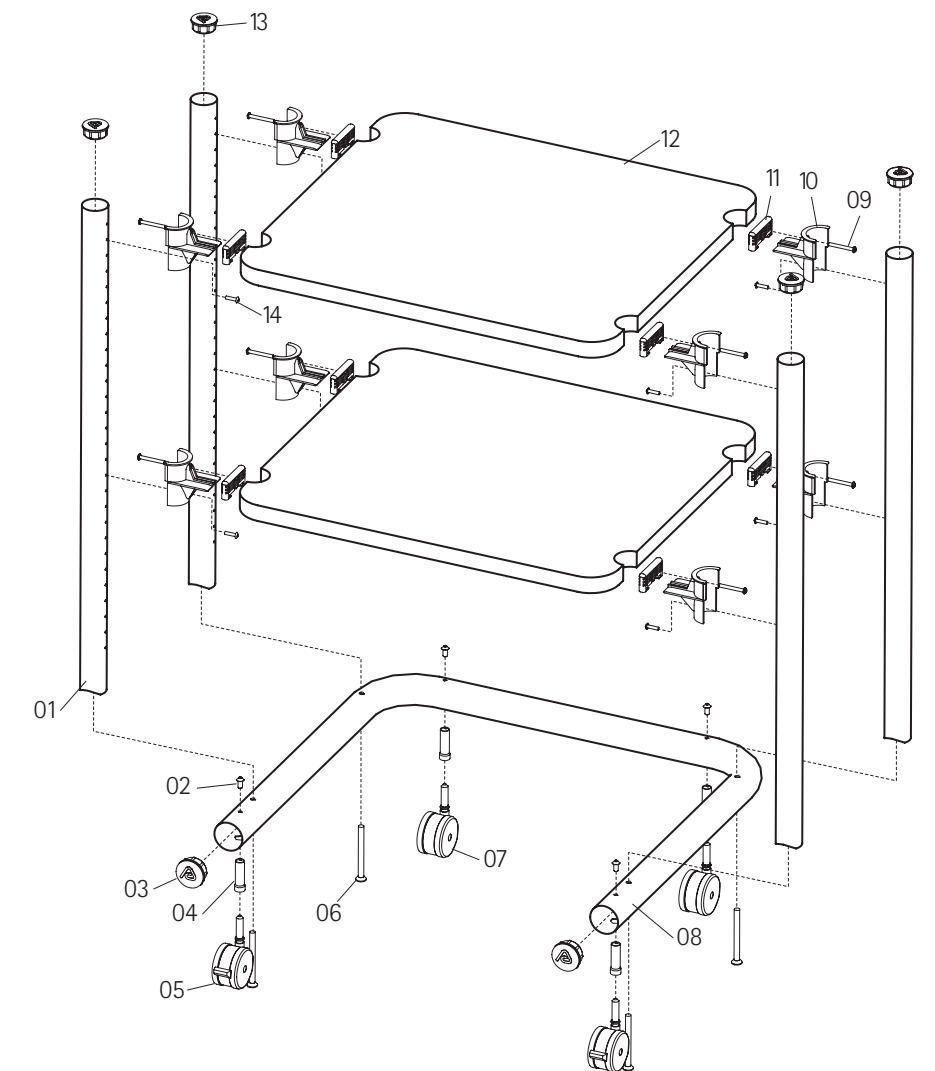

Touchboards

205 Westwood Ave, Long Branch, NJ 07740
Phone: 866-94 BOARDS (26273) / (732)-222-1511
Fax: (732)-222-7088 | E-mail: sales@touchboards.com



300-5045-00

1-800-325-3841

Questions?

Anthro® Corporation Technology Furniture® 10450 SW Manhasset Drive Tualatin, Oregon 97062

Rev D, January 2015

SAVE THESE INSTRUCTIONS!

anthro.com

Anthro Equipment Cart

Assembly Instructions

Questions? 1-800-325-3841

Step 1

Before proceeding, please review the Assembly Instructions of all Anthro products you purchased and are planning to include in this installation.

Decide on the shelf configuration that works best for you. Generally, customers place the large shelf at the top of the legs and the small shelf at the bottom of the legs, and that's how these instructions are organized. This configuration leaves 18" clearance between the shelves on the 28" high cart.

Shelves can be installed at any height (in 1" increments), so find the best configuration for you. If you need help configuring your cart, just give us a call!

Step 2

Attach four shelf supports to each shelf. Begin by first installing a shelf clamp into the shelf notch. Be sure the pointed barbs face towards the outer shelf edge.

Next, slide a shelf support into the recesses of the shelf clamp and shelf. Push in as far as possible.

Finally, secure with a 1-5/8" Screw (325-5086-00).

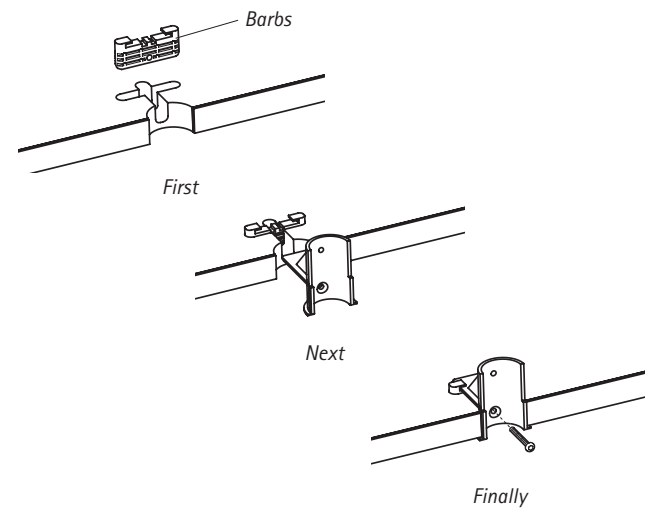

1-5/8" Screw
325-5086-00

Step 3

Loosely attach a shelf to lowest hole, at the bottom (*coped end*) of two vertical legs using two Self-threading Screws (325-5010-00). These fasteners are cutting threads into the leg, so the first few turns will require some force.

NOTE: This will place your lower shelf 9" from the floor using the standard 2³/₈" casters.

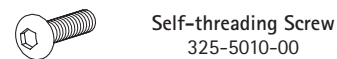
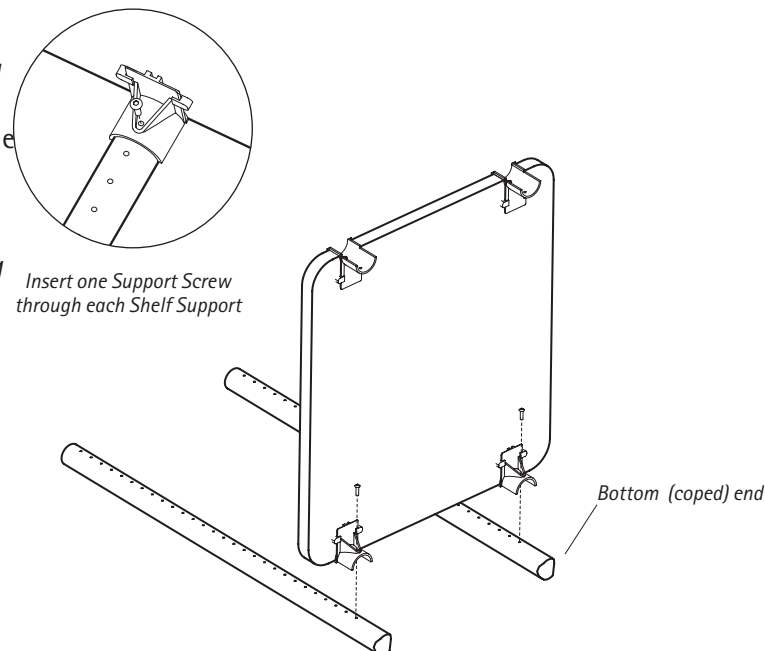

Self-threading Screw
325-5010-00

Step 4

Loosely attach the remaining shelf to hole 2 from the top (*non-coped end*) of the vertical leg assembly (*from Step 3*) using two Self-threading Screws (325-5010-00).

NOTE: Handle the shelf assembly carefully until the cart is fully assembled.

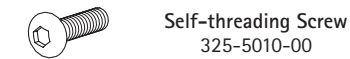

Self-threading Screw
325-5010-00

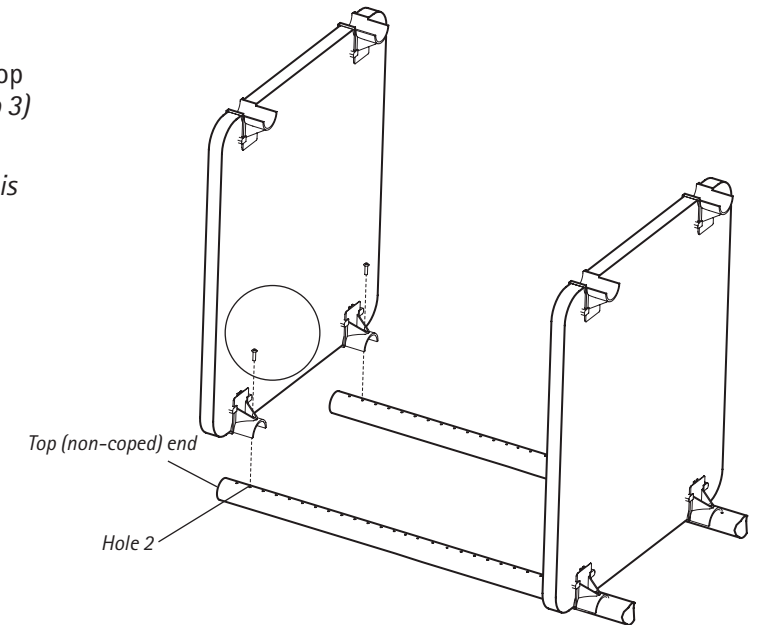

Step 5

Loosely attach the 3rd and 4th vertical legs to the shelf assembly (*from Step 4*) using one Self-threading Screw per shelf support.

TIP: Use the holes in the vertical legs as a ruler to ensure that your Self-threading Screws are installed into the correct locations.

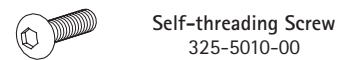

Self-threading Screw
325-5010-00

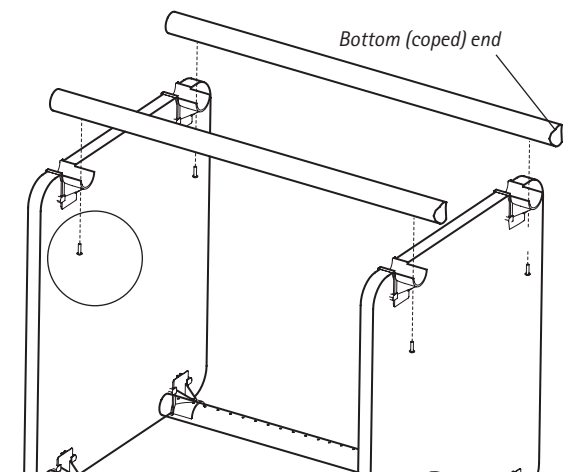

Step 6

Install all four caster inserts into the base tube and secure with one Caster Insert Screw (325-5052-00) per insert.

Push the casters, (locking ones in front) into the caster inserts.

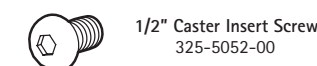

1/2" Caster Insert Screw
325-5052-00

