

Perma-Grip Industrial Grade Cord Grip

Portable Power



PERMA-GRIP™



Industry Leading Features:

- CSA Certified and UL Listed
- ☞ External TPE Molded Husk offers wider temperature range, higher crush and chemical resistance
- ☞ Husk Grooves for secure non-slipping gloved grip
- ☞ Cord Grip Dust and Moisture Seal prevents migration of harmful dust and moisture intrusion
- ☞ Device Blades and Contact are Plated for better contact and service life
- ☞ Cord Grip Nut and Grommet System offer a wide range of cable sizes

 Industry Leading, Ericson Exclusive



Locking Configurations:



15-AMP Locking
1520-PG, 1620-CG



20-AMP Locking
2310-PG, 2410-CG

Additional Features:

All Available in Black
*Custom Colors Available

Unique Features:



Higher Temperature range, superior crush, & chemical resistance



Patented Cord Grip Nut & Grommet System



Plated Device Blades, standard



Watertight Cord Grip Resists Moisture & Dust for Quick Assembly

NEMA Configuration Chart:

	Face View	NEMA Configuration	Amperage	Voltage	Perma-Grip Plug	Perma-Grip Connector
2-Pole / 3-Wire		NEMA 5-15	15A	125V	1510-PG	1610-CG
		NEMA 5-20	20A	125V	1512-PG	1612-CG
		NEMA L5-15	15A	125V	1520-PG	1620-CG
		NEMA L5-20	20A	125V	2310-PG	2410-CG
		NEMA L5-30	30A	125V	2510-PG	2610-CG
		NEMA 6-15	15A	250V	1514-PG	1614-CG
		NEMA 6-20	20A	250V	1516-PG	1616-CG
		NEMA L6-15	15A	250V	1522-PG	1622-CG
		NEMA L6-20	20A	250V	2312-PG	2412-CG
		NEMA L6-30	30A	250V	2512-PG	2612-CG
		NEMA L7-15	15A	277V	1524-PG	1624-CG
3-pole 3-wire		Non-NEMA ¹	20A	125 / 250V	2316-PG	2416-CG
		Non-NEMA ¹	15 / 10A	125 / 250V	1507-PG	1607-CG
		Non-NEMA ¹	30A	125 / 250V	2516-PG	2616-CG

¹All non-NEMA configurations are non-grounding

Product Dimensions:

15 / 20-Amp Straight Blade, 15-Amp Locking

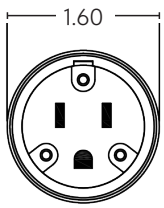

Typical Face

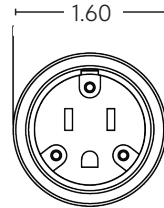
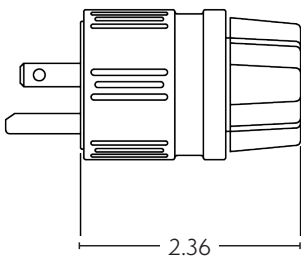

Typical Face

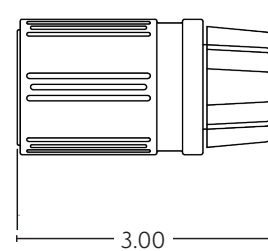

20-Amp Locking

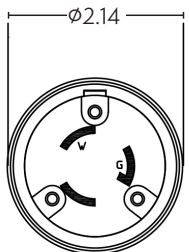

Typical Face

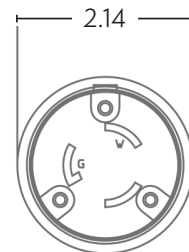
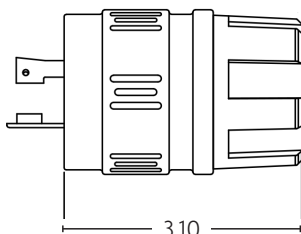

Typical Face

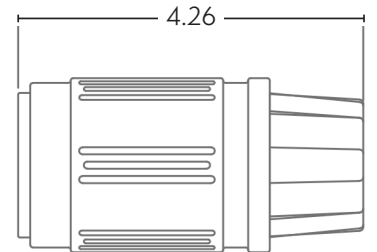

Related Products:



Perma-Spec
E515P, E515C



Perma-Link
1510-P, 1610-C



Hospital Grade
1530 PH, 1630 CH



SmartMonitor
AEGCP Compliant
1510-PML/GML, 1610-CML/GML



SmartMonitor
AEGCP Compliant
1510-PW6PL, 1610-CW6PL



Perma-Tite
IP69k Water Tight
1510-PW6P, 1610-CW6P



Perma-Kleen Antimicrobial
IP69k Water Tight
1510 PW6P-AM, 1610 CW6P-AM



Perma-Link 50A
CS 6365-P, CS 6364-C

Factory & Custom Assembled Cordsets:



Perma-Link Cordset



Perma-Tite Cordset



Perma-Kleen Cordset



Smart Monitor Cordset



ERICSON
SAFETY IS OUR STANDARD

Ericson Manufacturing Company
4323 Hamann Parkway
Willoughby, OH 44094, USA



1-800-374-2766
info@ericson.com
L1000877A