

SERIES 102 ERSADUR LONGLIFE SOLDERING TIPS

■ All i-CON stations with i-TOOL, i-TOOL NANO or i-TOOL PICO soldering iron

0102PDLF01/SB
pencil point, recessed, 0.1 mm \varnothing

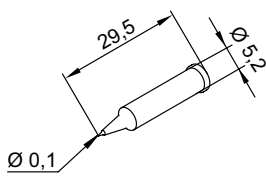

0102PDLF02/SB
pencil point, 0.2 mm \varnothing

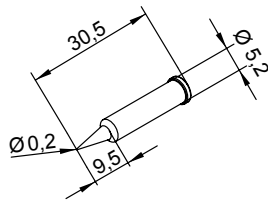

0102PDLF03/SB
pencil point, recessed, 0.3 mm \varnothing

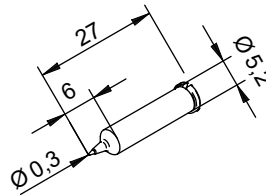

0102PDLF03L/SB
pencil point, extended, 0.3 mm \varnothing

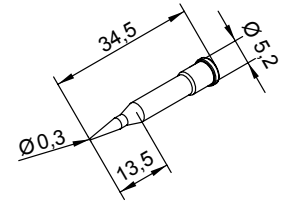

0102PDLF04/SB
pencil point, 0.4 mm \varnothing

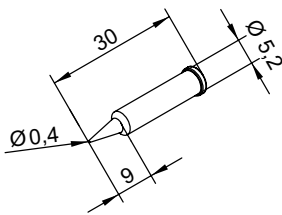

0102PDLF04L/SB
pencil point, extended, 0.4 mm \varnothing

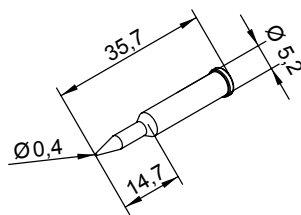

0102PDLF05L/SB
pencil point, extended, 0.5 mm \varnothing

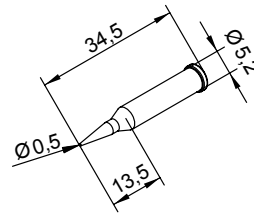

0102PDLF06/SB
pencil point, extended, 0.6 mm \varnothing

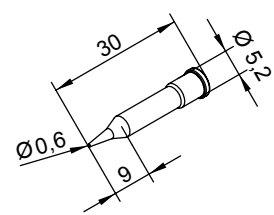

0102PDLF06L/SB
pencil point, extended, 0.6 mm \varnothing

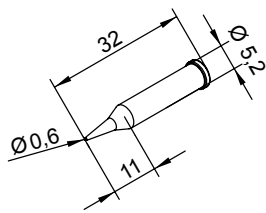

0102PDLF07/SB
pencil point, 0.7 mm \varnothing

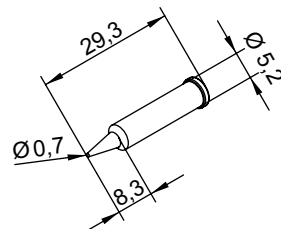

0102PDLF08L/SB
pencil point, extended, 0.8 mm \varnothing

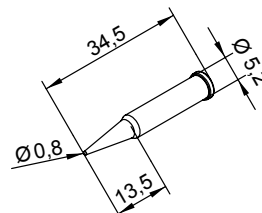

0102PDLF10/SB
pencil point, 1.0 mm \varnothing

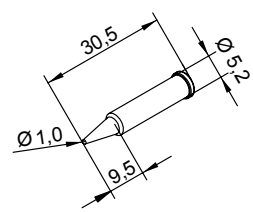

0102CDLF04/SB
chisel-shaped, 0.4 mm

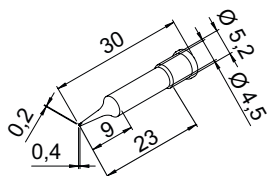

0102CDLF12/SB
chisel-shaped, 1.2 mm

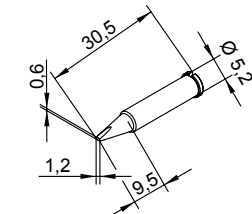

0102CDLF16/SB
chisel-shaped, 1.6 mm

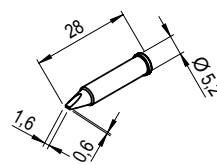

0102CDLF18L/SB
chisel-shaped, extended, 1.8 mm

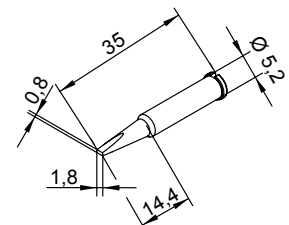

0102CDLF20/SB
chisel-shaped, 2.0 mm

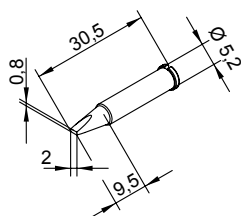

0102CDLF24/SB
chisel-shaped, 2.4 mm

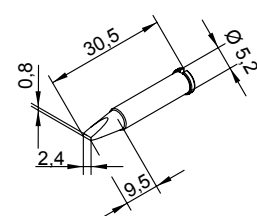

0102CDLF24L/SB
chisel-shaped, 2.4 mm

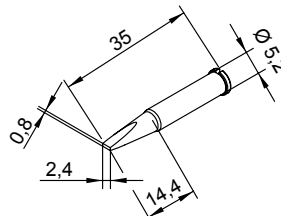

0102CDLF32/SB
chisel-shaped, 3.2 mm

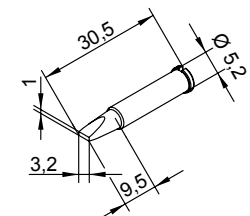

0102CDLF50/SB
chisel-shaped, 5.0 mm

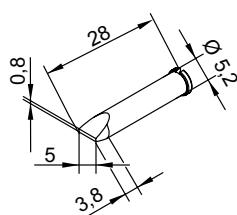

0102CDLF65/SB
chisel-shaped, 6.5 mm

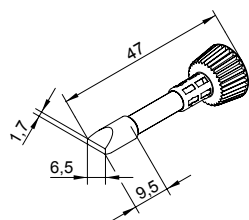

0102CDLF080C/SB
chisel-shaped, conical, 8.0 mm

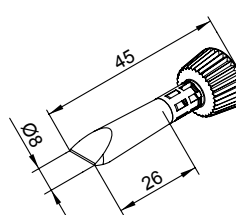

0102CDLF100/SB
chisel-shaped, 10.0 mm

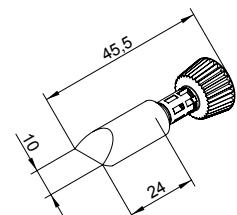

Dimensions without pre-tinning

SERIES 102 ERSADUR LONGLIFE SOLDERING TIPS

■ All i-CON stations with i-TOOL, i-TOOL NANO or i-TOOL PICO soldering iron

0102CDLF100C/SB
chisel-shaped, conical, 10.0 mm

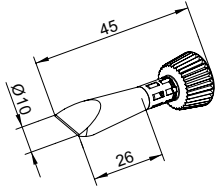

0102CDLF120C/SB
chisel-shaped, conical, 12.0 mm

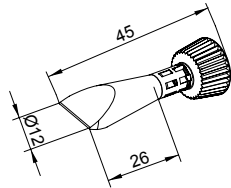

0102CDLF200/SB
angled face, 20.0 mm

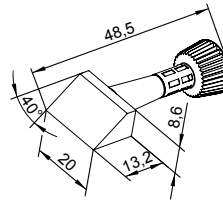

0102SDLF04/SB
pencil point, bent, 0.4 mm ϕ

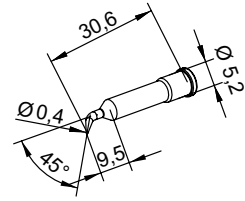

0102SDLF06/SB
pencil point, bent, 0.6 mm ϕ

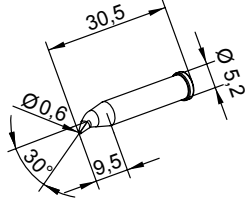

0102SDLF06L/SB
pencil point, bent, extended, 0.6 mm ϕ

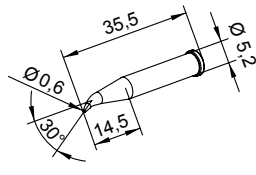

0102SDLF08L/SB
pencil point, bent, extended, 0.8 mm ϕ

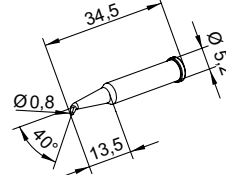

0102SDLF18/SB
chisel-shaped, bent, 1.8 mm ϕ

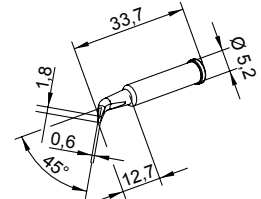

0102ADLF13/SB
angled face, 1.3 mm ϕ

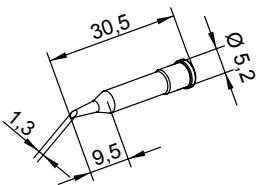

0102ADLF15/SB
angled face, 1.5 mm ϕ

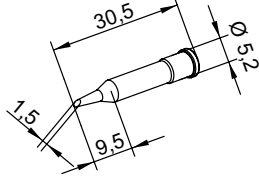

0102ADLF20/SB
angled face, 2.0 mm ϕ

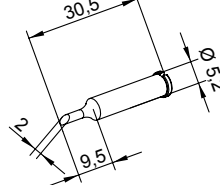

0102ADLF40/SB
angled face, 4.0 mm ϕ

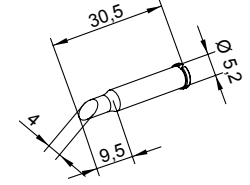

0102ZDLF100/SB
WICK-TIP, 10.0 mm

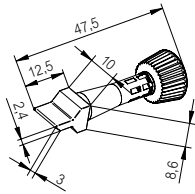

0102ZDLF150/SB
WICK-TIP, 15.0 mm

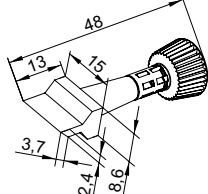

0102ZDLF200/SB
WICK-TIP, 20.0 mm

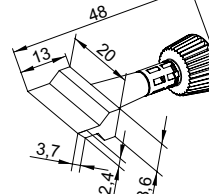

0102BDLF20/SB
PLCC blade

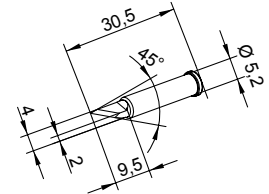

0102WDLF16/SB
PowerWell with concave portion, 1.6 mm ϕ

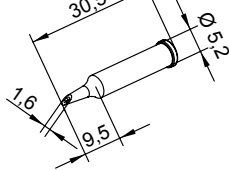

0102WDLF23/SB
PowerWell with concave portion, 2.3 mm ϕ

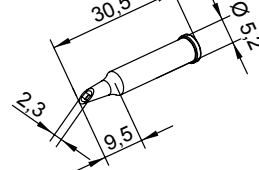

0102WDLF35/SB
PowerWell with concave portion, 3.5 mm ϕ

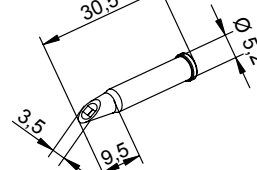

0102CDLF24A/SB
chisel-shaped, asymmetric, 2.4 mm

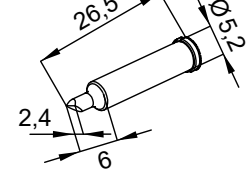

0102CDLF46A/SB
chisel-shaped, asymmetric, 4.6 mm

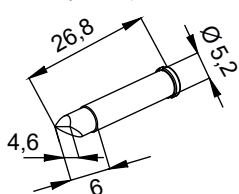

0102CDLF80A/SB
chisel-shaped, asymmetric, 8.0 mm

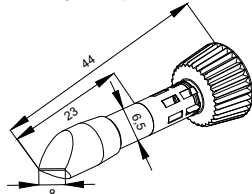

0102YDLF1224/SB
slotted, angled face, ID 1.2 mm, OD 2.4 mm

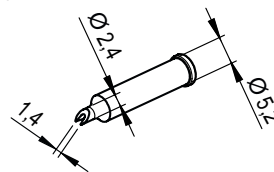

0102YDLF1852
slotted, angled face, ID 1.8 mm, OD 5.2 mm

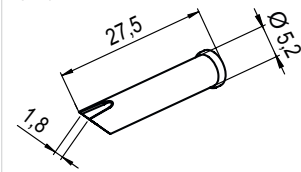

Dimensions without pre-tinning