

## SERIES 172 ERSADUR LONGLIFE SOLDERING TIPS

■ MULTI-TIP C25

### 0172BD/SB

ERSADUR, pencil point, 1.1 mm  $\phi$

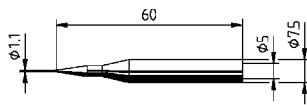

### 0172KD/SB

ERSADUR, chisel-shaped, 3.1 mm

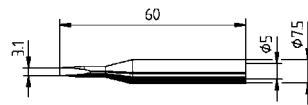

### 0172LD/SB

ERSADUR, angled face 45°, 4.1 mm

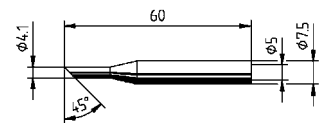

Dimensions without pre-tinning

## SERIES 162 ERSADUR LONGLIFE SOLDERING TIPS

■ MULTI-TIP C15

■ TIP 260

### 0162BD/SB

ERSADUR, pencil point, 1.1 mm  $\phi$

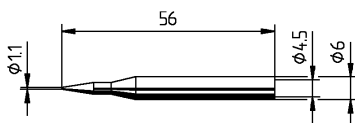

### 0162KD/SB

ERSADUR, chisel-shaped, 2.6 mm

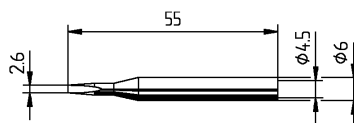

### 0162LD/SB

ERSADUR, angled face, 45°, 3.6 mm

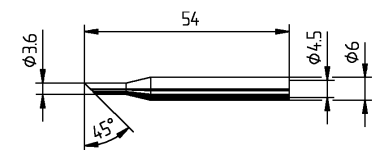

Dimensions without pre-tinning

## SERIES 472 HOT-AIR NOZZLES

■ i-CON VARIO 2 and 4 with i-TOOL AIR S hot-air iron

### 0472AR/SB

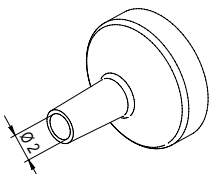

### 0472BR/SB

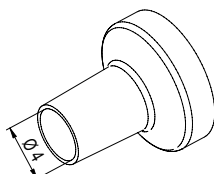

### 0472CR/SB

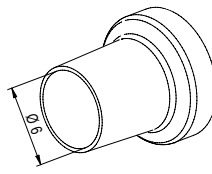

### 0472DR/SB

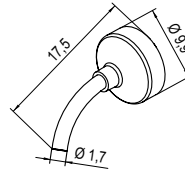

### 0472ER/SB

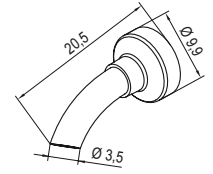

## SERIES G 072 & G 132 SOLDERING TIP

■ INDEPENDENT 75 gas soldering iron (series G 072)

■ INDEPENDENT 130 gas soldering iron (series G 132)

### 0G072CN/SB, 0G132CN/SB

chisel-shaped, 1.0 mm

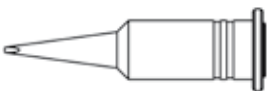

### 0G072KN/SB, 0G132KN/SB

chisel-shaped, 2.4 mm

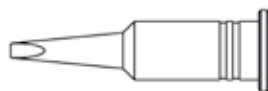

### 0G072AN/SB, 0G132AN/SB

chisel-shaped, 3.2 mm

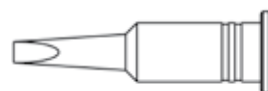

### 0G072VN/SB, 0G132VN/SB

chisel-shaped, 4.8 mm

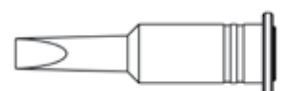

### 0G072BE/SB, 0G132BE/SB

flame nozzle



### 0G072HE/SB, 0G132HE/SB

hot gas nozzle

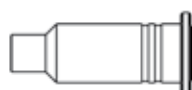

### 0G072RE/SB, 0G132RE/SB

deflector for hot gas nozzle  
0G072HE / 0G132HE to shrink  
heat shrinkable sleeves



### 0G072MN/SB, 0G132MN/SB

hot blade



Dimensions without pre-tinning