

---

# INSTALLATION INSTRUCTIONS

---

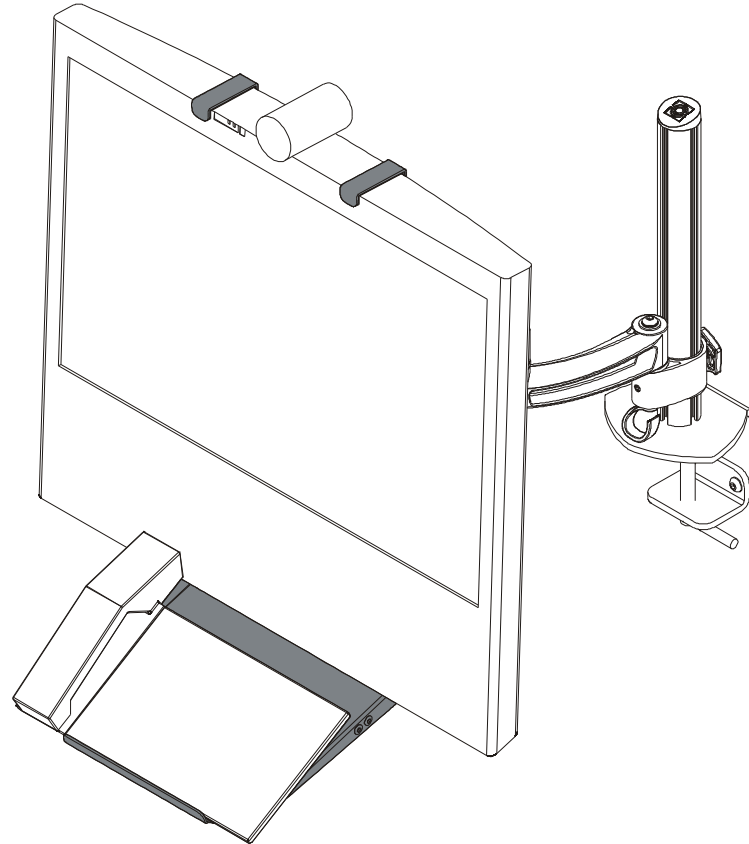

---

## Interface Bracket and Shelf Assembly

---

**Touchboards**

205 Westwood Ave, Long Branch, NJ 07740  
Phone: 866-94 BOARDS (26273) / (732)-222-1511  
Fax: (732)-222-7088 | E-mail: [sales@touchboards.com](mailto:sales@touchboards.com)

## DISCLAIMER

Milestone AV Technologies and its affiliated corporations and subsidiaries (collectively "Milestone"), intend to make this manual accurate and complete. However, Milestone makes no claim that the information contained herein covers all details, conditions or variations, nor does it provide for every possible contingency in connection with the installation or use of this product. The information contained in this document is subject to change without notice or obligation of any kind. Milestone makes no representation of warranty, expressed or implied, regarding the information contained herein. Milestone assumes no responsibility for accuracy, completeness or sufficiency of the information contained in this document.

Chief® is a registered trademark of Milestone AV Technologies. All rights reserved.

## IMPORTANT SAFETY INSTRUCTIONS

 **WARNING:** A WARNING alerts you to the possibility of serious injury or death if you do not follow the instructions.

 **CAUTION:** A CAUTION alerts you to the possibility of damage or destruction of equipment if you do not follow the corresponding instructions.

 **WARNING:** Failure to read, thoroughly understand, and follow all instructions can result in serious personal injury, damage to equipment, or voiding of factory warranty! It is the installer's responsibility to make sure all components are properly assembled and installed using the instructions provided.

 **WARNING:** Failure to provide adequate structural strength for this component can result in serious personal injury or damage to equipment! It is the installer's responsibility to make sure the structure to which this component is attached can support five times the combined weight of all equipment. Reinforce the structure as required before installing the component.

 **WARNING:** Exceeding the weight capacity can result in serious personal injury or damage to equipment! It is the installer's responsibility to make sure the combined weight of all components located between the FSB4090 up to (and including) the display does not exceed 35 lbs (15.9 kg) or the weight limit of the mount to which it is being attached.

 **WARNING:** Use this mounting system only for its intended use as described in these instructions. Do not use attachments not recommended by the manufacturer.

 **WARNING:** Never operate this mounting system if it is damaged. Return the mounting system to a service center for examination and repair.

 **WARNING:** Do not use this product outdoors.

**IMPORTANT ! :** The FSB4090 interface brackets are designed to be mounted to an already installed Chief K2 Series swing arm.

**--SAVE THESE INSTRUCTIONS--**

**DIMENSIONS**

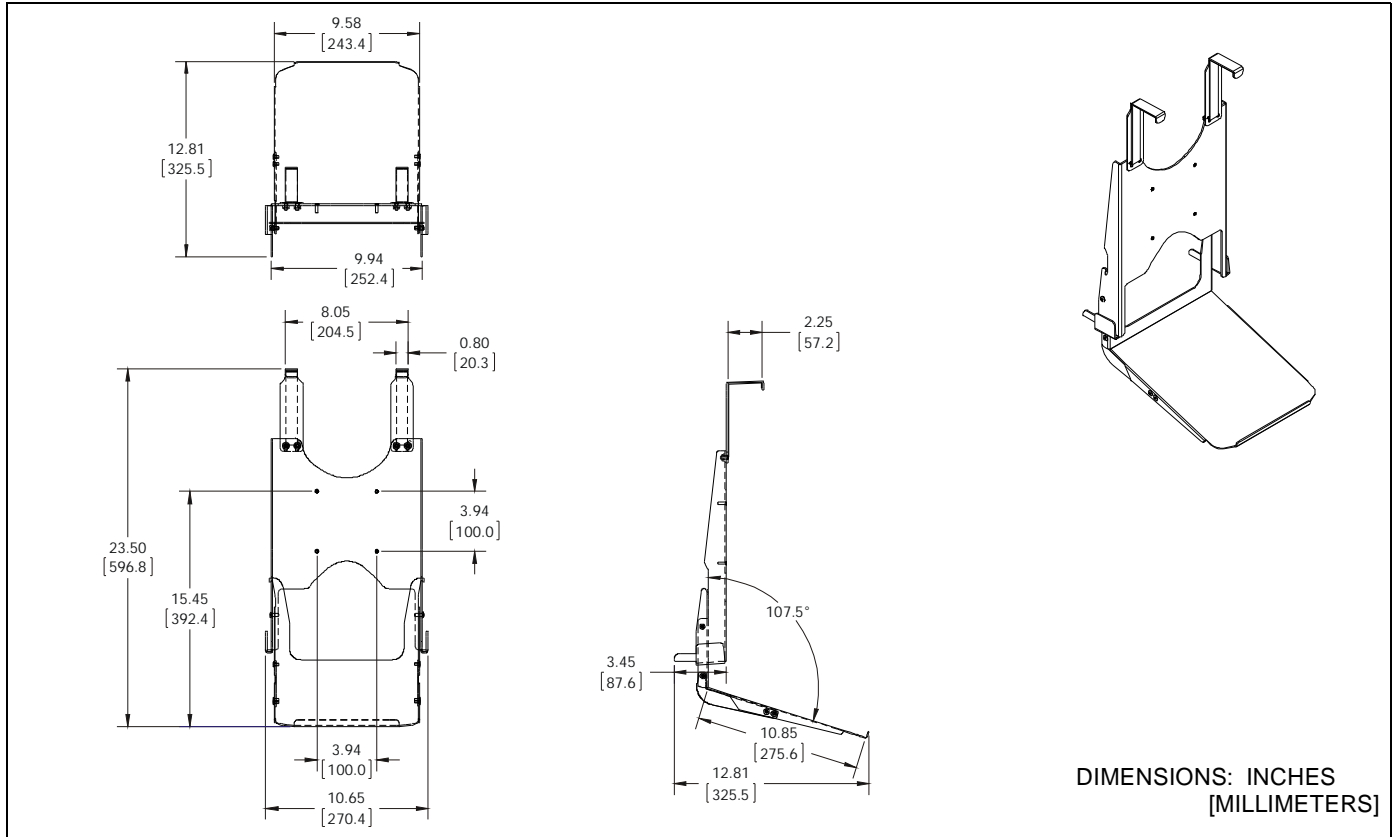

**LEGEND**

	<b>Tighten Fastener</b>		<b>Open-Ended Wrench</b>
	Apretar elemento de fijación		Llave de boca
	Befestigungsteil festziehen		Gabelschlüssel
	Apertar fixador		Chave de bocas
	Serrare il fissaggio		Chiave a punta aperte
	Bevestiging vastdraaien		Steeksleutel
Serrez les fixations	Clé à fourche		<b>Hex-Head Wrench</b>
	<b>Loosen Fastener</b>		Llave de cabeza hexagonal
	Aflojar elemento de fijación		Sechskantschlüssel
	Befestigungsteil lösen		Chave de cabeça sextavada
	Desapertar fixador		Chiave esagonale
	Allentare il fissaggio		Zeskantsleutel
	Bevestiging losdraaien	Clé à tête hexagonale	
Desserrez les fixations			

**TOOLS REQUIRED FOR INSTALLATION**

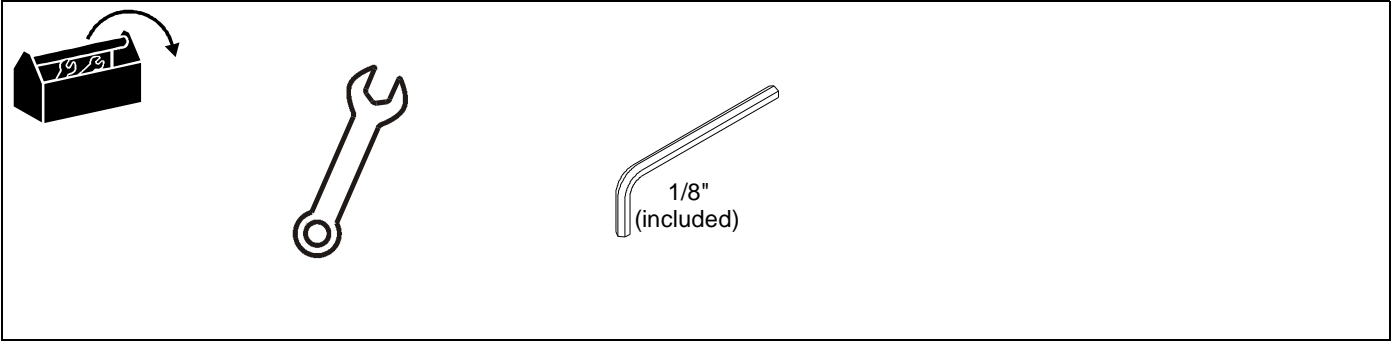

**PARTS**

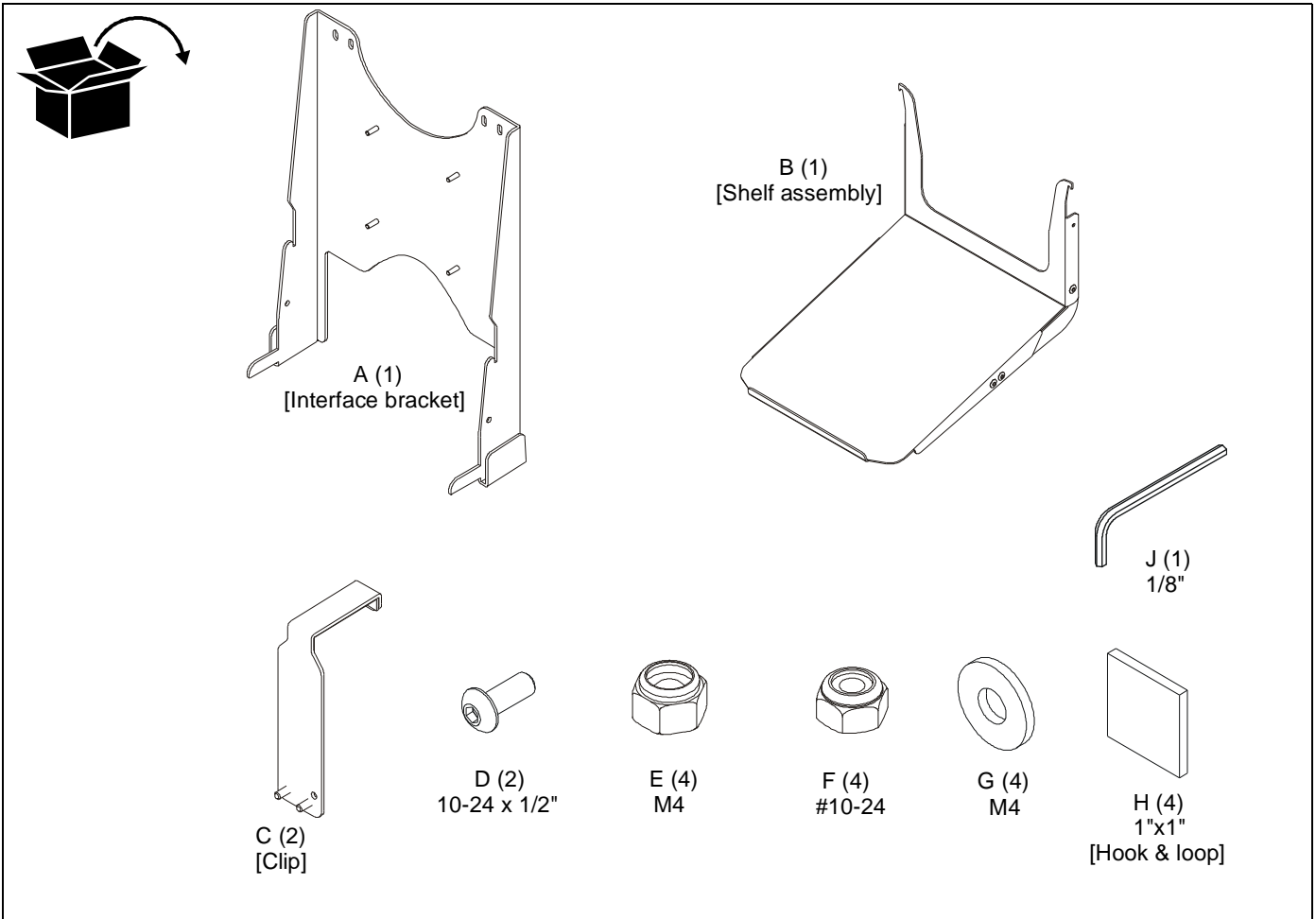

### ASSEMBLY AND INSTALLATION

**NOTE:** The following procedure assumes that a Chief K2 Series swing arm mount (not included) has already been installed following instructions included with the mount.

1. Hook two clips (C) over top of display, with long edge of clip on back of display. (See Figure 1)

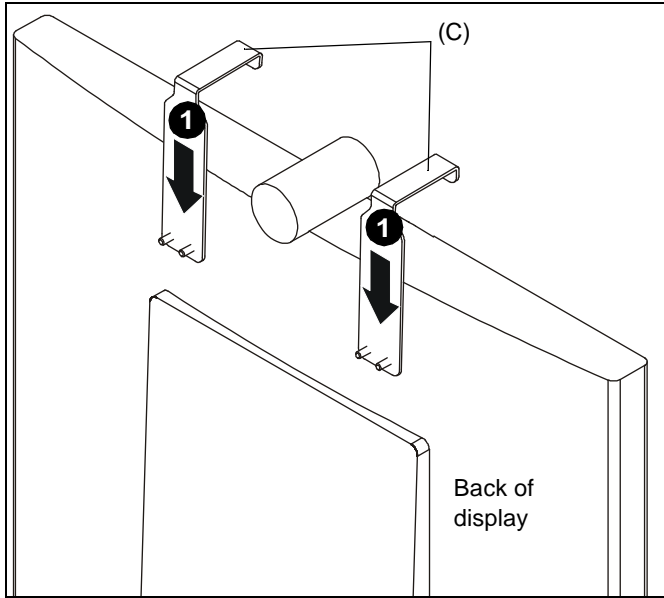

**Figure 1**

2. Slide interface bracket (A) up from bottom along back of display, ensuring that bottom of interface bracket hooks the extension bracket on back of display. (See Figure 2)
3. Hang interface bracket onto studs at bottom of clips (C). (See Figure 2)

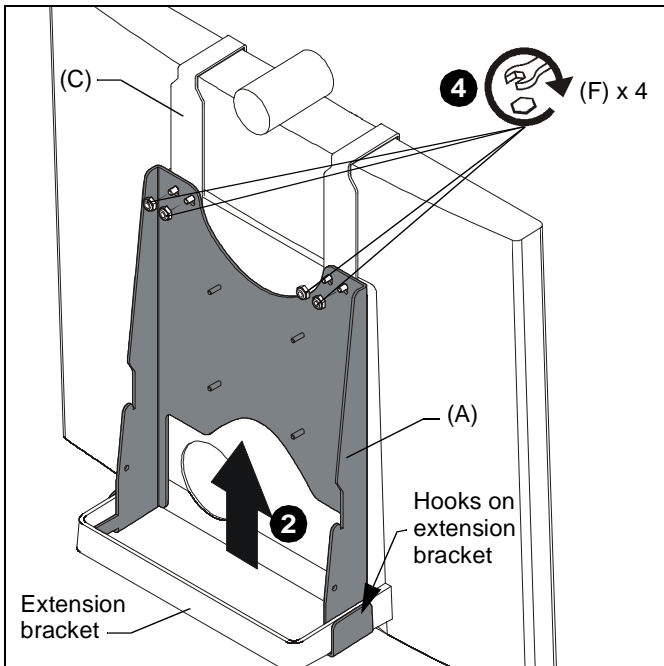

**Figure 2**

4. Fasten interface bracket to clips using four #10-24 locknuts (F). (See Figure 2)
5. Attach two M4 locknuts (E) and two M4 washers (G) to top two studs on back of interface bracket (A). Thread nuts completely onto studs and then back out three complete turns. (See Figure 3)

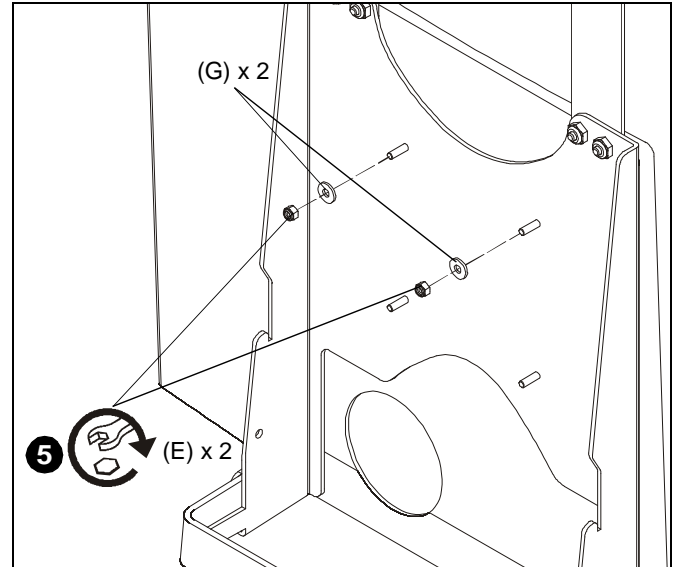

**Figure 3**

6. Lower interface bracket and display onto K2 Series mount faceplate by setting top two studs into top two mounting holes on faceplate. (See Figure 4)
7. Install two M4 locknuts (E) and two M4 washers (G) onto lower two studs on back of display. (See Figure 4)
8. Tighten all four locknuts (E). (See Figure 4)

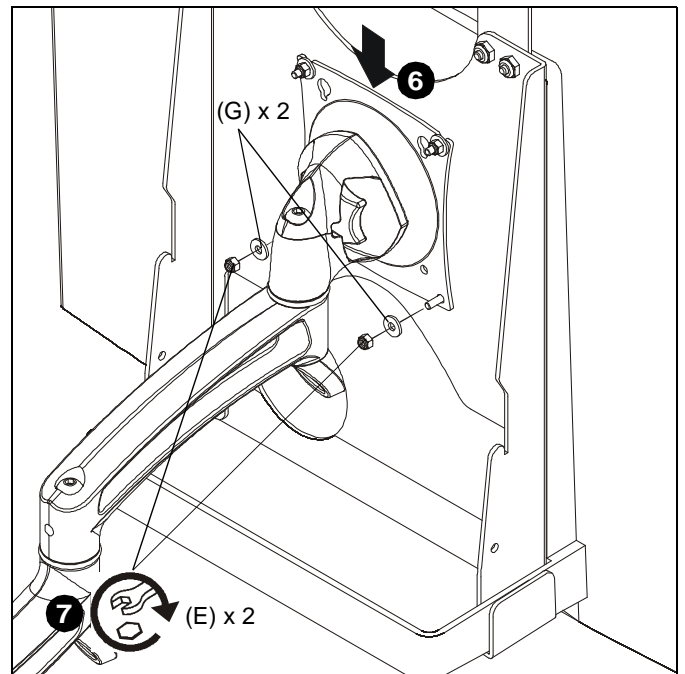

**Figure 4**

9. Lift shelf assembly (B) up from below display and hook onto interface bracket (A). (See Figure 5)

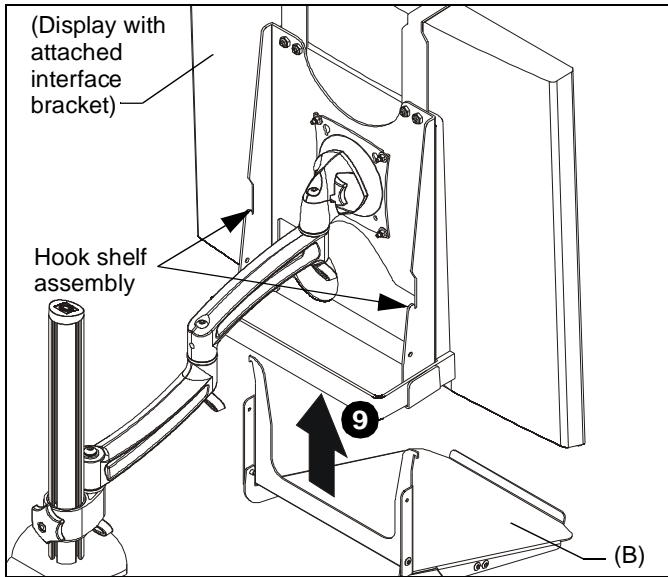

**Figure 5**

10. Fasten shelf assembly to interface bracket using two 10-24 x 1/2" buttonhead screws (D). (See Figure 6)

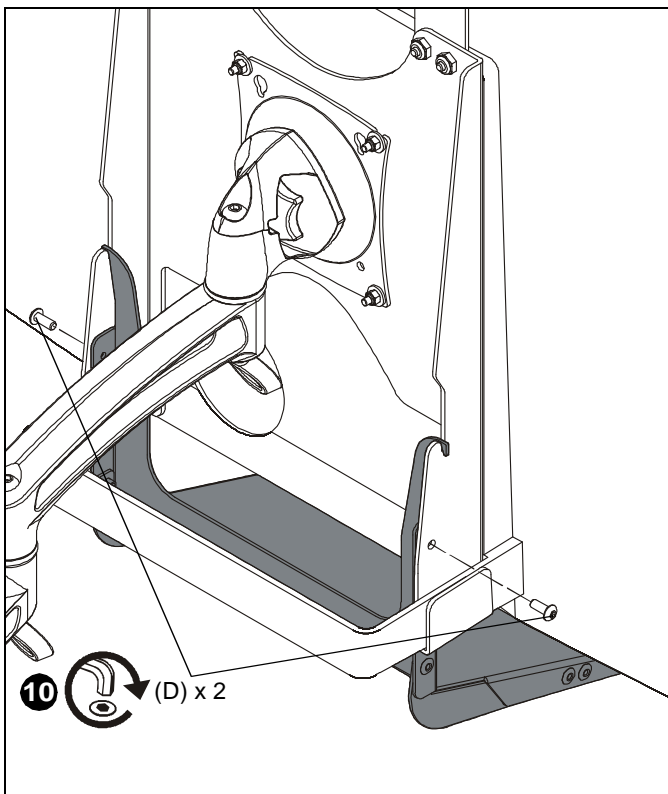

**Figure 6**

11. Put hook and loop (H) squares together so there are 2 squares.
12. Remove paper from one side of both of the squares.

13. Attach hook and loop squares to top of shelf assembly (B). (See Figure 7)

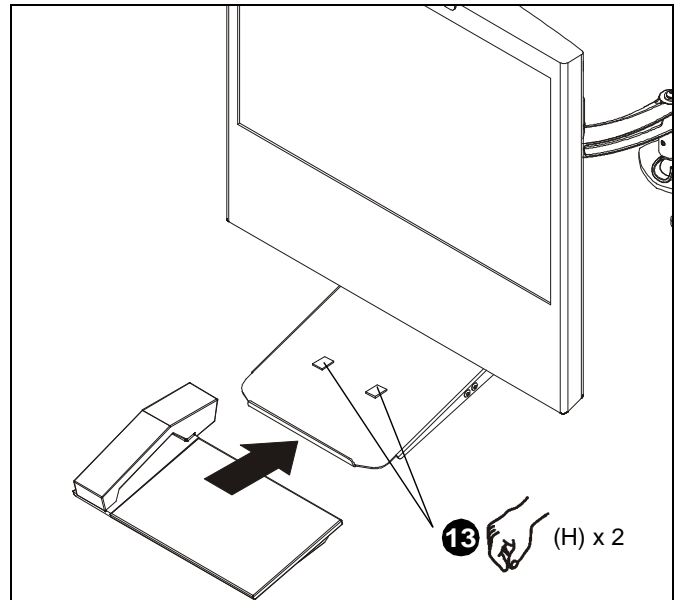

**Figure 7**

14. Remove paper from hook and loop squares and place remote phone on shelf assembly, pressing it against the hook and loop squares. (See Figure 8)

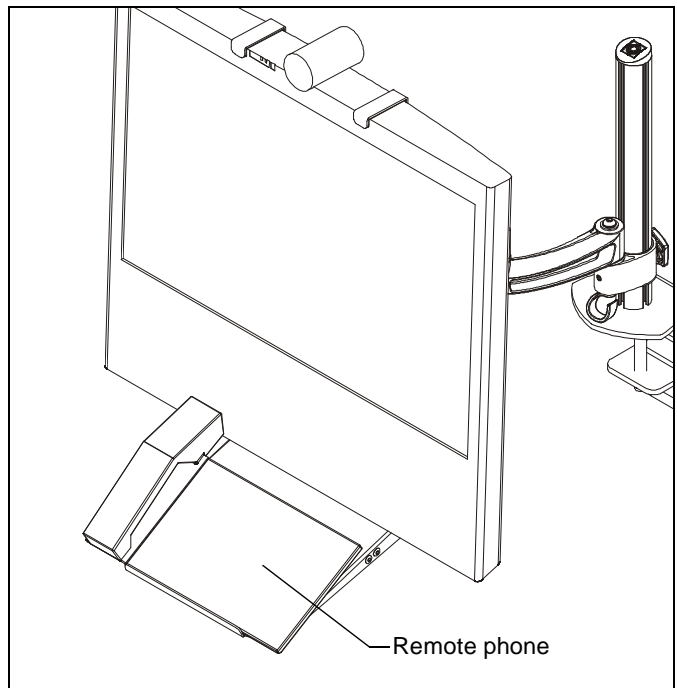

**Figure 8**





Our Mounts. **Your Vision.**

Chief Manufacturing, a products division  
of Milestone AV Technologies

8800-002367 Rev02  
©2013 Milestone AV Technologies, a  
Duchossois Group Company  
[www.chiefmfg.com](http://www.chiefmfg.com)  
05/13

<b>USA/International</b>	<b>A</b> 6436 City West Parkway, Eden Prairie, MN 55344 <b>P</b> 800.582.6480 / 952.225.6000 <b>F</b> 877.894.6918 / 952.894.6918
<b>Europe</b>	<b>A</b> Franklinstraat 14, 6003 DK Weert, Netherlands <b>P</b> +31 (0) 495 580 852 <b>F</b> +31 (0) 495 580 845
<b>Asia Pacific</b>	<b>A</b> Office No. 1 on 12/F, Shatin Galleria 18-24 Shan Mei Street Fotan, Shatin, Hong Kong <b>P</b> 852 2145 4099 <b>F</b> 852 2145 4477

