

Touchboards

205 Westwood Ave, Long Branch, NJ 07740
Phone: 866-94 BOARDS (26273) / (732)-222-1511
Fax: (732)-222-7088 | E-mail: sales@touchboards.com

nexus[®]
by Ghent

PARTITION ASSEMBLY INSTRUCTIONS

Models
NEX223MMP and NEX224MMP

 Before discarding the packaging, inventory the components and fasteners. (Some may be taped to the foam packaging.)

FASTENERS AND HARDWARE

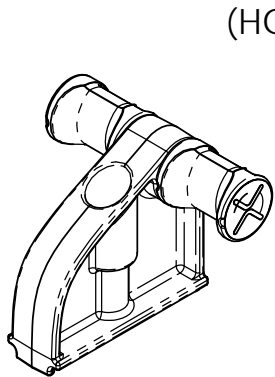

TABLET HANGER
2 EA.

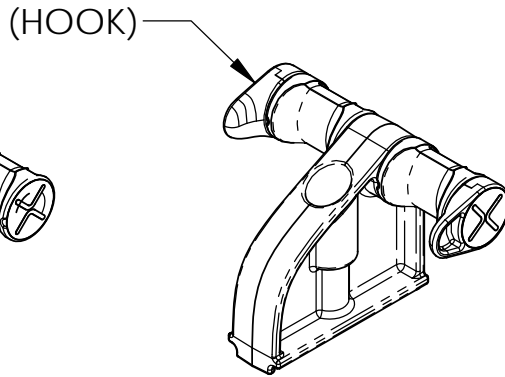

TABLET HANGER
(WITH HOOKS)
2 EA.

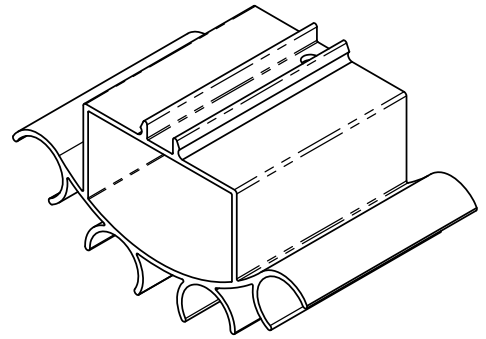

MARKER/ERASER
HOLDER
1 EA.

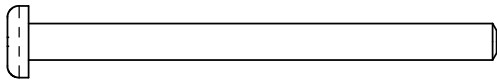

#10 X 2 1/2" PAN HEAD
MACHINE SCREW
5 EA.

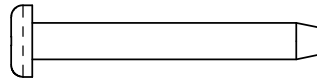

#10 X 1 1/2" PAN HEAD
MACHINE SCREW
2 EA.

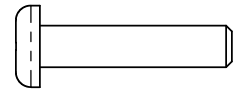

#12 X 1" PAN HEAD
MACHINE SCREW
8 EA.

(NEX224MP ONLY)

RECOMMENDED TOOLS:

CORDLESS DRILL - 12 VOLT OR BETTER

#2 AND #3 PHILLIPS SCREWDRIVER BITS

SCREWDRIVER BIT EXTENDER

PARTITION COMPONENTS

(NEX224MP SHOWN)

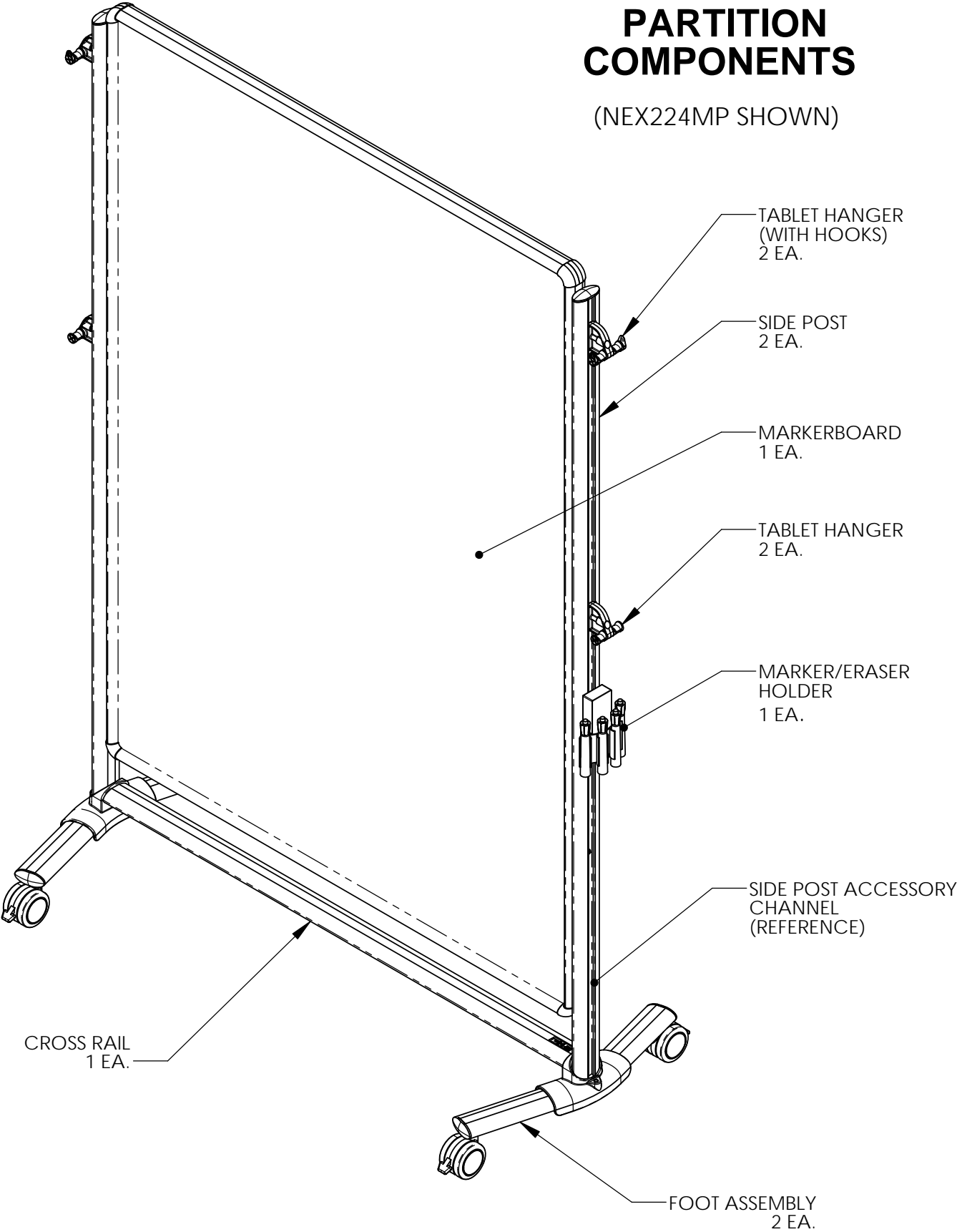

1 • Loosely attach the markerboard and the accent panel, with rails, to the side posts as shown.

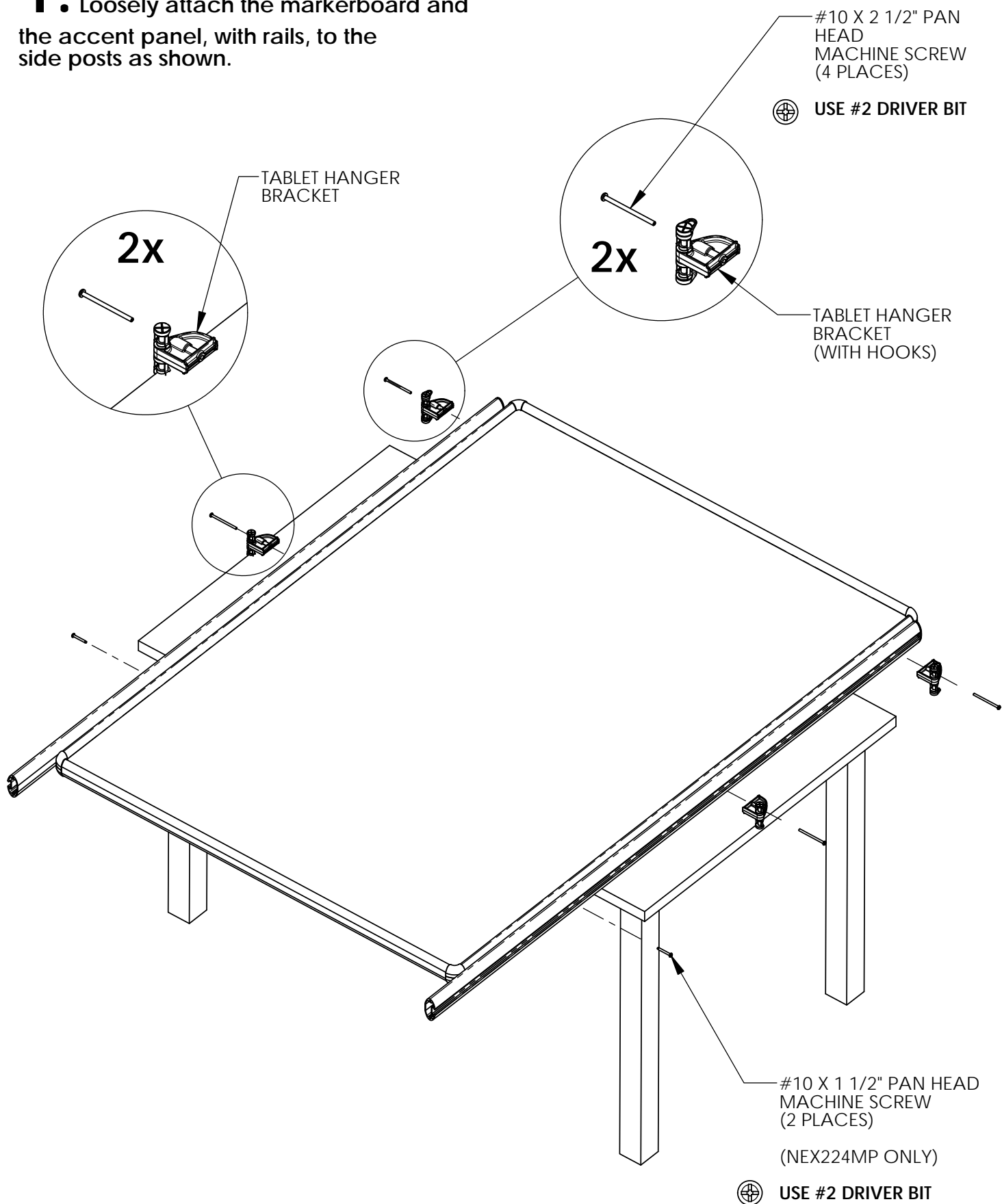

2. Attach the foot assemblies to the cross rail, as shown.

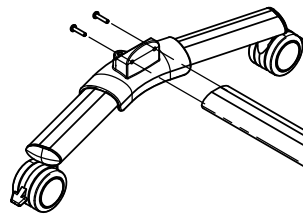

INSTALL WITH CHANNEL SIDE FACING DOWN

ASSEMBLE THE FEET ASSEMBLY ON A FLAT SURFACE, SO THAT THE CASTERS STAY LEVEL.

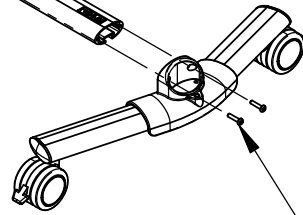

#12 X 1" PAN HEAD MACHINE SCREW (4 PLACES)

USE #3 DRIVER BIT WITH A BIT EXTENSION

3. Attach the feet assembly to the side posts, as shown.

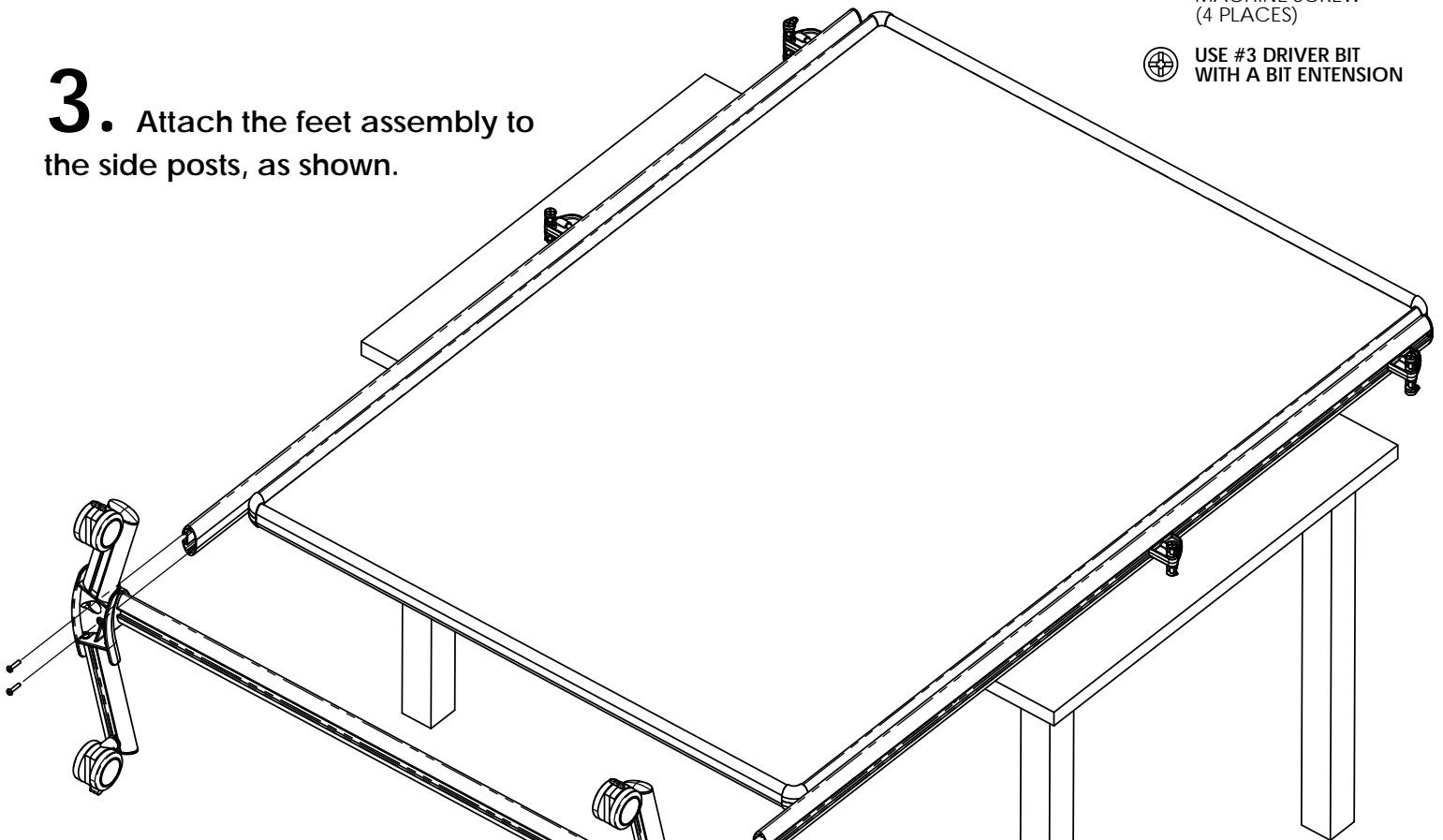

#12 X 1" PAN HEAD MACHINE SCREW (4 PLACES)

USE #3 DRIVER BIT

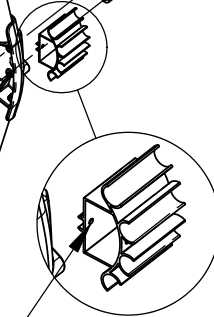

HOLE ORIENTATION

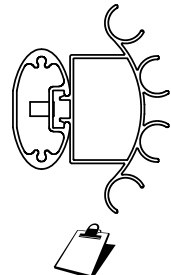

SLIDE THE MARKER/ERASER HOLDER INTO THE SIDE POST ACCESSORY CHANNEL BEFORE ATTACHING THE FEET ASSEMBLY.

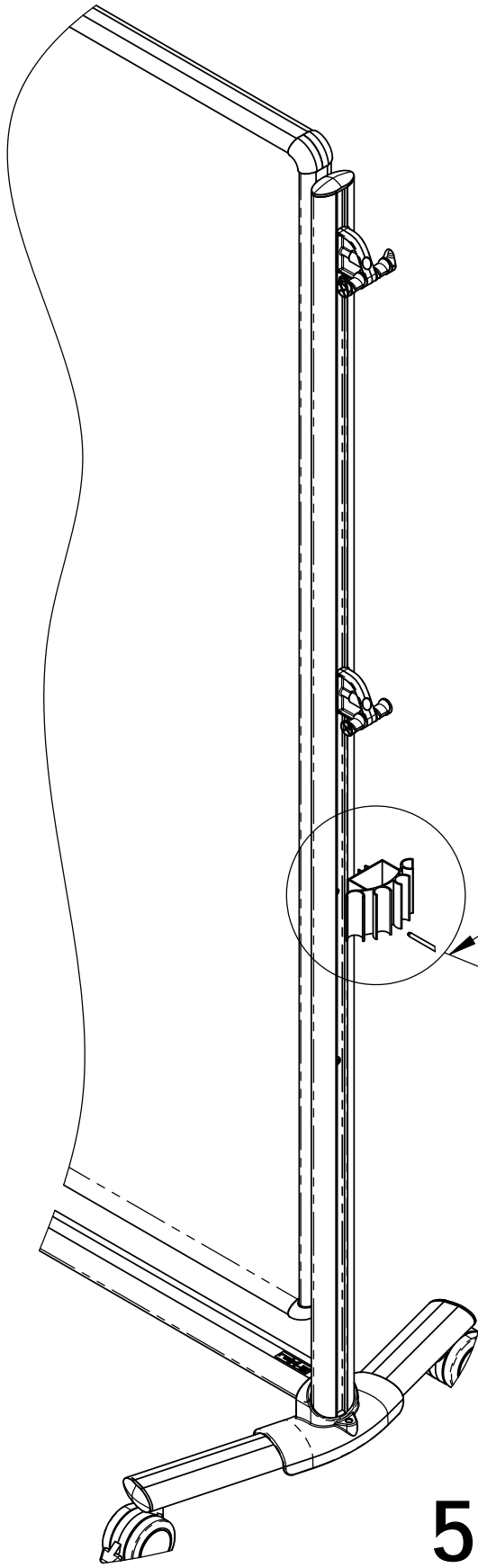

4. Slide the marker/eraser holder up into position below the lower tablet hanger and attach with the screw as shown.

#10 X 2 1/2" PAN HEAD MACHINE SCREW



USE #2 DRIVER BIT

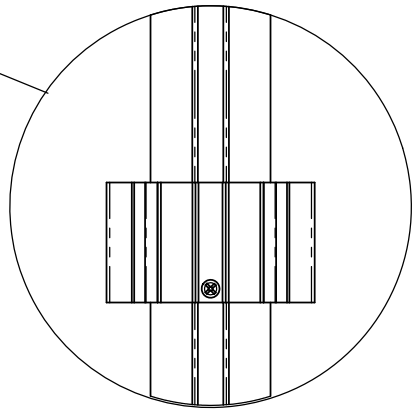

5. Tighten all screws to complete the assembly.