

# StarBoard

## Link EZ2 | Link EZ2-Pen



**THE PORTABLE Link EZ2 SERIES CAN MAKE ANY PROJECTOR AN INTERACTIVE SOLUTION**

### Link EZ2 Product Features



- Use your finger or a stylus pen to operate
- Includes 4 rails and 1 sensor for easy setup
- Supports multi-touch and multi-user input (up to 3)
- Expands to an active area of up to 90" diagonal

### Link EZ2-Pen Product Features



- Includes electronic-free pen
- Mounts magnetically for portability and secure storage
- Supports multi-user input (up to 3)
- Expands to an active area of up to 90" diagonal

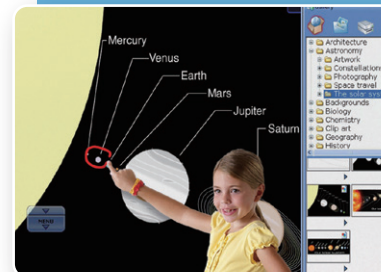

## Software Features

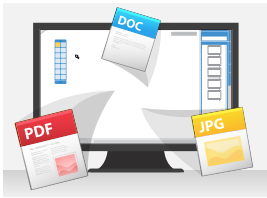

### IMPORT

Import a variety of documents into the software, including Microsoft® Office®, PDF, and multi-media files, enabling instant markup. Save your work to share with colleagues or for future use. You can also embed and annotate over motion video, adding dimension to your digital lectures and presentations.

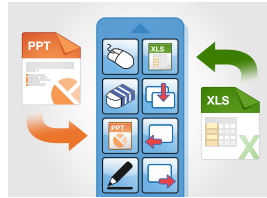

### CUSTOMIZE

Add external files and applications to the software toolbar, with the option to save it for future use. You can expand or collapse the toolbar and adjust its height and orientation based on your preference. Work in full-screen mode or add in multiple menu options for more accessibility.

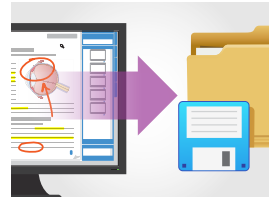

### ANNOTATE

With the StarBoard Software's virtual printer, you can transfer any file to your whiteboard page to review and markup with digital ink. The print to StarBoard feature gives you the option of editing and saving your work in a variety of file formats, such as JPEG, PDF, or PPT for ultimate compatibility.

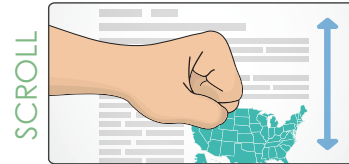

SCROLL

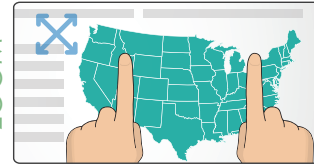

ZOOM

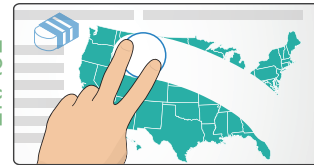

ERASE

### GESTURE

Operate the StarBoard intuitively using the built-in software gestures to zoom, right click, scroll or erase without the need to switch between tools or use the mouse.

## Specifications

Product Name	StarBoard Link E22	StarBoard Link E22-Pen
Model No.	AH00322	AH00336
Input Method	Infrared Image Sensor System	
Interface to Computer	USB 1.1, 2.0 compatible	
Active Area Size	60" – 77", 87" – 90" (aspect ratio 4:3) 60" – 72", 82" – 90" (aspect ratio 16:10)	60" – 90" (aspect ratio 4:3 / 16:10)
Dimensions	Digitizer: 510 mm(W) x 75.5 mm(H) x 41 mm(D) Reflective bars: 826 – 1,480 mm(W) x 24 mm(H) x 21 mm(D)	Digitizer: 510 mm(W) x 75.5 mm(H) x 41 mm(D) Pen: 140 mm x 15mm
Mass (weight)	Digitizer: 0.8 kg, Reflective bars: 0.8 kg / 4 bars	Digitizer: 0.8 kg, Pen: 15 g
Packing Dimensions	870 mm(W) x 90 mm(H) x 260 mm(D)	560 mm(W) x 88 mm(H) x 345 mm(D)
Packing Mass (weight)	approx. 3 kg	approx. 2.2 kg
Operating Specification	Temperature range: +5 – +35 °C, Humidity: 20 – 80% (without condensation)	
Certifications	FCC Class A, VCCI Class A, CE	
System Configuration		

## System Requirements

<b>Windows®</b>	
CPU	Intel® Pentium® 4 processor with 1.8GHz or higher
RAM	1GB or more is recommended
HDD	600MB of free space
Display Colors	32bits or more
Operating System (OS)	Microsoft Windows® XP 32bit / Windows® Vista 32bit / Windows® 7 32/64bit (latest service pack must be applied) (Tablet PC and Server Edition are not supported)
Software Required	StarBoard Software 9.42 or later
<b>Macintosh</b>	
CPU	Intel® CPU
RAM	1GB or more
HDD	600MB of free space
Display Colors	High Color (16bit) or more
Operating System (OS)	Mac OS X 10.5 / 10.6 / 10.7.4
Software Required	StarBoard Software 9.42 or later

• StarBoard is a registered trademark of Hitachi Solutions, Ltd. in Japan and other countries. • All other trademarks and trade names are the property of their respective owners.  
• All designs and specifications are subject to change without notice or obligation.

For questions and inquiries regarding our products and services, contact:

Hitachi Solutions, Ltd.

**Touchboards**

205 Westwood Ave, Long Branch, NJ 07740  
Phone: 866-94 BOARDS (26273) / (732)-222-1511  
Fax: (732)-222-7088 | E-mail: sales@touchboards.com