

# Mondopad™

**InFocus**  
Collaboration That Works

## Collaboration for Everyone

Work together better with the smart and easy touchscreen system for video conferencing, whiteboarding, data sharing and more.



Business meetings | Distance learning  
Brainstorming | Remote training | Interviewing  
Remote patient care | Software/website demos

[www.infocus.com](http://www.infocus.com)

# Mondopad™

Now with 2.0!

## In-room and remote visual collaboration made easy

InFocus Mondopad elegantly blends video calling, whiteboarding and more into one giant touchscreen PC for efficient face-to-face collaboration with people in any location.

Bridge communication gaps, strengthen teams, capture and share information, and save time and money. You'll never want to meet without it.



Generate, share and capture ideas

Bring teams together instantly from anywhere in the world

Get more done in less time with less cost and no travel

Captivate and collaborate with attendees in and out of the room



80-inch

70-inch

57-inch

### Key Features

- Big, bright 1080p touch display everyone in the room can see
- Native HD video calling and data sharing that's crystal clear
- Interactive whiteboard and on-screen annotation
- BYOD-friendly to connect and share with any device
- Built on a fast and flexible i7-based Windows PC
- Wireless keyboard and mouse included



**Save time** with one easy-to-use and -manage system. Start meetings right away with one device that is always on and ready for presenting, video conferencing, whiteboarding and annotation.



**Save money** by bringing people together anytime without expensive and time-consuming travel while still achieving the benefits of face-to-face interaction. See and hear personal intangibles, such as facial expressions and body language – making the sharing of ideas and collaboration more effective.



**Captivate audiences** in the room and around the world – with a bright HD multi-touch display that's so big everyone in the room can see it, and an adjustable HD camera and mic array that accurately captures the sights and sounds of the room.

“[Mondopad] has enhanced audio and video calling capabilities compared with SIP/H.323 conferencing systems costing five times as much.”

Dan Odom, instructional technology lead at Brenau University

“There is no doubt in our minds that businesses and educators could benefit greatly from a device like the Mondopad.”

DigitalTrends





See faces and content side by side with **dual-stream** video conferencing capabilities. You can even split them onto a **second touch display** – where one display shows participants' faces while the other shows content.

## Video Connect to the World

Instantly **bring people together** from anywhere in the world to visually collaborate on the same content and do better work in less time.

InFocus video calling service is included for the first year, so you can **make and receive video calls right away** – or add your own video conferencing client onto Mondopad like on any other PC.

Have **instant 4-way conversations** on a Mondopad when you upgrade to InFocus 121 Premium video calling service. **New!**

Bring up to 25 people together with an InFocus ConX Video Meeting room they can enter from a PC, Mac, tablet or smartphone.



## Bring Your Own Device

Participants can securely connect and share content with Mondopad from PCs, Macs, tablets or smartphones – making meetings more collaborative, productive and sustainable.

- Cast your device's screen to the Mondopad **New!**
- Control the Mondopad, such as advancing slides, web browsing or annotating, with your device from anywhere in the room
- See what's being presented on the Mondopad from your device
- People can also video-call your Mondopad from a PC, Mac, tablet or smartphone



Wide-angle HD camera and noise-cancelling microphone array accurately capture the sights and sounds of the room.

Speaker bars deliver clear voices and powerful multimedia to the whole room.

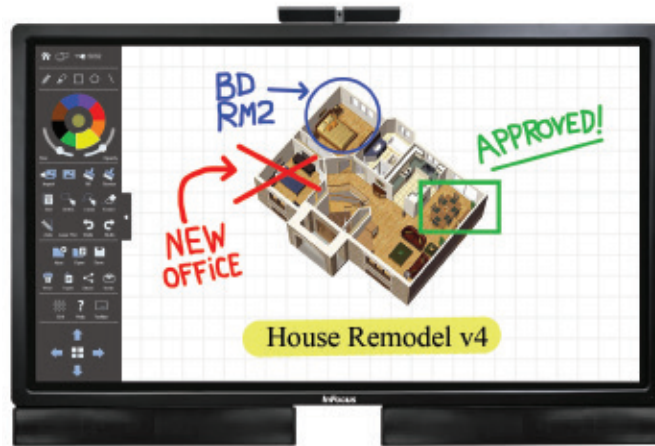
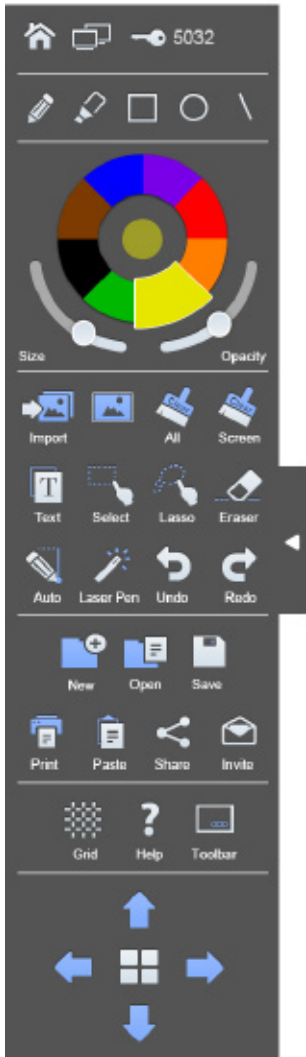

“You can underline, circle, cross out, tick, highlight and erase. And then save it all and/or email it. It’s brilliant.”  
Gearburn.com

## Whiteboard

Stop taking pictures of your stained, old-fashioned whiteboard and step up to the digital Mondopad. Brainstorm, capture and share your ideas on an interactive whiteboard without borders or barriers.

- A complete collection of digital pens, highlighters, shapes and lines in a spectrum of colors is at your fingertips
- Create a whiteboard on a canvas of up to 100 display screens in size
- Auto-shape the circles, squares and lines you draw for instant professionalism **New!**
- Paste backgrounds and images onto a whiteboard or wallpaper the entire canvas
- Collect, save and email info captured on the whiteboard right from the Mondopad
- Up to five people can draw at the same time

## Annotation

Never lose an idea. Quickly and easily take notes on anything you’re presenting and then save the changes.

- Use the same whiteboard tools to mark-up whatever you’re presenting
  - Presentations, spreadsheets, images, etc.
  - Web pages
  - Videos **New!**
- Save your notes as an image and email it directly from the Mondopad

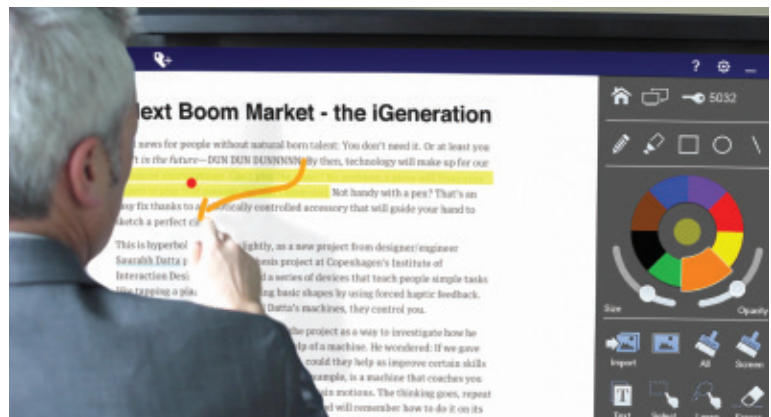

“With the unique ability of the Mondopad to draw and annotate, our personnel in their respective classrooms can see anything the instructor is talking about.”

Mike Heimbecker, Fire Inspector, Addison Fire Protection District

## Accessories / Solutions

InFocus products work together so you can collaborate effectively in and out of the conference room.

### Video and Audio Solutions

Provide and capture the best views and sounds in the room for efficient and clear communication.

**RealCam PTZ Camera** (INF-SPTZ-2): True HD 1080p resolution and pan/tilt/zoom with included remote control

**Thunder Speakerphone** (INA-TH150): VoiceAware anti-echo and noise-reducing technology for any size meeting room

**SIP2Phone Analog Speakerphone Bridge/Adapter** (INASIP2PHONE): Use your analog speakerphone for video calls on your Mondopad

**Polycom Speakerphone Adapter** (INF-POLYCBLE): Use your Polycom speakerphone for video calls on your Mondopad



RealCam PTZ Camera



Thunder Speakerphone

### Videoconferencing Solutions

Collaborate with multiple participants and share faces and data on-demand.

**ConX Video Meeting** Secure cloud-based video meeting rooms for up to 12 participants on nearly any device (get a FREE trial at infocusconx.com)

**121 Premium** (IN121PRM-1Y, IN121PRM-2Y, IN121PRM-3Y): Add 4-way videoconferencing and custom SIP address capabilities to your Mondopad. Upgrade from 121 Basic to 121 Premium with IN121PRM-UPG. Have SIP addresses with your domain name with IN121PRM-DOM.

**121 Basic** (IN121-1Y, IN121-2Y, IN121-3Y): Standard 2-way video call dial tone and SIP address (free for first year of Mondopad ownership)

**MVP100 Video Phone** (MVP100): Easy-to-use desk video phone for on-demand video communication from remote locations

### Display Solutions

Enhance the usability of Mondopad in the meeting room with these touchscreen solutions.

**JTouch** (INF5701, INF6501a, INF7001a): Extend your Mondopad's desktop to a second touch display and show two apps at once

**Q Tablet** (INP-120Q-ED, INP-120Q-PR): Follow or control your Mondopad from around the room with this full-featured 10.1-inch Windows 8.1 Pro tablet



Q Tablet

### Mounting Solutions

Mount your Mondopad on the wall or on a cart and roll it wherever it's needed to maximize its versatility.

MODEL	INF5720	INF7021	INF8021
Wall Mounts	INF-WALLMNT2, INF-WALLMNT3		INF-WALLMNT3
Mobile Carts	INF-MOBCART, INF-MOBCARTPRO-B		INF-MCART-PL
Floor Stand	INF-FLRSTND		N/A
Accessory Trays	INF-ACCYSHELF, INF-ACCYSHELFPRO-B		
Lift Assist Mounts	INA-MNTBB70	INA-MNTBB95	
Camera Shelves	INA-CARTBB, INA-SUPPORTBB, INA-VESABB		
	INF-PTZMNTU, INFPTZMNTL (attach to display)		
	INF-VIDSHELF2 (attach to INF-WALLMNT2, INF-WALLMNT3, INF-MOBCARTPRO-B or INF-MCART-PL)		
	INF-VIDSHELF (attach to INF-MOBCART or INF-FLRSTND)		N/A
ATA Lift Cases	CA-ATALIFT55	CA-ATALIFT70	N/A

### Warranty, Maintenance and Training Services

Get the most out of your Mondopad and protect your investment with these valuable services.

MODEL	INF5720	INF7021	INF8021
Extended Hardware Warranty Plans	EPWHW57MP1	EPWHW70MP1	EPWHW80MP1
	EPWHW57MP2	EPWHW70MP2	EPWHW80MP2
Extended Premium (Warranty & Software) Plans	EPWPRE57MP1	EPWPRE70MP1	EPWPRE80MP1
	EPWPRE57MP2	EPWPRE70MP2	EPWPRE80MP2
Software Maintenance Plans	EPWSOFTPLAN1, EPWSOFTPLAN2		
Training Services	INF-VT2, INF-VT4		



# Specifications\*

DISPLAY	INF5720	INF7021	INF8021
Size	57"	70"	80"
Resolution	Full HD 1920 x 1080		
Anti-Glare	No		Yes & Gorilla Glass
Refresh Rate	120 Hz		
Viewing Angle	176°		
Technology	LED edge-lit LCD		
Pixel Pitch	0.67 mm	0.63 mm	
Response Time	9.5 ms	6 ms	4 ms
Contrast Ratio	5000:1		4000:1
Brightness	370 cd/m <sup>2</sup>		350 cd/m <sup>2</sup>
Video Input Compatibility	Full NTSC, 480i, 480p, 720p, 1080i, 1080p		
Inputs	HDMI x 2, VGA (HD15 VESA), component, RS232, 3.5mm stereo audio in, RCA stereo audio in, 3.5mm microphone in, USB Type-B to touch screen controller board		
Outputs	RCA stereo audio out (for sound bars), 3.5mm stereo out		
Touch Screen	Edge-to-edge multi-touch system with support for 5 point gestures		
Speakers (Integrated)	Stereo 7W x 2		
Power	AC 100 to 240V, 50/60Hz		
Mount	VESA standard 400 x 400mm, M6 screws		VESA standard 400 x 600mm M6 screws

PC	INF5720	INF7021	INF8021
Processor	Intel® Core i7-4770T, Q87 chipset		
Memory	8 GB RAM		
Hard Drive	SSD 120GB		
LAN (2x)	802.3 10/100/1000 Base-T with Wake on LAN		
Wi-Fi	Dual band 802.11 a/b/g/n MIMO PCIe half mini card, 2.4 GHz with Intel, AMT support		
Input Connections	USB Type-A x 7 (4 on side of display, 1 on top of display (used by camera), 2 on PC), Ethernet (RJ45 x 2)		USB Type-A x 6 (3 on side of display, 1 on top of display (used by camera), 2 on PC), Ethernet (RJ45 x 2)
Output Connections	HDMI out		
Bluetooth	4.0		
Operating System	Windows 7 Pro 64bit, compatible with Windows 8		
Included Software	Microsoft Office Home & Business 32bit, Mondopad interface software		

SYSTEM	INF5720	INF7021	INF8021
Product Dimensions (with top camera & bottom soundbars)	56.7 x 3.7 x 40.7 in / 1388 x 91 x 998 mm	65.7 x 4 x 45 in / 1669 x 102 x 1143 mm	74.8 x 4 x 50.3 in / 1900 x 101 x 1278 mm
Product Weight	139.5 lbs / 63.3 kg	170 lbs / 77.1 kg	190 lbs / 86.2 kg
Shipping Dimensions	63.5 x 10 x 42.5 in / 1613 x 254 x 1080 mm	73 x 10.5 x 49 in / 1854 x 267 x 1245 mm	83.5 x 10.5 x 53.5 in / 2121 x 267 x 1359 mm
Shipping Weight (monitor, PC & camera)	154 lbs / 70 kg	173 lbs / 78.5 kg	203 lbs / 92.1 kg
(soundbars)	17.4 lbs / 7.9 kg	17.4 lbs / 7.9 kg	17.4 lbs / 7.9 kg
Soundbars Shipping Dimensions	30.4 x 12.3 x 6.7 in / 772 x 313 x 169 mm		
Accessories Included**	Wireless keyboard (where allowed), wireless mouse (where allowed), stylus, VGA cable, USB cable, security screws, security screw removal tool, power cord, remote, quick setup guide, sound bar assembly, camera assembly, foot assembly (feet included with INF5720 only)		
Warranty	1 year limited, extended warranties available		
Operating Temperature	41 to 95°F at 0 to 10K ft / 5 to 35°C at 0 to 3,048 m		
Power Consumption	250W max	275W max	350W max
Noise	<40dBA @ 77°F / 25°C		
Interface Languages	English, German, French, Italian, Spanish, Simplified Chinese, Traditional Chinese, Korean, Vietnamese, Japanese, Malay, Bahasa		

## Video Conferencing

### Video call types

SIP, H.323, Skype, Lync

### Codecs

Audio: CN 16k, CN 8k, G.722, G.722.1 baseline (24 kbps), G.722.1 baseline (32 kbps), G.722.1C (24 kbps), G.722.1C (32 kbps), G.722.1C (48 kbps), PCMA (ALow), PCMU (ULow), H.224 (telephone-event), x-msrta 16k, x-msrta 8k, G.729AB

Video: H.263, H.263+, H.263++, H.264 AVC packetization 0 and 1, XVD, x-msrvt

## Camera and Microphones

Resolution: 1280 x 720

Frame rate: 30 fps at HD with H.264+YUV (2-way)

Lens and Field of View: 70° horizontal, 56° vertical, F/2.0, 3P Lens; FOV(D) 56.8° in HD mode, FOV(D) 50° in VGA mode 1.0x zoom, FOV(D) 30° in VGA mode 1.6x zoom

Audio support: 3 built-in Unidirectional microphones

Interface: USB 3.0 High Speed

Focus: Auto focus

Tilt: Manual up/down and left/right ±40°

## Soundbars

Power: 100 – 240 volts AC, 50 – 60Hz

Speaker Drivers (L&R Channel): Two 3" and one

3/4" Aluminum Neodymium Tweeter (per side)

Power Output (RMS): 25 watts/channel @ 1%

THD, 1KHz, 2-channels drive, 70 watts total

system PEAK

Frequency Response: 90 Hz to 20 KHz

**InFocus**  
Collaboration That Works

Learn more at  
[www.infocus.com/mondopad](http://www.infocus.com/mondopad)  
or contact your reseller

Get a live online demo at  
[www.infocus.com/mondopad-live-demo](http://www.infocus.com/mondopad-live-demo)

\* Product specifications, terms, and offerings are subject to change at any time without notice.

\*\* Keyboard, mouse and/or speaker bar may not be shipped to all countries.