

JBC

The Soldering Co.



DKR

All-in-one Selective Soldering Equipment

DKR

All-in-one Selective Soldering Equipment

Desktop Robot for automation processes with high repeatability and excellent performance.

This complete soldering system covers all requirements: accurate tip temperature, soldering time control, solder wire feeding, tip cleaning; all controlled by the teach pendant provided as standard equipment.

There are two models available: 245 for general soldering and 470 for heavy duty.



Easy configuration through intuitive menu and real-time tip temperature monitoring. Different working temperatures can be selected during the same application to achieve the best soldering quality on each soldering point.

Best tool for production

DKR Robot is a cost-effective way to standardize and improve production quality.

RBA Soldering Head

Two independent automatic movements through pneumatic actuators.

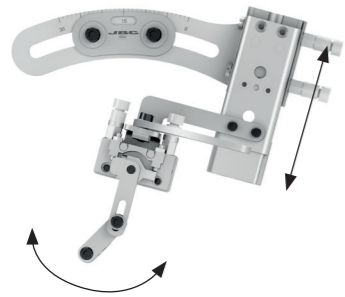

TR General Soldering Tool

A precise positioning system allows quick cartridge replacement, aligning the tip without the need for calibration.

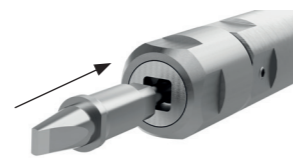

SFR Solder Feeder for Robot

Automatic solder wire feeding according to customized speed and length, featuring a wire detector sensor.

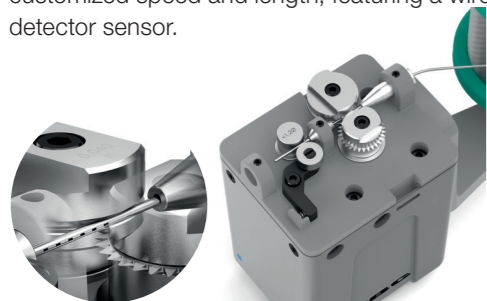

CLMRP Automatic Tip Cleaner

Non-metal Brush Tip Cleaner with a large capacity tank with easy extraction and adjustable position.

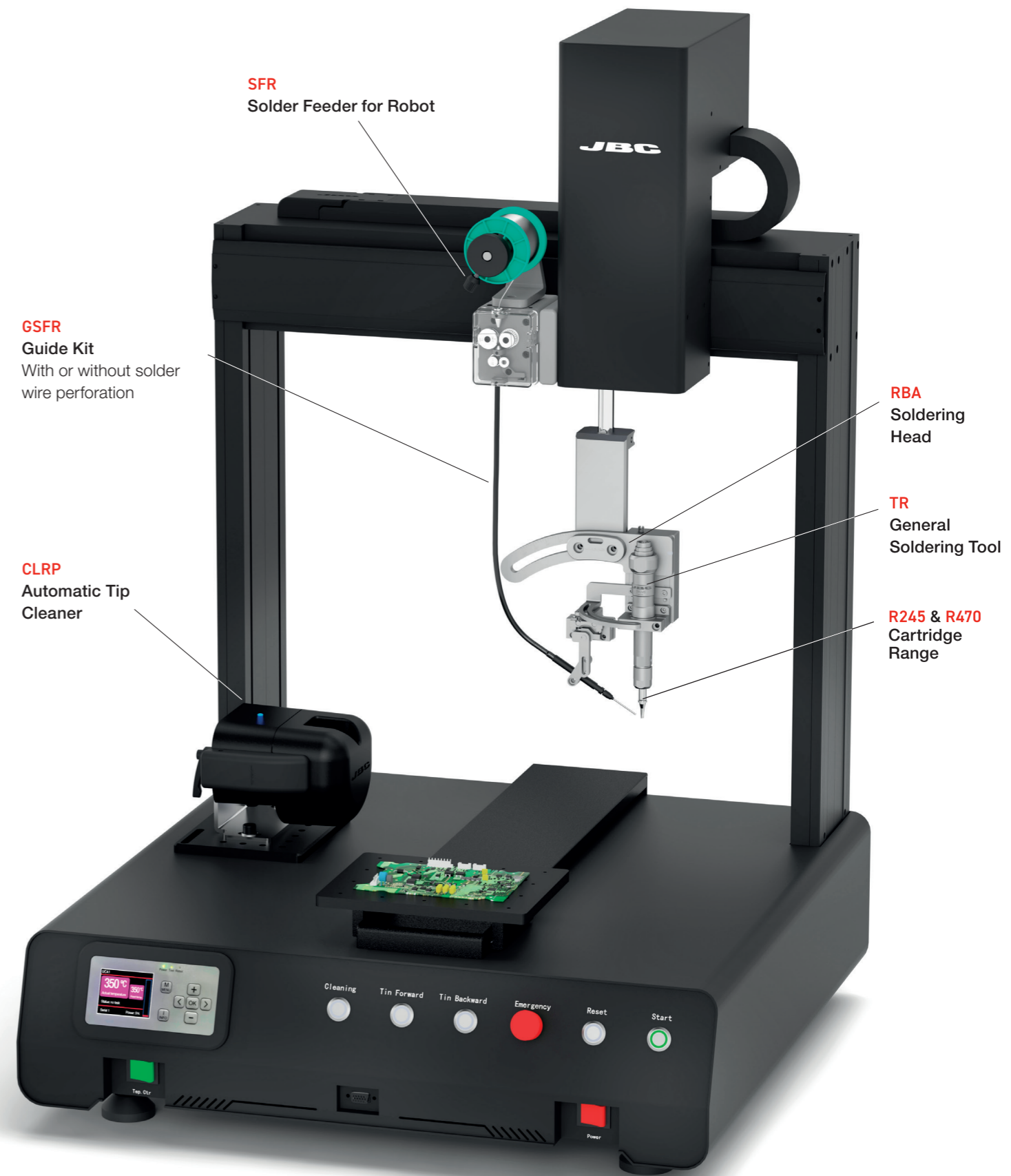

The robot XY axis travel range can be customized and 2 Y axis versions are available, so the operator can set up the next production item while the robot is soldering. This reduces production dead times. In addition, a CCD combined with an industrial computer can be installed for complex applications in which computer vision is needed for a proper soldering job.

Console

- Equipped with:
 - Interactive user-friendly interface
 - Data transfer function between robots
- Configuration of soldering joint temperature and solder wire length
- Available in English and Chinese
- Teach pendant functions:
 - Configuration of soldering point parameters: tip temperature, solder amount, soldering time, etc.
 - Information shown on the screen:
 - Product processing status
 - Successful solder joint rate
 - X,Y,Z,R-axis positioning
 - Configuration of I/O ports
 - Configuration of system parameters: operation, location, speed, equipment, etc.
 - Keyboard Shortcuts for easy program editing:
 - Function keys: insert, delete, cursor movement, etc.
 - Robot program run and pause
 - Software menu navigation



Specifications

ITEM NAME		DKR
Model		DKR-2A
Number of Axes		4 axes
Travel Range	X, Y axes	400 mm
	Z axis	95 mm
	R axis	±360°
Operation Speed	X, Y axes	500 mm/s
	Z axis	500 mm/s
	R axis	200 mm/s
Repetitive XYZ axis positioning accuracy		±0.05 mm
Transportable weight	X, Y axis	10 Kg
	Z axis	3 Kg
Power Supply		AC 240V 50/60 Hz
External dimensions	W	650 mm
	D	660 mm
	H	980 mm
Weight		78 Kg

ITEM NAME	SOLDERING TOOL	
Model	UCR245-5A	UCR470-5A
Tool	TR245-B	TR470-B
Cartridge Range	R245	R470
Output Peak Power	160 W	250 W
Tip-to-ground Resistance	<2 Ω	<2 Ω
Selectable temperature	90 to 450 °C	90 to 500 °C
Solder Feeder	SFR-B	
Solder wire diameter	0.5 to 1.5 mm	
Solder wire feeding length	0.5 to 250 mm	
Solder wire feeding speed	0.5 to 120 mm/s	
Cleaning System	CLMR-PA	

Cartridge Range

More than 46 different tip shapes. Desktop Robot is fully compatible with **R245** and **R470** Cartridge Range.

