

# 16 WAYS TO COOL HEAD, FACE, AND NECK:

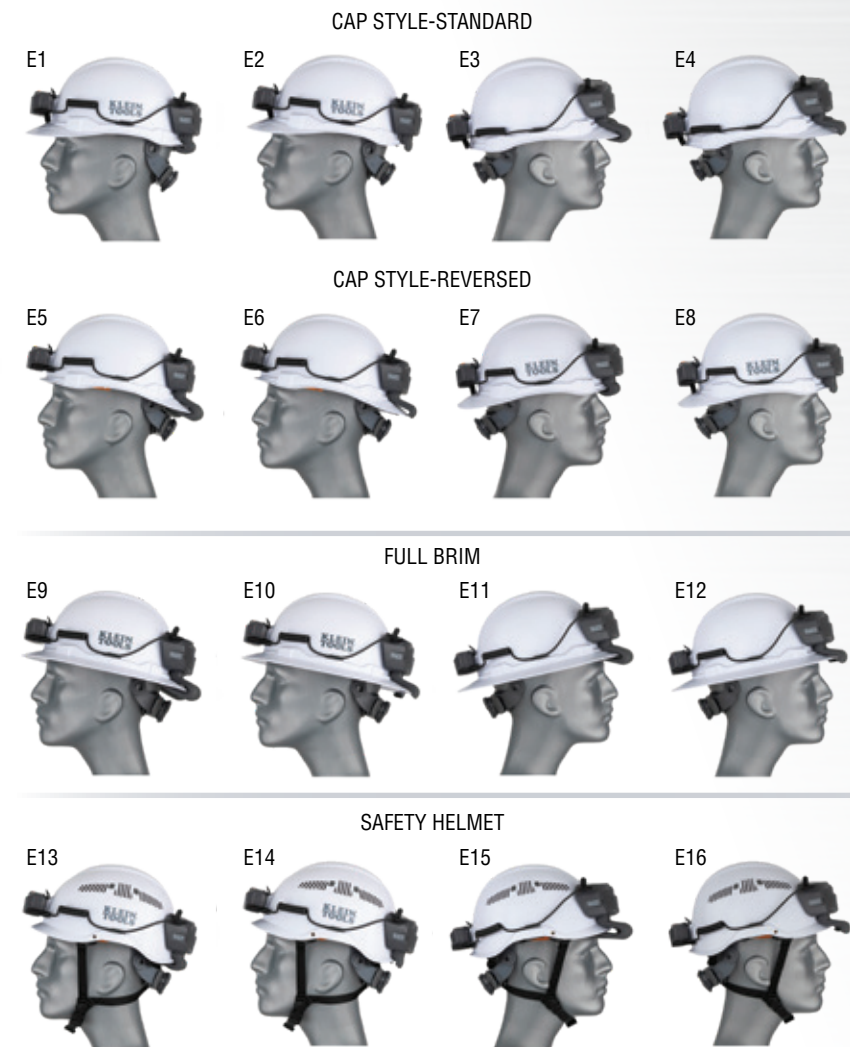

Setup Fig.	Shell Type	Bill Position	Duct Style	Fan: Front	Fan: Back	Airflow Focus
<b>CAP STYLE</b>						
E1	Cap Style	Standard	Short Duct w/clip		●	Inside Shell
E2	Cap Style	Standard	Short Duct w/o clip		●	Neck
E3	Cap Style	Standard	Long Duct w/clip	●		Inside Shell/Forehead
E4	Cap Style	Standard	Long Duct w/o clip	●		Face
E5	Cap Style	Reversed	Long Duct w/clip		●	Inside Shell
E6	Cap Style	Reversed	Long Duct w/o clip		●	Neck
E7	Cap Style	Reversed	Short Duct w/clip	●		Inside Shell/Forehead
E8	Cap Style	Reversed	Short Duct w/o clip	●		Face
<b>FULL BRIM</b>						
E9	Full Brim	Standard	Long Duct w/clip		●	Inside Shell
E10	Full Brim	Standard	Long Duct w/o clip		●	Neck
E11	Full Brim	Standard	Long Duct w/clip	●		Inside Shell/Forehead
E12	Full Brim	Standard	Long Duct w/o clip	●		Face
<b>SAFETY HELMET</b>						
E13	Safety Helmet	Standard	Short Duct w/clip		●	Inside Shell
E14	Safety Helmet	Standard	Short Duct w/o clip		●	Neck
E15	Safety Helmet	Standard	Long Duct w/clip	●		Inside Shell/Forehead
E16	Safety Helmet	Standard	Long Duct w/o clip	●		Face

## OPTIONAL ACCESSORIES & REPLACEMENT PARTS

Cat. No.	UPC 0-92644+	SKU Description
60155	60155-2	Hard Hat/Safety Helmet Cooling Fan
<b>Replacement Parts</b>		
29025	29025-1	Modular battery Li-ion (3200mAh)
60490	60490-4	Duct and cable replacement kit
<b>Optional Accessories</b>		
56048	56048-4	Rechargeable Headlamp and Worklight, 400 Lumens, Auto-Off sensor
56062	56062-0	Rechargeable Headlamp and Worklight, 300 Lumens, All-Day Runtime
56063	56063-7	Safety Lamp
56414	56414-7	Rechargeable 2-Color LED Headlamp-Spot/Flood/Red LEDs
60156	60156-9	Intrinsically Safe LED Headlamp



Visit [www.kleintools.com](http://www.kleintools.com) for warnings and instructions.

See our complete line of Personal Protective Equipment  
[www.kleintools.com](http://www.kleintools.com)



© 2021 Klein Tools, Inc.  
 Lincolnshire, IL 60069  
 82959 Rev. 09/21 A

# HARD HAT / SAFETY HELMET COOLING FAN

Effective, Lightweight, Compact Personal Cooling Solution



## HARD HAT/SAFETY HELMET COOLING FAN

Managing heat stress is a major issue on job sites, and it starts by keeping your head area cool. The 60155 Cooling Fan is a one-of-a-kind portable solution that provides hours of continuous airflow, to stay cool and remain focused on the job. Designed for Klein Tools hard hats and safety helmets with patent-pending accessory mounts for easy attachment and removal, it is powered by a detachable, rechargeable lithium-ion battery (Catalog no. 29025) that provides up to 6 hours of continuous operation. As an added convenience, the modular battery can also be used to charge other USB powered devices like phones, job site speakers, headlamps and more.

### COOLING FAN

Wide dual speed button for convenient operation—even with gloves on

Quick release tab to remove for storage or to reconfigure

Accessory mount to easily attach optional Klein accessories

Removable grills to facilitate easy cleaning and maintenance

USB-C Power Input Port

SHORT DUCTS

LONG DUCTS

FLEXIBLE, LIGHTWEIGHT DUCTS



### MODULAR BATTERY

#### QUICK FACTS

- 1) Capacity: 3200mAh
- 2) Cell type: 18650 Li-ion
- 3) Charge time: 2.5 hrs
- 4) USB-C (2x):  
Input: 5V DC, 1.1A  
Output: Max 5V DC, 2A
- 5) Weight: 109g
- 6) Ingress: IP54
- 7) Drop rated: 2m (6.6ft)

Battery Release Tab

Battery Status Button

USB-C Input/Output Ports (2)

Accessory mount to easily attach optional Klein accessories like headlamp/worklight or safety lamp

#### BATTERY FUNCTIONALITY

Charge cell phones, headlamps, speakers and small devices

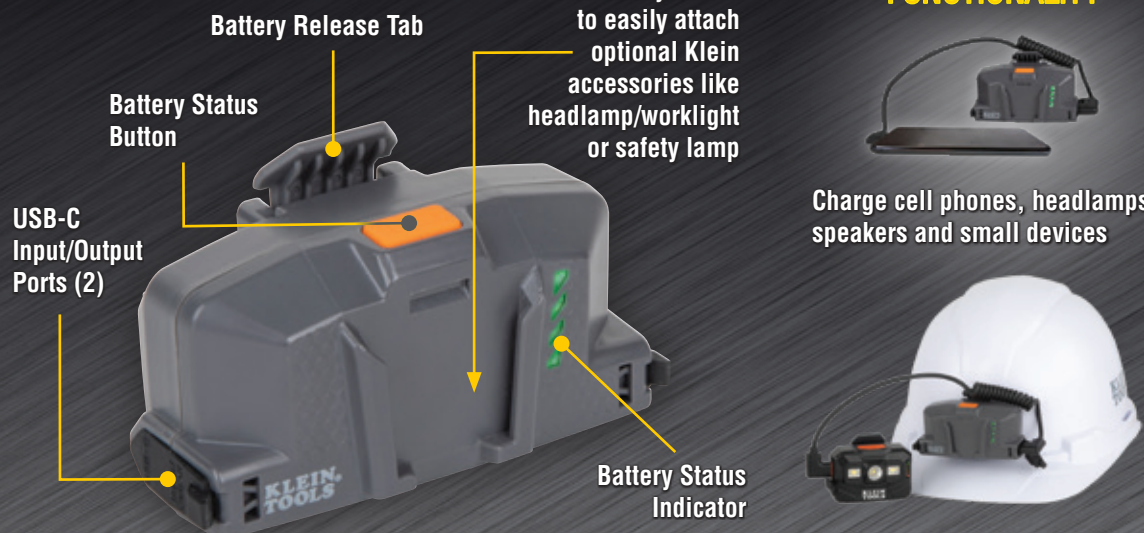

## CONVENIENT AND PRACTICAL

The modular fan and battery leverage Klein's successful patent-pending accessory mount design on any Klein cap style, full brim, or safety helmet. Configure to your needs by simply repositioning the fan and battery and switching ducts. NO straps, fasteners or adhesive needed.

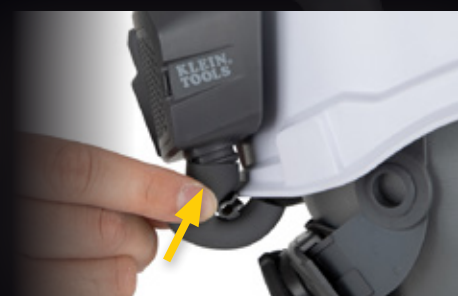
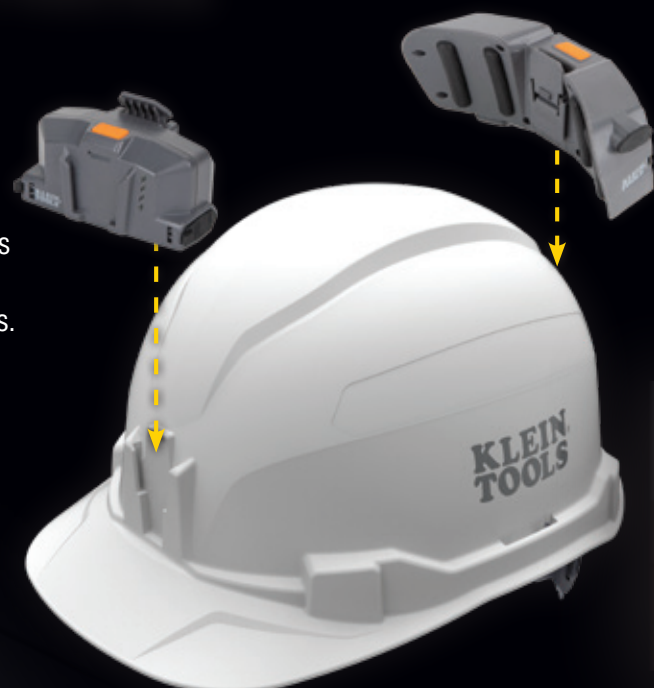

Easily detachable long or short ducts mount securely to fan and direct airflow to desired area

### HOW IT WORKS

Dual centrifugal fans pull outside air and direct it via ducts under the shell, face or neck area—pushing out stale hot air, for continuous cooling. The system can be configured 16 different ways across Cap, Full Brim, and Safety Helmet vented and non-vented designs.



UNDER SHELL COOLING



NECK COOLING



FACE COOLING