

Technical Specifications

55101

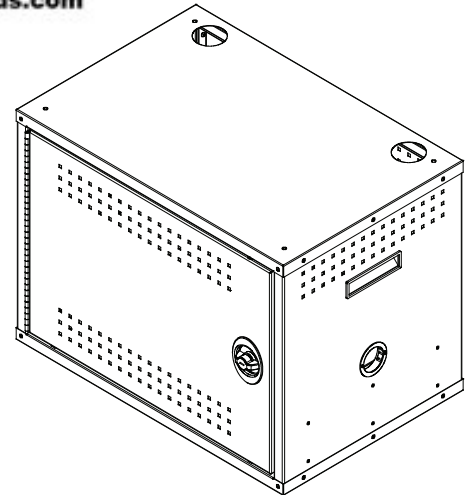

205 Westwood Ave, Long Branch, NJ 07740  
 Phone: 866-94 BOARDS (26273) / (732)-222-1511  
 Fax: (732)-222-7088 | E-mail: sales@touchboards.com

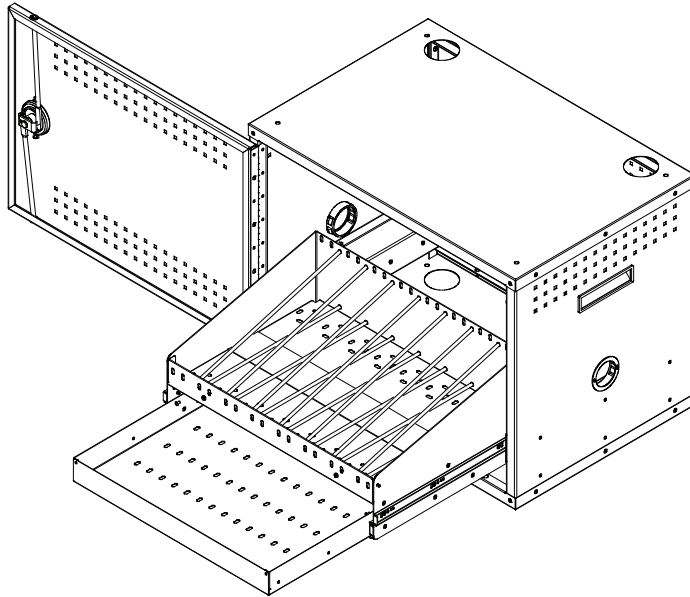

The Secure Laptop Locker V2 has a unique storage tray that actually slides out of the cabinet, making it easy to remove mobile devices and put them back in. Whether you use laptops, tablets, or netbooks, wear and tear due to handling is greatly reduced since your device doesn't have to slide in and out of the laptop cabinet with every use. A secondary slide-out tray stores all the power cords to keep the cords out of the way. This laptop locker is constructed of 16-gauge steel and mobile computers inside are protected by a double-bolt lock to provide vault-like laptop security. Designed to be bolted to the floor and/or wall to provide the ultimate in laptop anti-theft security. Up to 3 units can be fastened together for expansion needs.

**Features and Benefits**

- A slide-out storage/recharging module with built-in cord management holds up to 8 laptops making laptops easy to retrieve and put back
- 3/8" mounting holes on top (4), bottom (4), and back (6), provide secure attachment to wall, floor, or worksurface (floor fasteners not provided)
- Velcro® tie-downs, and cord management drawer located under the laptop storage module help keep wires and cords organized
- Laptop module has rubber pad to protect laptops
- Double-bolt, keyed, locking front door provides security and easy-access
- Symmetrical door can be installed to be hinged from the left or right-side
- Includes one 8-outlet insured power strip with surge-protector and 8' cord standard
- Cord management grommets throughout unit keeps cords organized and allow easy cord passage
- Ventilated door and side panels help dissipate heat
- Side handles assist when positioning or relocation is necessary
- Lockers are stackable up to three high allowing additional laptop storage to be added as needed
- Optional worksurface provides a finished look and writing surface for single units
- Warranted to be free of all defects in materials and workmanship with a 10-year warranty

Page 3 **Options & Accessories**

**Color Options**

Standard metal colors

Black  
(B)



Standard color combination refers to the quickest deliverable product color combination. Custom laminates and color combinations are available-additional lead-times and up-charges may apply. Call 1-800-235-1262 for further information.

# Construction

- Vented side panels and door are made of 16-gauge steel
- All metal components are finished with a scratch-resistant powder coat epoxy
- Each Secure Laptop Locker is factory-assembled

# Specifications

Laptop capacity	8 units
Storage slots in module	2¼"W x 14 <sup>7</sup> / <sub>16</sub> "D x 14"H
Storage module	Module extends 14" on full-extension slides and has a total weight capacity of 100 lbs
Cord / wire management drawer	19 <sup>3</sup> / <sub>4</sub> "W x 14 <sup>1</sup> / <sub>4</sub> "D x 2"H
Electrical	Power strip: <ul style="list-style-type: none"> <li>• 120V (50/60Hz) 1800 watts</li> <li>• 1080 joule surge suppressor</li> <li>• 15-amp circuit breaker</li> </ul> <ul style="list-style-type: none"> <li>• 8-outlets</li> <li>• 8' cord</li> <li>• 13"W x 2½"D x 1½"H</li> </ul>
Stackability	Lockers are stackable up to 3 units high. For security and stability reasons, lockers must be fastened together and bolted to either the floor or the wall. (fasteners not provided)
Unit weights (nominal)	73 lbs
Shipping weights (nominal)	75 lbs
Meets or exceeds applicable ANSI-BIFMA test standards	

*Specifications subject to change without notice*

## ! CAUTION !

Note: The Secure Laptop Locker needs to be permanently and securely attached to a wall, desk, or floor to prevent tipping while the loaded laptop storage module is pulled out. 3/8" mounting holes located in the back panel are for stabilizing the unit(s) (up to 3 high only) and are 16" on-center to match most wall construction stud spacing. Be sure screws are anchored securely to studs or other solid portion of wall.

It is the customer's responsibility to use adequate fasteners for the specific worksurface and/or floor type the unit will be mounted to.

## ! WARNING !

THE SECURE LAPTOP LOCKER IS NOT INTENDED OR DESIGNED TO SOLELY BE HUNG ON A WALL. THE MOUNTING HOLES IN THE BACK PANEL ARE FOR STABILIZING PURPOSES ONLY WHEN A STACK OF (UP TO 3) LOCKERS IS BEING USED.

## ! CAUTION !

The Secure Laptop Locker can store up to 8 charging laptops. Some laptop computers may draw more than ½ amp when fully discharged. If more than 2 laptop lockers are being used to charge simultaneously, it may be necessary to connect the power cords to separate 15-amp electrical circuits to prevent an electrical overload which may trip a circuit breaker. Please consult the owner's manual of your specific laptop computer for further information.

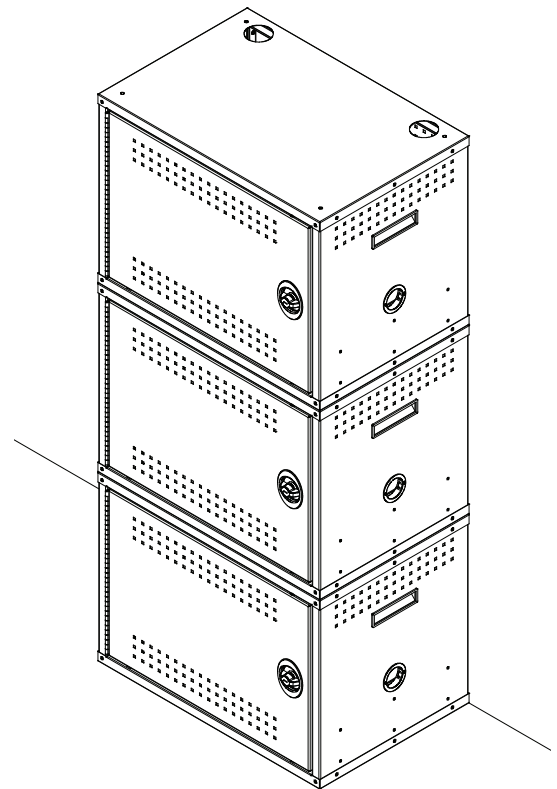

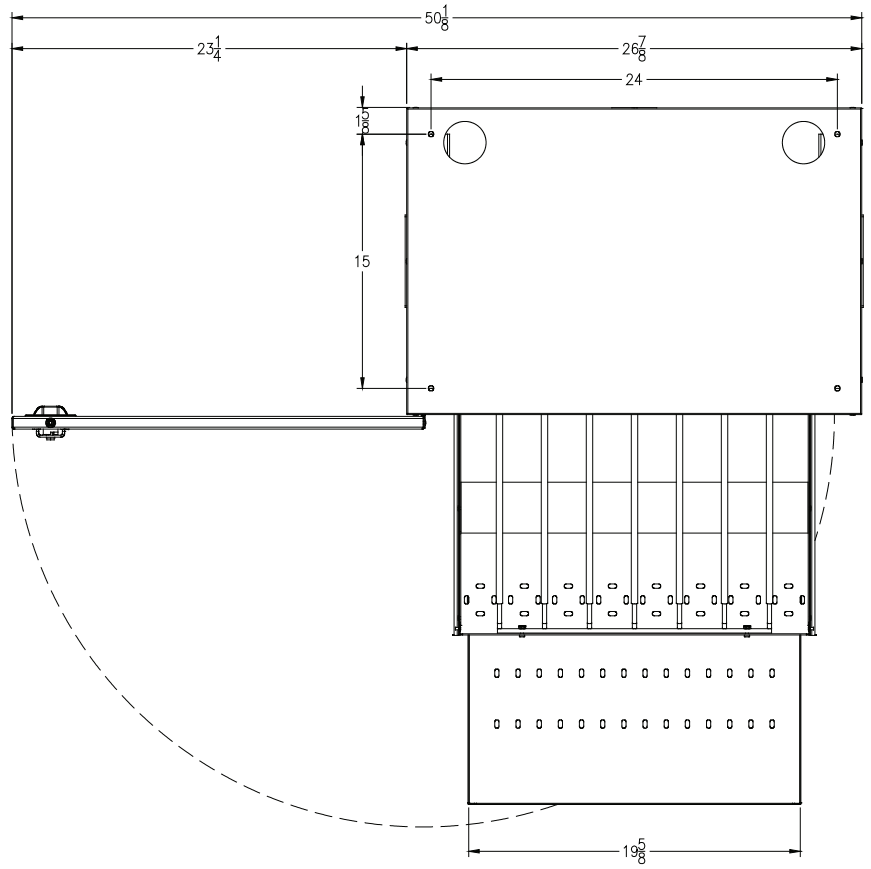
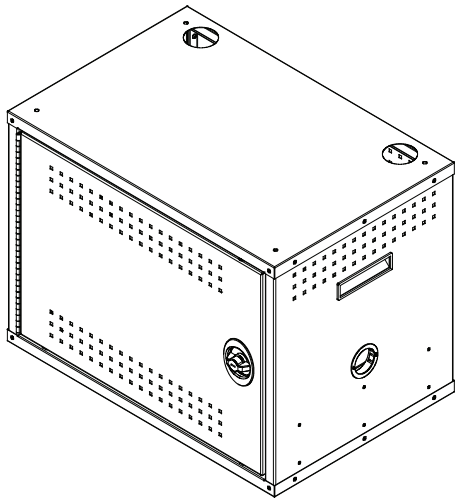

top view

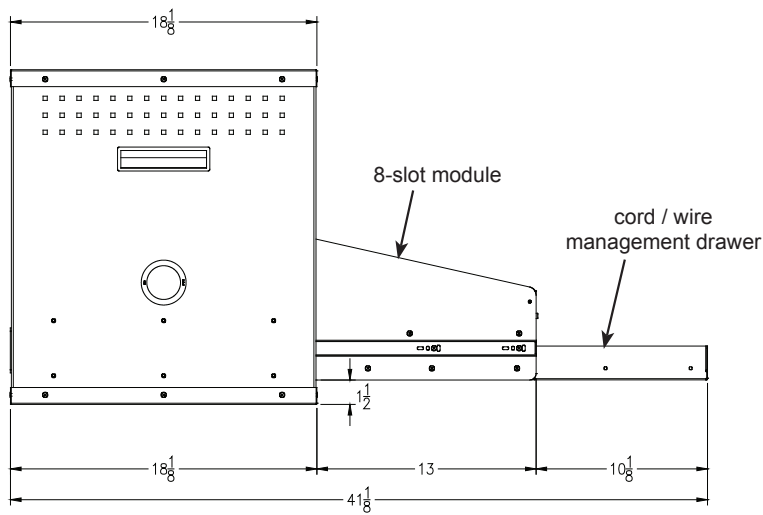

left side view

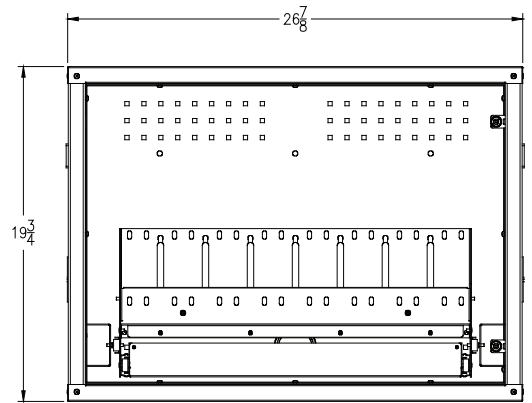

front view  
(shown with door removed)

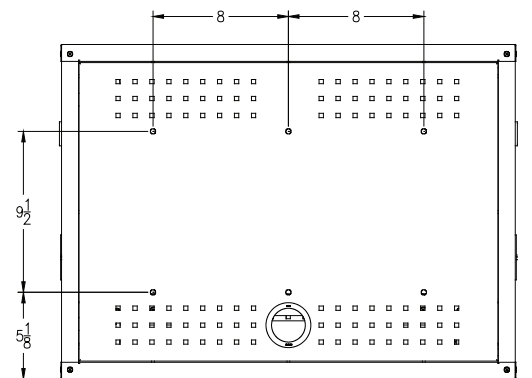

rear view

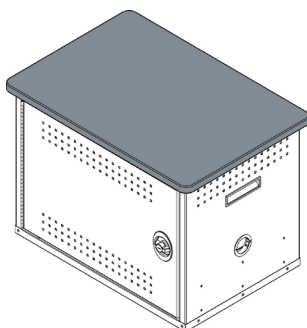

**Optional Worksurface**  
 29"W x 20"D x 1"H  
 (available in Wild Cherry CH  
 or Indigo Organix I laminate)  
 55102

# Warranty

## WE WILL MAKE IT RIGHT FOR YOU!

Spectrum is committed to provide complete customer satisfaction. Each of our products is manufactured from the best materials available and each product is stringently monitored throughout the production process through our P.A.C.E. program (Product Assurance to meet Customer Expectations).

We expressly warrant that Spectrum products will be of good quality and workmanship and free from defect for the period set out in the warranty table below from the date of delivery. This warranty shall not apply to defects or damage resulting from misuse, abuse, neglect, improper care, modification or repair not authorized by Spectrum, or any other cause outside the control of Spectrum. Spectrum will, at its sole option, either repair or replace the defective product.

This warranty is exclusive; no other warranty, written or oral, is expressed or implied. This warranty is given by Spectrum to Buyer and to no other person or legal entity. No Spectrum dealer, distributor, agent or employee is authorized to make any modification or addition to this warranty.

**NOTWITHSTANDING ANYTHING TO THE CONTRARY, SPECTRUM WILL NOT UNDER ANY CIRCUMSTANCES BE LIABLE FOR INDIRECT OR LIQUIDATED DAMAGES, INCLUDING CONSEQUENTIAL, INCIDENTAL AND SPECIAL DAMAGES. IN NO EVENT SHALL SPECTRUM'S LIABILITY, WHETHER UNDER CONTRACT OR WARRANTY, IN TORT OR OTHERWISE, EXCEED THE PURCHASE PRICE RECEIVED BY SPECTRUM FOR THE PRODUCT AT ISSUE AND "RECALL ACTION" EXPENSES. SPECTRUM SHALL NOT BE SUBJECT TO ANY OTHER OBLIGATIONS OR LIABILITIES, WHETHER ARISING OUT OF BREACH OF CONTRACT, WARRANTY, TORT (INCLUDING NEGLIGENCE AND STRICT LIABILITY) OR OTHER THEORIES OF LAW, WITH RESPECT TO PRODUCTS SOLD OR SERVICES RENDERED BY SPECTRUM, OR ANY UNDERTAKINGS, ACTS OR OMISSIONS RELATING THERETO.**

Our Customer Service Department is ready to provide immediate attention to any questions, comments or concerns. They are available to answer your calls Monday through Friday from 7 am to 5 pm CST. In addition your product comments or concerns are welcome via e-mail at: [spectrum@spectrumfurniture.com](mailto:spectrum@spectrumfurniture.com).

Warranty Table

Item	Warranty Period
<ul style="list-style-type: none"> <li>Adjustable Crank/Electric Desk Legs</li> <li>Flat Panel Desk Gas Cylinders</li> </ul>	<ul style="list-style-type: none"> <li>1 Year</li> </ul>
<ul style="list-style-type: none"> <li>Adjustable Height Chair Parts – including frames, gas cylinders, wood and plastic parts, and control handles Adjustable Height Chair Parts Casters</li> <li>Adjustable Height Chair Upholstery</li> <li>In-Stock Upholstery</li> <li>Graded-In Fabrics and Customer Owned Material</li> </ul>	<ul style="list-style-type: none"> <li>7 Years</li> <li>2 Years</li> <li>2 Years</li> <li>No Warranty</li> </ul>
<ul style="list-style-type: none"> <li>Height Adjustable Columns and Lifts</li> <li>General Use Casters</li> <li>Electrical</li> <li>Keyboard/Mouse Trays</li> </ul>	<ul style="list-style-type: none"> <li>1 Year</li> </ul>
<ul style="list-style-type: none"> <li>Flat Panel Monitor Arm – General Parts</li> <li>Flat Panel Monitor Arm – Gas Cylinders</li> </ul>	<ul style="list-style-type: none"> <li>5 Years</li> <li>2 Years</li> </ul>
<ul style="list-style-type: none"> <li>Computer Desk Chassis</li> <li>Cart Chassis</li> <li>Lectern Chassis</li> </ul>	<ul style="list-style-type: none"> <li>10 Years</li> </ul>



205 Westwood Ave, Long Branch, NJ 07740  
 Phone: 866-94 BOARDS (26273) / (732)-222-1511  
 Fax: (732)-222-7088 | E-mail: [sales@touchboards.com](mailto:sales@touchboards.com)



**INDOOR AIR QUALITY**  
 Indoor Advantage | Furniture



925 First Avenue, PO Box 400, Chippewa Falls, WI 54729 Ph: 800-235-1262, 715-723-6750 Fax: 800-335-0473, 715-738-2309

E-mail: [spectrum@spectrumfurniture.com](mailto:spectrum@spectrumfurniture.com) web: [www.spectrumfurniture.com](http://www.spectrumfurniture.com)