

USER INSTRUCTIONS

ENG ✓

DEU

ESP

FRA

ITA

PRT

NLD

Touchboards

CarryOn™

205 Westwood Ave, Long Branch, NJ 07740
Phone: 866-94 BOARDS (26273) / (732)-222-1511
Fax: (732)-222-7088 | E-mail: sales@touchboards.com



www.pclocs.com.au

www.lockncharge.com

**Congratulations on your purchase.
Follow these instructions for easy and fast set-up of your CarryOn.**

PC Locs, LocknCharge and the Padlock device are Trademarks of IWS Global Pty Ltd.
Copyright IWS Global Pty Ltd, October 2015.

Disclaimer.

This information is the intellectual property of IWS Global Pty Ltd and may not be distributed, duplicated or copied in part or full without the written permission. Since the use of this information, the equipment connected and the conditions by which any IWS Global product is used is beyond the control of IWS Global, it is the obligation of the owner and/or user to determine the correct and safe use of any equipment and product. To the extent that the law permits, any liability which may be incurred as a result of the use or future use of a product manufactured or sold by IWS Global is limited to the cost of repairing or replacing the failed product or component at the discretion of IWS Global either within, or outside of warranty periods, and does not extend to any loss or damage which may be caused as a consequence of misuse or failure of the equipment or product or the information contained herein. IWS Global shall not in any event be liable for economic loss of profits, indirect, special, bodily injuries or consequential damages.

Specifications and images are for illustration purposes only. Final product may differ and is subject to change without notice.

STEP 1 - Unpacking the CarryOn.

After unpacking, unlock the perspex door using the supplied keys



Remove the plastic divider by lifting the base tabs first then lift the divider and gently pull forward.

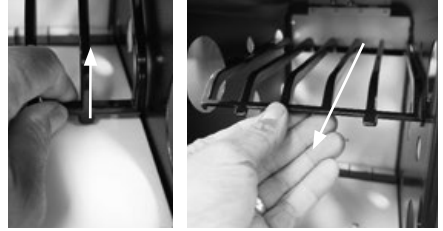

STEP 2 - Routing the device cables in the CarryOn.

Undo the four screws that secure the device shelf.

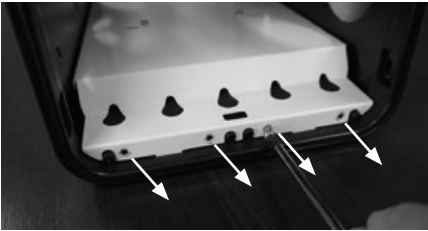

Remove the device shelf, flip over and plug in the USB-A plugs of the device cables into the USB charger.



NOTE: Use the green velcro cable ties supplied to neaten the cables if using long cables.

Route the cables through the 'strain relief device' as shown, allowing the correct length for your device.



Route the cables through the 'tear-drop' slots.

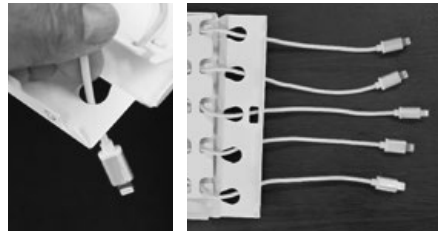

Picture above: Completed cable installation.

CarryOn

Replace the device shelf into the CarryOn and tighten the four fixing screws.

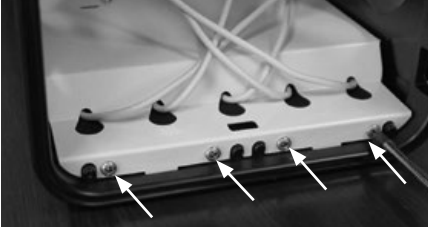

Replace the plastic divider.
Insert the rear tabs first.

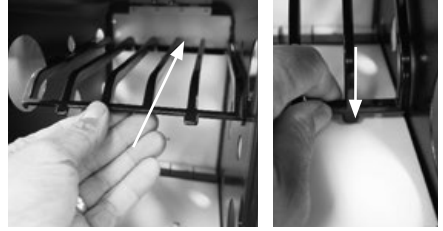

STEP 3 - Connecting the devices and powering on the CarryOn.

Insert the devices and connect the charging cables.



Plug in the power cord, connect to a wall outlet and switch it on. Charging will automatically start.



STEP 4 - Locking and storing.

Lock the door when unattended and when transporting the devices (to prevent accidental dropping).



When not in use, wrap power cable around cleats.



Additional Step - Mounting the wall hanging bracket for the CarryOn.

NOTE: mount the wall bracket in a location where there is no personnel traffic as the protruding arms may cause a hazard when the CarryOn is not engaged.

Only a suitably qualified person should install the wall mounting bracket to a wall of suitable material (masonry, concrete, timber stud etc.) using fixings that can hold up to 10kg (22 lb).

Insert bracket 'arms' into the disc and hold against the wall in the chosen location, ensuring the bracket is level. Then mark the four (4) holes.



Drill holes and insert four screws and tighten.

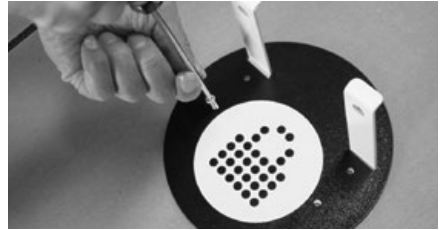

Place the CarryOn onto the wall bracket.



Use a 25 mm (1") padlock to secure*.



** PLEASE NOTE: only a 25mm (1") padlock will fit.*

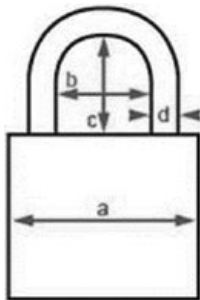

Lock dimensions (maximum):

- a: any size
- b: 15 mm (0.591 inch)
- c: 19 mm (0.748 inch)
- d: 5 mm (0.197 inch)

Warranty

PC Locs/LocknCharge warrants the product to be free of defects in design, materials, assembly and craftsmanship from the date of purchase to the original retail purchaser. Evidence of original purchase will be required to obtain warranty service.

In the event that a defect, malfunction or failure occurs or is discovered during the warranty period, PC Locs/LocknCharge will repair or replace, at its option, the products which in the reasonable judgment of PC Locs/LocknCharge are deemed defective. All transportation costs shall be borne by the owner and the risk of loss shall be upon the party initiating the transportation.

The warranty does not apply to any product that has been subject to misuse, tampering, neglect, or accident or as a result of unauthorized alterations or repairs to the product. The warranty is in lieu of all warranties expressed or implied, including the implied warranties of merchantability and fitness for a particular purpose which are expressly excluded or disclaimed. In no event will PC Locs/LocknCharge, their directors, officers, employees, or agents be liable for any harm, consequential, incidental, third party, special or indirect damages whatsoever arising out of the use or inability to use the products even if PC Locs/LocknCharge has been advised of the possibility of such damages. PC Locs/LocknCharge obligation is strictly and exclusively limited to the replacement or repair of any defective products. Some states do not allow the exclusion or limitation of incidental or consequential damages, so the above limitation or exclusion may not apply to you.

The logo for Touchboards features the word "Touchboards" in a bold, black, sans-serif font. The letters are set against a background of three overlapping rectangular shapes: a yellow one on the left, a blue one in the middle, and an orange one on the right. The shapes are slightly offset, creating a layered effect behind the text.

205 Westwood Ave, Long Branch, NJ 07740

Phone: 866-94 BOARDS (26273) / (732)-222-1511

Fax: (732)-222-7088 | E-mail: sales@touchboards.com

Compliances and Approvals

CE (Europe)

SAA (Australia)

UL Compliant (USA and Canada)

KCC (Korea) - pending

SIRIM (Malaysia) - pending

SPRING (Singapore) -pending



www.pclocs.com.au

www.lockncharge.com