

Measuring Fluoride in Water and Wastewater using the Thermo Scientific Orion Dual Star pH/ISE Meter

Water and Lab Products, Thermo Fisher Scientific

Key Words

Thermo Scientific Orion Dual Star pH/ISE meter, fluoride ion selective electrode (ISE), fluoride, wastewater, water

Goal

This technical note explains how to accurately measure fluoride content in general water and wastewater samples using the Thermo Scientific™ Orion™ Dual Star™ pH/ISE dual channel benchtop meter.



Introduction

Too much or too little fluoride can be harmful to humans and the environment. Precise measurement of fluoride by municipalities, potable water plants and bottled water manufacturers promotes quality water for consumption and helps prevent damage to the environment.

Required Equipment

- Orion Dual Star pH/ISE meter with electrode stand (Cat. No. 2115000)
- Fluoride combination electrode (Cat. No. 9609BNWP)
- Automatic Temperature Compensation (ATC) probe (Cat. No. 927007MD)
- Stirrer probe (Cat. No. 096019) or magnetic stir plate and bar
- 1 ppm fluoride standard premixed with Total Ionic Strength Adjustment Buffer (TISAB) II (Cat. No. 040906)
- 2 ppm fluoride standard premixed with TISAB II (Cat. No. 040907)
- TISAB II solution (Cat. No. 940909)
- Thermo Scientific™ Orion™ Optimum Results™ A electrode filling solution (Cat. No. 900061)
- Deionized water
- 100 mL volumetric flasks
- 50 mL beakers
- 50 mL, 25 mL and 15 mL pipettes
- 50 mL graduated cylinders or 10 mL automatic pipette

Fluoride Electrode Setup

Note: Add filling solution each day before using the electrode. The filling solution level should be at least one inch above the level of sample to ensure a proper flow rate. The fill hole should always be open when taking measurements.

See *Figure 1* for labeled electrode components.

1. Remove the protective shipping cap from the sensing element and save the cap for storage.
2. Insert the spout of the Optimum Results A bottle into the electrode fill hole, add a small amount of filling solution to the chamber, tip the electrode upside-down to wet the O-ring and return the electrode to its original, vertical position.
3. Hold the electrode body and use your thumb to push down on the electrode cap to allow a few drops of filling solution to drain out and wet the junction.
4. Release the electrode cap and allow the outer sleeve to return to its original position. If the outer sleeve does not return to its original position immediately, check if the O-ring is moist and repeat step 3.
5. Add filling solution to the electrode up to the bottom of the electrode fill hole.
6. Soak the electrode in the 1 ppm fluoride calibration standard until all of the equipment is ready for use.

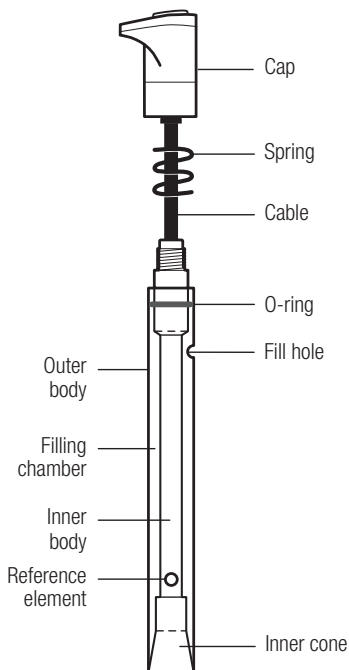
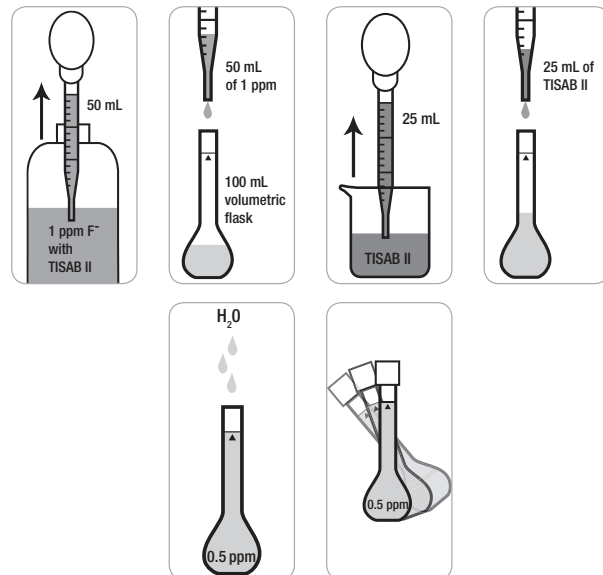

Figure 1 : Fluoride Electrode Components

Calibration Standard Preparation

1. Prepare a 0.5 ppm fluoride standard by pipetting 50 mL of the 1 ppm fluoride standard premixed with TISAB II (Cat. No. 040906) and 25 mL of the TISAB II solution (Cat. No. 940909) into a 100 mL volumetric flask. Dilute to the mark with deionized water. Mix the solution well.



2. Using a graduated cylinder or automatic pipette, add 30 mL of the 0.5 ppm fluoride standard to a 50 mL beaker and label the beaker.

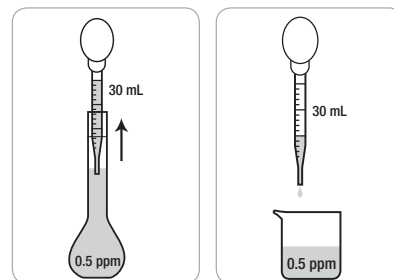

3. Using a graduated cylinder or automatic pipette, add 30 mL each of the 1 ppm fluoride standard and 2 ppm fluoride standard to separate 50 mL beakers and label the beakers.

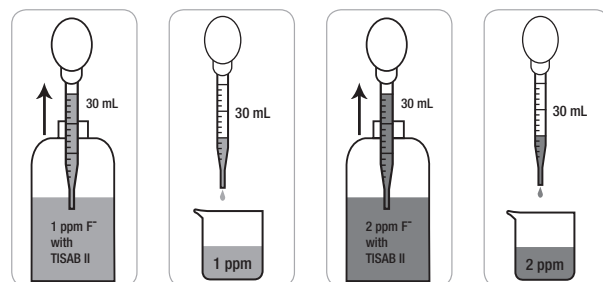

Sample Preparation

- Using a graduated cylinder or pipette, measure and add 15 mL of the sample to a 50 mL beaker and label the beaker. Add 15 mL of TISAB II to the beaker. Gently stir the sample and TISAB II to mix the solution.

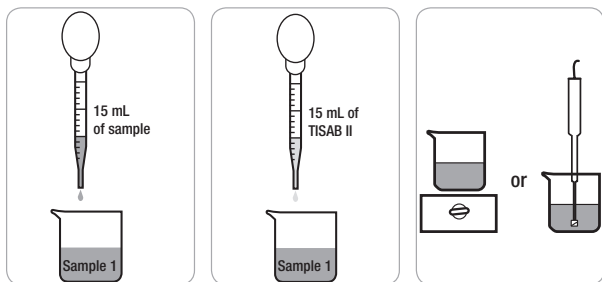

- Repeat step 1 for additional samples.

Meter Preparation

The Orion Dual Star meter has two BNC, reference and ATC connections. These connections are labeled as Channel 1 or Channel 2 on the ridge above the connections.

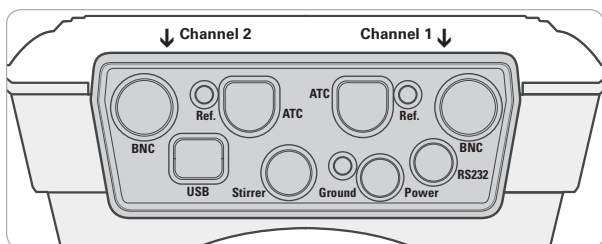

- Prepare the power adapter by selecting the appropriate wall outlet plug and sliding the plug plate into the groove on the back of the adapter.

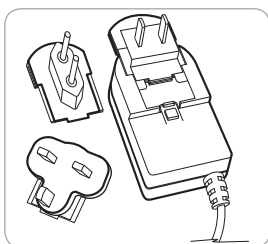

- Connect the power adapter to the meter and then to the wall outlet. See Figure 2. Connect the fluoride electrode to one of the BNC inputs on the meter and note which channel (channel 1 or channel 2) was selected. See Figure 3. Connect the ATC probe to the 8 pin MiniDIN input on the meter and note which channel was selected. See Figure 4. Connect the stirrer probe to the stir jack input on the meter. See Figure 5.

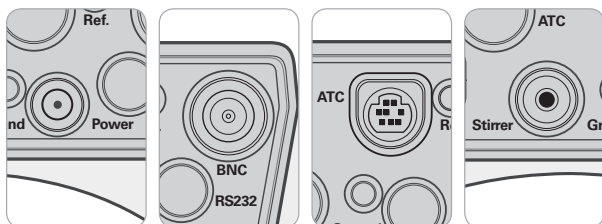

Figure 2

Figure 3

Figure 4

Figure 5

Meter Setup

Note: It is highly recommended that the EZ Startup menu be completed the first time that the meter is used. The EZ Startup menu sets important meter parameters, such as the displayed language, date and time, measurement mode and read type for each channel, and data output settings. To access the EZ Startup menu from the measurement mode, press the *setup* key, press the \blacktriangle / \blacktriangledown keys to highlight EZ Startup and press the *f2 (select)* key.

- In the measurement mode, press the *setup* key.
- Press the \blacktriangle / \blacktriangledown keys to highlight Channel 1 or Channel 2, depending on which BNC input the fluoride electrode was connected to, and press the *f2 (select)* key.
- Press the \blacktriangle / \blacktriangledown keys to highlight Measure Mode and press the *f2 (select)* key. Press the \blacktriangle / \blacktriangledown keys to highlight ISE and press the *f2 (accept)* key. Press the \blacktriangle / \blacktriangledown keys to highlight ppm (or mg/L, depending on your preference or method) and press the *f2 (accept)* key.
- Press the \blacktriangle / \blacktriangledown keys to highlight Electrode ID and press the *f2 (select)* key. Press the \blacktriangle / \blacktriangledown keys to highlight F⁻ and press the *f2 (accept)* key.
- Press the \blacktriangle / \blacktriangledown keys to highlight Resolution and press the *f2 (select)* key. Press the \blacktriangle / \blacktriangledown keys to highlight 3 Significant Figures (1.00) and press the *f2 (accept)* key.
- Press the \blacktriangle / \blacktriangledown keys to highlight Temperature Input and press the *f2 (select)* key. Press the \blacktriangle / \blacktriangledown keys to highlight ATC1 or ATC2, depending on which 8 pin MiniDIN input the ATC probe was connected to, and press the *f2 (accept)* key.
- Press the \blacktriangle / \blacktriangledown keys to highlight Calibration Setup and press the *f2 (select)* key. Press the \blacktriangle / \blacktriangledown keys to highlight Autoblack and press the *f2 (select)* key. Press the \blacktriangle / \blacktriangledown keys to highlight On and press the *f2 (accept)* key. Verify that the Low Level Stability and Isopotential options are set to Off. Press the *f1 (back)* key.
- Press the \blacktriangle / \blacktriangledown keys to highlight Read Type and press the *f2 (select)* key. Press the \blacktriangle / \blacktriangledown keys to highlight On Ready and press the *f2 (select)* key.
- Press the *f1 (back)* key.
- Press the \blacktriangle / \blacktriangledown keys to highlight Instrument Parameters and press the *f2 (select)* key.
- Press the \blacktriangle / \blacktriangledown keys to highlight Export Data (PC/Printer/Log) and press the *f2 (select)* key. Press the \blacktriangle / \blacktriangledown keys to highlight Export Trigger and press the *f2 (select)* key. Press the \blacktriangle / \blacktriangledown keys to highlight Channel 1 or Channel 2, depending on which BNC input the fluoride electrode was connected to, and press the *f2 (accept)* key. Press the \blacktriangle / \blacktriangledown keys to highlight Data Log and press the *f2 (select)* key. Press the \blacktriangle / \blacktriangledown keys to highlight Data Log On/Off and press the *f2 (select)* key. Press the \blacktriangle / \blacktriangledown keys to highlight On and press the *f2 (accept)* key.

12. Press the *f1* (*back*) key twice.
13. Press the \blacktriangle / \blacktriangledown keys to highlight **Stirrer Speed** and press the *f2* (*select*) key. Press the \blacktriangle / \blacktriangledown keys to highlight **1** and press the *f2* (*accept*) key. Press the *f1* (*back*) key.
14. Press the *f1* (*back*) key. The meter will return to the measurement mode.

Calibration Procedure

1. Prepare and condition the fluoride electrode. Connect the fluoride electrode, ATC probe and stirrer probe to the meter (note which channel the fluoride electrode is connected to) and place the electrode and probes in the electrode stand. Prepare the 2 ppm, 1 ppm and 0.5 ppm standards.

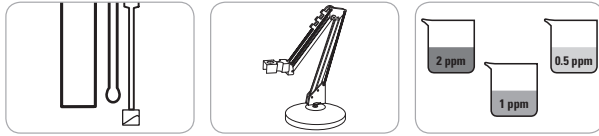

2. In the measurement mode, press the *cal* key.

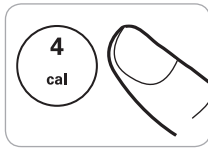

3. Dual channel display only: Press the \blacktriangle / \blacktriangledown keys to highlight **Channel 1** or **Channel 2** as the channel to calibrate and press the *f2* (*accept*) key.

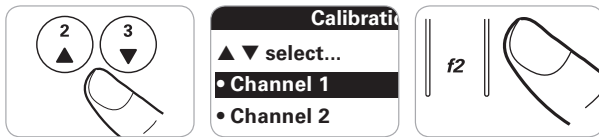

4. Rinse the fluoride electrode, ATC probe and stirrer probe with deionized water, blot dry and place into the 0.5 ppm calibration standard.

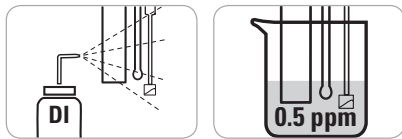

5. When the electrode and standard are ready, press the *f3* (*start*) key to begin the calibration.

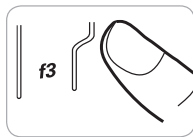

6. Wait for the concentration value to stop flashing and then use the numeric keypad and the *decimal* key to enter the concentration of the first standard as 0.50 and press the *f2* (*accept*) key.

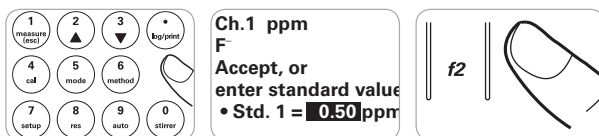

7. Press the *f2* (*next*) key to proceed to the next calibration standard.
8. Rinse the fluoride electrode, ATC probe and stirrer probe with deionized water, blot dry and place into the 1 ppm calibration standard.

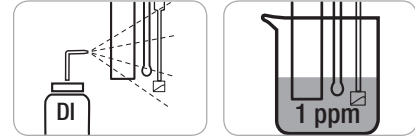

9. When the electrode and standard are ready, press the *f3* (*start*) key.

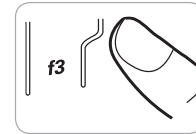

10. Wait for the concentration value to stop flashing and then use the numeric keypad and the *decimal* key to enter the concentration of the second standard as 1.00 and press the *f2* (*accept*) key.

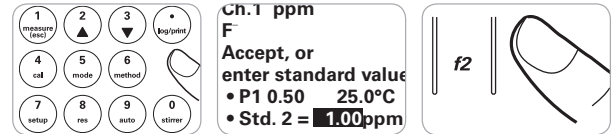

11. Press the *f2* (*next*) key to proceed to the next calibration standard.

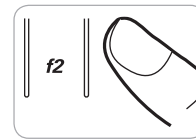

12. Rinse the electrode, ATC probe and stirrer probe with deionized water, blot dry and place into the 2 ppm calibration standard.

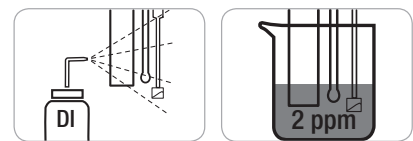

13. When the electrode and standard are ready, press the *f3* (*start*) key.

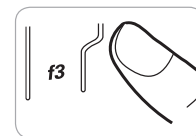

14. Wait for the concentration value to stop flashing and then use the numeric keypad and the *decimal* key to enter the concentration of the third standard as 2.00 and press the *f2* (*accept*) key.

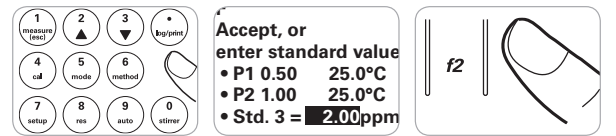

15. Press the *f3 (cal done)* key. A summary of the calibration will be displayed. The slope should be -54 mV per decade to -65 mV per decade.

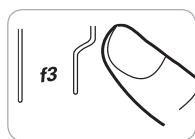

16. Press the *f2 (log/print)* key to save and end the calibration and export the calibration data to the calibration log.

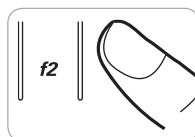

5. Repeat steps 2 through 4 for all of the samples.

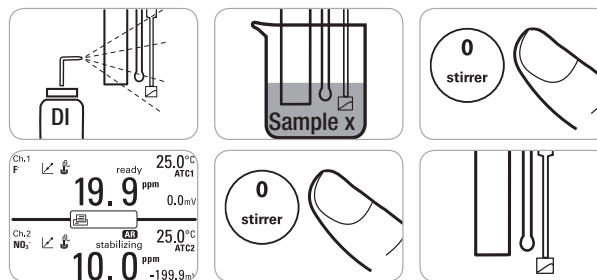

6. When all of the samples have been measured, store the equipment. For short term storage between samples and overnight, store the fluoride electrode in the 1 ppm fluoride calibration standard. Store the ATC probe and stirrer probe dry.

Sample Measurement Procedure

1. Calibrate the fluoride electrode and meter (note which channel the fluoride electrode is connected to) and make sure that the electrode and probes are in the electrode stand. Prepare the fluoride samples.

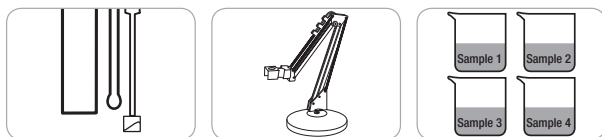

2. Rinse the fluoride electrode, ATC probe and stirrer probe with deionized water, blot dry and place into the sample. Press the *stirrer* key to turn on the stirrer probe.

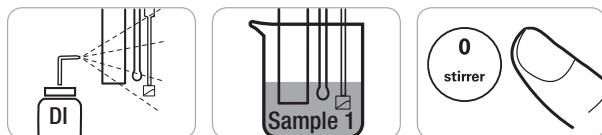

3. The meter display will flash stabilizing and then show ready once the measurement is stable. Record the concentration and temperature of the sample when the meter display shows ready. When ready is shown on the display, the meter will export the measurement to the data log.

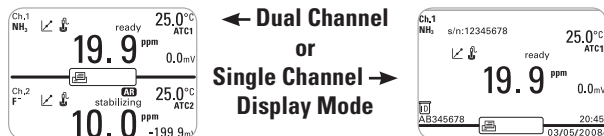

4. Press the *stirrer* key to turn off the stirrer probe. Remove the fluoride electrode, ATC probe and stirrer probe from the sample.

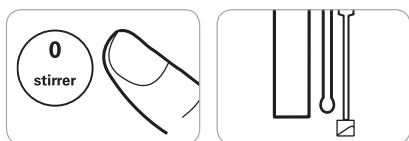

Visit www.thermoscientific.com/water to view the full line of Thermo Scientific Orion products and download product literature, user guides and manuals and software updates. For any questions or technical support, contact your local Technical Sales Representative or our Technical Support Specialists by phone at 1-978-232-6000 or 1-800-225-1480 (US toll-free), or by email at wai.techservbev@thermofisher.com.

Ordering Information

To purchase an Orion Dual Star meter, electrodes and other related products, please contact your local equipment distributor and reference the part numbers listed below.

Product	Description	Part Number
Meter	Orion Dual Star pH/ISE Dual Channel Benchtop Meter	2115000
Electrodes	Orion Fluoride Combination Electrode	9609BNWP
	Orion Stainless Steel ATC Temperature Probe	927007MD
Solutions	Orion 1 ppm Fluoride Standard Premixed with TISAB II, 475 mL	040906
	Orion 2 ppm Fluoride Standard Premixed with TISAB II, 475 mL	040907
	Orion 10 ppm Fluoride Standard Premixed with TISAB II, 475 mL	040908
	Orion TISAB II Solution, 3.8 L (1 gallon)	940909
	Orion Optimum Results A Electrode Filling Solution, 5 x 60 mL	900061
Accessories	Orion Stirrer Probe	096019
	Swing Arm Electrode Stand	090043

thermoscientific.com/water

© 2015 Thermo Fisher Scientific Inc. All rights reserved. All trademarks are the property of Thermo Fisher Scientific and its subsidiaries.

Water and Lab Products

North America

Toll Free: 1-800-225-1480
Tel: 1-978-232-6000
info.water@thermofisher.com

Germany

Tel: (49) 6184-90-6000
info.water.uk@thermofisher.com

India

Tel: (91) 22-4157-8800
wai.asia@thermofisher.com

Japan

Tel: (81) 045-453-9175
wai.asia@thermofisher.com

China

Tel: (86) 21-68654588
wai.asia@thermofisher.com

Singapore

Tel: (65) 6778-6876
wai.asia@thermofisher.com

Australia

Tel: (613) 9757-4300
In Australia: (1300) 735-295
InfoWaterAU@thermofisher.com

Thermo
SCIENTIFIC

A Thermo Fisher Scientific Brand