

Lever-operated Cam Grips

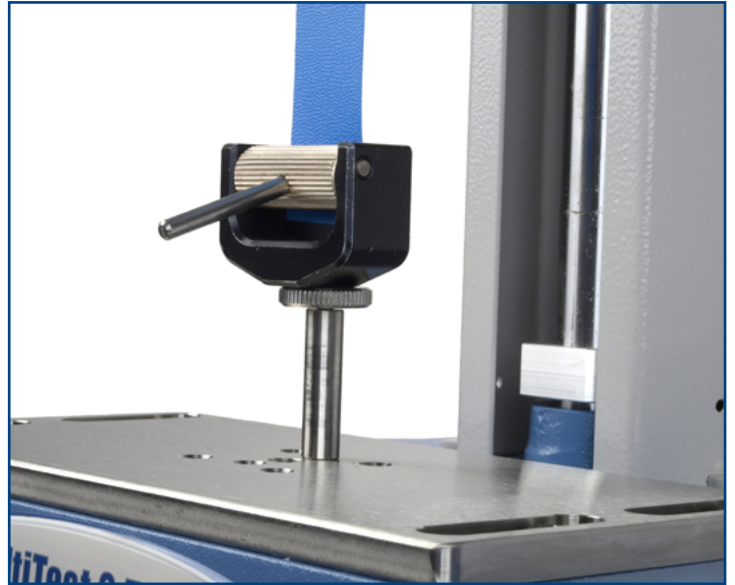

Description

Lever-operated cam grips are designed to self-tighten as load is applied, and spread the load evenly. The lever also allows for quick insertion and release of samples.

Applications

- dumbbells
- elastomers

Specifications

Part No.	Load Capacity	Thread 1	Maximum Sample Size (Width x Thickness)		Height	Weight
432-383	500 N / 50 kgf / 110 lbf	10-32 UNF	30 mm x 5 mm	1.18" x 0.20"	29 mm (1.14")	100 g (0.22 lb)
432-047	500 N / 50 kgf / 110 lbf	10-32 UNF	70 mm x 5 mm	2.76" x 0.20"	29 mm (1.14")	100 g (0.22 lb)

Dimensions mm (inch)

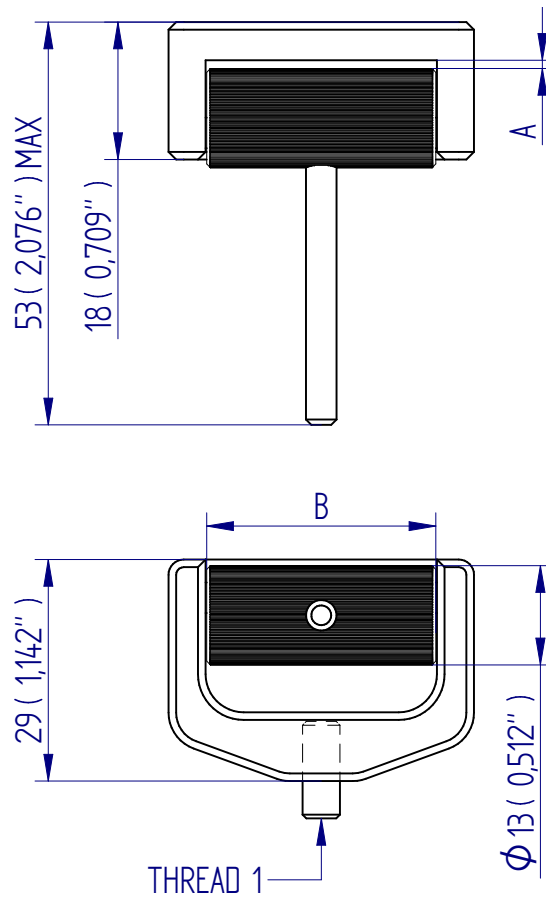

FS 58553

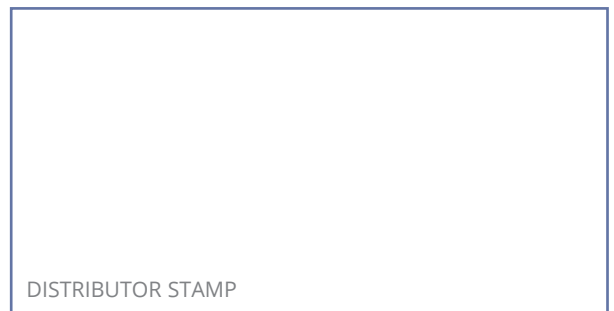

Mecmesin reserves the right to alter equipment specifications without prior notice.
E&OE

Head Office
Mecmesin Limited

w: www.mecmesin.com
e: sales@mecmesin.com

France
Mecmesin France

w: www.mecmesin.com/fr
e: contact@mecmesin.fr

Germany
Mecmesin GmbH

w: www.mecmesin.com/de
e: info@mecmesin.de

North America
Mecmesin Corporation

w: www.mecmesin.com
e: info@mecmesincorp.com

Asia
Mecmesin Asia Co., Ltd

w: www.mecmesin.com/th
e: sales@mecmesinasia.com

China
Mecmesin (Shanghai) Pte Ltd

w: www.mecmesin.com/zh
e: sales@mecmesin.cn