

Double Cam Grip

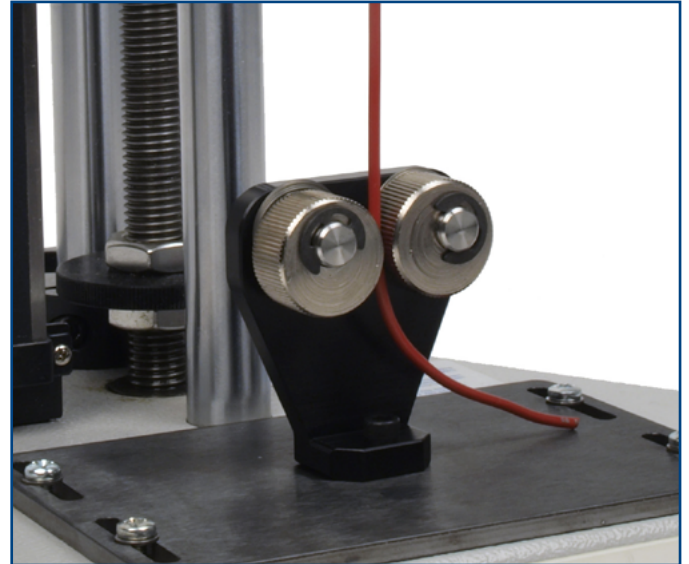

Description

Double cam grips are designed for holding insulated cables and wire. The sample is secured by the cam, which self-tightens as load is applied, minimising slippage during testing.

Supplied individually.

Applications

Used for tensile testing of:

- crimp terminals
- wires

Specifications

Part No.	Load Capacity	Thread 1	Max. Sample Thickness	Max. Sample Width	Length
432-387	500 N / 50 kgf / 110 lbf	10-32 UNF	2 mm (0.08")	10 mm (0.40")	36 mm (1.42")
432-378	500 N / 50 kgf / 110 lbf	10-32 UNF	5 mm (0.20")	15 mm (0.59")	62 mm (2.44")

Dimensions mm (inch)

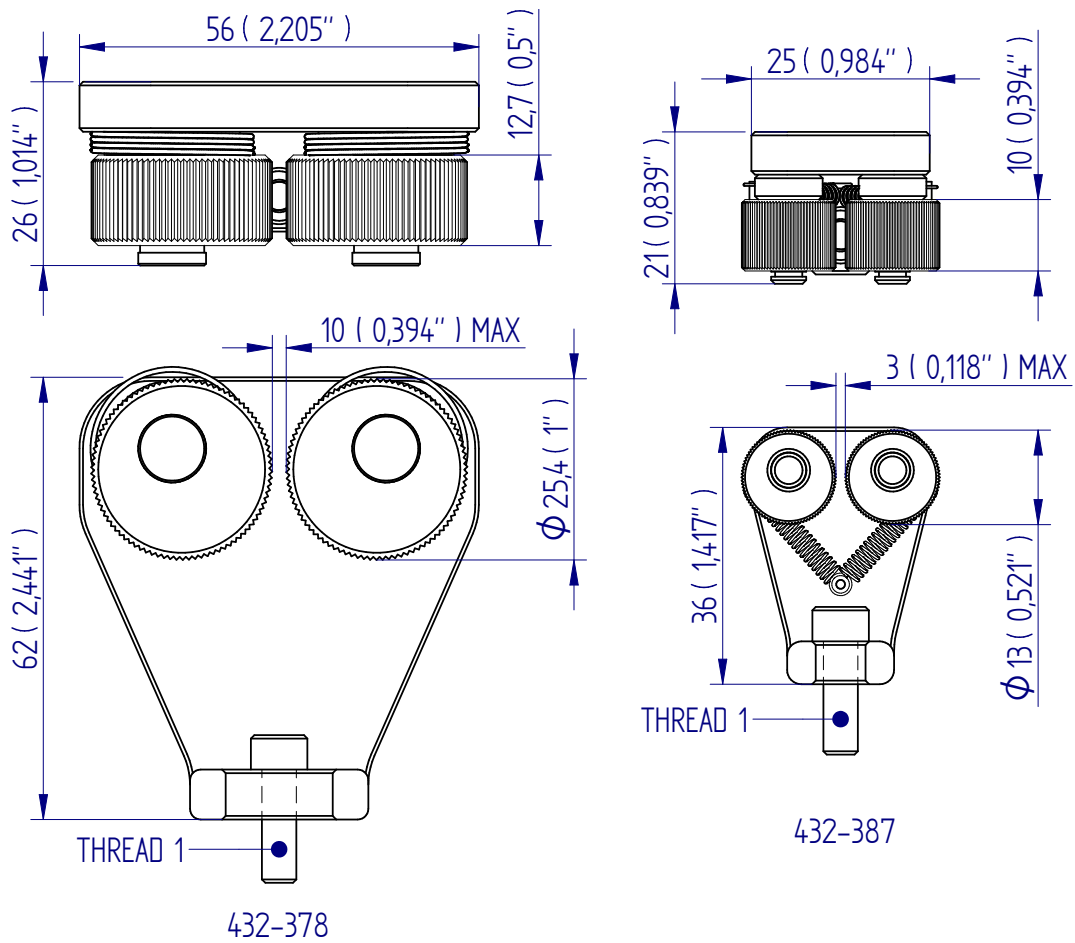

FS 58553

003

DISTRIBUTOR STAMP

Mecmesin reserves the right to alter equipment specifications without prior notice.
E&OE

Head Office
Mecmesin Limited

w: www.mecmesin.com
e: sales@mecmesin.com

France
Mecmesin France

w: www.mecmesin.com/fr
e: contact@mecmesin.fr

Germany
Mecmesin GmbH

w: www.mecmesin.com/de
e: info@mecmesin.de

North America
Mecmesin Corporation

w: www.mecmesin.com
e: info@mecmesincorp.com

Asia
Mecmesin Asia Co., Ltd

w: www.mecmesin.com/th
e: sales@mecmesinasia.com

China
Mecmesin (Shanghai) Pte Ltd

w: www.mecmesin.com/zh
e: sales@mecmesin.cn