



Novitizer Digital Signage Kiosk Install Guide



Important Safety Instructions

- » Please completely read and verify you understand all instructions in this manual before operating this equipment.
- » Keep these instructions in a safe, accessible place for future reference.
- » Heed all warnings.
- » Follow all instructions.
- » Do not use this apparatus near water.
- » Clean only with a dry cloth.
- » Do not install near any heat sources such as radiators, heat registers, stoves, or other apparatus (including amplifiers) that produce heat.
- » Use only accessories specified or recommended by Intelix.
- » Explanation of graphical symbols:

◊ Lightning bolt/flash symbol: the lightning bolt/flash and arrowhead within an equilateral triangle symbol is intended to alert the user to the presence of uninsulated “dangerous voltage” within the product enclosure which may be of sufficient magnitude to constitute a risk of shock to a person or persons.



◊ Exclamation point symbol: the exclamation point within an equilateral triangle symbol is intended to alert the user to the presence of important operating and maintenance (servicing) instructions in the literature accompanying the product.



- » **WARNING: TO REDUCE THE RISK OF FIRE OR ELECTRIC SHOCK, DO NOT EXPOSE THIS APPARATUS TO RAIN OR MOISTURE AND OBJECTS FILLED WITH LIQUIDS, SUCH AS VASES, SHOULD NOT BE PLACED ON THIS APPARATUS.**
- » Use the mains plug to disconnect the apparatus from the mains.
- » **THE MAINS PLUG OF THE POWER CORD MUST REMAIN READILY ACCESSIBLE.**
- » Do not defeat the safety purpose polarized or grounding-type plug. A polarized plug has two blades with one wider than the other. A grounding-type plug has two blades and a third grounding prong. The wide blade or the third prong is provided for your safety. If the provided plug does not fit into your outlet, consult an electrician for replacement of your obsolete outlet. **Caution! To reduce the risk of electrical shock, grounding of the center pin of this plug must be maintained.**
- » Protect the power cord from being walked on or pinched particularly at the plugs, convenience receptacles, and the point where they exit from the apparatus.
- » Do not block the air ventilation openings. Only mount the equipment per Intelix’s instructions.
- » Use only with the cart, stand, table, or rack specified by Intelix or sold with the equipment. When/if a cart is used, use caution when moving the cart/equipment combination to avoid injury from tip-over.
- » Unplug this apparatus during lightning storms or when unused for long periods of time.
- » **Caution! Shock Hazard. Do not open the unit.**
- » Refer to qualified service personnel. Servicing is required when the apparatus has been damaged in any way, such as power supply cord or plug is damaged, liquid has been spilled or objects have fallen into the apparatus, the apparatus has been exposed to rain or moisture, does not operate normally, or has been dropped.



Installation Instructions

Mounting

The Novitizer can be mounted onto a wall or by using a stand, not included. If you need a stand please contact Liberty AV Solutions for the NOVI-STD stand for the Novitizer.

Fill the Hand Sanitizer Tank

The Novitizer comes with two keys to lock and unlock the kiosk system. Use one of the supplied keys to unlock the unit, then lift the white casing UP to access the tank dispenser.

The unit unlocks and opens up underneath near the sanitizer dispenser as seen below.



Remove the dispenser tank from inside the kiosk, there are no cords or electronics attached to the tank so you can remove in one piece with one tug. Unscrew the nozzle from the tank, then refill the tank with any liquid, gel or foam sanitizer. Reattach the nozzle to the tank then place the tank and nozzle assembly back into the kiosk. Close the white panel casing and lock with the key.

A pic below shows the tank and nozzle assembly inside the kiosk.



Connect Keyboard and Mouse

To navigate the Android operating system of the Novitizer kiosk, connect a wired or wireless keyboard and mouse to the USB connection to the right side of the kiosk as seen below.

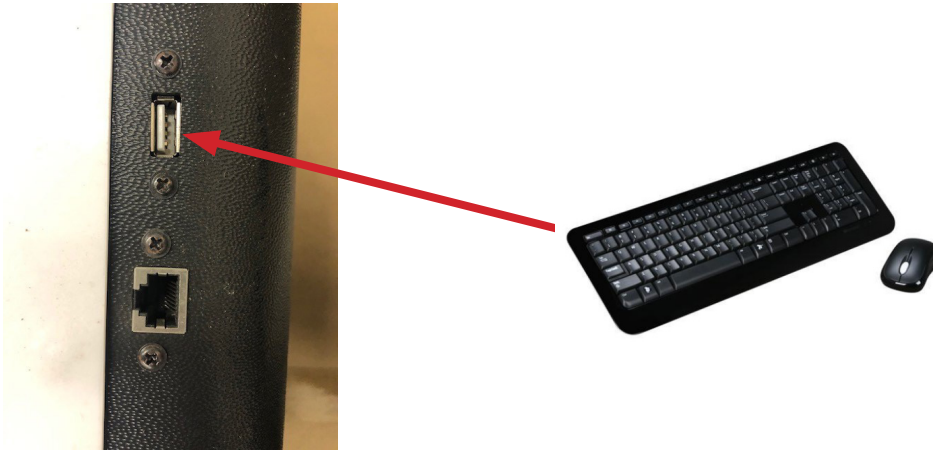

Apply Power

Connect the attached power cord to a power outlet, the device will automatically turn on. If the unit does not turn on use the supplied remote control to turn the unit on by holding down the POWER button.

Novisign Digital Signage Player APP

The Novisign Digital Signage Player APP has been pre-installed for convenience on the Novitizer kiosk. Below are the instructions for using the Player APP.

NOTE: A Novisign 12 month digital signage cloud license is included in the purchase of a Novitizer. Login to the Novisign cloud content management service online at www.novisign.com with your user name and password to create digital signage content for the Novitizer. Use a 9:16 template for the aspect ratio for the content to play in portrait mode on the Novitizer kiosk.

When the Novitizer powers ON, content from the Novisign APP player maybe in test / demo mode. To access the Android desktop, right click your mouse as right click in the Android OS is to 'go back one step'. To connect the kiosk to the Internet either use an Ethernet cable to connect the kiosk physically to a LAN on the right side of the kiosk or connect the device to WiFi. Click on *SETTINGS* on the Android desktop to login to the WiFi SSID of your choice in your area.

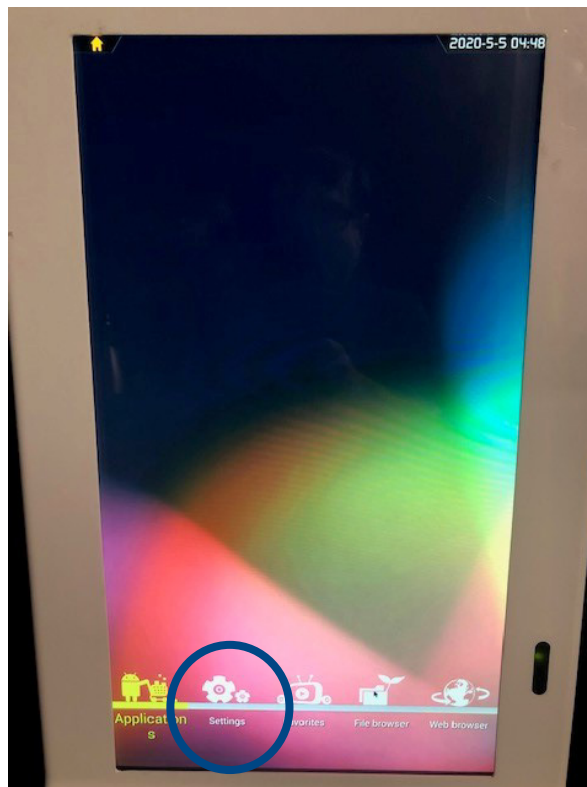

NOTE: If using the WiFi option be sure the included WiFi antenna is connected to the top of the kiosk.

Once the Novitizer is online, click on the *APPLICATIONS* icon bottom left of the desktop.



Navigate to and click on the Novisign Player APP in the applications folder

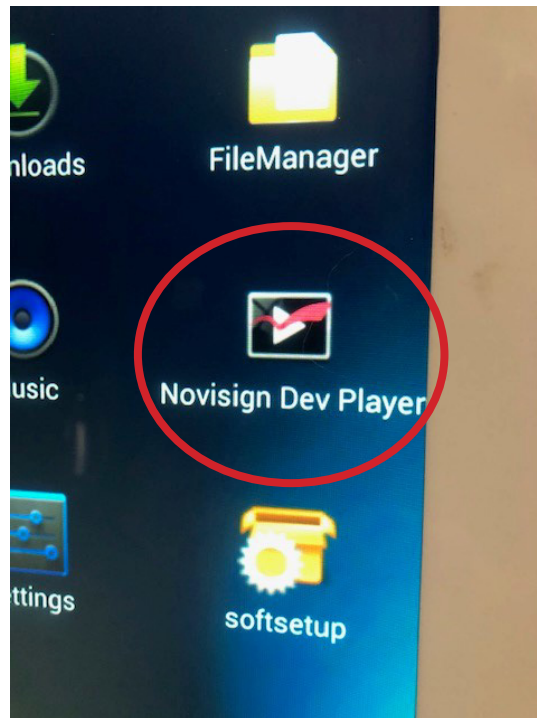

Login to the player APP with your Novisign user name and password at the top right of the APP

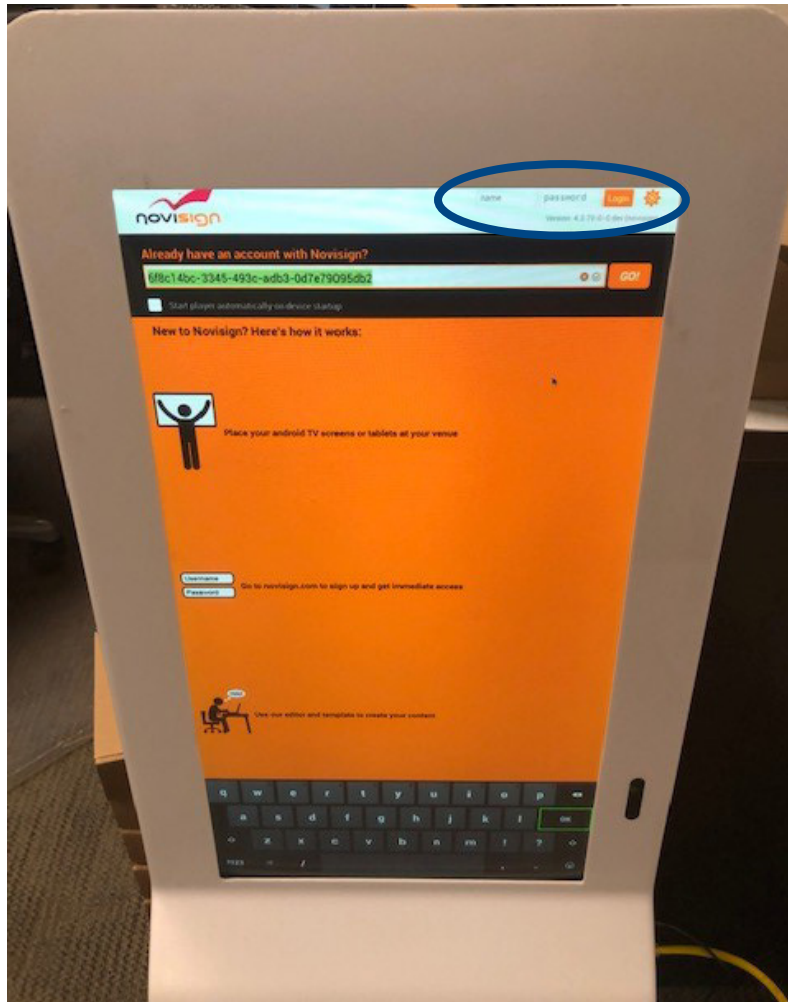

Once logged in, choose the digital signage content you would like to display on the kiosk screen by clicking the open field to show available *screens* in your license

You can choose to have the APP play automatically on device startup, simply check the box below the screen field for this option. This is a best practice to use this option in case the device is rebooted by accident. To disengage the auto play option, simply connect a wireless USB mouse to the device and right click the mouse to access the APP option or click once more for the desktop.

Click *GO*. Your digital signage content will now play.

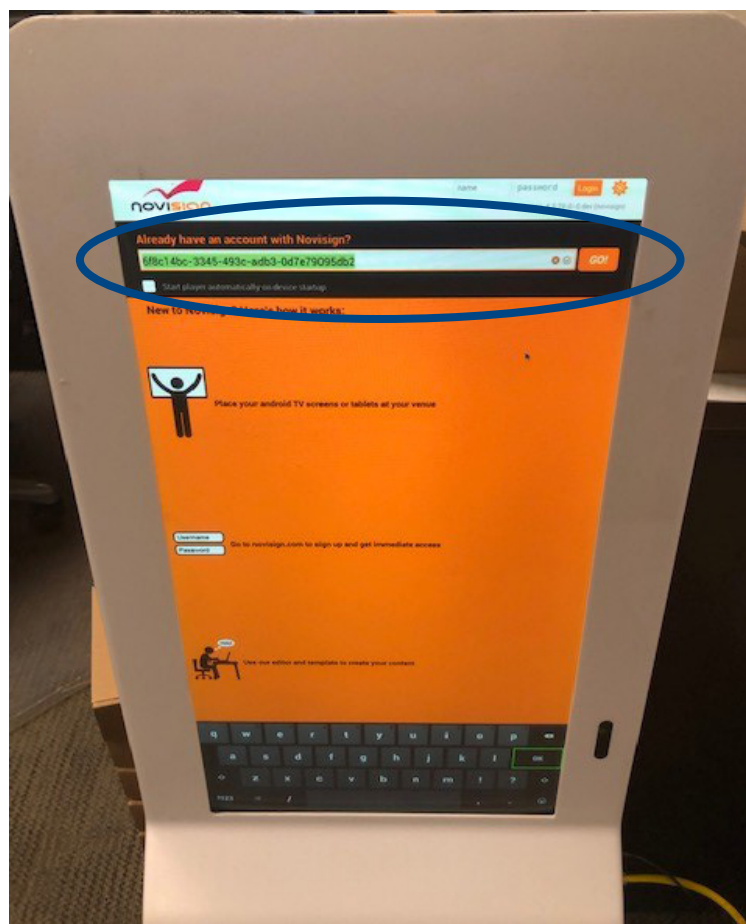

Thank you for your purchase.

For Technical Support please call our toll free
number at 800-530-8998 or email us at supportli-
bav@libav.com

www.libav.com

Digitalinx is a brand of:



LIBERTY[®]
AV SOLUTIONS
A SUBSIDIARY OF WESCO DISTRIBUTION, INC.