

## FHDQ163



### Wireless content sharing

Simplify collaboration with the TapCast Pro companion app. Easily cast images, documents and screen share from up to four simultaneous supported devices<sup>1</sup>.



**WIDE VIEWING ANGLE:** Smooth screen surface and 170° wide viewing angle with robust 4-in-1 SMD LED



**OPTIMIZED IMAGE:** Stunning out-of-the-box image quality with 1.9mm pixel pitch and pre-calibration



**MOBILE DEVICE CONTROL:** Control and manage digital media via the Fusion Connect app for iOS and Android



**QUAD PIXEL TECHNOLOGY:** Unique quad pixel design with advanced contrast boosting for darker black levels and brighter whites



**INTEGRATED SCALER:** Calibre HQUltra 4K image processing technology delivers lightning-fast switching & sharp scaling



**ONSCREEN DISPLAY:** OSD provides easy access to display settings and functions directly with a remote



**SINGLE POWER CABLE:** A single 240V power cable delivers the necessary voltage and wattage; < 0.5 watts standby

Experience stunning, larger-than-life visuals with the 163-inch Optoma FHDQ163 All-in-One Direct View LED display. Employing a unique packaging process, the all-in-one LED display easily installs in three steps, bringing a beautiful large format display in hours, not days.

Image optimizations ensure every FHDQ163 is ready to impress with richer colors, brighter whites and deeper black levels without a time-consuming calibration process – every display is pre-calibrated. Calibre HQUltra 4K image processing technology provides 4K source compatibility, lightning-fast input switching and image scaling that makes all video sources and input resolutions look its best.

### Expandable

Combine multiple FHDQ163 displays to create a seamless display. The extra-slim, removable bezel makes creating massive displays easy.

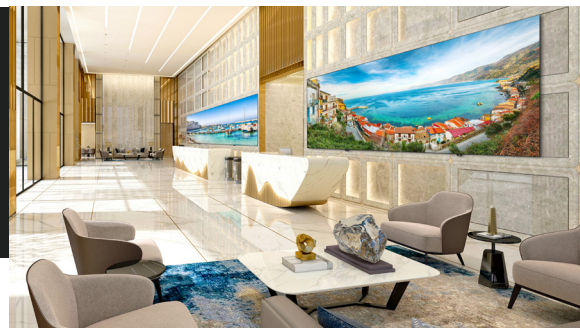

### Quick and simple installation - three step process

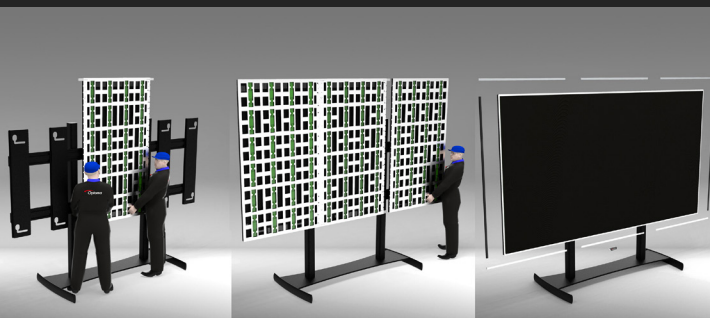

An easy three step installation process eliminates the build and installation complexities of traditional direct-view LED displays for a quick and easy 163-inch visual experience. Simply mount the display sections on the bracket, either on a wall or optional stand, apply LED tiles, and connect power. This unique pre-build process dramatically reduces installation time from days to hours.

### Ambient light sensor

An integrated ambient light sensor enables the FHDQ163 to automatically adjust the brightness depending on available light. The dynamic brightness ensures the display is always at optimal brightness for visibility and eye comfort.

**Flight case included**

The FHDQ163 ships in a rugged and flexible flight case for enhanced protection. Its flexible three-part design can separate into three smaller and lighter pieces for easier transport.



**Add the flexibility of Windows 10**

Optoma offers optional full-fledged PCs with Intel Core i5 and i7 processors that slot into the FHDQ163 and enhance the computing capabilities. The Windows 10 operating system is not included, letting system administrators easily integrate the OPS2<sup>1</sup> slot-in PCs with existing volume licensing.



OPS2-i5 | OPS2-i7



**SPECIFICATIONS**

**DISPLAY**

NATIVE RESOLUTION	1080p Full HD (1920 x 1080)
MAXIMUM INPUT RESOLUTION	4K UHD (3840 x 2160) @ 30Hz
SCREEN SIZE	163" (diagonal), 141.73" x 79.72" (WxH)
MINIMUM VIEWING DISTANCE	6.23'
BRIGHTNESS	600 nits (calibrated)
BRIGHTNESS CONTROL LEVELS	1 to 100% steps
CONTRAST	5,000:1
VIEWING ANGLE	170°/170° (vertical/horizontal)
INGRESS PROTECTION (IP CERTIFICATION)	IP40 (front), IP20 (back)
FRAME COLOR	Black
LED TILES	Front access

**COLOR**

GREYSCALE PROCESSING DEPTH	16-bit
COLORS	281 trillion
REFRESH RATE	3840 Hz

**IMAGE PROCESSING**

VIDEO PROCESSOR	Integrated image scaler and switching
SENDER	Integrated sender

**LED TILES**

PIXEL PITCH (H X V)	1.875 mm
LEDS PER PIXEL	3
PIXEL CONFIGURATION	Quad SMD
LED COLOR (OFF)	Black
LED TYPE	4-in-1 SMD
PIXEL RESOLUTION	128 pixels (width) / 72 pixels (height)
PIXELS PER AREA	284,444 pixels/m <sup>2</sup>

**SPECIFICATIONS**

**CONNECTIVITY**

INPUTS	2x HDMI, 1x HDBaseT, 1x 3D-SDI, 2x USB 2.0 (Wi-Fi adapter, USB storage), 1x RS232,
OUTPUTS	1x HDMI, 1x audio (3.5mm), 1x RS232, 1x IR (3.5mm),
FILE COMPATIBILITY	.ts .mp4 .avi .mkv .mov .bmp .jpg .png .jpeg
CONNECTIVITY	1x RJ45, Wi-Fi (included USB adapter), RS232
CONTROL	LAN, RS232, Fusion Connect Mobile App

**PHYSICAL SPECIFICATIONS**

WEIGHT	432.1 lbs.
DIMENSIONS (W X H X D)	142" x 80" x 1.42"
DEPTH (WITH MOUNT)	3.9" Meets ADA guidelines for digital signage (doesn't stick out more than 4" from wall). Please consult your system integrator for ADA compliant digital signage.
STORAGE TEMPERATURE RANGE	14°F - 140°F (-10°C - 60°C)
OPERATING TEMPERATURE (MAX)	104°F
INPUT VOLTAGE	200-240 VAC
INPUT POWER (MAX)	3,000 watts
POWER (STANDBY)	<0.5 watts
LIFESPAN	100,000 hrs

**Warranty**

2 Year parts and labor limited warranty

**What's in the Box**

FHDQ163, remote, USB Wi-Fi adapter, tile removal tool, spare LED tiles, wall mount, flight case, 2x removable grip handles

**Accessories**

Floor stand: ODM03MFS  
Spare LED tile: FHDQT163

UPC 796435 69 026 7