

HA-200

Basic User Manual - Setup | Grundlegende Bedienungsanleitung - Einrichtung |
Manuel d'utilisation de base - Configuration | Manual básico del usuario - Configuración |
基礎使用手冊 - 設定 | 基本用戶手冊 - 設置 | 基本ユーザーマニュアル - 設定 | 기본 사용 설명서 - 설정



NuForce HA-200



Power Cord



1

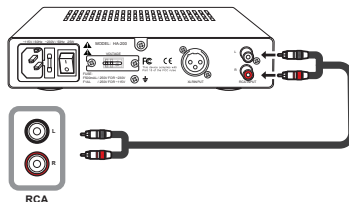

Balanced Mode

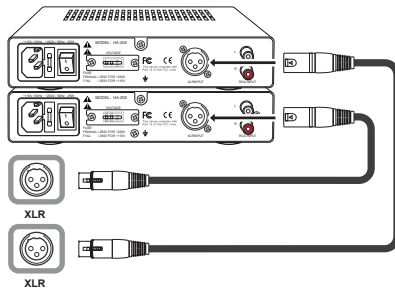

2

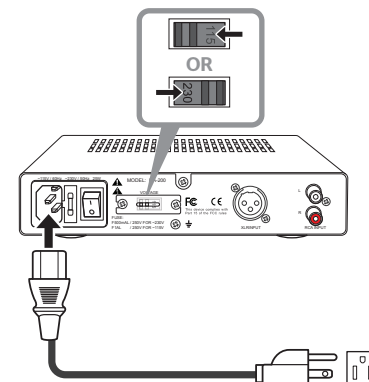

3

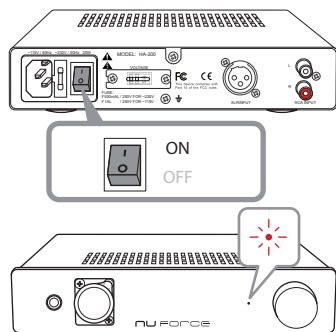

4

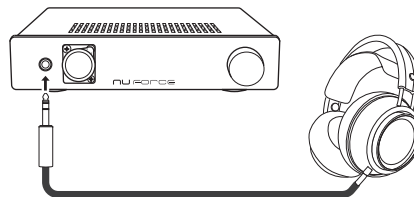

Balanced Mode

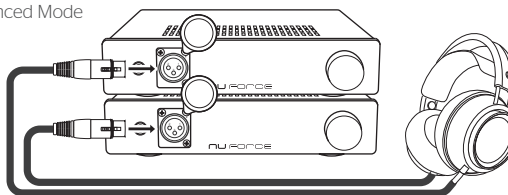

5

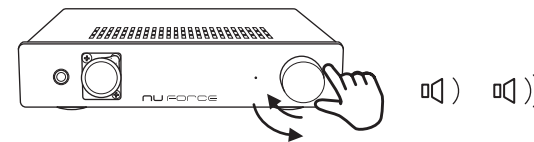

Touchboards

205 Westwood Ave, Long Branch, NJ 07740
Phone: 866-94 BOARDS (26273) / (732)-222-1511
Fax: (732)-222-7088 | E-mail: sales@touchboards.com



nuforce.optoma.com



www.optoma.com