

Installation and Assembly - Monitor Desktop Stand

Models: LCV-100

IMPORTANT! Read entire instruction sheet before you start installation and assembly.

MAX Load Capacity:

IMPORTANT! The product is made to support screens with a VESA compliant hole pattern.

25 lb (11.4KG)

For safe mounting, mounting screws must turn at least three times in the screen inserts.

Parts List

		LCV-100	
Description	Qty.	Part #	
A mount assembly	1	091-1091	
B 3mm allen wrench	1	560-0073	
C mounting base	1	091-1089	
D adapter plate	1	095-4354	
E M4 x 8mm countersink screw	4	520-1795	
F M4 x 10mm phillips screw	4	520-1796	
G wood screw #14 x 1	4	510-9159	
H hex bolt	1	-	
I hex nut	1	-	
J M4 x 0.7mm nut	4	530-1082	
K pressure plate	1	-	

LCV-100

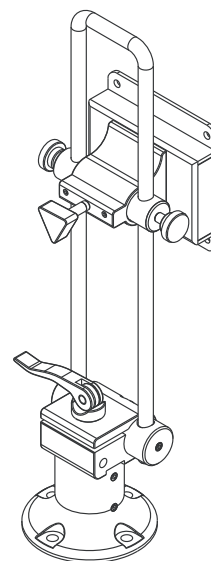

NOTE: You may not use all hardware provided.

NOTE: Some parts may not appear exactly as illustrated.

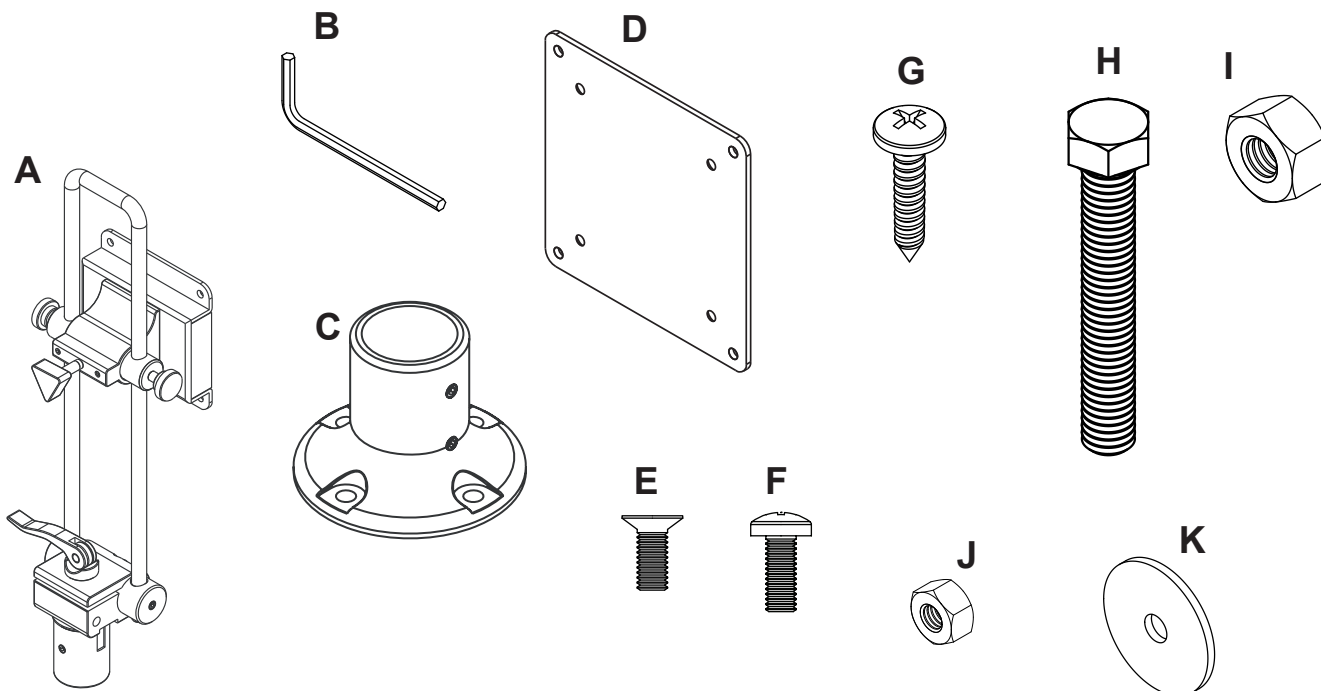

- 1** Remove telescopic pedestal (A) from mounting base (C) by loosening set screws (B) where shown with 3 mm allen wrench (B).

Touchboards

205 Westwood Ave, Long Branch, NJ 07740
Phone: 866-94 BOARDS (26273) / (732)-222-1511
Fax: (732)-222-7088 | E-mail: sales@touchboards.com

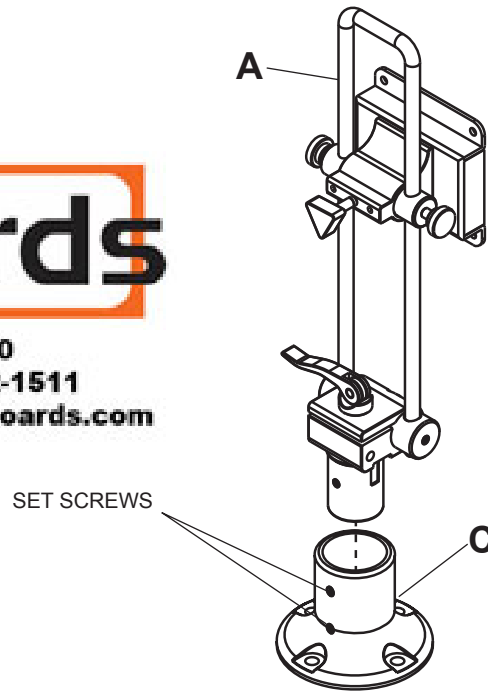

2

⚠ CAUTION

- Mount must be installed on wood and/or wood composition surfaces of at least 3/4" thick. However, the installer must ensure that the mounting surface will safely hold the combined weight of the mount and the screen. See other mounting requirements below.

There are two methods of installation. Follow step 2-1 for installation using hex bolt and pressure plate or step 2-2 using four wood screws.

- 2-1** Mark hole on desktop for positioning mount. Drill one 1/2" dia. hole through desktop. Attach mounting base (C) to desktop using hex bolt (H), pressure plate (K), and hex nut (I). Tighten nut using proper sized wrench.
- Important!** Mount is to be installed onto desktops 3/4" to 1-5/8" thick only! For thicker mounting surfaces, you may have to provide your own hardware.

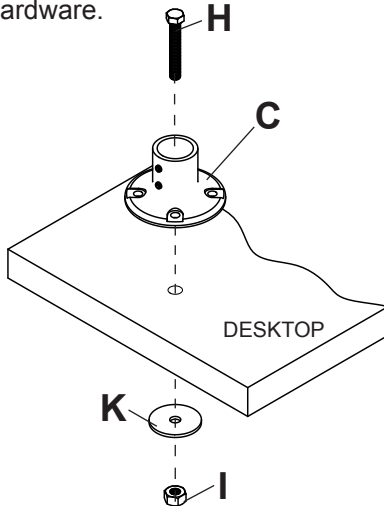

- 2-2** Use four holes on mounting base (C) to mark holes on desktop for positioning mount. Drill four 3/16" dia. holes through desktop. Attach mounting base (C) to desktop using four wood screws (G).

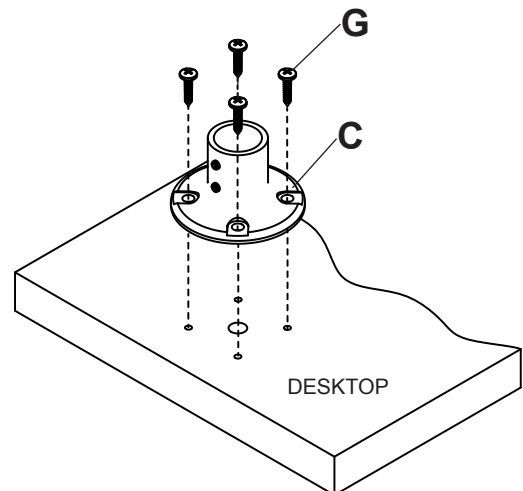

- 3** Insert telescopic pedestal (**A**) into mounting base (**C**). Tighten set screws where shown with 3 mm allen wrench (**B**).

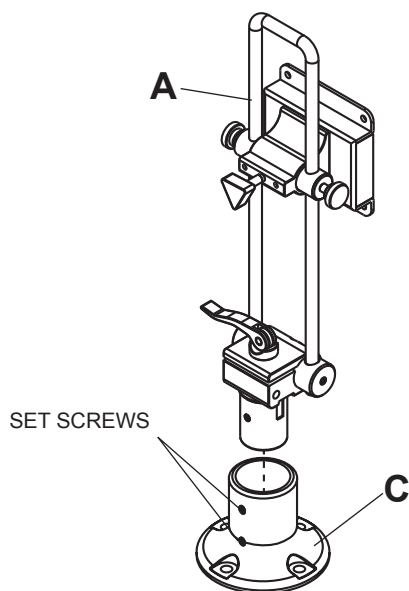

- 4** To install to a **VESA 75 mm standard LCD monitor**, attach mount assembly (**A**) to back of LCD monitor using four M4 x 10 mm phillips screws (**F**) as shown.

Skip to step 6.

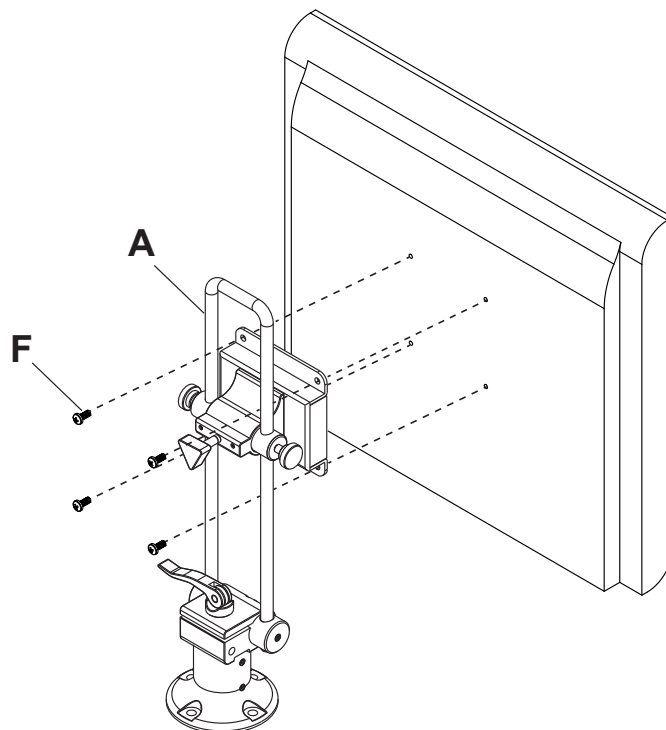

- 5** To install to a **VESA 100 mm standard LCD monitor**, attach adapter plate (**D**) to mount assembly (**A**) using four M4 x 8 mm phillips screws (**E**) and four M4 x 0.7mm nuts (**J**) as shown in **detail 1**. Attach mount assembly (**A**) to back of LCD monitor using four M4 x 10 mm phillips screws (**F**) as shown in **detail 2**.

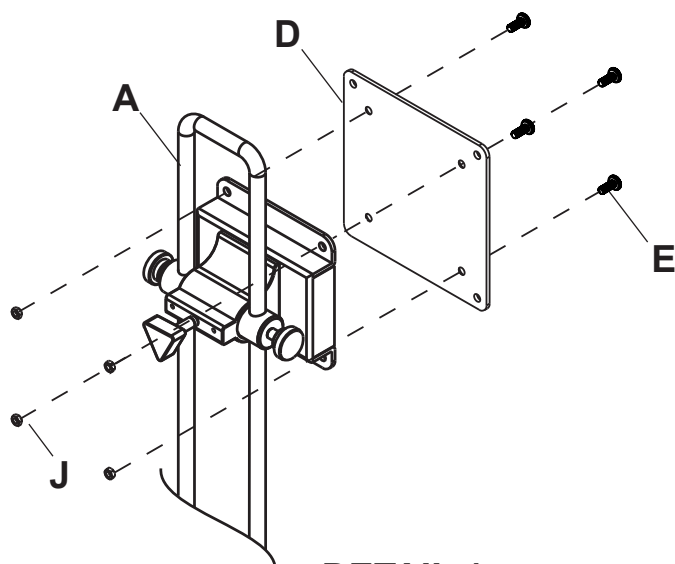

DETAIL 1

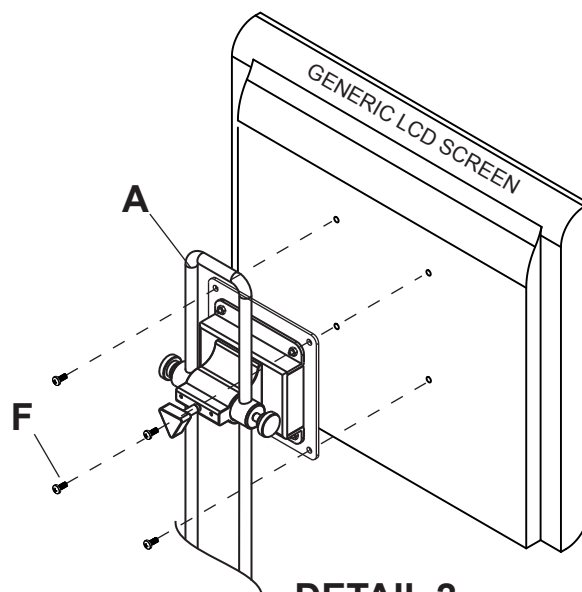

DETAIL 2

- 6** To adjust tilt position, hold the screen with one hand and loosen the handle as shown in **detail 3**. Adjust the screen then tighten handle.

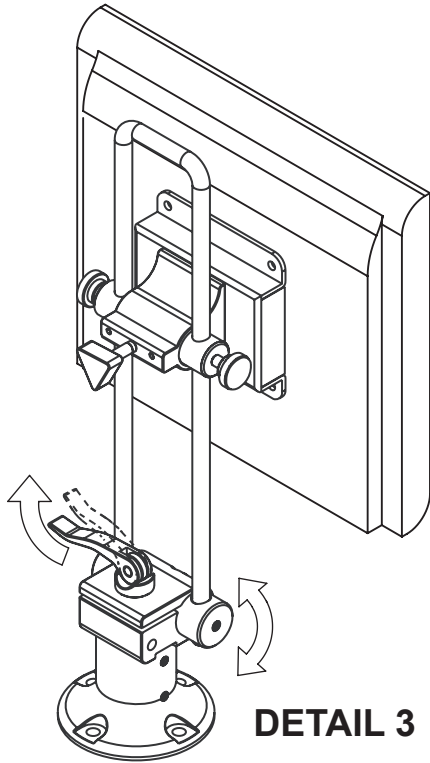

To adjust height position, hold the screen with one hand and turn the circular knobs counterclockwise as shown in **detail 4**. Adjust the screen then tighten knobs.

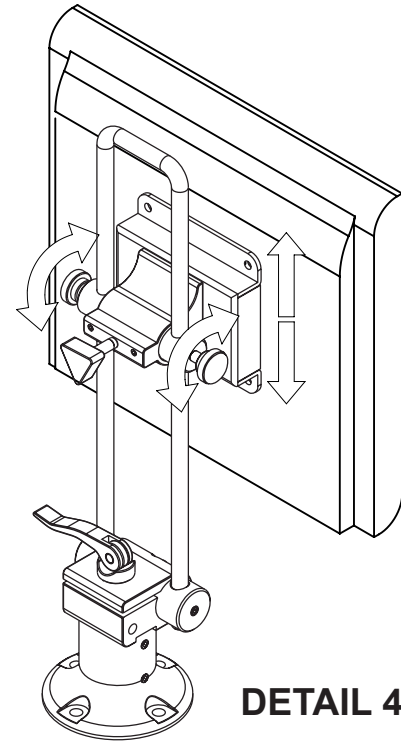

To adjust tilt position of display, turn the triangular shaped knob, adjust display to the desired angle shown in **detail 5** then tighten knob. For screens 15 lbs and over, it may be necessary to tighten set screws with the 3mm Allen wrench (**B**).

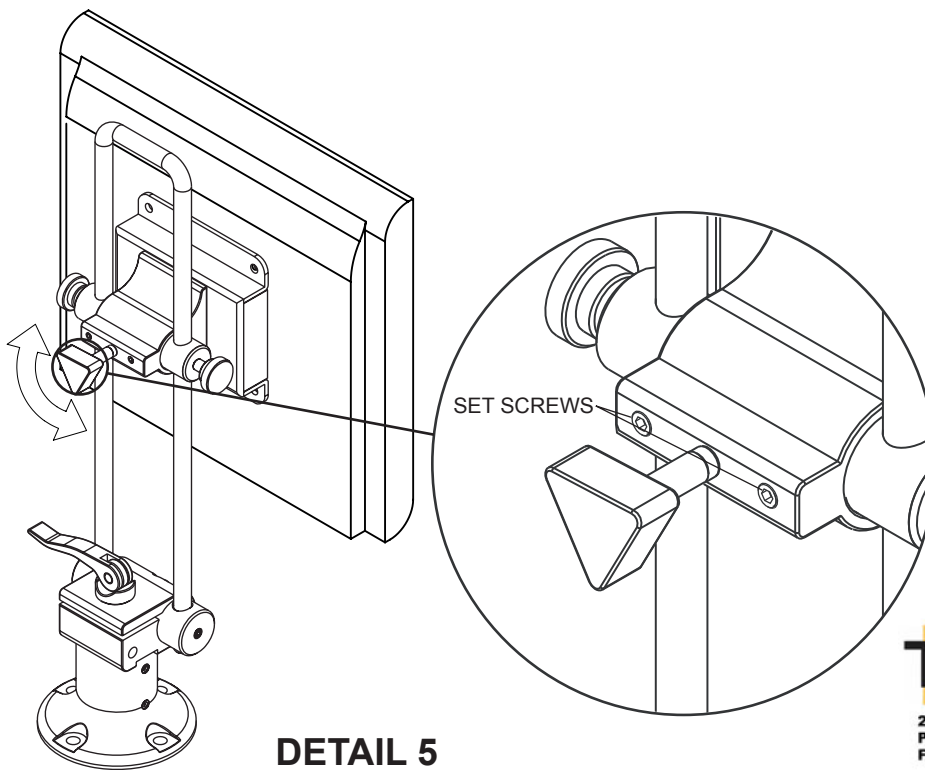

Touchboards

205 Westwood Ave, Long Branch, NJ 07740
Phone: 866-94 BOARDS (26273) / (732)-222-1511
Fax: (732)-222-7088 | E-mail: sales@touchboards.com