

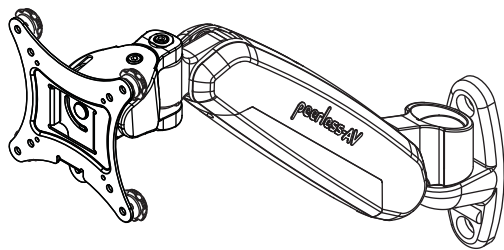

Installation and Assembly:
Wall Mount for 19" - 30" LCD Screens

Models: LCW420A, LCW620A



LCW420A

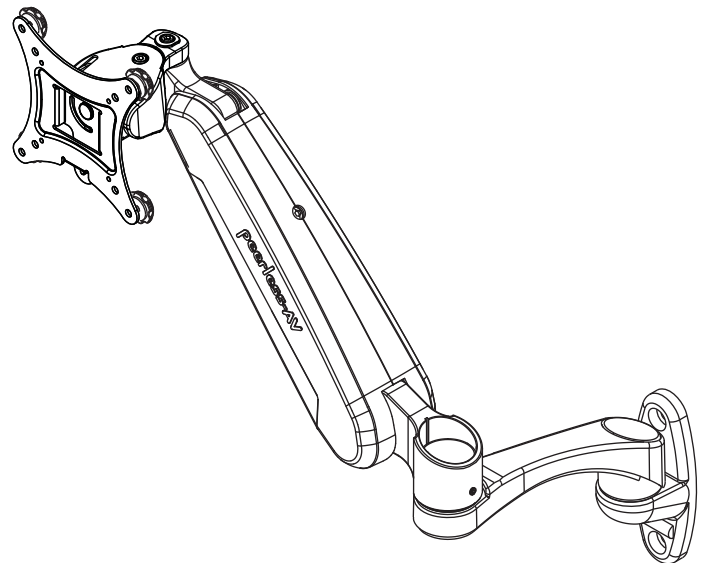

LCW620A

Touchboards

205 Westwood Ave, Long Branch, NJ 07740
Phone: 866-94 BOARDS (26273) / (732)-222-1511
Fax: (732)-222-7088 | E-mail: sales@touchboards.com

Max Load Capacity: 15 lbs (6.8 kg)

NOTE: Read entire instruction sheet before you start installation and assembly.

WARNING

- Do not begin to install your Peerless product until you have read and understood the instructions and warnings contained in this Installation Sheet. If you have any questions regarding any of the instructions or warnings, please call Peerless customer care at 1-800-865-2112.
- This product should only be installed by someone of good mechanical aptitude, has experience with basic building construction, and fully understands these instructions.
- Make sure that the supporting surface will safely support the combined load of the equipment and all attached hardware and components.
- Never exceed the Maximum Load Capacity. See page 1.
- Always use an assistant or mechanical lifting equipment to safely lift and position equipment.
- Tighten screws firmly, but do not overtighten. Overtightening can damage the items, greatly reducing their holding power.
- This product is intended for indoor use only. Use of this product outdoors could lead to product failure and personal injury.

Tools Needed for Assembly

- phillips screwdriver
- drill
- 5/32" (4mm) drill bit for wood stud
- 3/8" (10mm) drill bit for solid concrete or cinder block

Table of Contents

Parts List.....	3
Installation to Wood Stud Wall.....	4
Installation to Solid Concrete or Cinder Block	5
Attaching Arm Assembly to Screen	6

Before you begin, make sure all parts shown are included with your product.

Parts List		
Description	LCW420A Qty	LCW620A Qty
A wall plate	1	1
B single link arm assembly	1	-
double link arm assembly	-	1
C wood screw	2	2
D M6 washer	2	2
E concrete anchor	2	2
F M4 x 12 mm phillips screw	4	4
G M4 x 25 mm phillips screw	4	4
H spacer	4	4
I 4 mm allen wrench	1	1
J 2.5 mm allen wrench	1	1
K M6 x 12 mm phillips screw	1	1
L M6 plastic washer	1	1
M cover	1	1
N cable tie	5	5

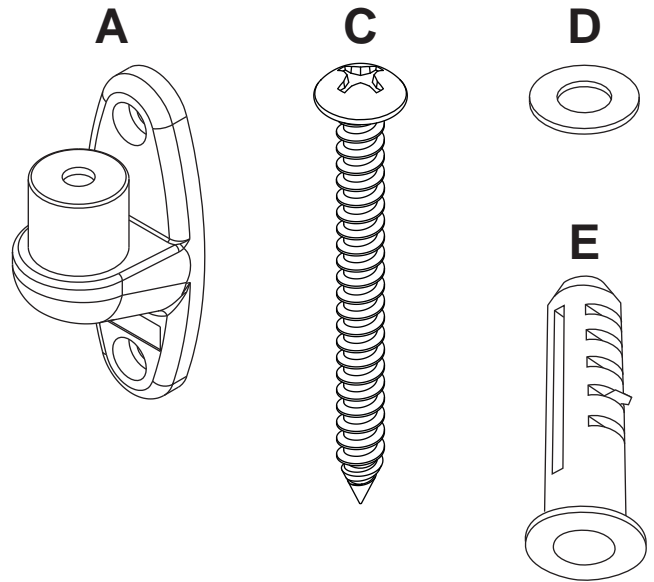

Parts may appear slightly different than illustrated.

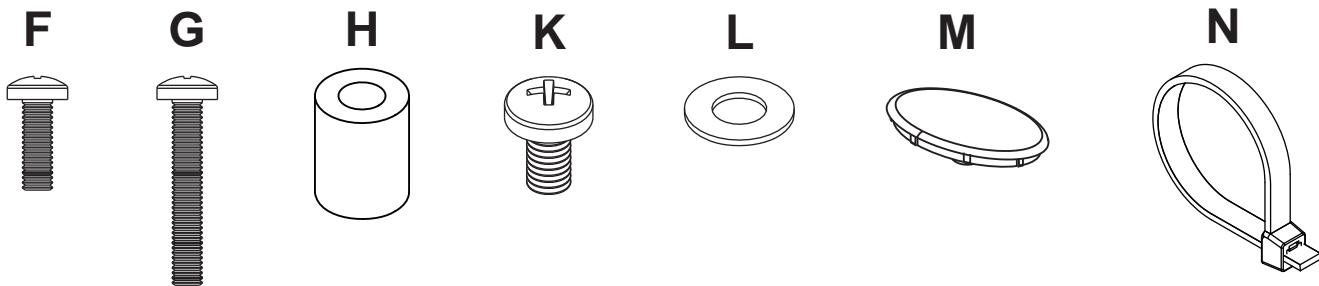
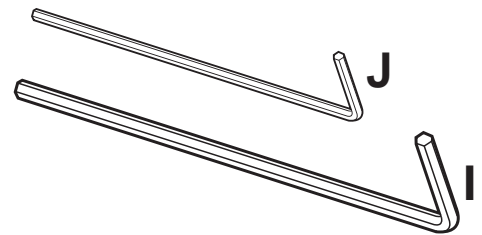
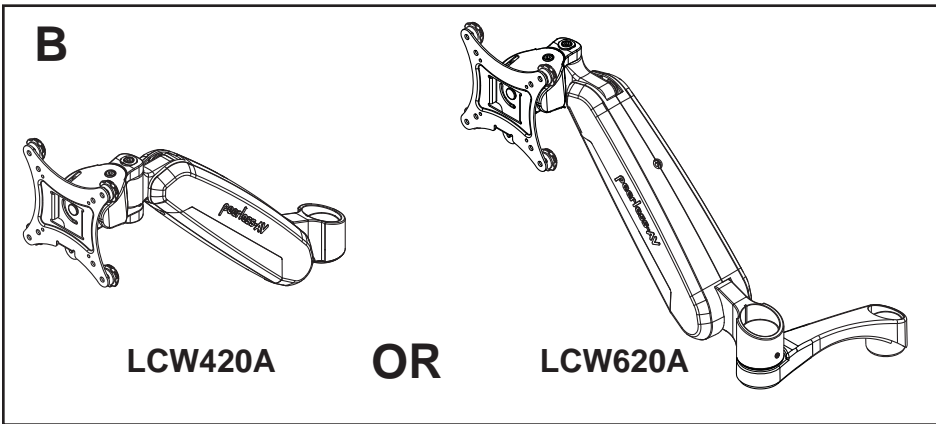

Installation to Wood Stud Wall

⚠ WARNING

- Installer must verify that the supporting surface will safely support the combined load of the equipment and all attached hardware and components.
- Tighten wood screws so that wall plate is firmly attached, but do not overtighten. Overtightening can damage the screws, greatly reducing their holding power.
- Never tighten in excess of 80 in. • lb (9 N.M.).
- Make sure that mounting screws are anchored into the center of the stud. The use of an "edge to edge" stud finder is highly recommended.
- Hardware provided is for attachment of mount through standard thickness drywall or plaster into wood studs. Installers are responsible to provide hardware for other types of mounting situations.

- 1 Use a stud finder to locate the edges of the studs and draw a vertical line down the stud's center. Place wall plate (A) on wall as a template. Drill two 5/32" (4mm) dia. holes to a depth of 2" (50mm). Attach wall plate (A) to wall with two wood screws (C) and two M6 washers (D).

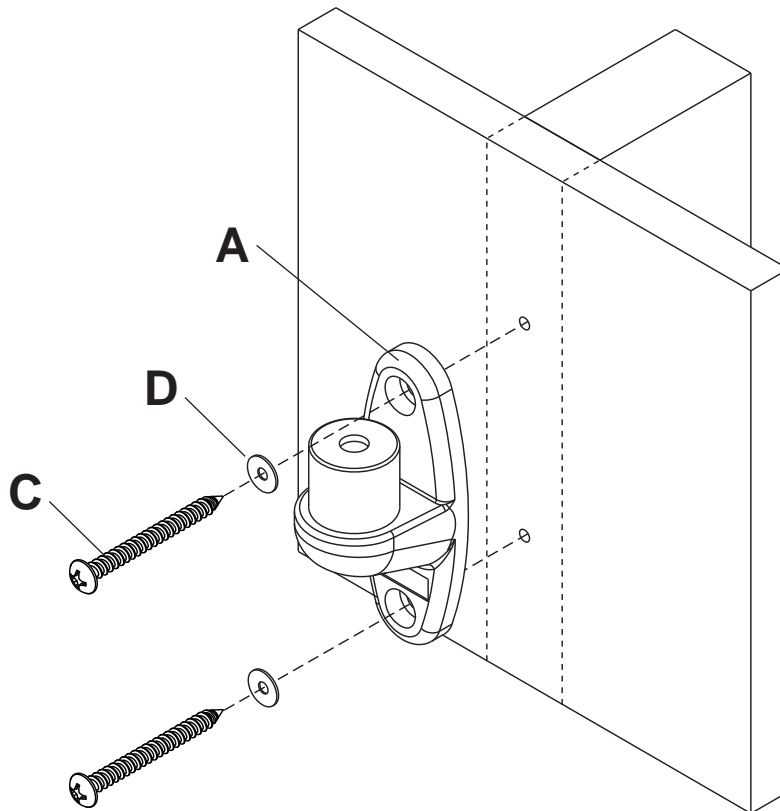

Installation to Solid Concrete and Cinder Block

⚠ WARNING

- When installing Peerless wall mounts on cinder block, verify that you have a minimum of 1-3/8" (35mm) of actual concrete thickness in the hole to be used for the concrete anchors. Do not drill into mortar joints! Be sure to mount in a solid part of the block, generally 1" (25mm) minimum from the side of the block. Cinder block must meet ASTM C-90 specifications. It is suggested that a standard electric drill on slow setting is used to drill the hole instead of a hammer drill to avoid breaking out the back of the hole when entering a void or cavity.
- Concrete must be 2000 psi density minimum. Lighter density concrete may not hold concrete anchor.
- Make sure that the supporting surface will safely support the combined load of the equipment and all attached hardware and components.

- 1** Use wall plate as template to mark center of holes. Drill two 3/8" (10mm) dia. holes to a minimum depth of 2.5" (64mm). Insert anchors (E) into holes. Place wall plate (A) over anchors and attach to wall with two wood screws (C) and two M6 washers (D).

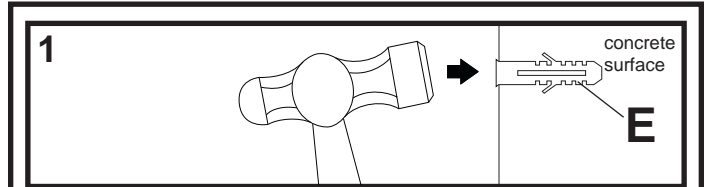

Drill holes and insert anchors (E).

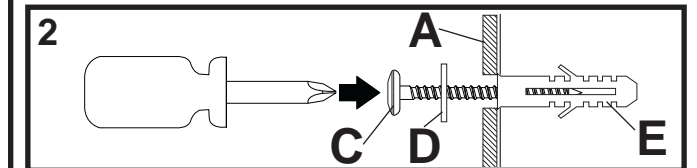

Place plate (A) over anchors (E) and secure with screws (C).

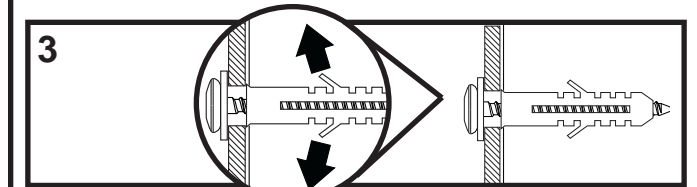

Tighten all fasteners.

⚠ WARNING

- Tighten screws so that wall plate is firmly attached, but do not overtighten. Overtightening can damage screws, greatly reducing their holding power.
- Never tighten in excess of 80 in. • lb (9 N.M.).
- Always attach concrete expansion anchors directly to load-bearing concrete.
- Never attach concrete expansion anchors to concrete covered with plaster, drywall, or other finishing material. If mounting to concrete surfaces covered with a finishing surface is unavoidable, the finishing surface must be counterbored as shown below. Be sure concrete anchors do not pull away from concrete when tightening screws. If plaster/drywall is thicker than 5/8" (16mm), custom fasteners must be supplied by installer.

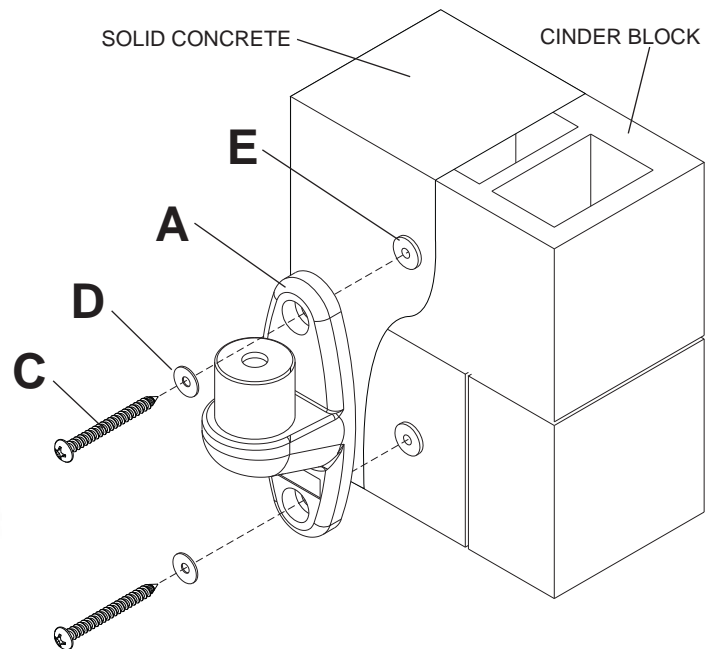
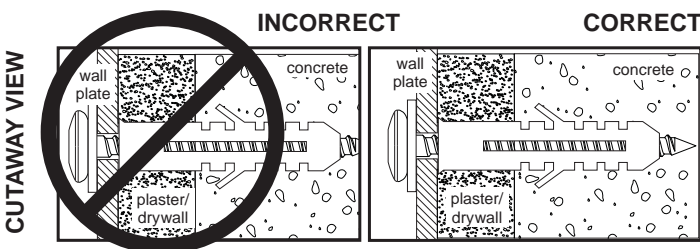

Touchboards

205 Westwood Ave, Long Branch, NJ 07740
 Phone: 866-94 BOARDS (26273) / (732)-222-1511
 Fax: (732)-222-7088 | E-mail: sales@touchboards.com

Attaching Adapter Plate to Screen

⚠ WARNING

- Tighten screws so adapter plate is firmly attached. Do not tighten with excessive force. Overtightening can cause stress damage to screws, greatly reducing their holding power and possibly causing screw heads to become detached. Tighten to 40 in. • lb (4.5 N.M.) maximum torque.
- If screws don't get three complete turns into the screen inserts or if screws bottom out and arm is still not tightly secured, damage may occur to screen or product may fail.

2 **OPTIONAL:** To disassemble adapter plate from arm assembly (**B**), remove knob attached to bottom of adapter plate as shown in figure 2.1.

2-1 To prevent scratching the screen, set a cloth on a flat, level surface that will support the weight of the screen. Place screen face side down. If screen has knobs on the back, remove them to allow the adapter plate to be attached. Place adapter plate on back of screen.

Choose hole pattern as shown in detail 1.

FOR DISPLAYS WITH FLAT BACKS: Attach adapter plate to display using four knobs or remove four knobs and secure with 12mm screws (**F**) as shown in figure 2.2.

FOR DISPLAYS WITH RECESSED BACKS: Remove knobs from adapter plate and attach to display using four 25mm screws (**G**) and four spacers (**H**) as shown in figure 2.3.

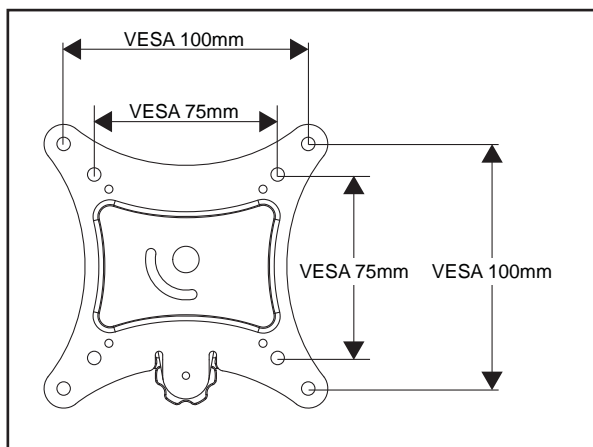
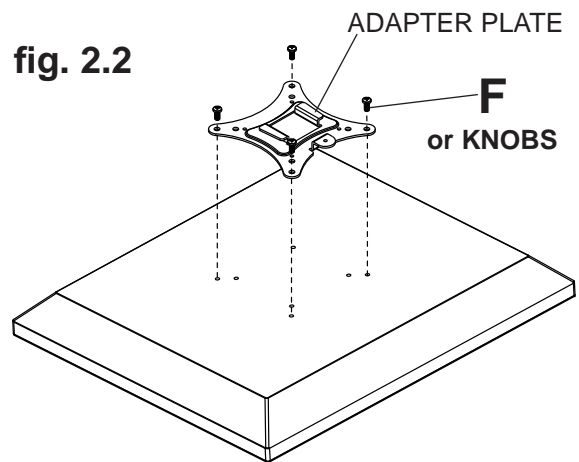
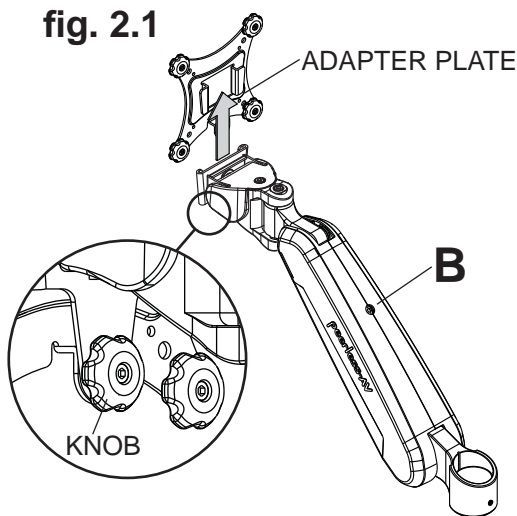

DETAIL 1

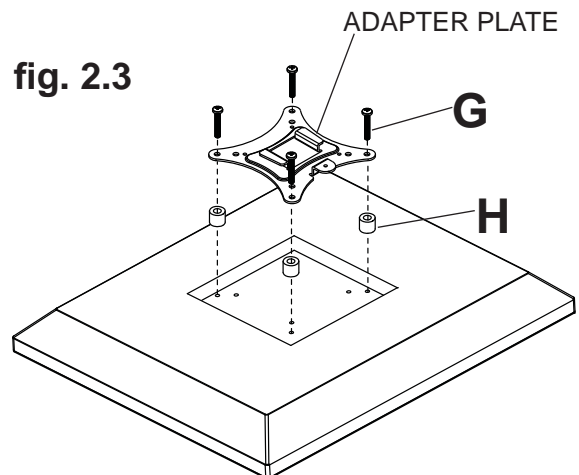

- 3 Insert arm assembly (B) onto wall plate (A) as shown in figure 3.1.
Tighten set screw on rear of arm assembly (B) using 2.5mm allen wrench (J) as shown in figure 3.2.

fig. 3.1

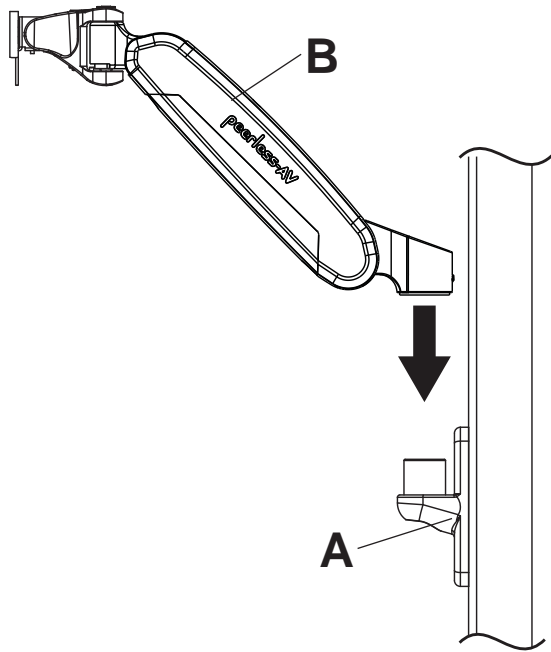
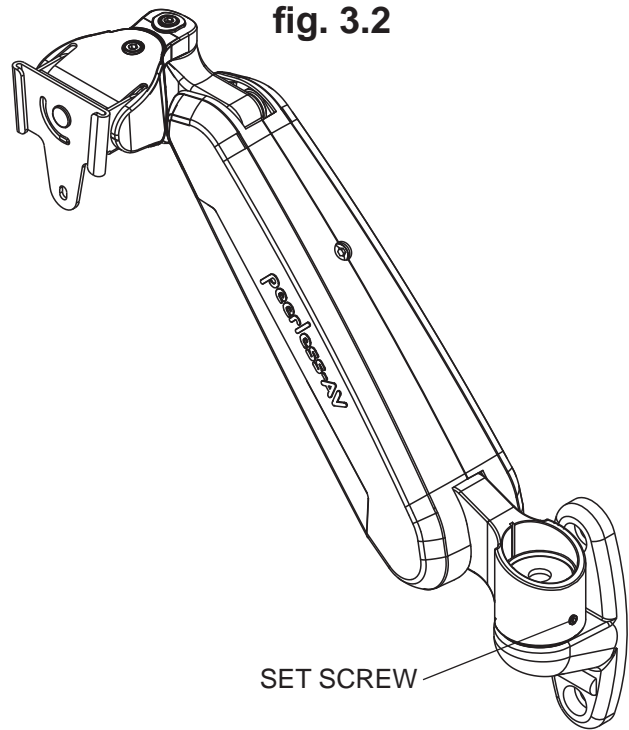
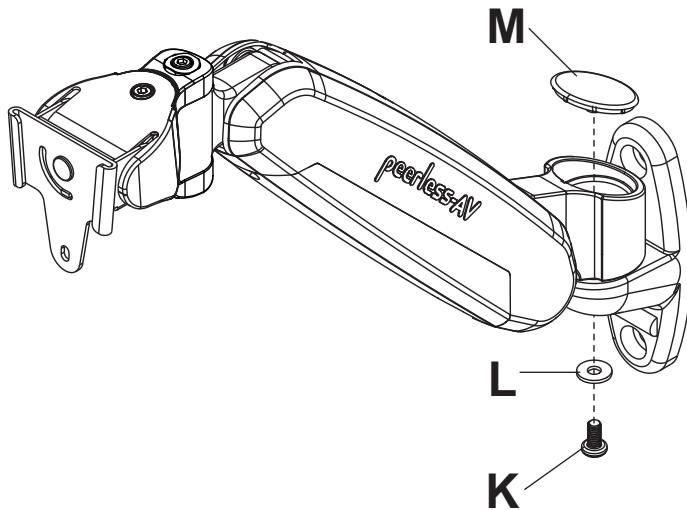

fig. 3.2



- 4 Secure arm assembly (B) to wall plate (A) with one M6 x 12mm phillips screw (K), one M6 plastic washer (L), and cover (M).



- 5 Hook adapter plate onto arm assembly (B).

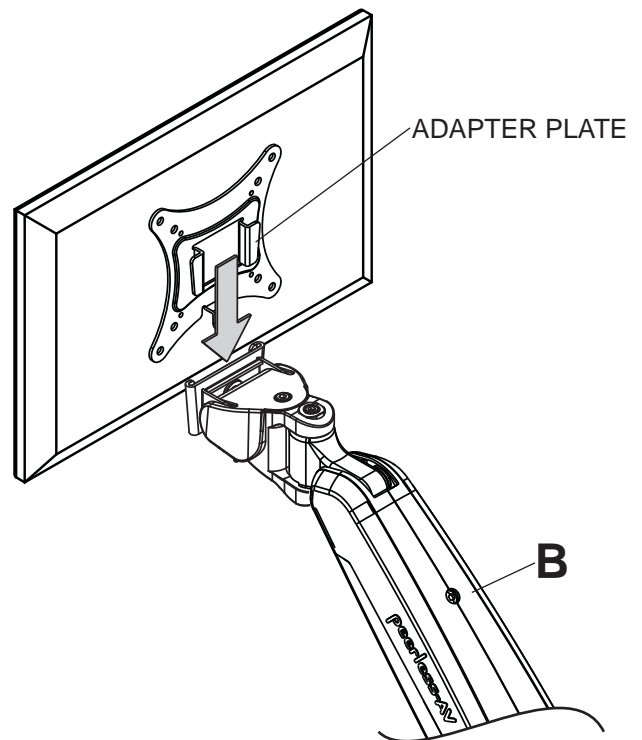

- 7 Cables may be routed using cavity in arm assembly (B). Remove the cable cover on arm assembly (B) by pressing firmly in the middle of the cable cover and then pulling the flanges of the cable cover. Route the cables in arm assembly (B) and then reinstall the cable cover.

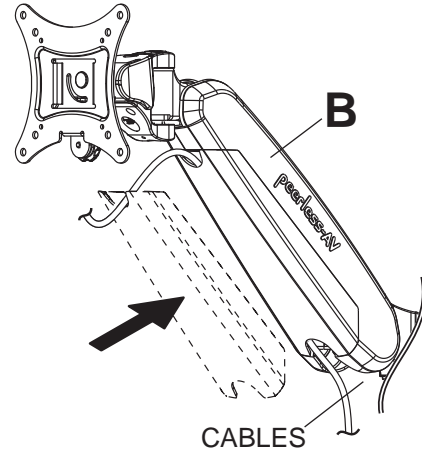
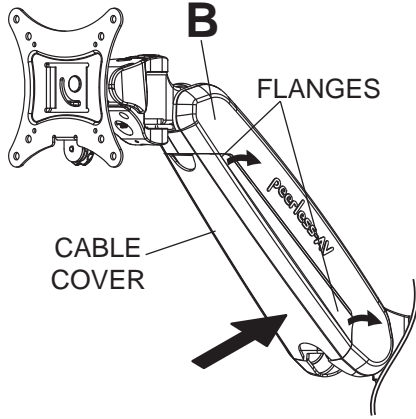

7

To lock down rotation, tighten set screw shown in detail 2.

To lock down tilt, tighten screw shown in detail 3.

To lock down swivel, tighten screw shown in detail 4.

To lock down height adjustment, tighten set screw shown in detail 5.

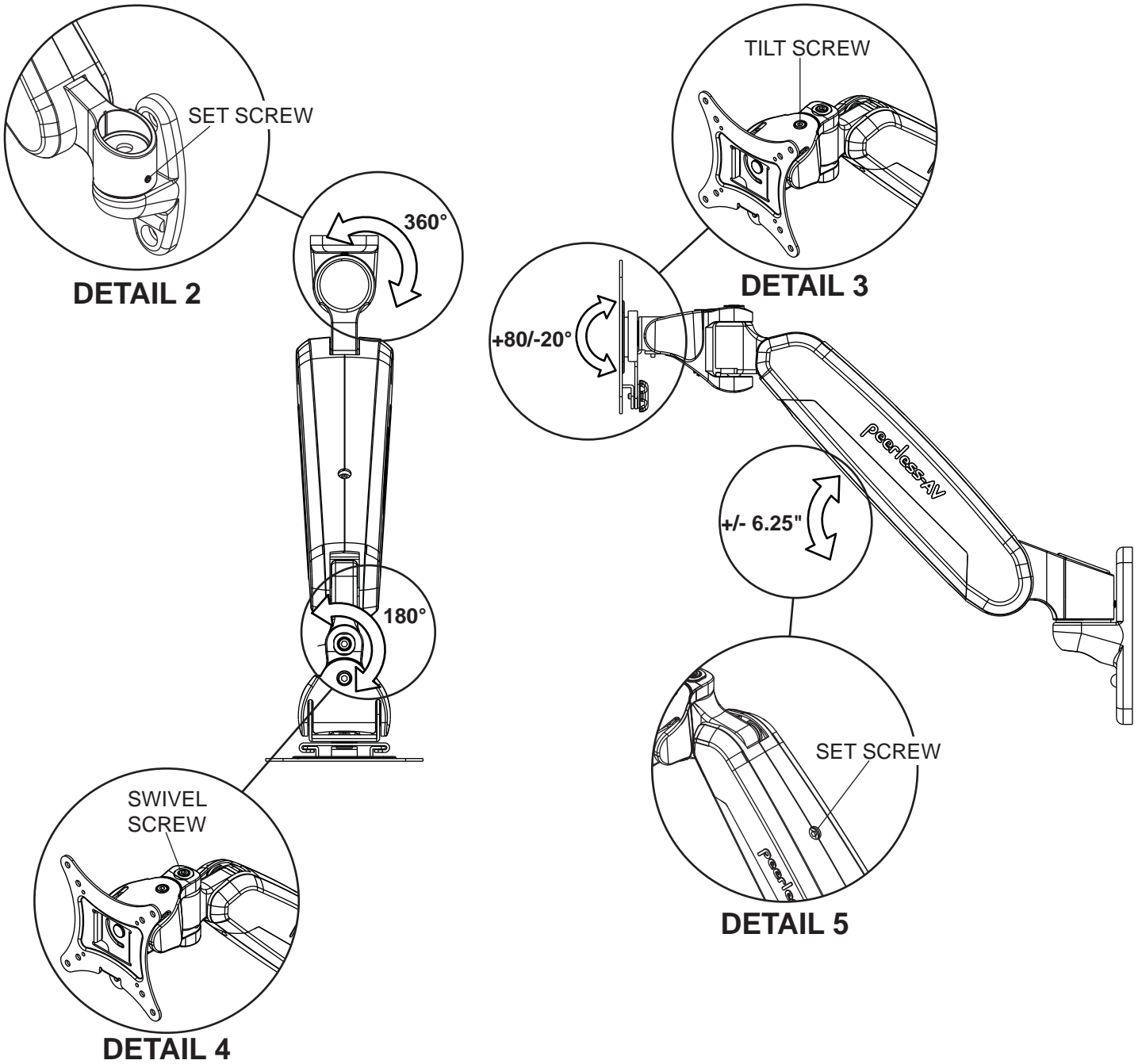

LIMITED FIVE-YEAR WARRANTY

Peerless Industries, Inc. ("Peerless") warrants to original end-users of Peerless® products will be free from defects in material and workmanship, under normal use, for a period of five years from the date of purchase by the original end-user (but in no case longer than six years after the date of the product's manufacture). At its option, Peerless will repair or replace, or refund the purchase price of, any product which fails to conform with this warranty.

In no event shall the duration of any implied warranty of merchantability or fitness for a particular purpose be longer than the period of the applicable express warranty set forth above. Some states do not allow limitations on how long an implied warranty lasts, so the above limitation may not apply to you.

This warranty does not cover damage caused by (a) service or repairs by the customer or a person who is not authorized for such service or repairs by Peerless, (b) the failure to utilize proper packing when returning the product, (c) incorrect installation or the failure to follow Peerless' instructions or warnings when installing, using or storing the product, or (d) misuse or accident, in transit or otherwise, including in cases of third party actions and force majeure.

In no event shall Peerless be liable for incidental or consequential damages or damages arising from the theft of any product, whether or not secured by a security device which may be included with the Peerless® product. Some states do not allow the exclusion or limitation of incidental or consequential damages, so the above limitation or exclusion may not apply to you.

This warranty is in lieu of all other warranties, expressed or implied, and is the sole remedy with respect to product defects. No dealer, distributor, installer or other person is authorized to modify or extend this Limited Warranty or impose any obligation on Peerless in connection with the sale of any Peerless® product.

This warranty gives specific legal rights, and you may also have other rights which vary from state to state.



www.peerless-av.com

© 2012 Peerless Industries, Inc.

Touchboards

205 Westwood Ave, Long Branch, NJ 07740

Phone: 866-94 BOARDS (26273) / (732)-222-1511

Fax: (732)-222-7088 | E-mail: sales@touchboards.com