

PLANAR

Planar Imager Full Resolution VIDEO WALL WORKSTATION

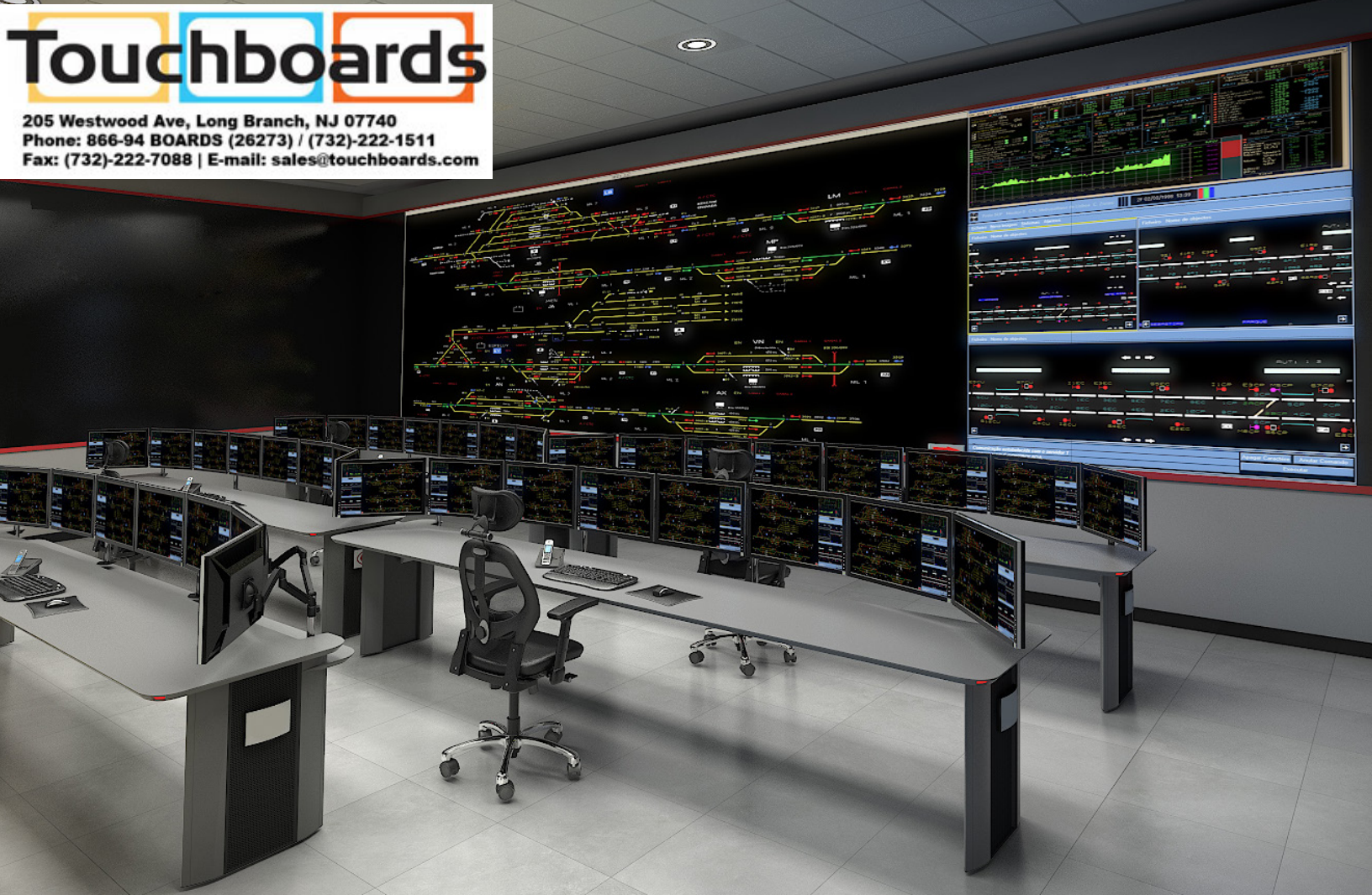

Full Resolution, Robust, High Performance Network-Oriented Imaging

The Planar® Imager (PLI) Full Resolution Video Wall Workstation is designed for large-scale video walls comprised of up to 48 full HD Planar displays. PLI has the capacity to run applications and draw the application's output at the full native resolution of all the displays within a video wall. With its network orientation, PLI is designed to receive data feeds to maintain live, high-quality visual data on a video wall. It acts as a seamless desktop spread across the entire video wall. Optionally, screen captures can be brought on to the video wall via Planar's Indisys™ Video Wall Processor. Using only industrial strength components, PLI designed for 24x7 operation.

Efficient, Full Resolution

Fewer connections to the video wall mean simpler cabling and higher reliability

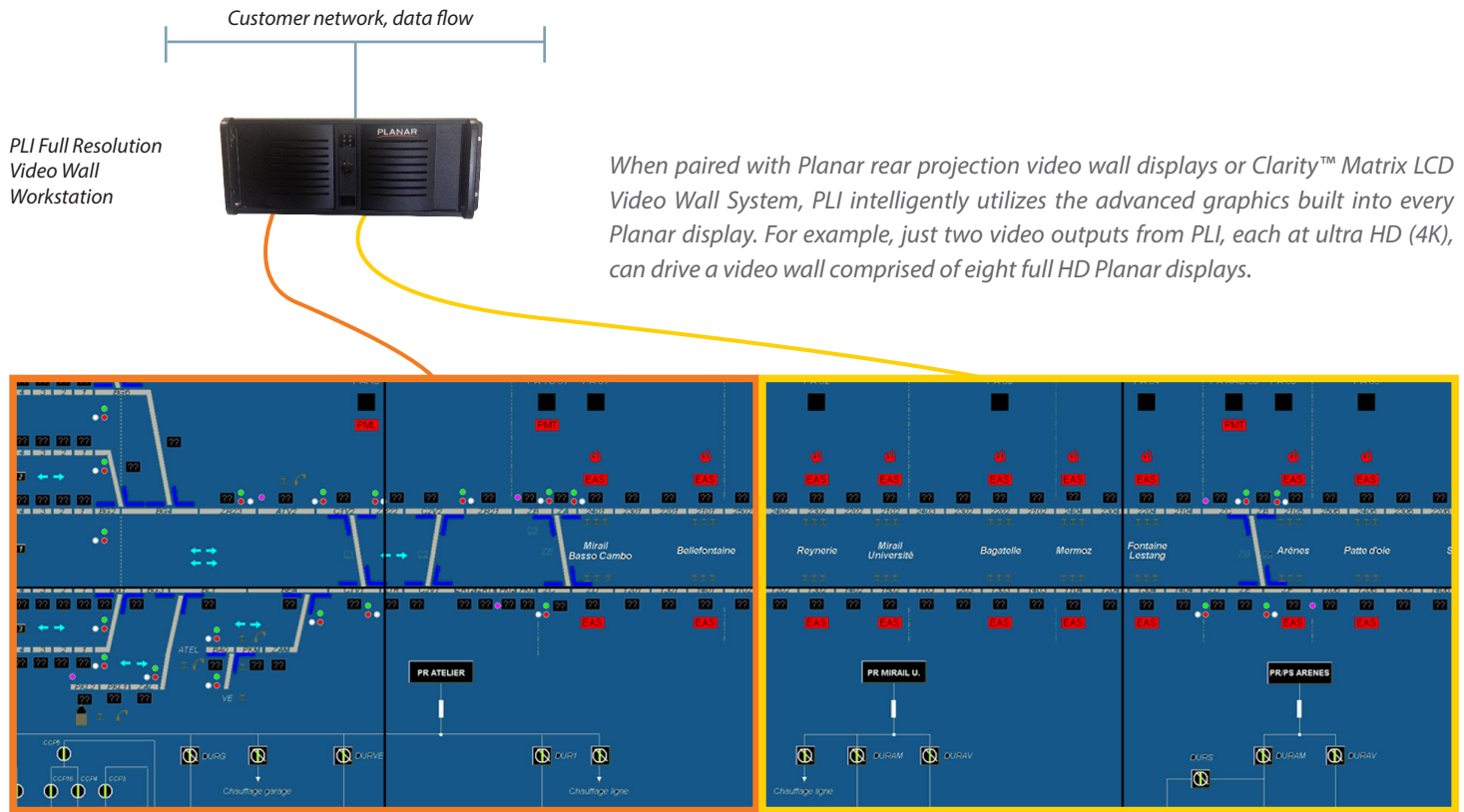

Superior Hardware, Superior Images

Each PLI is configured with graphic output capacity to match the needs of the video wall. The workstation's 4U rack chassis has capability for the largest, most demanding jobs. Multiple ethernet inputs can be configured for use on separate networks or in redundant failover mode. Built for reliability, all PLIs include redundant power and RAID hard drive systems. Applications are loaded and run on the PLI, or may be hosted remotely and connected to the PLI over the network.

The PLI can also be fitted with multiple motherboard processors to handle the toughest application requirements. Each output graphics card has the industry's leading performance for video computation. The PLI workstation otherwise operates as any Windows® computer, just with an ultra-high pixel density desktop.

Big, full resolution visualization applications

- SCADA diagrams
- Giant desktops for multiple applications
- Geospatial maps
- Large simulation images
- Presentations

Video overlays when Integrated with Indisys Video Processing

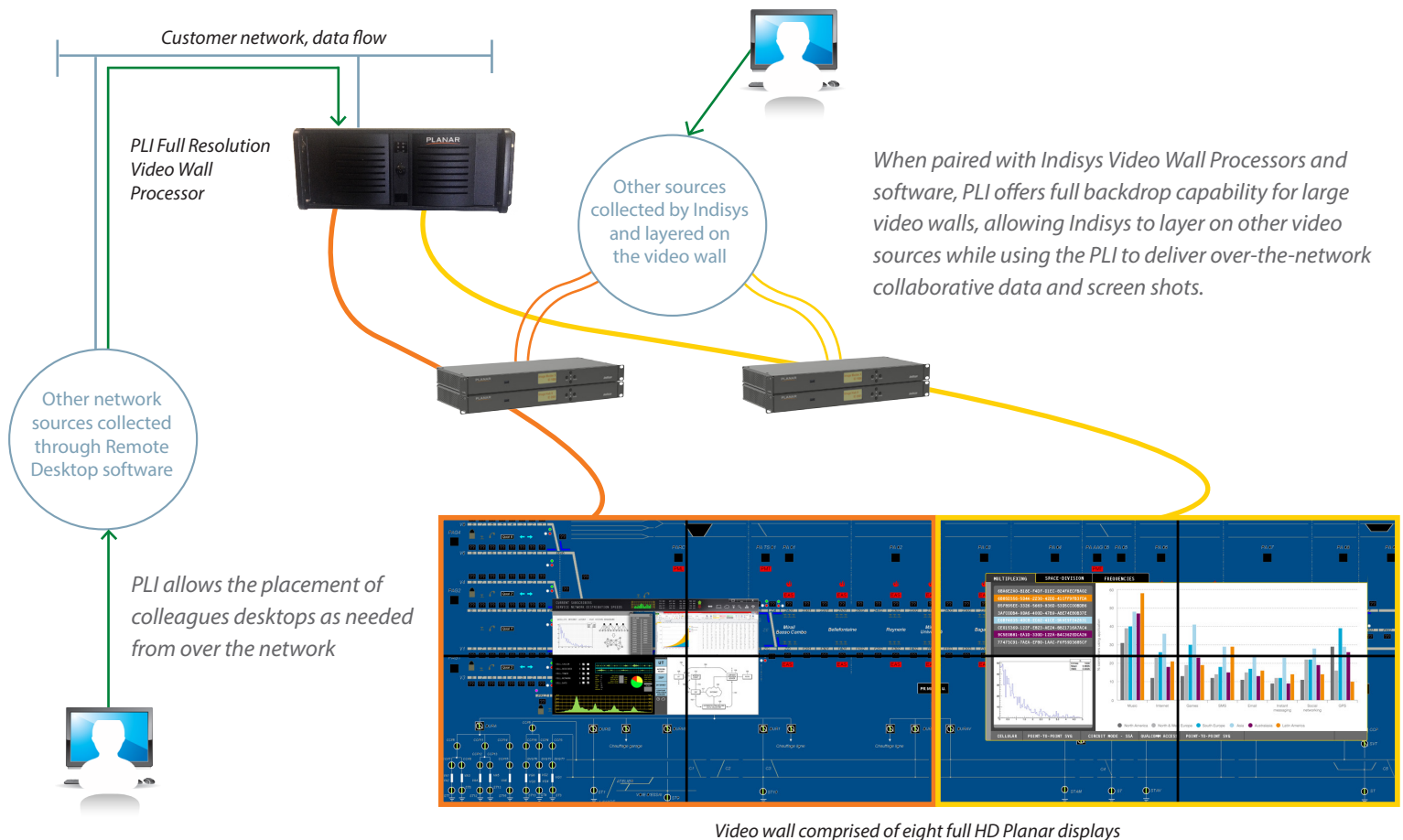

Integrate with Planar Indisys Video Processing

Planar's Indisys Video Wall Processor is a set of high-performance source-collecting video processors implemented in modular at-the-video wall components. PLI can be paired with Indisys to offer additional advantages and features to the video wall. When combined with Indisys, PLI delivers a large full resolution desktop backdrop to the video wall allowing other source video images to be overlaid in front of the PLI Windows desktop. Although video sources are processed separately from the application data, video images and application windows are integrated seamlessly on the displays. This architecture separating video sources from network data adds a fundamental redundancy to the solution that other all-in-one processors lack.

What's more, the PLI desktop can be used by the Indisys Desktop Service software to receive collaborative desktops from a variety of computer hosts throughout the control room and to post those screen grabs on the video wall. When combined with Indisys, PLI makes for a complete and high-end video wall processing set up.

Industrial performance for all your needs

- High MTBF components
- Advanced cooling chassis for 24x7 hours operation
- Powerful GPU for better utilization
- Latest professional processors and memory modules
- Redundancy on power, hard drive and network

PLI is offered with two ranges: PLI Ultra featuring Intel® i7 processing and PLI Extreme featuring Intel® Xeon E5 processing



PLI Ultra: PLI-U2/4/8



PLI Extreme: PLI-X4/8/12

	ULTRA: PLI-U2/4/8			EXTREME: PLI-X4/8/12		
	-U2	-U4	-U8	-X4	-X8	-X12
Output	2 Digital Full-sized DisplayPort Outputs	4 Digital Mini DisplayPort Outputs	8 Digital Mini DisplayPort Outputs	4 Digital Mini DisplayPort Outputs	8 Digital Mini DisplayPort Outputs	12 Digital Mini DisplayPort Outputs
Typical Uses	Provides an extended Windows desktop across Planar Rear Projection Video Wall or Clarity Matrix LCD Video Wall System. Can be paired with Indisys Video Processing solution.					
Planar Displays Supported	Up to 8 FHD*	Up to 16 FHD*	Up to 32 FHD*	Up to 16 FHD*	Up to 32 FHD*	Up to 48 FHD*
	*Number of displays supported depends on display type and video wall layout.					
Processor	1x Intel® iCore i7 Processor			1x Intel® Xeon® Processor E5 family PLI-X12 comes with Dual processors standard		
Optional Processor	n/a			Dual Xeon Processor for -X4 & -X8		
Hard disk drive	RAID 0/1			RAID 0/1		
Power Supply	Redundant 1 + 1 Power Supply, Hot swap module			Redundant 1+1 Power Supply, Hot swap module		
Ethernet	4 Ethernet ports*			4 Ethernet ports*		
	*If the PLI is used with Planar Indisys Video Wall Processing, one network port is dedicated to the private Indisys network. Additional cards required if failover redundancy is needed.					
Operating System	Windows 7 64 bit (Inquire about other Operating Systems)			Windows 7 64 bit (Inquire about other Operating Systems)		
Dimension	4U Rack high 427 x 177 x 480mm			4U Rack high 437 x 178 x 648mm (W x D x H)		
Misc	USB keyboard and mouse DVD +/- RW			USB keyboard and mouse DVD +/- RW		
Weight	16 kg (35.3 lb)			26 kg (57.8 lb)		



205 Westwood Ave, Long Branch, NJ 07740
 Phone: 866-94 BOARDS (26273) / (732)-222-1511
 Fax: (732)-222-7088 | E-mail: sales@touchboards.com



When image experience matters.

www.planar.com
 sales@planar.com
 1-866-475-2627

Planar is a trademark of Planar Systems, Inc. All other trade and service marks are the property of their holders.

Copyright © 2014 Planar Systems, Inc. All rights reserved. This document may not be copied in any form without written permission from Planar Systems, Inc. Information in this document is subject to change without notice. 9/14