

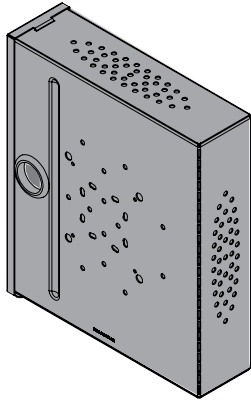

# GB-MBX200/210/220/230 Installation Instructions



The GB-MBX200 Medium Equipment Storage GearBox™ provides 13.25" x 11.25" x 3" of storage space and is big enough to house laptops, digital signage players, switchers and equipment of similar size. It mounts to a variety of Premier Mounts' adapters (sold separately) using its variety of mounting patterns. The GB-MBX210 comes complete with a PSD-SPA, the GB-MBX220 includes a PSP-SPA and the GB-MBX230 is designed to be mounted to the back of an ECM flat-panel ceiling mount.

## Step 1

The GB-MBX200 may be used with a variety of Premier Mounts installation adaptors, such as PSD-SPA, PSP-SPA, etc. The included 100x100mm VESA bolt pattern may be used when mounting directly to the back of a flat-panel display (additional hardware and adaptors may be required).



Which version of the GB-MBX200 are you installing?

For **GB-MBX210**, to dual pole cart/stand installation skip to **step 2**.

For **GB-MBX220**, to single pole cart/stand installation skip to **step 3**.

For **GB-MBX230**, to ECM ceiling mount installation skip to **step 4**.

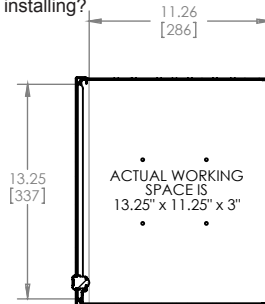

## Step 2

- 1) Your order should have come in two boxes. Remove the PSD-SPA from the second box.
- 2) Locate the 4 1/2" bolt pattern on the back of the GearBox™, which is highlighted in the drawing to the right.
- 3) Install the PSD-SPA to the GB-MBX210 using the manual provided with the PSD-SPA.

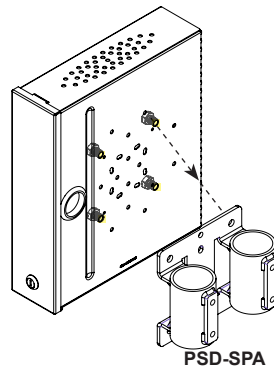

The (4) hex bolts included with the PSD-SPA should be installed from within the GB-MBX210 and come out to meet the adaptor.



3130 East Miraloma Avenue  
Anaheim, CA 92806 USA  
**USA and Canada**  
Phone: 1.800.368.9700  
Fax: 1.800.832.4888

Other Locations – Phone: (001).714.632.7100; Fax: (001).714.632.1044 ©Premier Mounts 2011

## Parts List

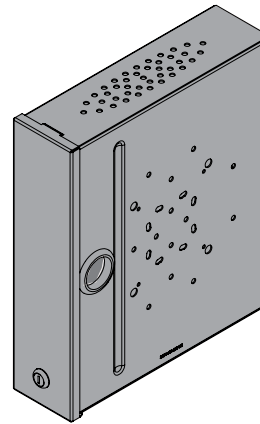

GB-MBX200  
(Qty 1)

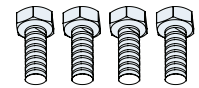

M6 x 16mm Hex Head Screw  
(Qty 4)

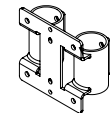

PSD-SPA (Qty 1)  
(Included with GB-MBX210)

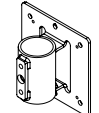

PSP-SPA (Qty 1)  
(Included with GB-MBX220)

## Step 3

- 1) Your order should have come in two boxes. Remove the PSP-SPA from the second box.
- 2) Locate the 4 1/2" bolt pattern on the back of the GearBox™, which is highlighted in the drawing to the right.
- 3) Install the PSP-SPA to the GB-MBX220 using the hardware and manual provided with the PSP-SPA.

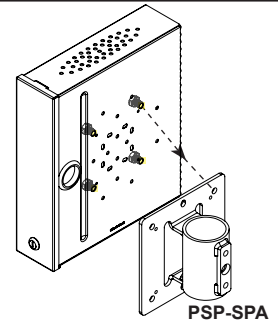

The (4) hex bolts included with the PSP-SPA should be installed from within the GB-MBX210 and come out to meet the adaptor.

## Step 4

1. Align the adjustable mounting slots of the GB-MBX230 with the fixed mounting holes on the ECM Mount you have purchased.
  2. Use the included (4) M6 x 16mm hex screws to attach the box to the back of ECM.  
Install screws from the inside of GearBox™, screwing out into the ECM's mounting holes.  
The lid of the GearBox™ should be opened or removed prior to installation.
- Use the four (4) points marked A or the (4) marked B, depending on preferred orientation

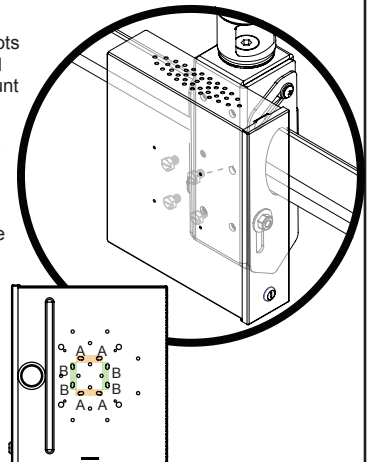

• All trademarks are the property of the respective trademark owners.