



ActivBoard

Touchboards

205 Westwood Ave, Long Branch, NJ 07740
Phone: 866-94 BOARDS (26273) / (732)-222-1511
Fax: (732)-222-7088 | E-mail: sales@touchboards.com



Copyright Information

TP1819 Issue 03 © 2013 Promethean Limited. All rights reserved.

All software, resources, drivers and documentation supplied in the Promethean ActivInspire download are copyright Promethean Ltd 2013. Promethean grants a license to install and use Promethean ActivInspire software, including any resources, drivers and documentation supplied in the download. Refer to the licence agreement for information about the terms and conditions of this licence.

Promethean is owner of a number of trademarks in several jurisdictions across the world. The Promethean products documented in this guide include aspects which are protected under their respective patent, copyright, design copyright, registered design and trademark laws.

Windows, Windows XP, Excel and PowerPoint are registered trademarks or trademarks of Microsoft Corporation in the United States and other countries.

All other trademarks remain the property of their respective owners.

This guide is distributed with the product. It may only be reproduced for use within the institution in which the product is used. For use outside of your institution, no part of this guide may be reproduced, transmitted, stored in a retrieval system or translated into any other language without the prior permission of Promethean Limited.

Please note that the content in this guide is protected under copyright law. Although every care has been taken in the compilation of this guide, Promethean Limited accepts no responsibility for errors or omissions, or for damages resulting from the use of information contained within the following pages.

General Safety Instructions

For your safety, read this guide before installation. Incorrect handling and installation could result in personal injury, property damage or damage to the components. Keep this installation guide at hand for future reference.

Refer to the Safety Instructions for your ActivBoard System and projector.

Follow the instructions in these documents.

Explanation of Symbols

The warning marks shown below are used throughout this installation guide to prevent personal injury or property damage. Make sure you understand these warnings when reading this installation guide.



This symbol indicates information that, if ignored, could possibly result in personal injury or even death due to incorrect handling.

WARNING



This symbol indicates information that, if ignored, could possibly result in personal injury or physical damage due to incorrect handling.

CAUTION



Symbol indicating an action that should be done.



Symbol indicating an action that must not be done.



WARNING

Safety Precautions for Installation



The installation work should be performed by a qualified installer. Attempting to install the product without relevant experience is done so at your own risk. Incorrect or incomplete installation could result in personal injury, property damage or product failure.



The weight of the ActivBoard, and strength of the mounting wall is required to be confirmed prior to installation.

Ensure precautions are taken to ensure the wall strength and fixings are suitable.

Thank you for purchasing an ActivBoard from Promethean. We recommend using your ActivBoard with our latest software solutions:

- ActivInspire - Fully featured software that combines the best of our award-winning programs in one package, delivering the best software for education technology integration, www.prometheanplanet.com/ActivInspire
- Promethean ActivOffice - Software plug-in that enables certain ActivInspire features to be used natively in PowerPoint® presentations, www.prometheanplanet.com/PrometheanActivOffice
- Promethean Applications - Standalone applications that enable multi-user 'Pen and Touch' interaction with the ActivBoard 500 Pro, www.prometheanplanet.com/PrometheanApplications

Acquire thousands of great lessons, resources and teaching ideas from our free online community, Promethean Planet. While you're there, enroll in one of our ActivLearning courses.

Just create a user account and you will have access to a wealth of teaching resources and courses that will help you achieve your teaching and learning goals.

www.prometheanplanet.com/activlearning

Part of the Activclassroom, your Activboard along with ActivInspire software, was designed to be an innovative and integrated whole group learning environment which encourages active student participation in lessons.

For more information on the ActivClassroom by Promethean and other products available please visit

www.prometheanworld.com.

Components supplied and minimum specifications stated have been tested and are required for optimal performance. Use of components not supplied by Promethean, or not meeting minimum specifications, may impact performance and affect warranty. Contact your Promethean partner or visit www.PrometheanKB.com for more information.

Contents

100 Series

5

300 Series

6

300 Pro Series

11

500 Pro Series

17



100 Series Safety Information

WARNING



The ActivBoard 100 series are USB powered therefore do not require an external Power Supply Unit. Power supply Units are only required for use in wireless mode. The Wireless Upgrade Kit is available separately- please contact your Promethean Partner for more information.



The ActivBoard 100 series are powered, when operated in wireless mode, by a universal input power supply unit, branded Promethean and type FW7650L/05. This is the only approved power supply unit. Do not connect any other power supply unit to the ActivBoard 100 series. Failure to do this could result in personal injury, property damage or product failure.



Inspect the power supply unit for physical damage to the casing before use. If damage is apparent, take care to avoid contact with any potentially live parts. Disconnect the power supply unit from the mains supply at the wall socket and contact an authorised Promethean service agent for advice. Failure to do this could result in personal injury or product failure.



Never open or modify the power supply or mains lead. It does not contain any user serviceable parts.

Attempting to open or modify the power supply or mains lead could result in personal injury, property damage or product failure.



Do not connect the power supply unit if you are unsure of the electrical compatibility of your equipment. Please contact Promethean or an authorised Promethean service agent for advice before attempting to connect the power supply unit to the mains supply if you are in any doubt. Failure to do this could result in personal injury or product failure.



The power supply unit may be supplied with more than one interchangeable plug or adapter and mains leads. This is to accommodate countries with more than one type of mains outlet socket. Only use the mains lead, or adapter, which is compatible with your mains outlet socket. Failure to do this could result in personal injury, property damage or product failure.



The socket outlet should be installed near the equipment and should be easily accessible. Failure to do this could result in personal injury.



ENVIRONMENTAL CONSIDERATIONS:

Operating Temperature Range: 0°C to +50°C (32°F to 122°F)

Storage Temperature Range: -20°C to +70°C (-4°F to 158°F)

Humidity (non condensing): 0% to 90%

Additional support and information on Promethean products can be found on Promethean's knowledgebase. www.prometheankb.com



Box Contents

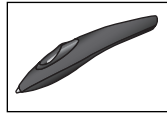

2 X ActivPens

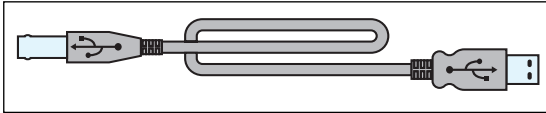

USB Data Cable
5m (16ft)

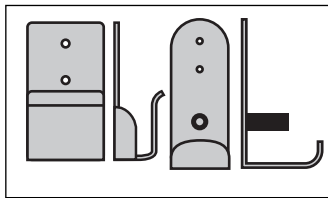

Wall Mounting Brackets

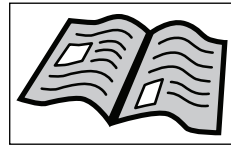

User Guide

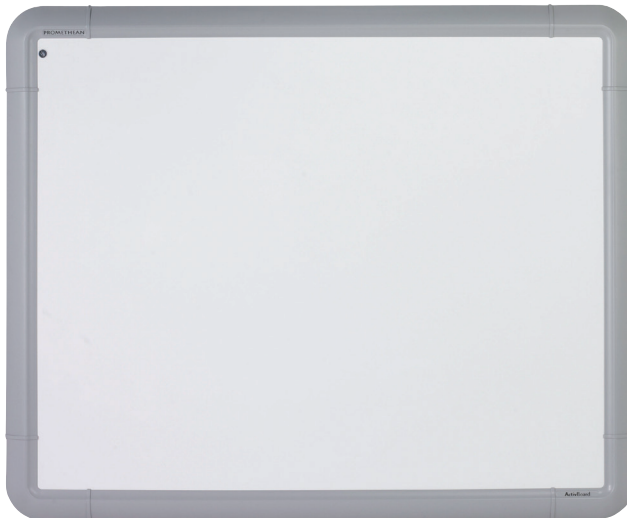

ActivBoard



Installation

CAUTION

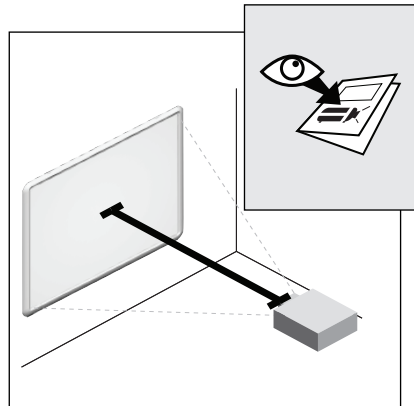
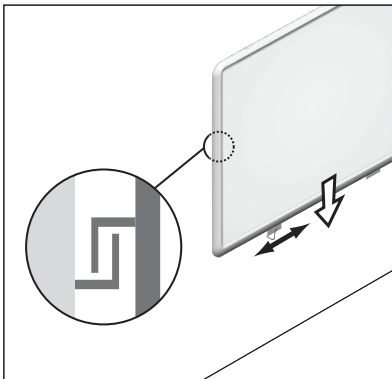
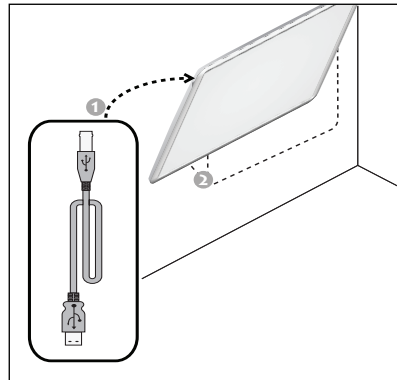
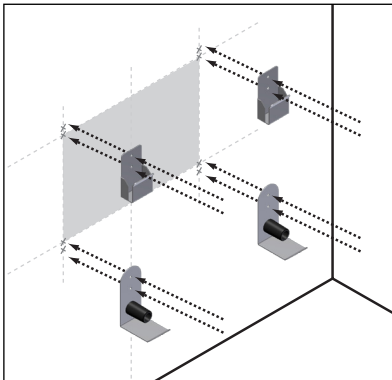
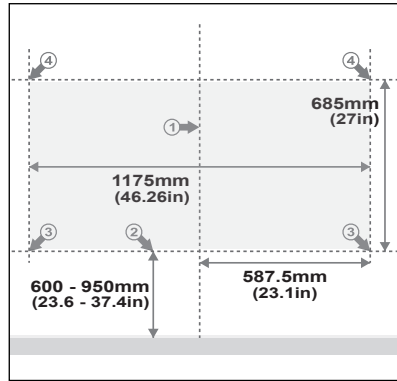
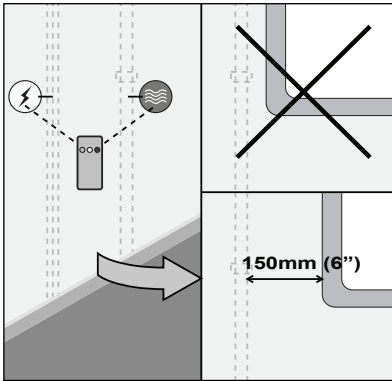

! Set-Up

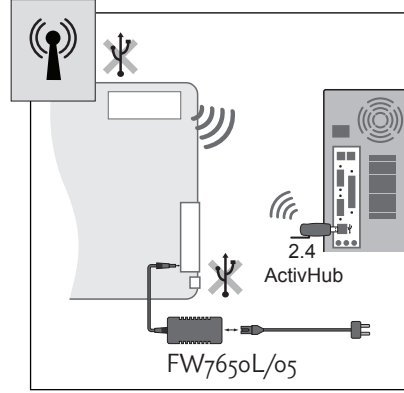
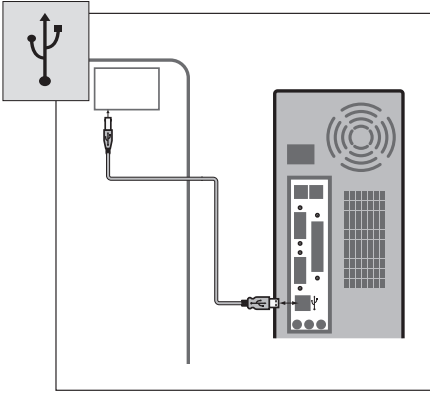

! Calibration

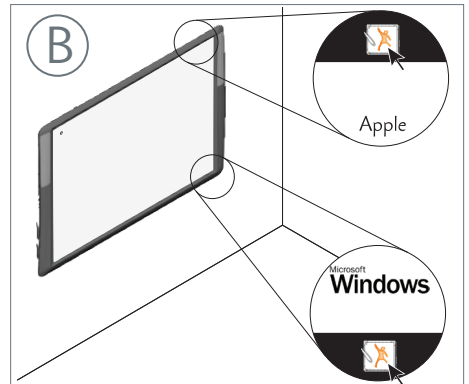
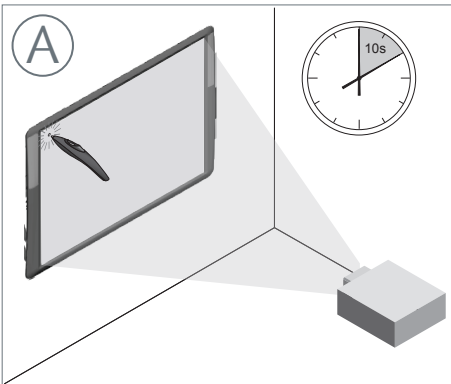
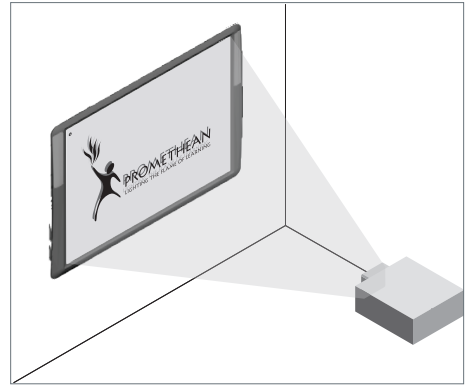
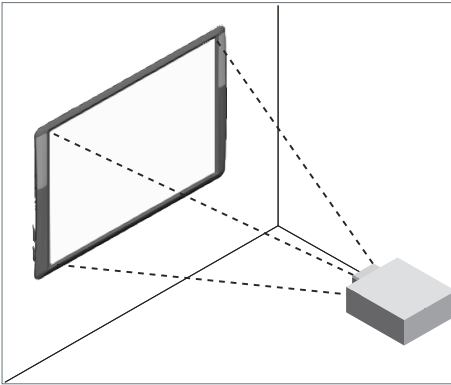

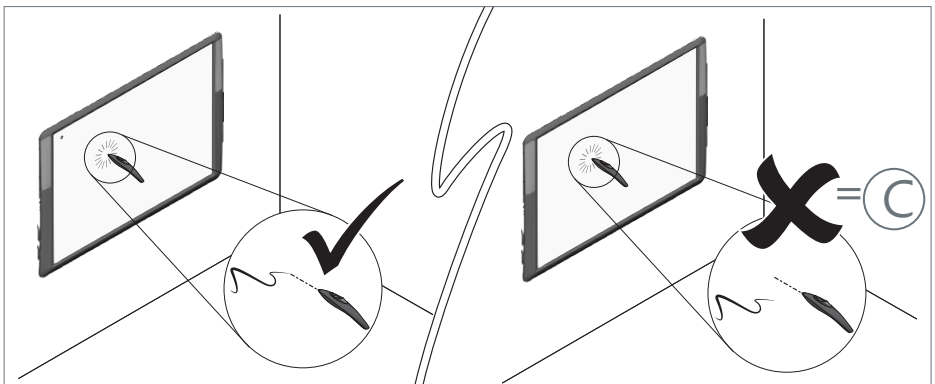
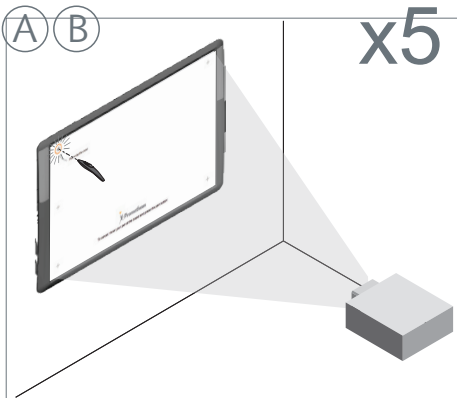
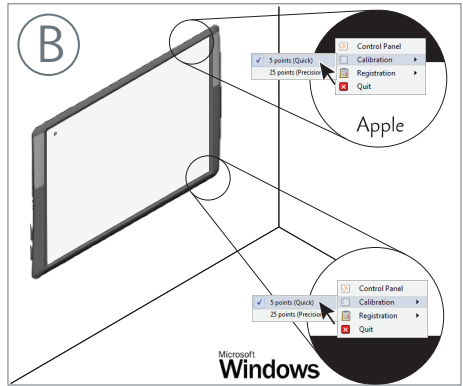
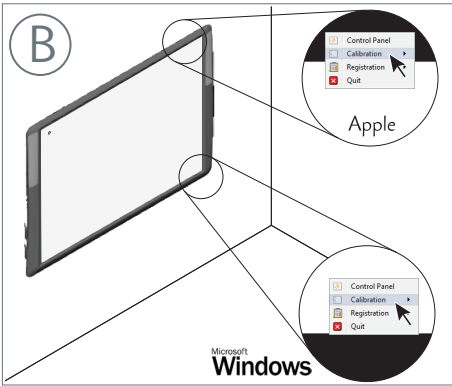

ActivBoard

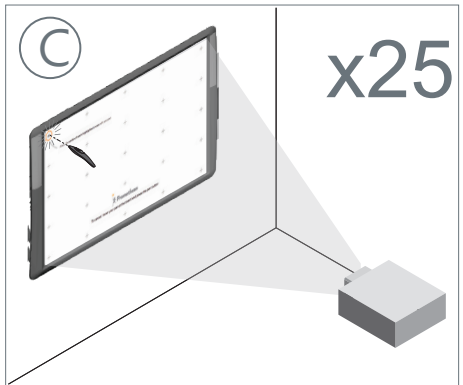
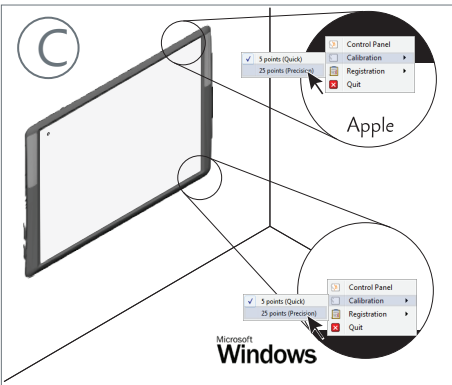
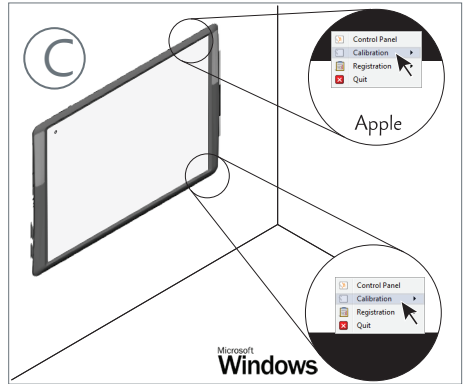
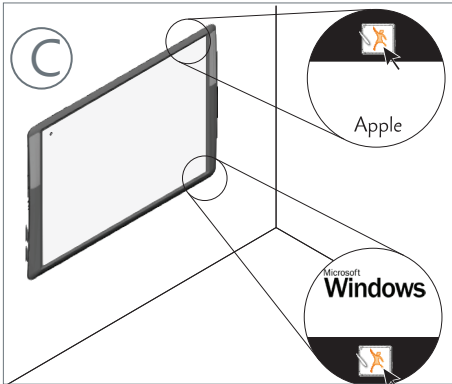

Getting Started

www.prometheanplanet.com/activinspire

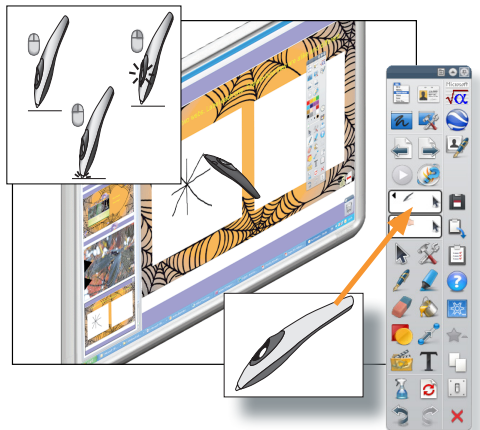



300 Series Safety Information



The ActivBoard 300 series are USB powered therefore do not require an external Power Supply Unit. Power supply Units are only required for use in wireless mode. The Wireless Upgrade Kit is available separately- please contact your Promethean Partner for more information.



The ActivBoard 300 series are powered, when operated in wireless mode, by a universal input power supply unit, branded Promethean and type FW7650L/05. This is the only approved power supply unit. Do not connect any other power supply unit to the ActivBoard 300 series. Failure to do this could result in personal injury, property damage or product failure.



Inspect the power supply unit for physical damage to the casing before use. If damage is apparent, take care to avoid contact with any potentially live parts. Disconnect the power supply unit from the mains supply at the wall socket and contact an authorised Promethean service agent for advice. Failure to do this could result in personal injury or product failure.



Never open or modify the power supply or mains lead. It does not contain any user serviceable parts.

Attempting to open or modify the power supply or mains lead could result in personal injury, property damage or product failure.



Do not connect the power supply unit if you are unsure of the electrical compatibility of your equipment. Please contact Promethean or an authorised Promethean service agent for advice before attempting to connect the power supply unit to the mains supply if you are in any doubt. Failure to do this could result in personal injury or product failure.



The power supply unit may be supplied with more than one interchangeable plug or adapter and mains leads. This is to accommodate countries with more than one type of mains outlet socket. Only use the mains lead, or adapter, which is compatible with your mains outlet socket. Failure to do this could result in personal injury, property damage or product failure.



The socket outlet should be installed near the equipment and should be easily accessible. Failure to do this could result in personal injury.



ENVIRONMENTAL CONSIDERATIONS:

Operating Temperature Range: 0°C to +50°C (32°F to 122°F)

Storage Temperature Range: -20°C to +70°C (-4°F to 158°F)

Humidity (non condensing): 0% to 90%

Additional support and information on Promethean products can be found on Promethean's knowledgebase. www.prometheankb.com



Box Contents

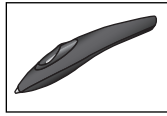

2 X ActivPens

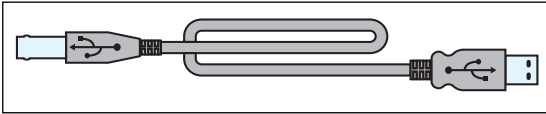

USB Data Cable
5m (16ft)

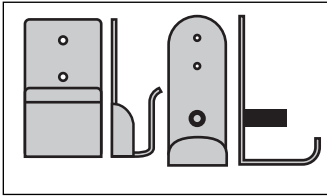

Wall Mounting Brackets

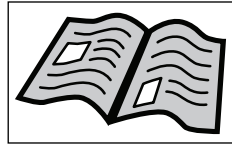

User Guide



ActivBoard



Installation

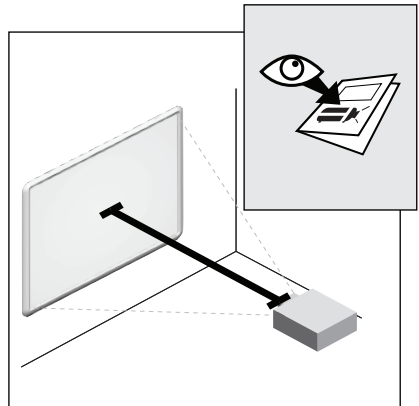
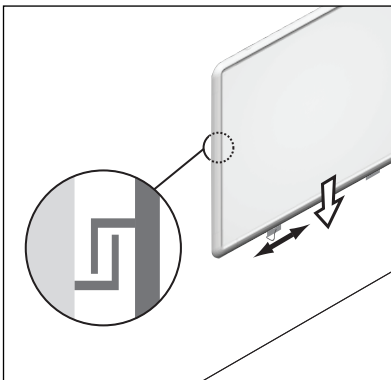
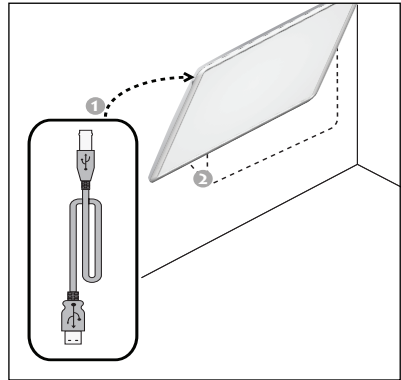
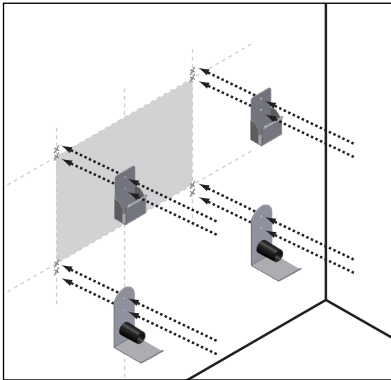
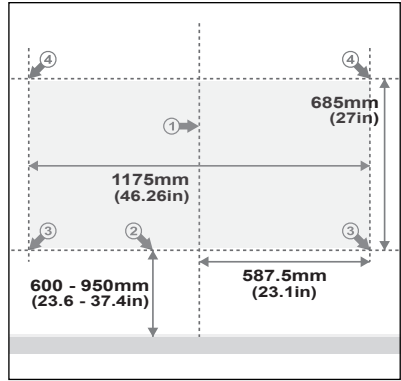
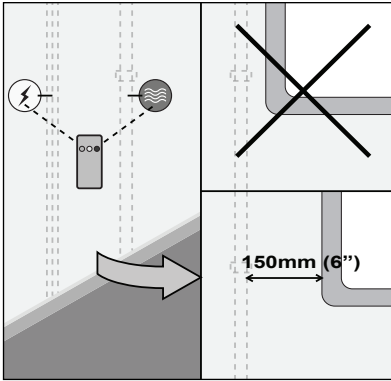

! Set-Up

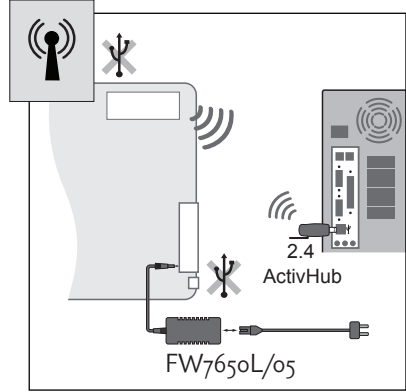
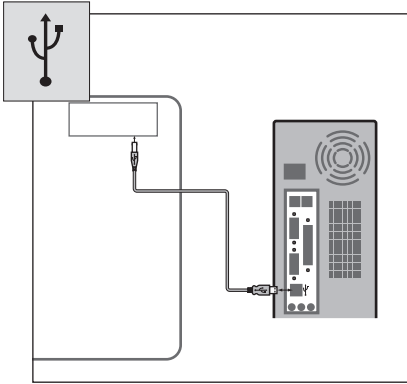

! Calibration

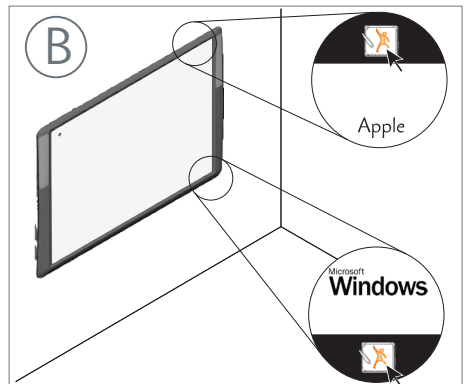
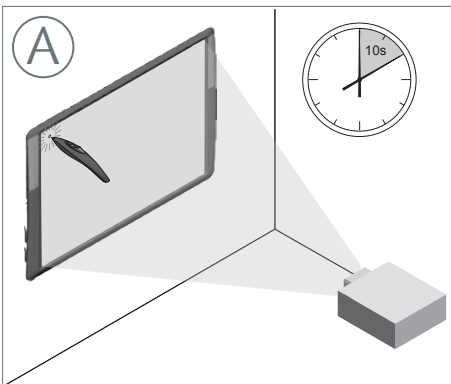
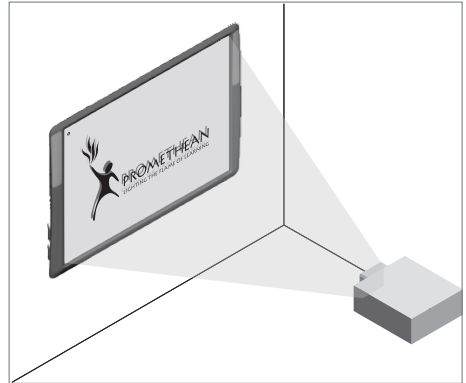
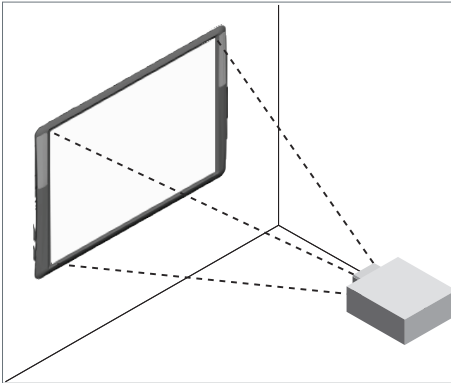

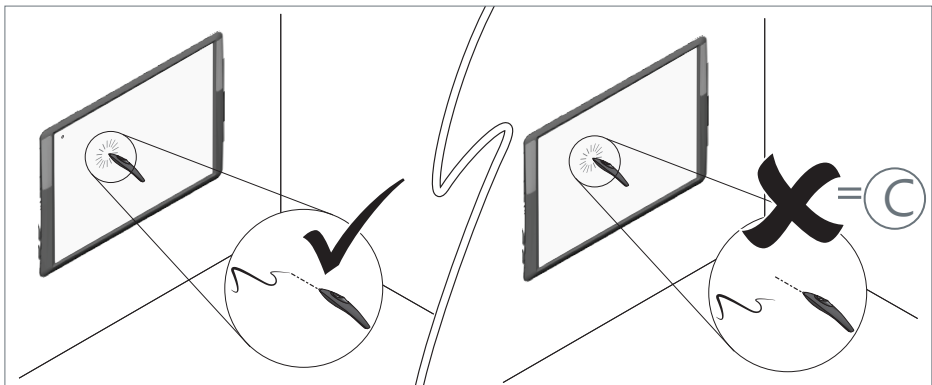
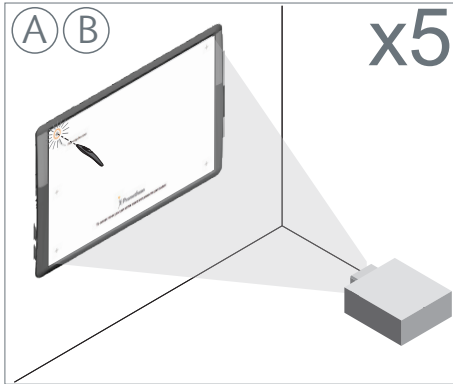
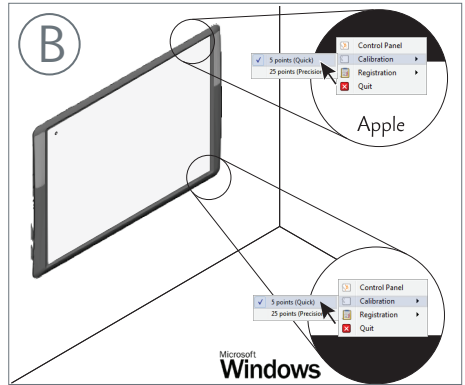
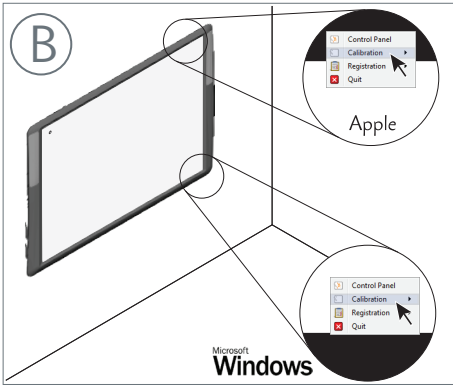

ActivBoard

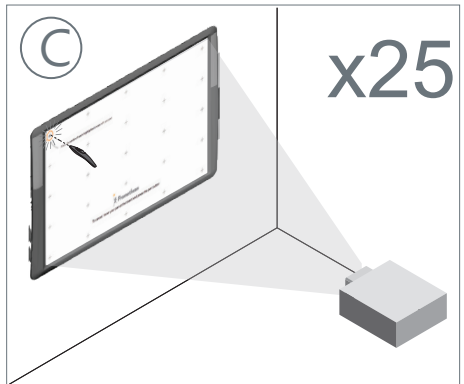
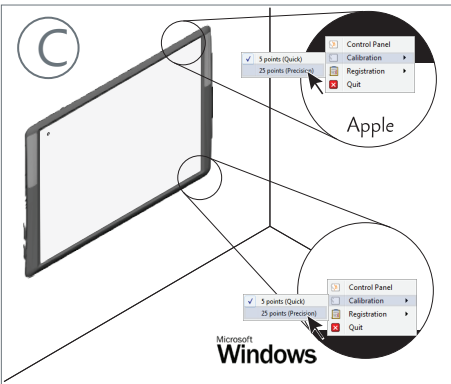
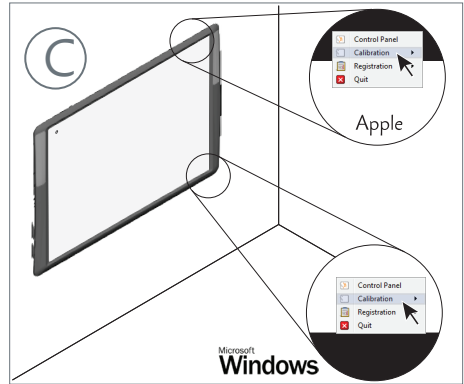
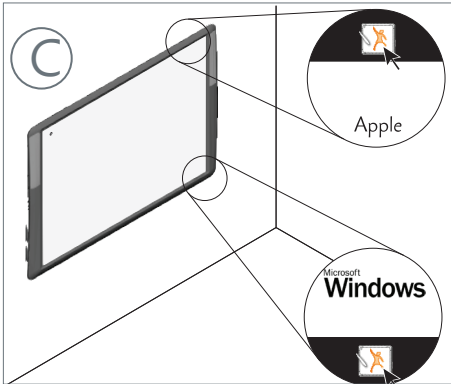

Getting Started

www.prometheanplanet.com/activinspire

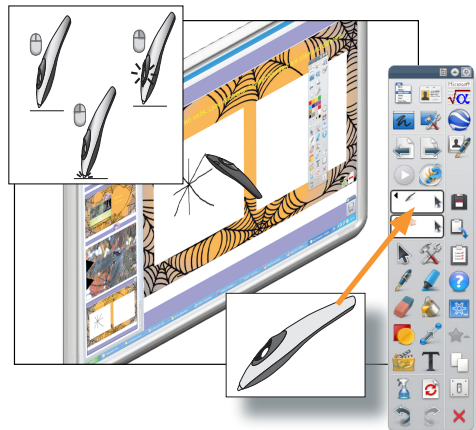



300 Pro Series Safety Information

WARNING



The ActivBoard 300 Pro series are powered by a universal input power supply unit, branded Promethean and type DT6018 or DPS-60SB A. This is the only approved power supply unit. Do not connect any other power supply unit to the ActivBoard 300 Pro series. Failure to do this could result in personal injury, property damage or product failure.



Inspect the power supply unit for physical damage to the casing before use. If damage is apparent, take care to avoid contact with any potentially live parts. Disconnect the power supply unit from the mains supply at the wall socket and contact an authorised Promethean service agent for advice. Failure to do this could result in personal injury or product failure.



The ActivBoard 300 Pro series can also be operated in wireless mode. The Wireless Upgrade Kit is available separately- please contact your Promethean Partner for more information.



Never open or modify the power supply or mains lead. It does not contain any user serviceable parts. Attempting to open or modify the power supply or mains lead could result in personal injury, property damage or product failure.



Do not connect the power supply unit if you are unsure of the electrical compatibility of your equipment. Please contact Promethean or an authorised Promethean service agent for advice before attempting to connect the power supply unit to the mains supply if you are in any doubt. Failure to do this could result in personal injury or product failure.



The power supply unit may be supplied with more than one interchangeable plug or adapter and mains leads. This is to accommodate countries with more than one type of mains outlet socket. Only use the mains lead, or adapter, which is compatible with your mains outlet socket. Failure to do this could result in personal injury, property damage or product failure.



The socket outlet should be installed near the equipment and should be easily accessible. Failure to do this could result in personal injury.



ENVIRONMENTAL CONSIDERATIONS:

Operating Temperature Range: 0°C to +50°C (32°F to 122°F)
Storage Temperature Range: -20°C to +70°C (-4°F to 158°F)
Humidity (non condensing): 0% to 90%

Additional support and information on Promethean products can be found on Promethean's knowledgebase. www.prometheankb.com



Box Contents

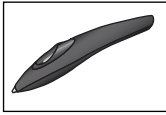

2 X ActivPens-Teacher



2 X ActivPens-Student

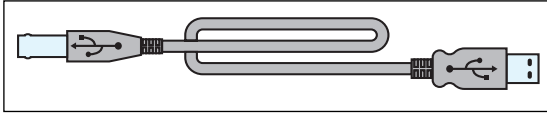

USB Data Cable
5m (16ft)

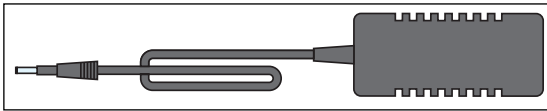

1 AMPLIFIER PSU
DT6018 or DPS-60SB A

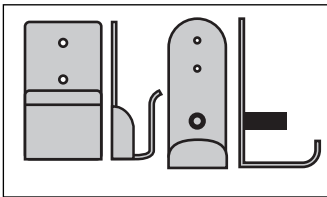

Wall Mounting Brackets

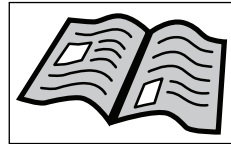

User Guide



ActivBoard



Installation

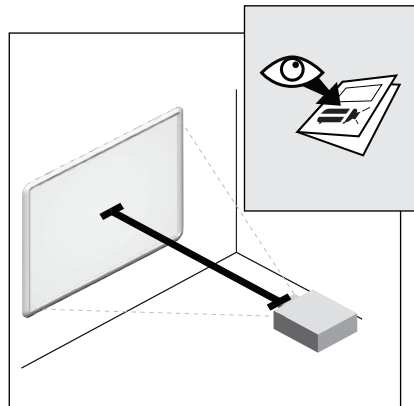
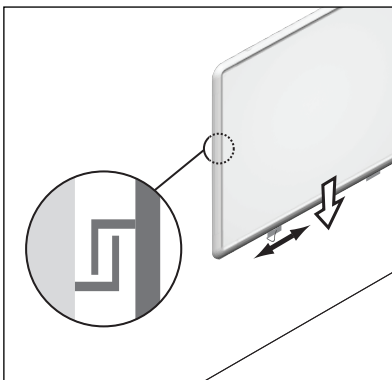
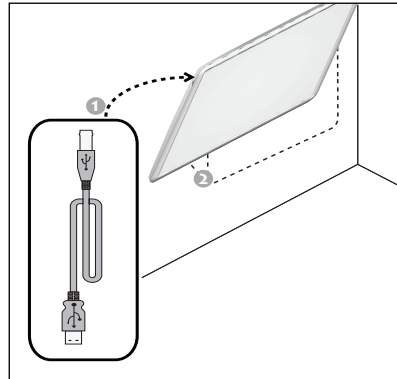
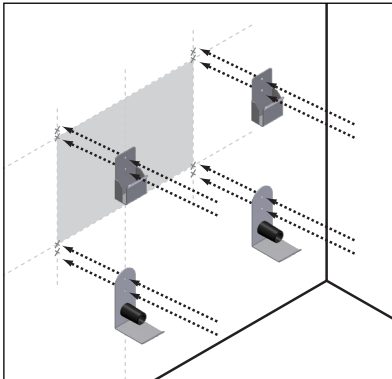
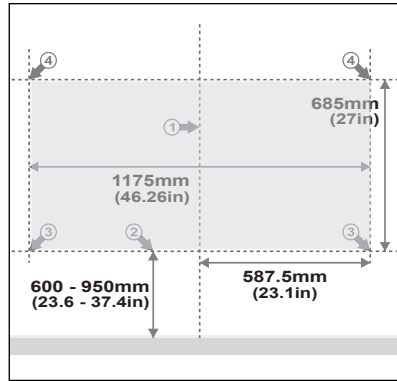
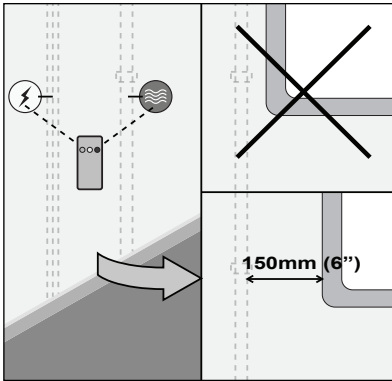

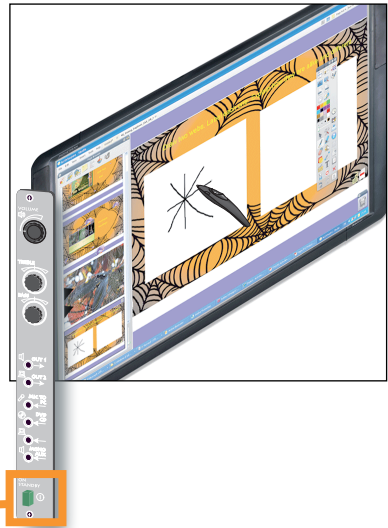
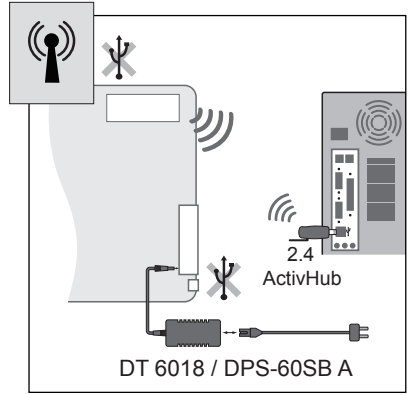
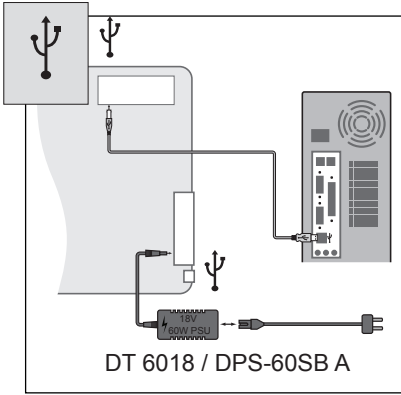

! Calibration

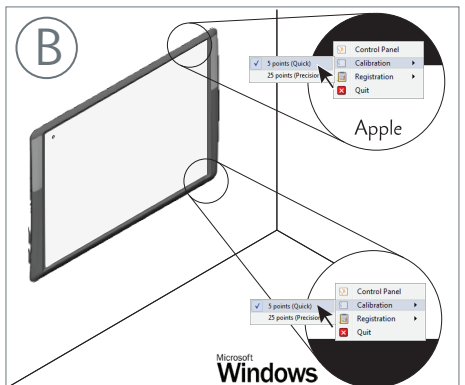
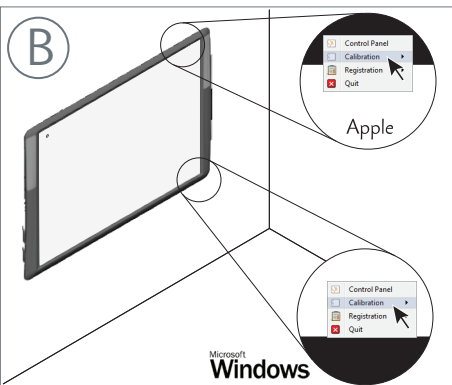
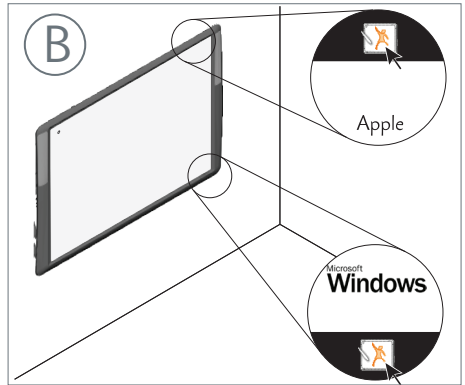
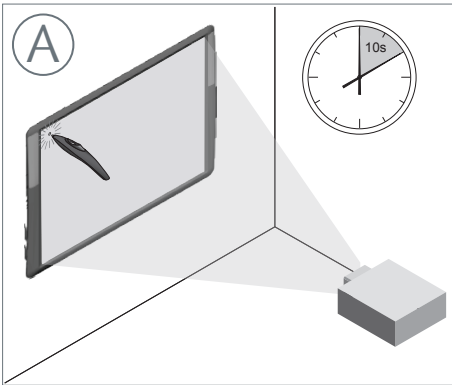
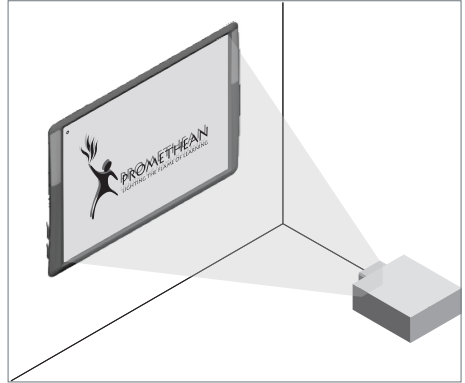
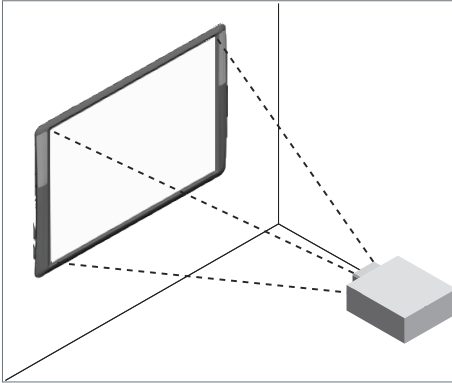

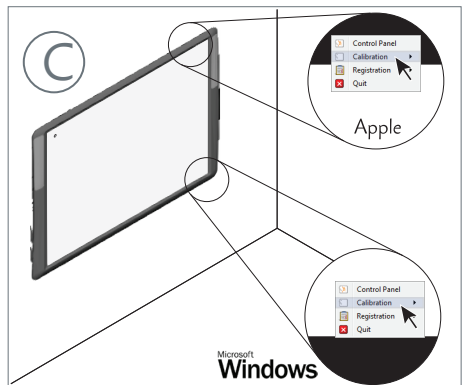
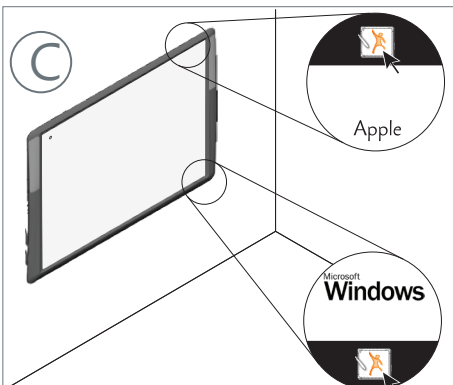
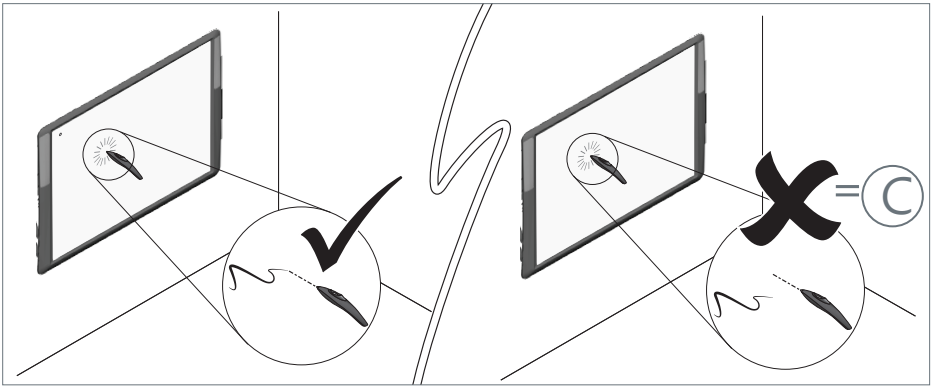
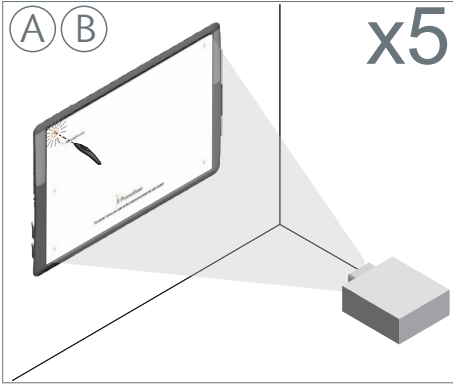

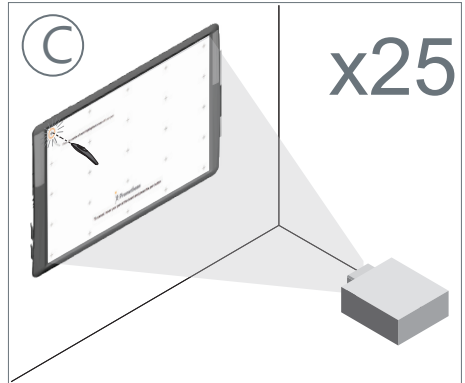
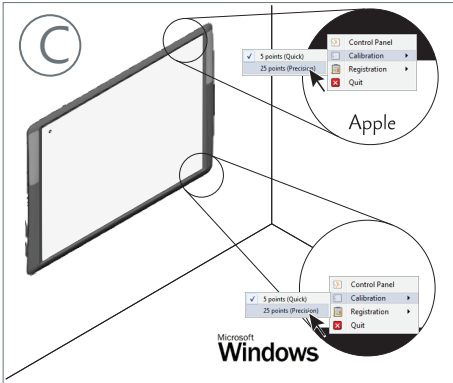

www.prometheanplanet.com/activinspire

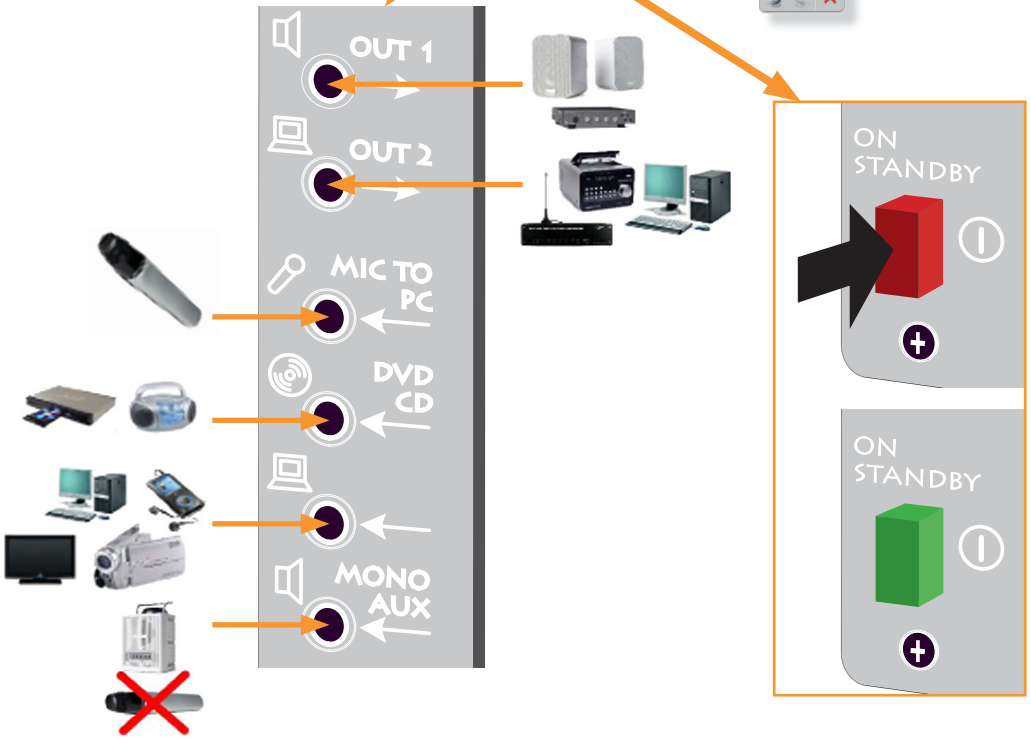
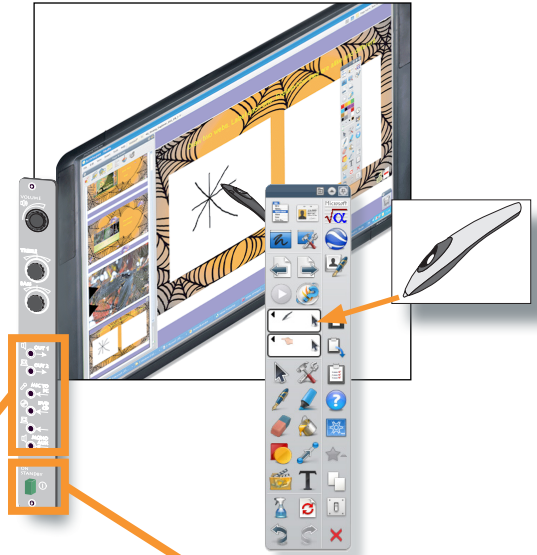



500 Pro Series Safety Information

WARNING



The ActivBoard 500 Pro series are powered by a universal input power supply unit, branded Promethean and type DPS-90SB A.

This is the only approved power supply unit. Do not connect any other power supply unit to the ActivBoard 500 Pro series. Failure to do this could result in personal injury, property damage or product failure.



Inspect the power supply unit for physical damage to the casing before use. If damage is apparent, take care to avoid contact with any potentially live parts. Disconnect the power supply unit from the mains supply at the wall socket and contact an authorised Promethean service agent for advice. Failure to do this could result in personal injury or product failure.



Never open or modify the power supply or mains lead. It does not contain any user serviceable parts.

Attempting to open or modify the power supply or mains lead could result in personal injury, property damage or product failure.



Do not connect the power supply unit if you are unsure of the electrical compatibility of your equipment. Please contact Promethean or an authorised Promethean service agent for advice before attempting to connect the power supply unit to the mains supply if you are in any doubt. Failure to do this could result in personal injury or product failure.



The power supply unit may be supplied with more than one interchangeable plug or adapter and mains leads. This is to accommodate countries with more than one type of mains outlet socket. Only use the mains lead, or adapter, which is compatible with your mains outlet socket. Failure to do this could result in personal injury, property damage or product failure.



The socket outlet should be installed near the equipment and should be easily accessible. Failure to do this could result in personal injury.



ENVIRONMENTAL CONSIDERATIONS:

Operating Temperature Range: 0°C to +40°C (32°F to 104°F)

Storage Temperature Range: -20°C to +60°C (-4°F to 140°F)

Humidity (non condensing): 10% to 90%

Additional support and information on Promethean products can be found on Promethean's knowledgebase. www.prometheankb.com



Box Contents

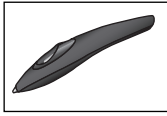

2 X ActivPens-Teacher

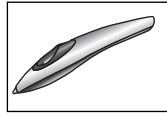

2 X ActivPens-Student

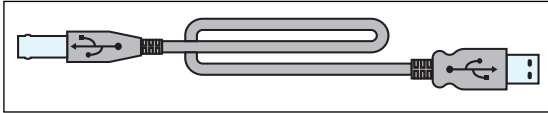

USB Data Cable
3m (9.8ft)

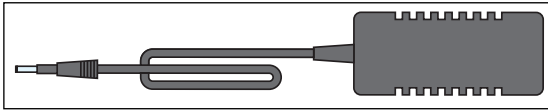

1 AMPLIFIER PSU
DPS-90SB A

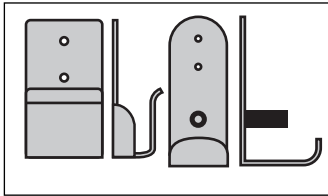

Wall Mounting Brackets

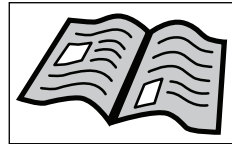

User Guide

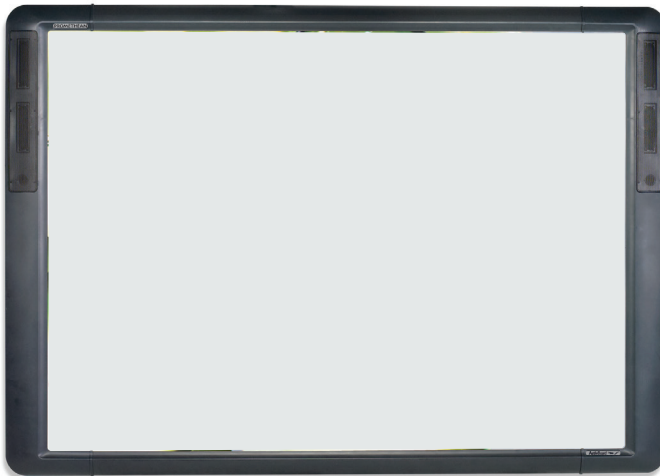

ActivBoard



Installation

CAUTION

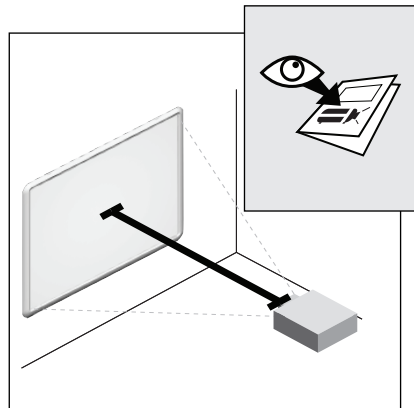
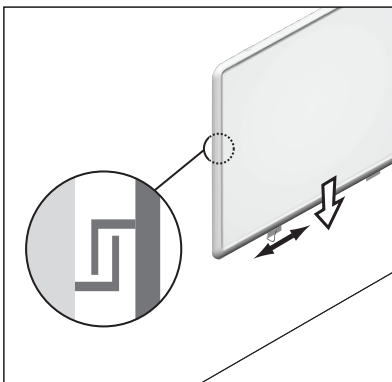
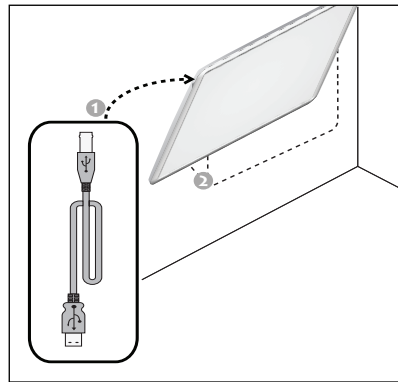
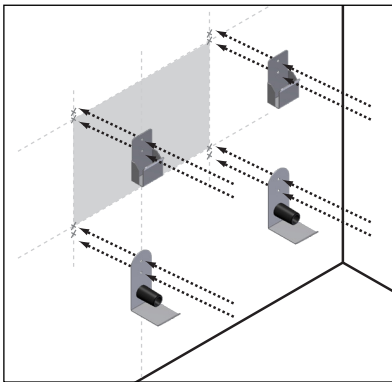
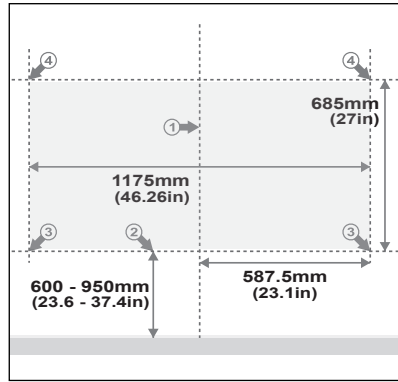
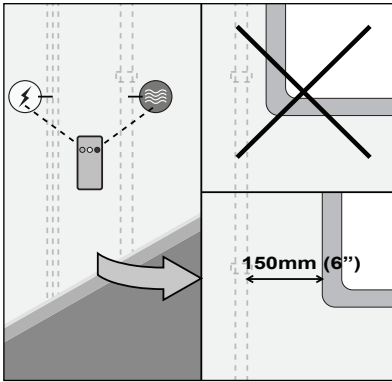

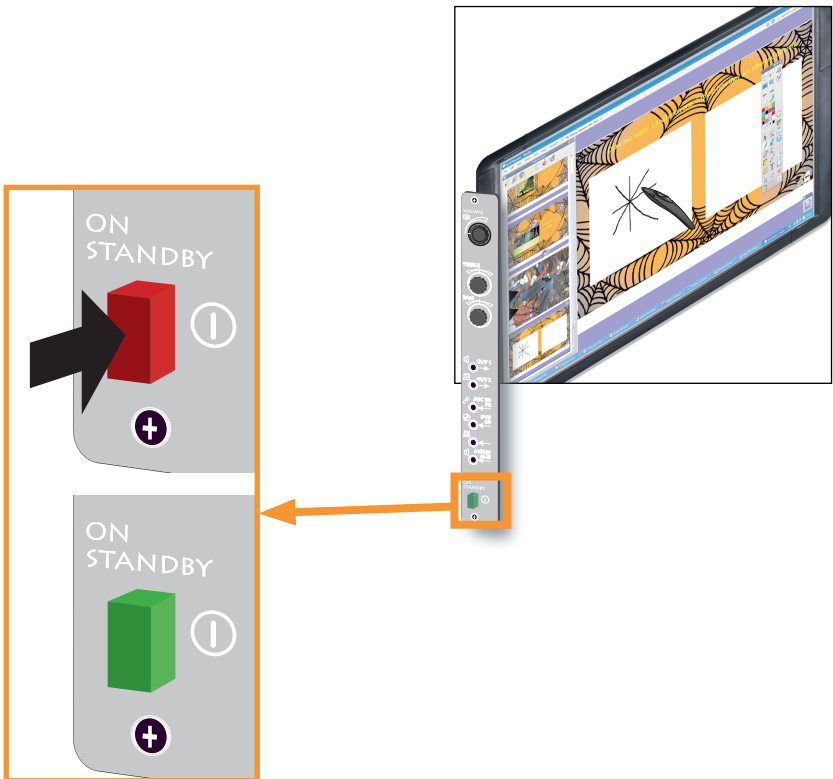
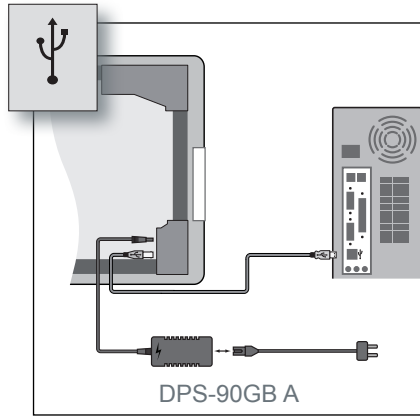

! Calibration

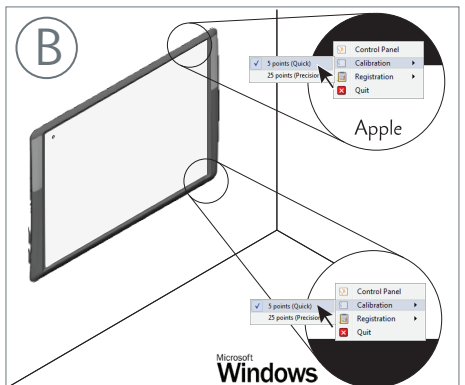
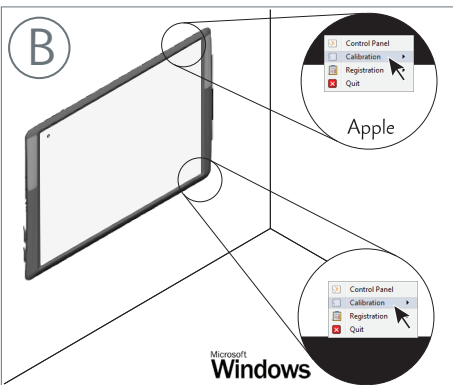
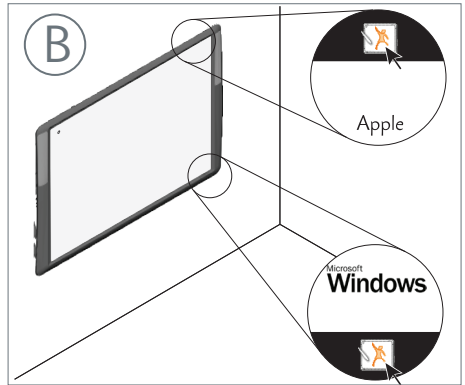
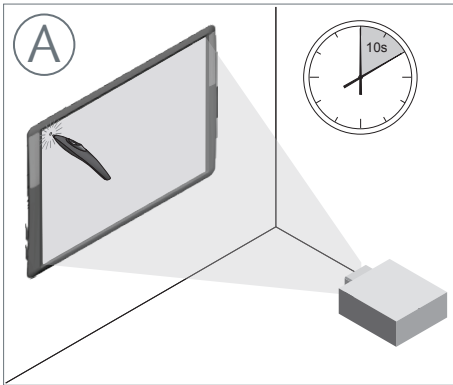
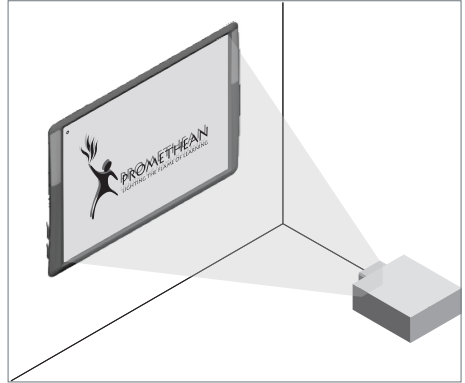
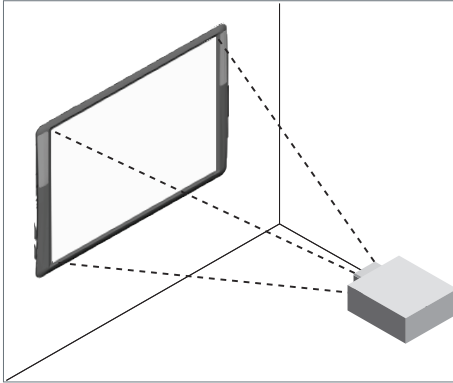

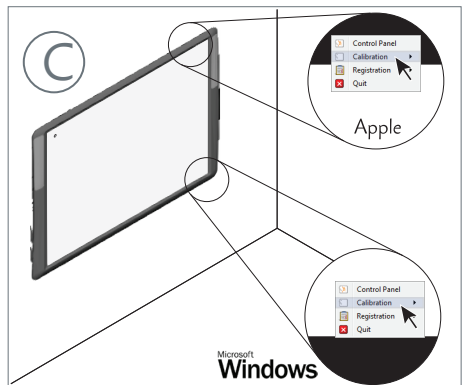
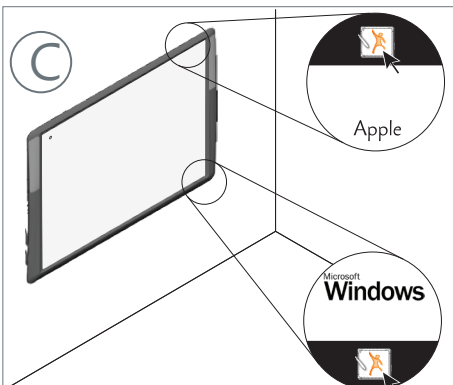
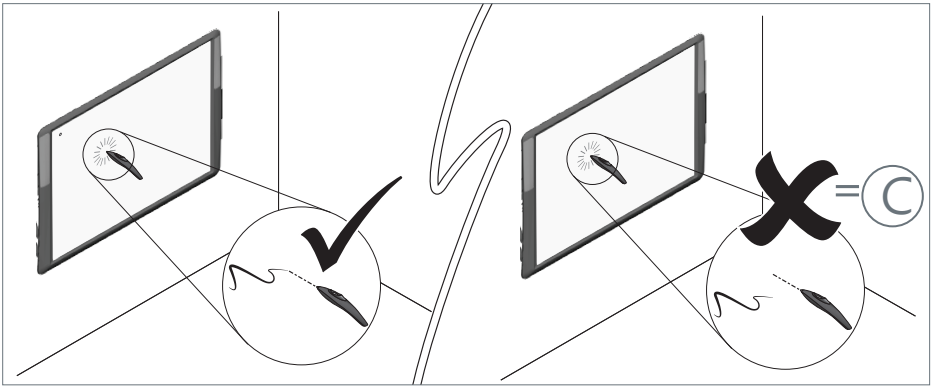
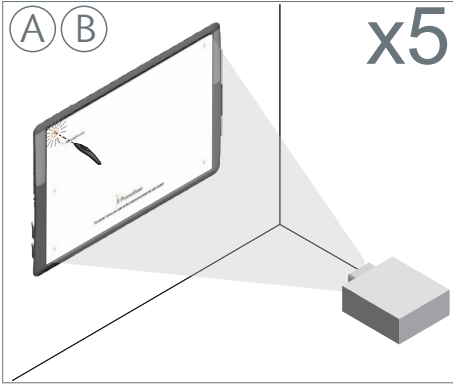

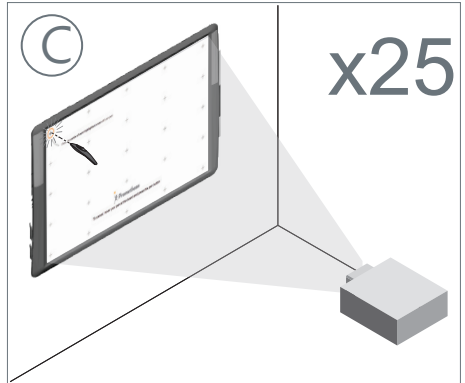
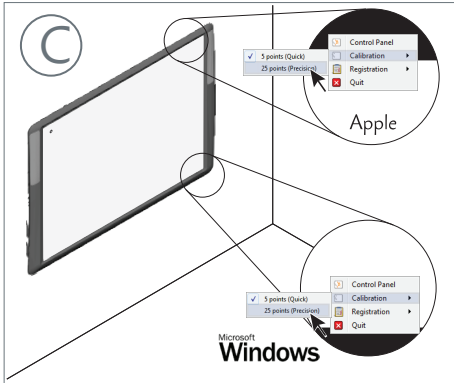

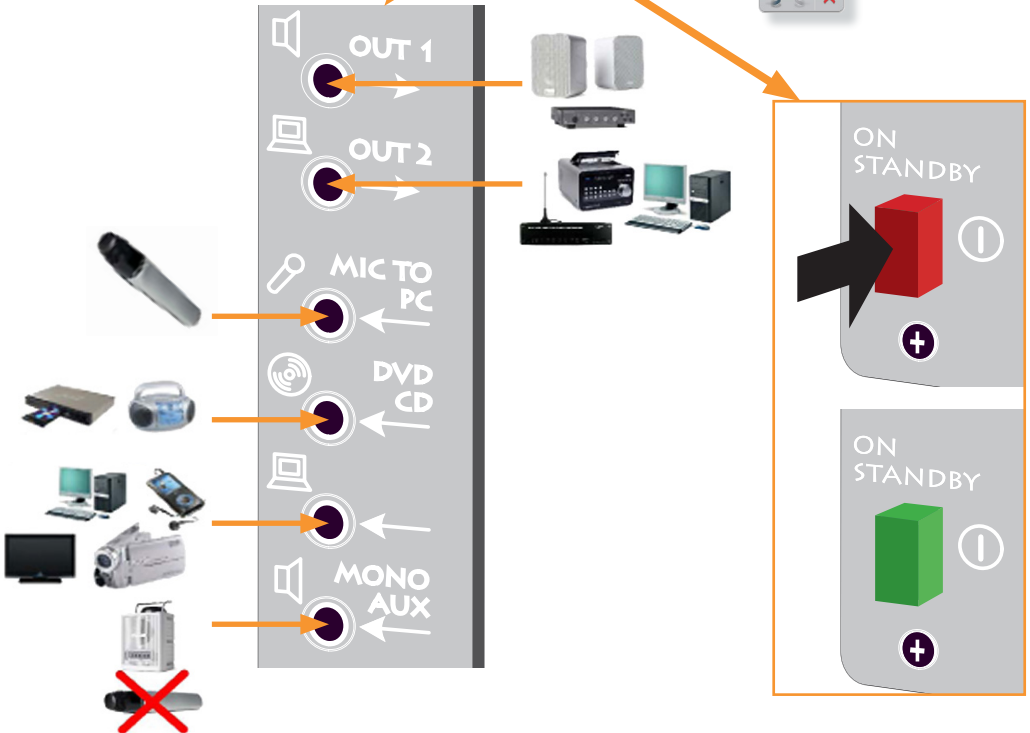
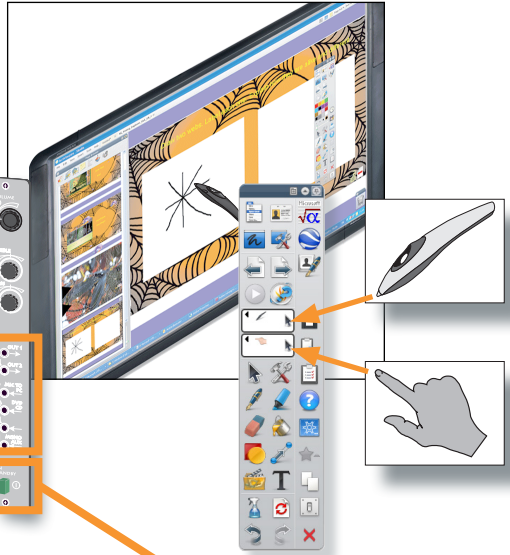

Technical support

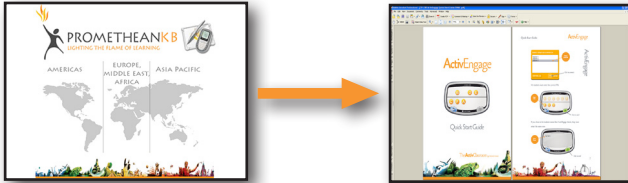

Touchboards

205 Westwood Ave, Long Branch, NJ 07740

Phone: 866-94 BOARDS (26273) / (732)-222-1511

Fax: (732)-222-7088 | E-mail: sales@touchboards.com