

ActivPanel 9

Premium



DISPLAY

| | |
|----------------------------|---|
| Screen Size and Resolution | 65" 4K |
| | 75" 4K |
| | 86" 4K |
| Screen Type | TFT LCD (Direct LED Backlight) |
| Blue Light Reduction | Yes |
| Bonded Glass | Yes |
| Aspect Ratio | 16:9 |
| Display Area | 65" 4K: 1429 x 804 mm (56.3 x 31.7 in) |
| | 75" 4K: 1652 x 930 mm (65 x 36.6 in) |
| | 86" 4K: 1895 x 1066 mm (74.6 x 41.9 in) |
| LCD Viewing Angle | 178° |
| LCD Response Time | 8 ms |
| LCD Refresh Rate (Panel) | 60 Hz |
| LED Lifespan | 50,000 hours |
| Contrast Ratio | 5000:1 Dynamic 1200:1 Static |
| Brightness | 400 cd/m2 |
| Ambient Light Sensor | Yes |
| Glass Hardness | 9H (pencil), 7 (Mohs) |
| Glass Type | Heat tempered, Anti-Glare |

INTERACTIVITY

| | |
|--------------------------------|---|
| Vellum Touch Technology | Yes |
| Continuous Touch Points | 20 |
| Touch Resolution | 32768 x 32768 px |
| Response Time | ≤5 ms |
| Touch Accuracy | 1 mm |
| Tracking Rate | 4 m/s |
| Scan Rate | 200 Hz |
| Gestures and Edge Swipes | Windows® supported |
| Eraser Included (Block Eraser) | Yes |
| Unique Pen IDs | 2 |
| Pen and Touch Differentiation | Yes |
| Palm Erase | Yes |
| Palm Rejection | Yes, writing and non-writing hand |
| Pens Included | Yes, 4 |
| Pen Type | Battery-less pen |
| Pen Holder | Integrated full-length pen tray |
| Pen Tip Diameter | 3 mm (Eraser 7 mm) |
| Classroom Essential Apps | Including Whiteboard, Annotate, Timer, Spinner, Screen Capture, Screen Share, Browser, PDF Reader, Media Player |
| Compatibility | Windows® 7 to 11; Mac OS® 10.8 to 10.11; macOS® Sierra 10.12.1 or later; Linux® Ubuntu 20.04 LTS; Chrome OS™ |

COMPUTING

| | |
|---------------------------|----------------------|
| Operating System | ActivPanel OS |
| RAM | 6.5 GB |
| Internal Storage | 64 GB |
| CPU | ARM CORTEX - A73 x 4 |
| GPU | ARM Mali-G52 2EE MC2 |
| ActivSync™ | Yes |
| Trusted Platform Module | Yes |
| Cloud Based User Profiles | Yes |

AUDIO

| | |
|----------------------------|----------|
| Dual Front-facing Speakers | 2 x 18 W |
| Subwoofer | 1 x 15 W |
| Microphone Array | Yes |

CONNECTIVITY

| | |
|--------------------------------|--|
| OPS Slot | 1 |
| HDMI In (Rear) | 2 (1 x 2.0, 1 x 2.1) |
| HDMI In (Front) | 1 (2.0) |
| Display Port | 1 (1.2) |
| USB-A 2.0 (Rear) | 1 |
| USB-C 3.2 (Rear) | 1 (100 W Power Delivery) |
| USB-B 3.0 (Touch, Front) | 1 |
| USB-B 3.0 (Touch, Rear) | 3 |
| USB-A 3.0 (Front) | 2 |
| USB-A 3.0 (Rear) | 2 |
| MicroSD Slot | Yes |
| LAN In (RJ45) | 1 Gbps |
| LAN Out (RJ45) | 1 Gbps |
| Wake-on-LAN | Yes |
| Wi-Fi (Client) | IEEE 802.11 a/b/g/n/ac/ax, Wi-Fi 6 and dual band supported |
| Bluetooth | 5.0 |
| HDMI Out | 1 (2.0) |
| VGA In | 1 |
| PC Audio (3.5 mm) | 1 |
| AV-In (3.5 mm) | 1 |
| Mic (3.5 mm) | 1 |
| Audio Out (3.5 mm) | 1 |
| RS-232 | 1 |
| Proximity Sensor for Warm Boot | Yes |
| NFC (Near-field Communication) | Yes |

ActivPanel 9

Premium

PANEL MANAGEMENT

| | |
|-----------------------------|-----|
| OTA Updates | Yes |
| Promethean Panel Management | Yes |

POWER

| | |
|-------------------------------|---|
| Power Requirements | 100 V - 240 V AC |
| Energy Star Power Consumption | 65" 4K: 119 W 75" 4K: 163 W 86" 4K: 194 W |
| Power Consumption (Standby) | <= 0.5 W |
| Ultra-Quiet Fanless Design | Yes |

ENVIRONMENTAL

| | |
|-----------------------|------------------------------------|
| Operating Temperature | 0 °C to 40 °C (32 °F to 104 °F) |
| Storage Temperature | -15 °C to 55 °C (-5 °F to 131 °F) |
| Operating Humidity | 20% to 80% non-condensing humidity |
| Storage Humidity | 20% to 90% non-condensing humidity |

COMPLIANCE & CERTIFICATION

| | |
|---------------------------|---|
| Regulatory Certifications | CE, FCC, IC, UL, CUL, CB, RCM |
| Energy Star Certified | 65" 4K: Yes 75" 4K: Yes 86" 4K: Yes |

PHYSICAL SPECIFICATIONS

| | |
|-----------------------|--|
| Panel Dimensions | 65": 1508 x 945 x 85 mm (59.4 x 37.2 x 3.3 in) 75": 1730 x 1070 x 86 mm (68.1 x 42.1 x 3.4 in) 86": 1974 x 1207 x 86 mm (77.7 x 47.5 x 3.4 in) |
| Packed Dimensions | 65": 1642 x 1072 x 246 mm (64.6 x 42.2 x 9.7 in) 75": 1860 x 1137 x 246 mm (74.6 x 45.7 x 9.7 in) 86": 2102 x 1300 x 246 mm (84.8 x 52.8 x 9.7 in) |
| Panel Net Weight | 65": 44.5 kg (98.1 lb) 75": 57.8 kg (127.4 lb) 86": 73.3 kg (161.6 lb) |
| Packed Weight | 65": 61.5 kg (135.6 lb) 75": 78.5 kg (173.1 lb) 86": 95.7 kg (211 lb) |
| Wall Mount Dimensions | 1010 x 720 x 52 mm (39.8 x 28.3 x 2.0 in) |
| VESA Mount Point | 65": 600 x 400 mm (23.6 x 15.7 in) 75": 800 x 400 mm (31.5 x 15.7 in) 86": 800 x 600 mm (31.5 x 23.6 in) |

EDUCATION SOFTWARE LICENSE

| | |
|----------------------------|----------|
| ActivInspire® Professional | Included |
| Single User | |

PACKED CONTENTS

| | |
|-------------------|--|
| What's in the Box | 1x ActivPanel 9 Premium 1x 3 m Length HDMI Cable 1x 3 m Length USB Cable (A-B) 1x 3 m Regional Power Cable 1x 2 m Length USB-C Cable 1x Remote Control 2x Batteries for Remote 4x Pens 1x Block Eraser 1x Sealed Antistatic Bag 8x Desiccant 4x VESA Mount Screws (M6) 1x Mini PC Bracket with Screws (x2) 2x NFC Cards 1x Quick Install Guide 1x Promethean Wi-Fi/Bluetooth Module 3x Antennae 1x Wi-Fi/Bluetooth Module User Guide 1x Wall Mount |
|-------------------|--|

INSTALLATION

The installation of this product should be completed by a qualified installer. Use of components not supplied by Promethean or not meeting minimum specifications may impact performance, safety and warranty. For more information, visit Support.PrometheanWorld.com.

WARRANTY

Warranty term and upgrade options vary by region. Contact your local reseller or distributor for information and visit PrometheanWorld.com/Warranty.

SUPPORT

For all Promethean products, visit Support.PrometheanWorld.com.

ActivPanel 9

Premium

TECHNICAL DRAWINGS

65"

Front

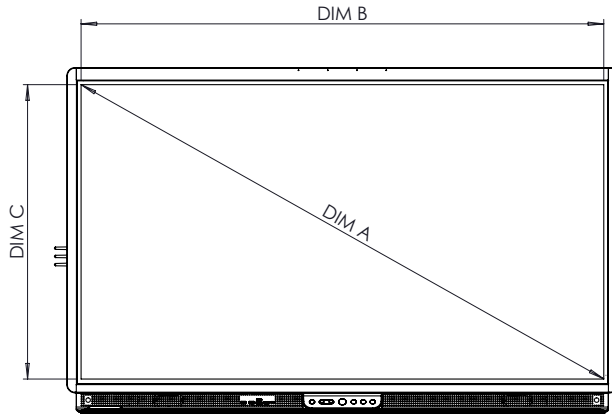

| DIM | DIMENSIONS (MM) | DIMENSIONS (IN) |
|-----|-----------------|-----------------|
| A | 1642 | 64.6 |
| B | 1431 | 56.3 |
| C | 806 | 31.7 |
| E | 128 | 5.0 |
| F | 85 | 3.4 |
| G | 945 | 37.2 |
| H | 1508 | 59.4 |
| I | 600 | 23.6 |
| J | 400 | 15.7 |

Back

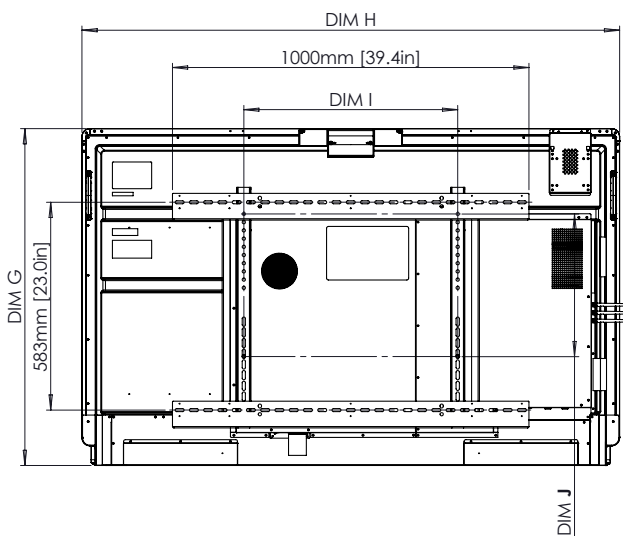

Side

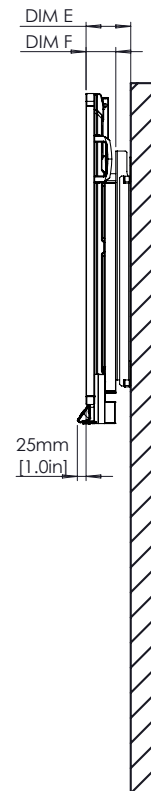

ActivPanel 9

Premium

TECHNICAL DRAWINGS

75"

Front

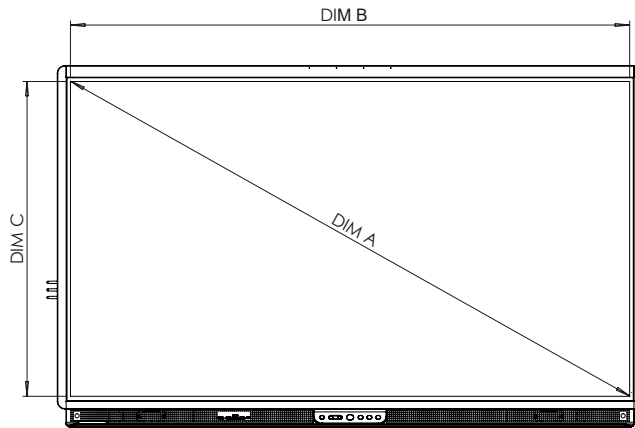

| DIM | DIMENSIONS (MM) | DIMENSIONS (IN) |
|-----|-----------------|-----------------|
| A | 1896 | 74.7 |
| B | 1652 | 65.0 |
| C | 930 | 36.6 |
| E | 128 | 5.0 |
| F | 86 | 3.4 |
| G | 1070 | 42.1 |
| H | 1730 | 68.1 |
| I | 800 | 31.5 |
| J | 400 | 15.7 |

Back

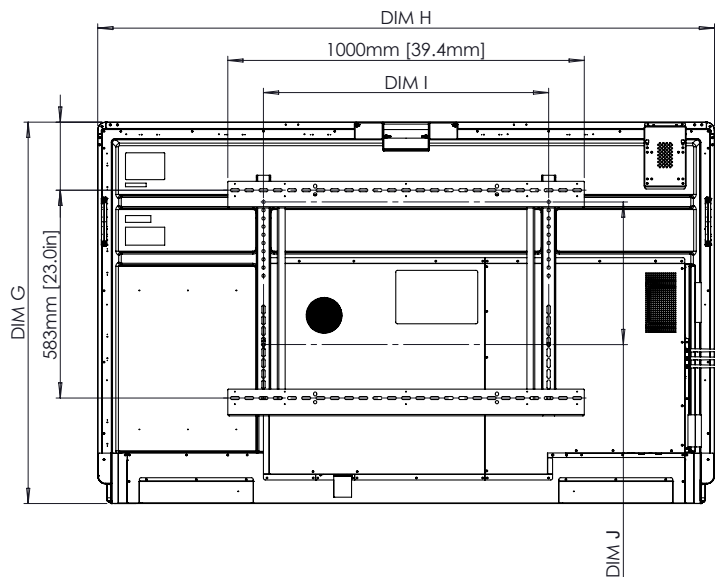

Side

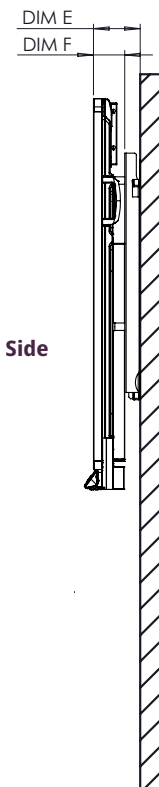

ActivPanel 9

Premium

TECHNICAL DRAWINGS

86"

Front

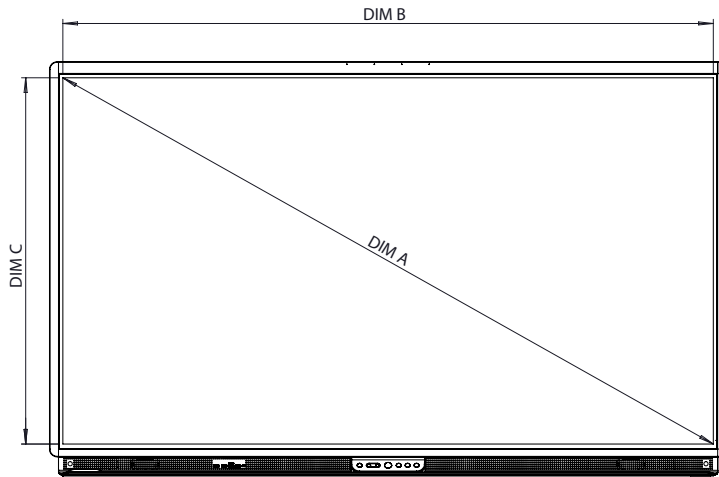

| DIM | DIMENSIONS (MM) | DIMENSIONS (IN) |
|-----|-----------------|-----------------|
| A | 2177 | 85.7 |
| B | 1897 | 74.7 |
| C | 1068 | 42.0 |
| E | 128 | 5.0 |
| F | 86 | 3.4 |
| G | 1207 | 47.5 |
| H | 1974 | 77.7 |
| I | 800 | 31.5 |
| J | 600 | 23.6 |

Back

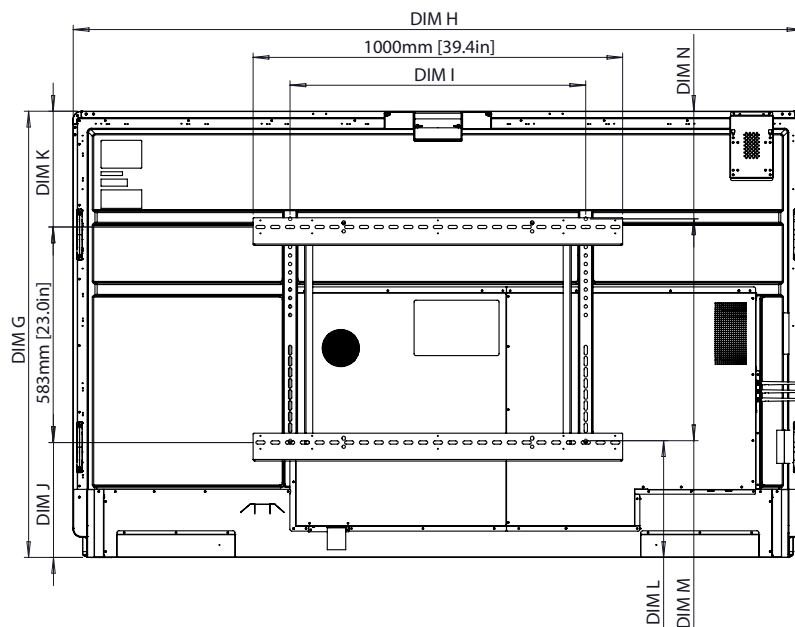

Side

