

New and improved multi-voltage FumeCube Max with almost 20% better airflow!



Multi-voltage FumeCube Max

Purex has upgraded one of their bestselling products and made it even better! FumeCube is now multi-voltage and can adapt to any voltage requirement. Perfect for bench soldering, and light laser marking applications.

Recirculating fume extraction is now extremely important with the rising concern for our environment and employee safety. Purex Fume Extractors provide not only a flexible and portable process for plant redesigns and expansions, but also a more stable process by providing a controlled airflow to remove harmful fumes. All this while eliminating the added costs of building modifications, increased air handling systems and lost energy.

Purex Systems

- ❖ Automatic Flow Control maintains constant extraction rate
- ❖ Adjustable Air Flow extends filter life
- ❖ Blocked Filter Warning
- ❖ Easy to change filters
- ❖ Quiet operation
- ❖ Low Energy consumption
- ❖ HEPA filtration removes 99.997% of particles down to .3 microns
- ❖ Remote Machine Interface
- ❖ Welded stainless steel construction
- ❖ Continuous run brushless motors
- ❖ Multi-voltage, use anywhere in the world

FumeCube Max

Power Switch w/
Indicator Light

Variable Speed
Control

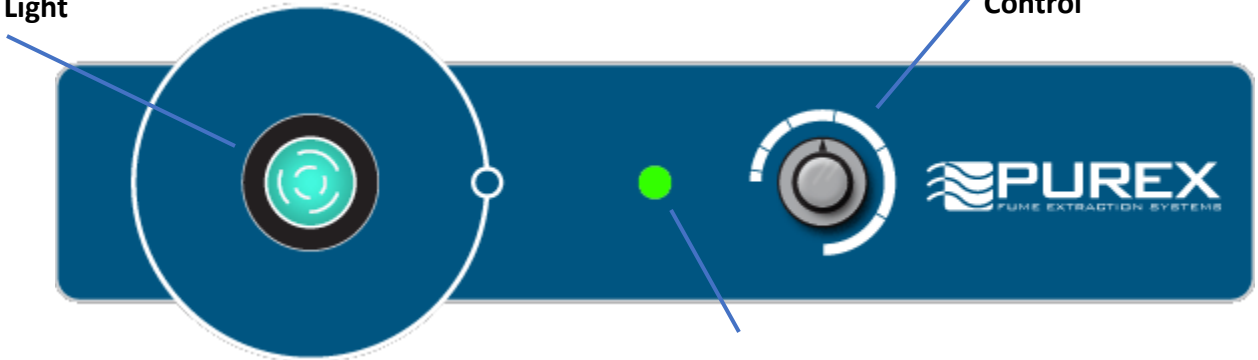

Filter Status
Indicator

Main Filter Options



HEPA/Chemical
Chemical

110507
110504

Pre-Filter



F8/F9 Composite >95% eff .5-1 μ 111124

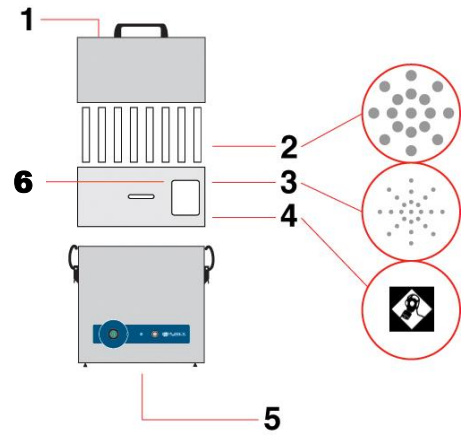

- 1) Dual Air inlet
- 2) Pre-filter
- 3) Main filter (HEPA Location)
- 4) Main filter (Carbon Location)
- 5) Clean air return
- 6) Filter I.D. label

	FumeCube Max
Model	072152
Voltage (50hz/60Hz)	100-230V
Wattage	.14 kW
Airflow	140 cfm (238 m ³ /Hr)
Vacuum	13 inwg (3.2 kPa)
Air Inlet	80mm Safe Seal
-Sound Rating	59 dBA
Dimensions (L/W/H)	12.15in x 13in x 19in
Weight	31 lbs

Hose and Arm Kits Available

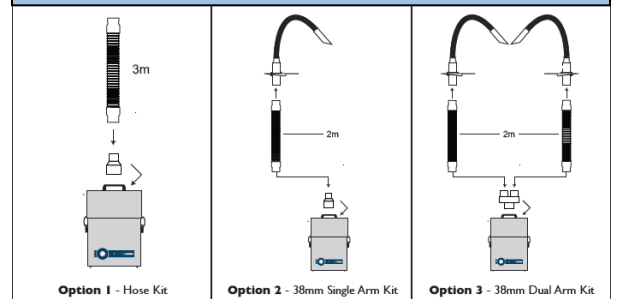

Option 1 - Hose Kit

Option 2 - 38mm Single Arm Kit

Option 3 - 38mm Dual Arm Kit