



RDP506 Shown

Capacity Range▶ 10 - 100 tons
 Stroke Range▶ 6 in.
 Maximum Pressure▶ 10,000 psi

- ▶ Hard chrome plated steel piston rods resist corrosion.
- ▶ Ideal for joining steel plates for welding.
- ▶ Useful for the fabrication industry as well as cable tensioning.
- ▶ Double acting cylinder provides quick & full retraction.



COUPLERS - pages 74 - 75

High flow quick disconnect couplers provide a quick change to a variety of pumps.



IN-LINE VALVES - page 72

Maximize control and safety with our in-line valves.



HOSES - pages 78 - 79

Heavy duty and thermo plastic hydraulic hoses to meet your requirements and safety factor.

The Simplex RDP506 is used by this manufacturer of heavy steel cables.▼

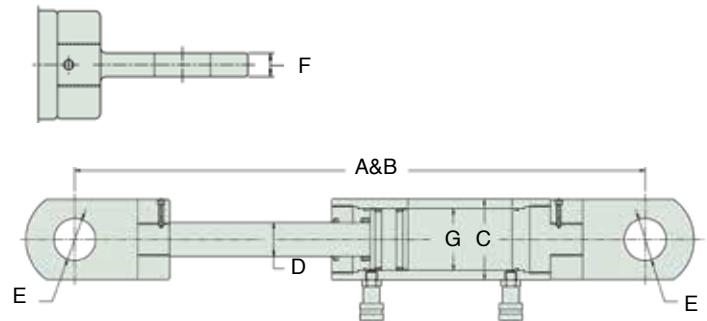

Model	Capacity (tons)	Stroke (in)	Oil Capacity Required (cu.in.)	Effect Area (sq.in.)	Pressure @ Capacity (psi)	A	B	C	D	E	F	G	Wgt. (lbs)
						Closed Dimensions (in)	Open Dimensions (in)	Body O.D. (in)	Piston O.D. (in)	Clevis Hole Diameter (in)	Clevis Width (in)	Bore Diameter (in)	
RDP106	10	6	11.5	2.4	8333	21.1	27.1	3.34	1.57	1.18	.78	2.36	30.8
RDP306	30	6	16.56	6.6	9091	26.3	32.3	4.53	1.89	2.36	.98	3.46	63.8
RDP506	50	6	25.9	11.7	8547	25.2	31.2	6.10	2.36	2.75	1.77	4.53	99
RDP1006	100	6	30.38	22.2	9010	29.1	35.1	7.80	2.56	3.15	1.97	5.91	193.6