

Dual Input Hygro-Thermometer Psychrometer

Model RH350

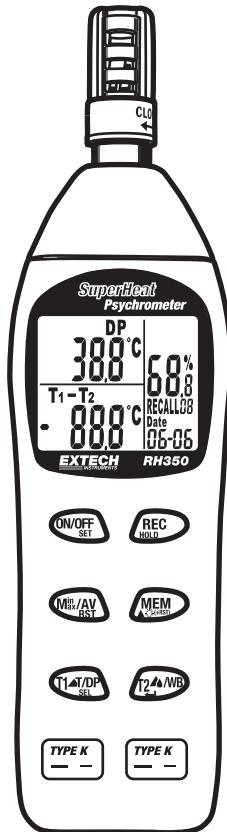

Introduction

Thank you for selecting the Extech Model RH350. This device is shipped fully tested and calibrated and, with proper use, will provide years of reliable service. Please visit the Extech Instruments website (www.extech.com) to check for the latest version of this User Guide.

Meter Description

1. Humidity Sensor & Air Temperature Sensor
2. Triple LCD Display
3. On/Off; Set Mode
4. Min/Max/Average; Reset Min/Max
5. Air, T1, Air-T1, Dew Point
6. T1 probe input
7. T2 probe input
8. T1-T2, T2, T1-Dew Point, Wet Bulb
9. Store Current Reading; Backlight
10. Hold; Recall Mode
11. RS232 port

Note: The battery compartment is located on the rear of the instrument

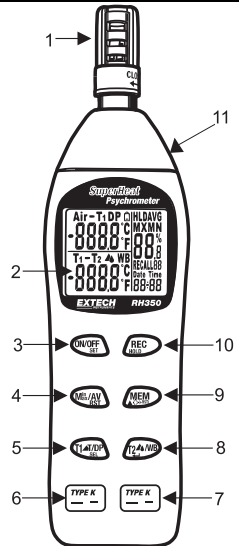

Display Description

1. Air, T1, Air-T1, Dew Point, Low Battery
2. Temperature °C/°F
3. T2, T1-T2, T1-Dew Point, Wet Bulb
4. Temperature °C/°F
5. Date (month, day, year), Time (24 hour clock)
6. Memory Store/Recall Location
7. Relative Humidity %
8. Maximum, Minimum
9. Hold, Average



Operation

Open the Protective Sensor Cap

Twist the protective sensor cap, located at the top of the meter, counter-clockwise a quarter of a turn to expose the sensors.

Turn Power ON or OFF

Press the **[ON/OFF]** button to turn power on or off. The meter will perform a short self-test when turned on.

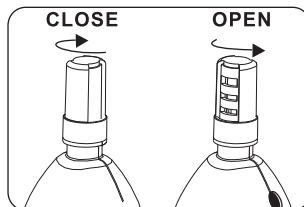

Taking measurements

1. Hold the probe in the area to be tested.
2. Allow adequate time for readings to stabilize.
3. The Relative Humidity measurement appears in the right display along with the date and time.
4. Air Temperature appears in the top left display.
5. Wet Bulb is in the lower left display.
6. Pressing the **[T1T/DPSEL]** button toggles the top left display between Air temperature, T1 temperature, Air-T1, and DP (Dew Point).
7. Pressing the **[T2▲WB]** button toggles the lower left display between WB (Wet Bulb), T1-T2, T2, and T1-DP (Dew Point).

SETUP

When the meter is off, press and hold the **[ON/OFFSET]** button for more than 2 seconds to enter setup mode. Prnt will appear on the display.

1. Selecting temperature units of measure (C/F)

Momentarily press the **[T1T/DPSEL]** button until "unit" appears in the display.

Press the **[MEM]** button to toggle between C or F.

Press the **[T2▲WB]** button to confirm the setting and return to normal operation.

2. Setting the Date/Time (24 hour clock)

Press the **[T1T/DPSEL]** button to select Year, Month, Day, Hour and Minute in sequence.

Press the **[MEM]** button to change the settings.

Press the **[T2▲WB]** button to confirm the date/time setting and return to normal operation.

Data Hold

Press the **[RECHOLD]** button momentarily to freeze the displayed reading. The 'HLD' icon will appear on the upper right-hand side of the display. Press the **[RECHOLD]** button again to return to normal operation.

Minimum (MN) Maximum (MX) Average (AVG) Function

The MIN/MAX/Average mode allows the user to view only the lowest (**MN**), highest (**MX**) or average readings. Press the **[M^h/AVRST]** button once and **MN** appears on the display. The display is now showing the lowest humidity and temperature readings in memory. Press the **[M^h/AVRST]** button again and **MX** appears on the display. The display is now showing the maximum humidity and temperature readings in memory. Press the **[M^h/AVRST]** button again to display the average (**AVG**) readings in memory. To exit the MIN/MAX/AVG mode, press the **[M^h/AVRST]** button. To clear the current min/max/avg readings in memory, press and hold the **[M^h/AVRST]** button for more than two seconds.

Backlight Display

Press the **[Mⁱⁿ/AVRST]** and **[MEM]** buttons together to turn on the backlight. It will remain on for ten seconds.

Automatic Power OFF

With the meter off, press and hold down the **[ON/OFFSET] + [RECHOLD]** buttons for more than 1 second to enter auto power off settings.

Press the **[MEM]** button to select non-sleep (n) or 2, 5, 10, 20, 40 and 60 minutes autosleep.

Press **[T2 ▲WB]** to confirm the selection.

Manual Datalogging

Manual datalogging allows the user to store and recall up to 99 readings with the press of a button.

1. Press the **[MEM]** button to manually store a single reading into memory. The display will flash 3 times and the memory location number will be displayed below the humidity reading.
2. To view stored readings, press and hold the **[RECHOLD]** button for 2 seconds and "RECALL" will blink next to the memory location number on the display.
3. Press the **[MEM]** button to manually increment through the stored readings.
4. Press **[RECHOLD] + [MEM]** for more than 1 second to clear the memory.
5. Press **[RECHOLD]** for more than 1 second to return to normal operation.

Note: In RECALL mode, pressing the **[Mⁱⁿ/AVRST]** button for min/max/avg readings will auto search the stored readings in memory and display the minimum, maximum and average values of the stored readings.

Note: A printer port is located on the side of the meter, however it is not functional on this model.

CALIBRATION

The following verification and calibration procedures require the 33% and 75% RH reference bottles which are supplied with the Model RH350-CAL kit.

Accuracy Verification

Checking the 33% or 75% RH Calibration

1. Insert meter's sensor into the 33% or 75% salt reference bottle
2. Check the reading after a minimum of 10 minutes
3. Verify that the reading is within the accuracy specification

Relative Humidity Calibration (33% and 75%)

33% Calibration

1. Turn the meter Off.
2. Insert the meter sensor into the 33% salt reference bottle.
3. Allow the meter one hour to stabilize.
4. While holding down the **[Mⁿ/AVRST]** button, press and hold the **[ON/OFFSET]** button for 2 seconds to enter calibration mode.
5. "32.8%" (reading may vary depending on operating temperature) will flash on the LCD screen. After 30 minutes, the flashing will stop to indicate that the 33% calibration is complete.

Note: Do NOT turn off the meter

6. Proceed to the 75% Calibration below.

75% Calibration

1. Insert the meter sensor into the 75% salt reference bottle.
2. Allow the meter one hour to stabilize
3. Press and hold the **[Mⁿ/AVRST]** button for 2 seconds to enter the 75% calibration.
4. "75.3%" (reading may vary depending on operating temperature) will flash on the LCD. After 30 minutes, the flashing will stop to indicate that the 75% calibration is complete.
5. Calibration is now complete. Turn power off.

Note: Frequently check the water level in the salt bottles. Both the 33% and 75% bottles should be completely saturated with some water present. The bottles are sealed and not refillable.

RS-232 PC Communications Interface

The meter is equipped with an RS-232 PC interface jack (3.5mm phono) for connection to a PC. The cable to connect the meter to the PC is included in the optional 407752 data acquisition kit. The kit includes Windows™ compatible software that allows the user to store readings in a text file and display real-time measurements in a series of selectable formats. For more information or specific operating instructions, refer to the User Guide included with the 407752 kit or contact Extech Instruments.

Specifications

| Function | Range and Resolution | Accuracy |
|--------------------------|-------------------------------|------------------------------|
| Humidity | 0.0 to 100.0% RH | ±3% RH (10 to 90%) @ 23°C |
| Temperature (air) | -4.0 to 122.0°F (-20 to 50°C) | ±1.8°F (±1°C) |
| Temperature (external K) | -40 to 1832°F (-40 to 1000°C) | ±(0.3% rdg + 1.8°F (1°C)) |

| | |
|------------------------------|---|
| Display | Triple LCD |
| Sensor Type | Humidity: Precision capacitance sensor Internal Temperature: Thermistor External Temperature: K-Type Thermocouple |
| Response Time | 60 seconds typical |
| Dew Point | -90.4 to 122.0°F (-68 to 50°C) (calculated from RH and Air temperature measurements) |
| Wet Bulb | -6.88 to 122.0°F (-21.6 to 50°C) (calculated from RH and Air temperature measurements) |
| Low Battery Indicator | Yes |
| Overrange Indicator | E2 (air) E5 (T1), E8 (T2) |
| Underrange Indicator | E3 (air), E6 (T1), E9 (T2) |
| Operating Conditions | -4 to 122°F (-20 to 50°C); < 99% RH non-condensing |
| Storage Conditions | -40 to 185°F (-40 to 85°C); <99% RH non-condensing |
| Power Supply | 4 x 1.5V 'AAA' batteries |
| Battery Life | Approx. 300 hours |
| Dimensions / Weight | 9 x 2.2 x 1.7" (230 x 57 x 44mm); 5.3 oz. (153g) |

Maintenance

Cleaning and storage

1. The meter should be cleaned with a damp cloth and mild detergent when necessary. Do not use solvents or abrasives.
2. Store the meter in an area with moderate temperature and humidity (refer to the operating and storage range in the specifications chart earlier in this manual).

Battery Replacement

When the battery power falls low, the  symbol will appear on the LCD. Replace the four (4) 1.5 'AAA' batteries by removing the rear battery compartment cover and accessing the battery compartment. Observe polarity when placing the batteries in the compartment. Ensure that the compartment cover is securely fastened when finished.

Warranty

FLIR Systems, Inc. warrants this Extech Instruments brand device to be free of defects in parts and workmanship for one year from date of shipment (a six month limited warranty applies to sensors and cables). If it should become necessary to return the instrument for service during or beyond the warranty period, contact the Customer Service Department for authorization. Visit the website www.extech.com for contact information. A Return Authorization (RA) number must be issued before any product is returned. The sender is responsible for shipping charges, freight, insurance and proper packaging to prevent damage in transit. This warranty does not apply to defects resulting from action of the user such as misuse, improper wiring, operation outside of specification, improper maintenance or repair, or unauthorized modification. FLIR Systems, Inc. specifically disclaims any implied warranties or merchantability or fitness for a specific purpose and will not be liable for any direct, indirect, incidental or consequential damages. FLIR's total liability is limited to repair or replacement of the product. The warranty set forth above is inclusive and no other warranty, whether written or oral, is expressed or implied.

Calibration, Repair, and Customer Care Services

FLIR Systems, Inc. offers repair and calibration services for the Extech Instruments products we sell. NIST certification for most products is also provided. Call the Customer Service Department for information on calibration services available for this product. Annual calibrations should be performed to verify meter performance and accuracy. Technical support and general customer service is also provided, refer to the contact information provided below.

Support Lines: U.S. (877) 439-8324; International: +1 (603) 324-7800

Technical Support: Option 3; E-mail: support@extech.com

Repair & Returns: Option 4; E-mail: repair@extech.com

Product specifications are subject to change without notice

Please visit our website for the most up-to-date information

www.extech.com

FLIR Commercial Systems, Inc., 9 Townsend West, Nashua, NH 03063 USA

Copyright © 2014 FLIR Systems, Inc.

All rights reserved including the right of reproduction in whole or in part in any form

www.extech.com

Garantie

FLIR Systems, Inc. garantit que cet appareil Extech Instruments est exempt de défauts matériaux et de fabrication pendant un an à partir de la date d'envoi (une garantie limitée de six mois s'applique aux capteurs et aux câbles). Si le renvoi de l'appareil pour réparation devient nécessaire durant ou après la période de garantie, contactez le service client pour autorisation. Pour obtenir les coordonnées, visitez le site Web suivant : www.extech.com. Un numéro d'autorisation de retour (AR) doit être délivré avant tout retour de produit. L'expéditeur prend à sa charge les frais d'expédition, le fret, l'assurance et l'emballage correct de l'appareil afin de prévenir toute détérioration durant le transport. Cette garantie ne s'applique pas aux dommages imputables à l'utilisateur, tels que l'usage impropre ou abusif, un mauvais câblage, une utilisation non conforme aux spécifications, un entretien ou une réparation incorrecte, ou toute modification non autorisée. FLIR Systems, Inc. déclinera spécifiquement toute garantie ou qualité marchande ou aptitude à l'emploi prévu, et ne sera en aucun cas tenu responsable pour tout dommage conséquent, direct, indirect ou accidentel. La responsabilité totale de FLIR est limitée à la réparation ou au remplacement du produit. La garantie définie ci-dessus est inclusive et aucune autre garantie, écrite ou orale, n'est exprimée ou implicite.

Calibrage, réparation et services après-vente

FLIR Systems, Inc. offre des services de calibrage et de réparation pour les produits Extech Instruments que nous commercialisons. Nous fournissons également une certification NIST pour la plupart des produits. Contactez notre service client pour toute information sur les services de calibrage disponibles pour ce produit. Un calibrage doit être effectué chaque année pour vérifier les performances et la précision du mètre. Nous offrons également une assistance technique et un service à la clientèle. Veuillez vous reporter aux coordonnées fournies ci-dessous.

Lignes d'assistance: États-Unis (877) 439-8324; international: +1 (603) 324-7800

Service d'assistance technique : Option 3 ; E-mail : support@extech.com

Réparations et retours : Option 4 ; E-mail : repair@extech.com

Les spécifications produit sont sujettes à modifications sans préavis.

Pour les toutes dernières informations, veuillez visiter notre site Web.

www.extech.com

FLIR Commercial Systems, Inc., 9 Townsend West, Nashua, NH 03063 USA

Copyright © 2014 FLIR Systems, Inc.

Tous droits réservés, y compris la reproduction partielle ou totale sous quelque forme que ce soit.

www.extech.com

Garantía

FLIR Systems, Inc., garantiza este dispositivo marca Extech Instruments para estar libre de defectos en partes o mano de obra durante un año a partir de la fecha de embarque (se aplica una garantía limitada de seis meses para cables y sensores). Si fuera necesario regresar el instrumento para servicio durante o después del periodo de garantía, llame al Departamento de Servicio al Cliente para obtener autorización. Visite www.extech.com para Información de contacto. Se debe expedir un número de Autorización de Devolución (AD) antes de regresar cualquier producto. El remitente es responsable de los gastos de embarque, flete, seguro y empaque apropiado para prevenir daños en tránsito. Esta garantía no se aplica a defectos resultantes de las acciones del usuario como el mal uso, alambrado equivocado, operación fuera de las especificaciones, mantenimiento o reparación inadecuada o modificación no autorizada. FLIR Systems, Inc., rechaza específicamente cualesquier garantías implícitas o factibilidad de comercialización o idoneidad para cualquier propósito determinado y no será responsable por cualesquier daños directos, indirectos, incidentales o consecuentes. La responsabilidad total de FLIR está limitada a la reparación o reemplazo del producto. La garantía precedente es inclusiva y no hay otra garantía ya sea escrita u oral, expresa o implícita.

Servicios de calibración, reparación y atención a clientes

FLIR Systems, Inc., ofrece servicios de reparación y calibración para los productos que vendemos de Extech Instruments. Además ofrecemos certificación NIST para la mayoría de los productos. Llame al Departamento de Servicio al Cliente para solicitar información de calibración para este producto. Para verificar el funcionamiento y precisión se debe realizar la calibración anual. Además se provee Soporte Técnico y servicios generales al cliente, consulte la información de contacto en seguida.

Líneas de soporte: EE.UU. (877) 439-8324; Internacional: +1 (603) 324-7800

Soporte Técnico Opción 3; correo electrónico: support@extech.com

Reparación / Devoluciones: Opción 4; correo electrónico: repair@extech.com

Las especificaciones del producto están sujetas a cambios sin aviso

Por favor visite nuestra página en Internet para la información más actualizada

www.extech.com

FLIR Commercial Systems, Inc., 9 Townsend West, Nashua, NH 03063 USA

Certificado ISO 9001

Copyright © 2014 FLIR Systems, Inc.

Reservados todos los derechos, incluyendo el derecho de reproducción total o parcial en cualquier medio

www.extech.com