



RADWAG BALANCES AND SCALES
ADVANCED WEIGHING TECHNOLOGIES

IMMB-06-02-06-21-EN

Start up Guide

Precision Balances

- WLC A1
- WLC A2
- WLC A1/C/2
- WLC A2/C/2

To view a complete User Manual go to the website or scan QR code:



radwag.com/en/manuals/7012

1. CONTENT

Models: WLC A1

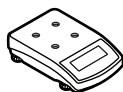

Balance
x1



Draft shield
x1



Weighing pan
x1



Grounding foot
x1



Foot
x3



Power adapter*
x1

Models: WLC A2

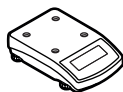

Balance
x1



Weighing pan
x1



Grounding foot
x1



Foot
x3



Power adapter*
x1

**The plug type may vary by country.*

2. UNPACKING

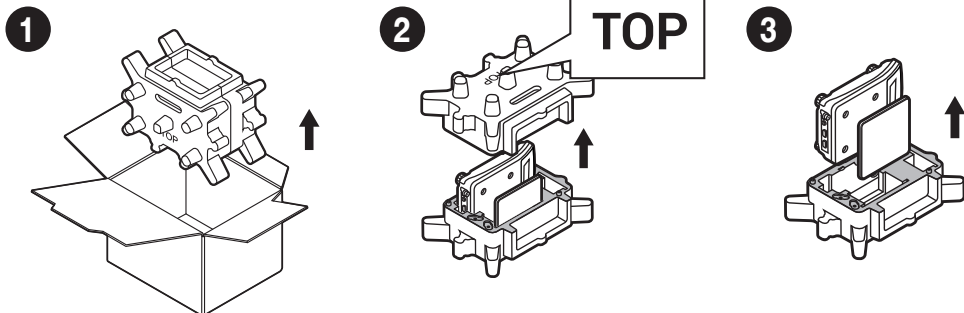

Keep the packaging should a warranty claim or service be required.

3. RECOMMENDATIONS AND WARNINGS

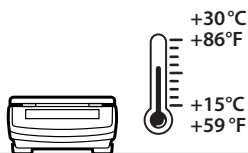

Operate the device in a room where the temperature ranges between 15–30 °C (59–86 °F) and where the relative humidity is below 80%. Any changes in temperature should be gradual and very slow.

Place the balance on a solid surface to ensure stability. To obtain stable and repeatable weighing results, an anti-vibration table is recommended.

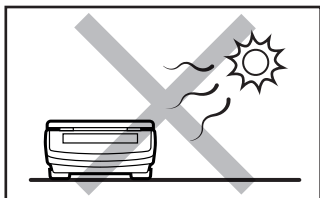

Place the balance away from heat sources. Avoid exposing the balance to the sunlight.

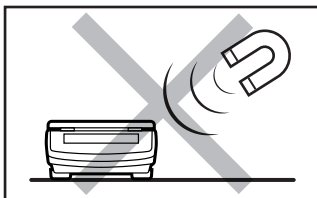

Avoid exposing the balance to a magnetic field. Do not weigh magnetic substances.

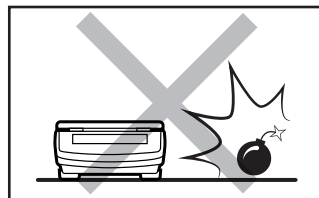

Do not place the balance in a hazardous area. Do not weigh explosive materials.

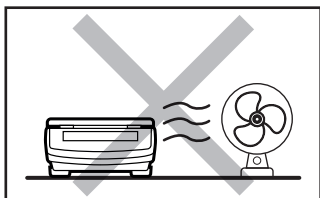

Avoid air drafts and air movements at the workstation.

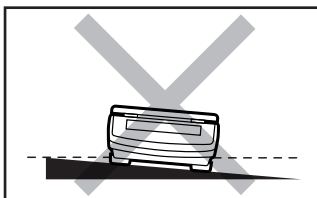

Make sure that the balance is placed on an even surface.

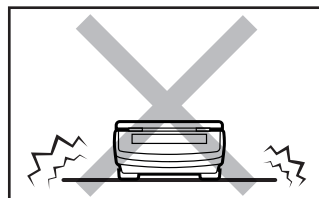

Do not place the balance on an unstable ground exposed to shocks and vibrations.

4. ACTIVITIES TO BE DONE PRIOR TO OPERATION

4.1. Grounding spring check

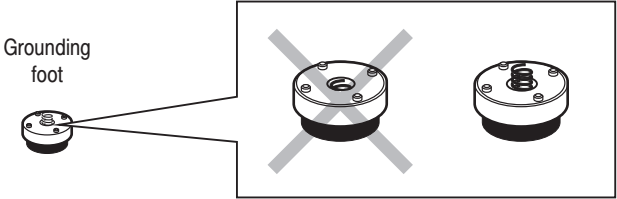

Check whether the grounding spring takes its intended location.

Make sure that the grounding spring juts slightly out of the hole.

5. COMPONENTS ASSEMBLY

Models: WLC A2



Models: WLC A1

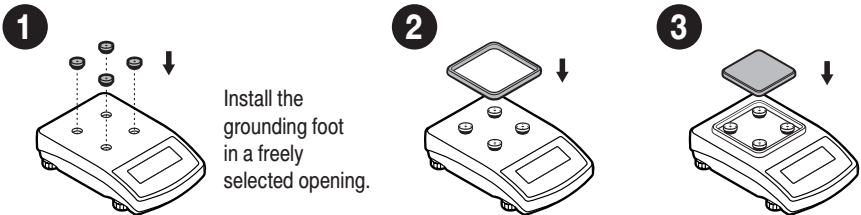

6. PREPARING FOR WORK

6.1. Temperature stabilisation

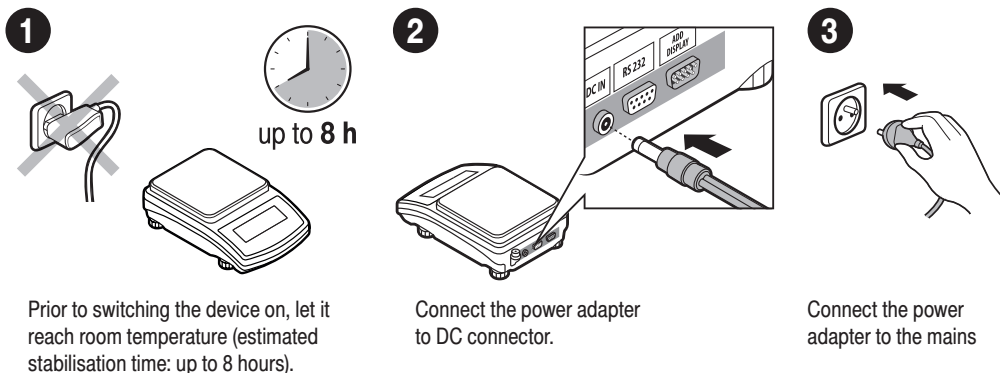

6.2. Levelling

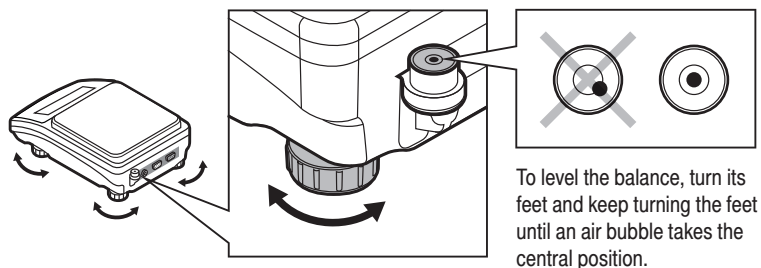

6.3. Switching the balance on

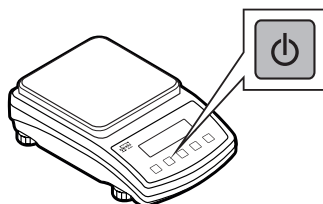

To switch the device on, press ON / OFF key.



Your balance is ready to use!

7. PANEL AND SCREEN

7.1. Panel keys

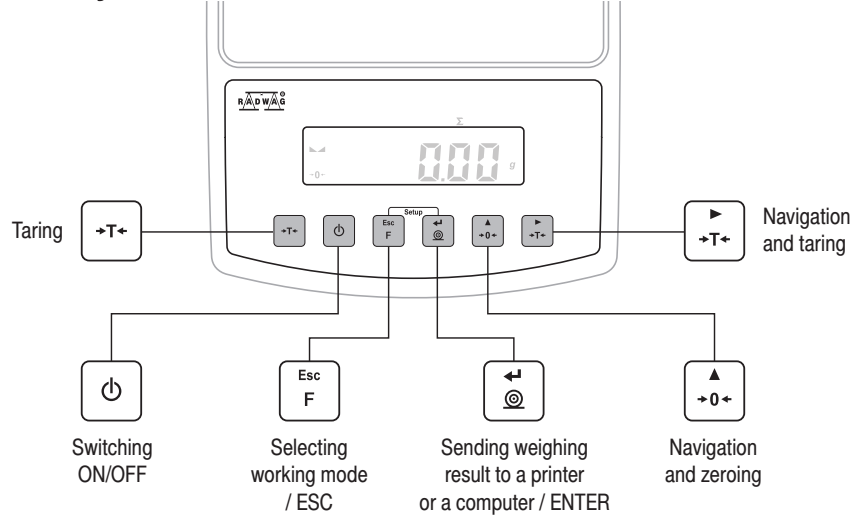

7.2. Home screen



8. BASIC OPERATIONS

8.1. Adjustment (for models with an internal adjustment only)

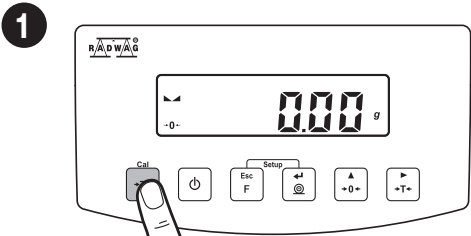

Press "Adjustment" button.

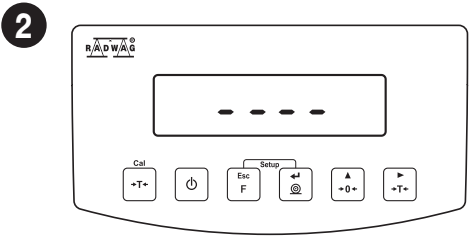

Wait for the process completion.

8.2. Adjustment (for models with an external adjustment only)

External adjustment is carried out using an external mass standard of the right accuracy and weight value, which value depends on balance type and capacity.

! The adjustment mass standard does not come with the balance. Prior to adjustment prepare the right mass standard. You are recommended to use a mass standard of class F1 or F2. View the table and select the mass standard you need.

Balance model	Mass standard [g]
WLC 1/A2	1 000
WLC 2/A2	2 000
WLC 6/A2 *	5 000
WLC 10/A2	10 000
WLC 20/A2	10 000

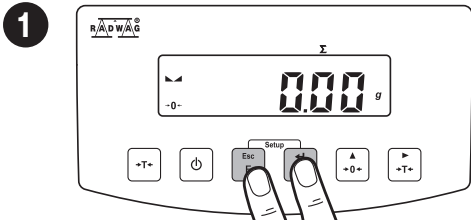

Simultaneously press **Esc F** + **Setup** keys to enter home screen.

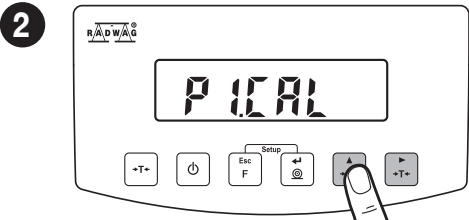

Using **-0-** key select "P1.CAL" parameter and press **-T-** key.

* - N/A in the case of a non-verified instrument

3

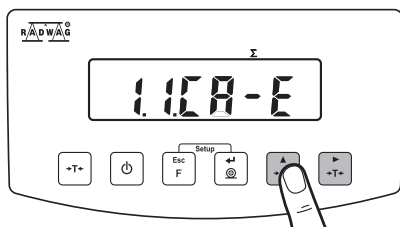

Using ▲+0= key select "1.1CA-E" parameter and press ▶T= key.

4

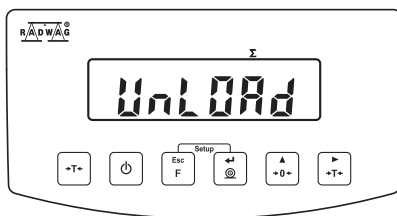

Wait for completion of the start mass determination process.

5

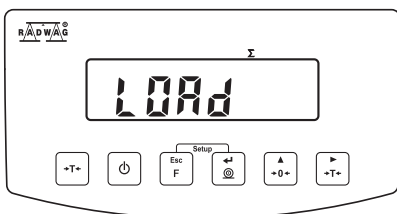

Prepare suitable mass standard.

6

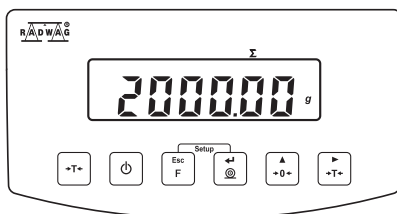

Load the weighing pan with the mass standard.

7

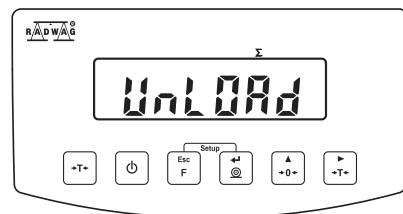

Unload the weighing pan.

8



Adjustment completed.

8.3. Zeroing

1

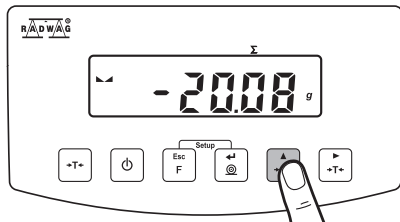

Make sure that the weighing pan is empty and press ▲+0=DELETE key.

2

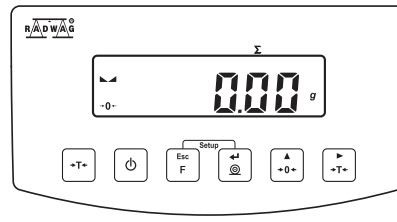

The balance has been zeroed.

8.4. Taring

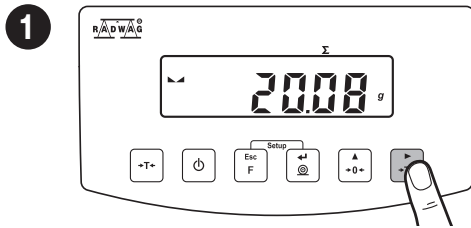

With loaded weighing pan: upon stabilisation of the weighing result, press **→T←** key.

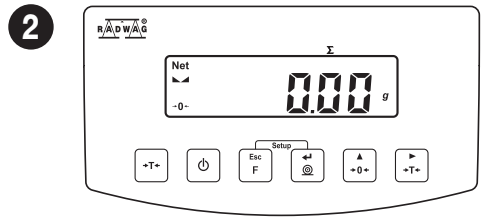

The balance has been tared.

8.5. Working modes accessibility

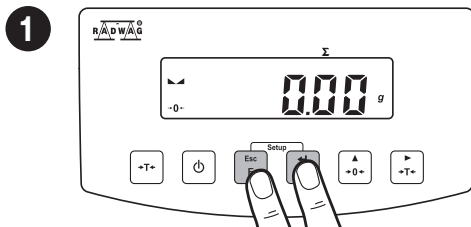

Simultaneously press **Esc F** + **↻** keys to enter home screen.

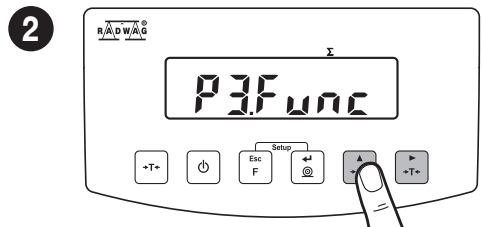

Using **→0←** key select "P3.Func" parameter and press **→T←** key.

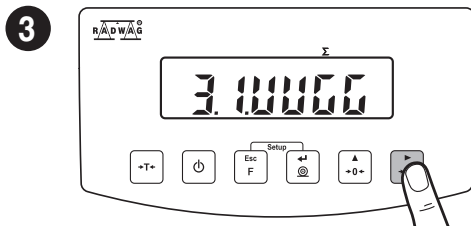

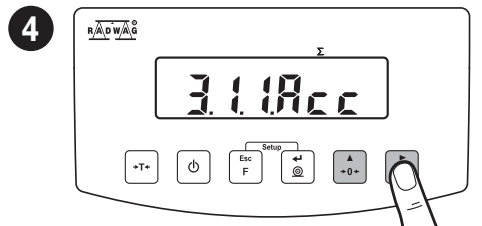

With "3.1.UUGG" parameter activated, press **→T←** key.

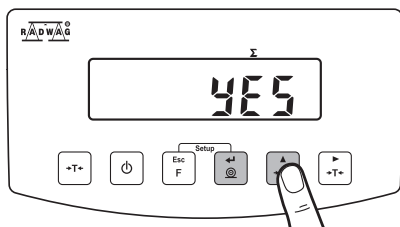

Press **→0←** key to select "3.1.1.Acc" parameter, next press **→T←** key.

5



Press  key to select “YES” value, next press  key in order to save settings.



To configure other working modes, follow the above procedure.

8.6. Selecting working mode



In order to be able to select working modes, it is necessary to make them available first (section 8.5).

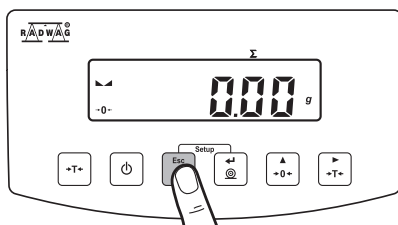

1

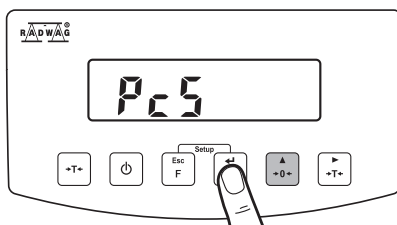

Using  key enter working modes menu.

2



Using  key select working mode and press .

The menu features the following working modes:

- Parts counting
- Percent weighing
- Checkweighing
- Animal weighing
- Totalising
- Peak hold
- Weighing



Detailed overview of the settings of the working modes is to be found in balance's main user manual.

8.7. Weighing unit selection

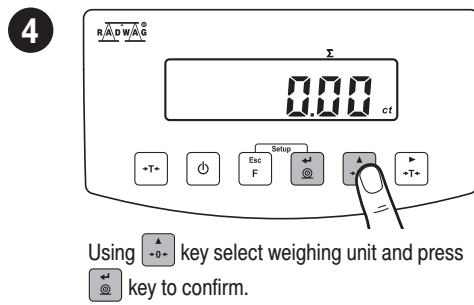
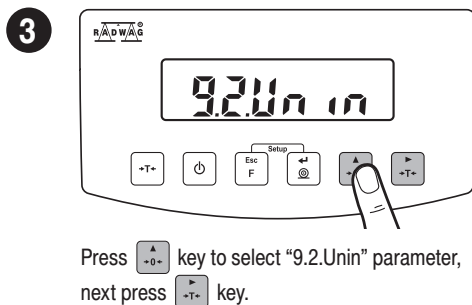
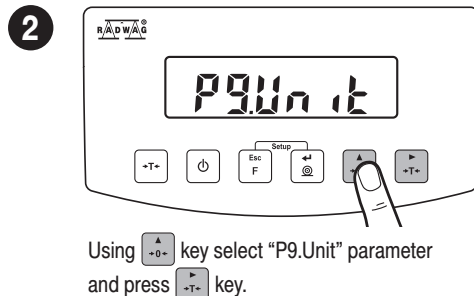
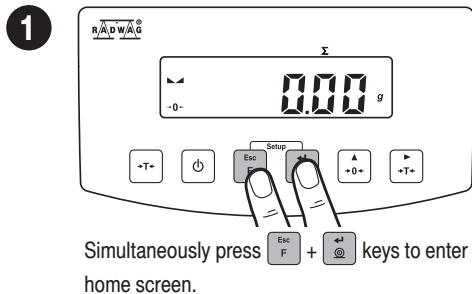

The balance enables selecting the following weighing units:

- g (gram)
- kg (kilogram)
- ct (carat)
- lb (pound)*

**(lb) pound unit unavailable for verified balances.*

9. PERIPHERAL DEVICES CONNECTORS

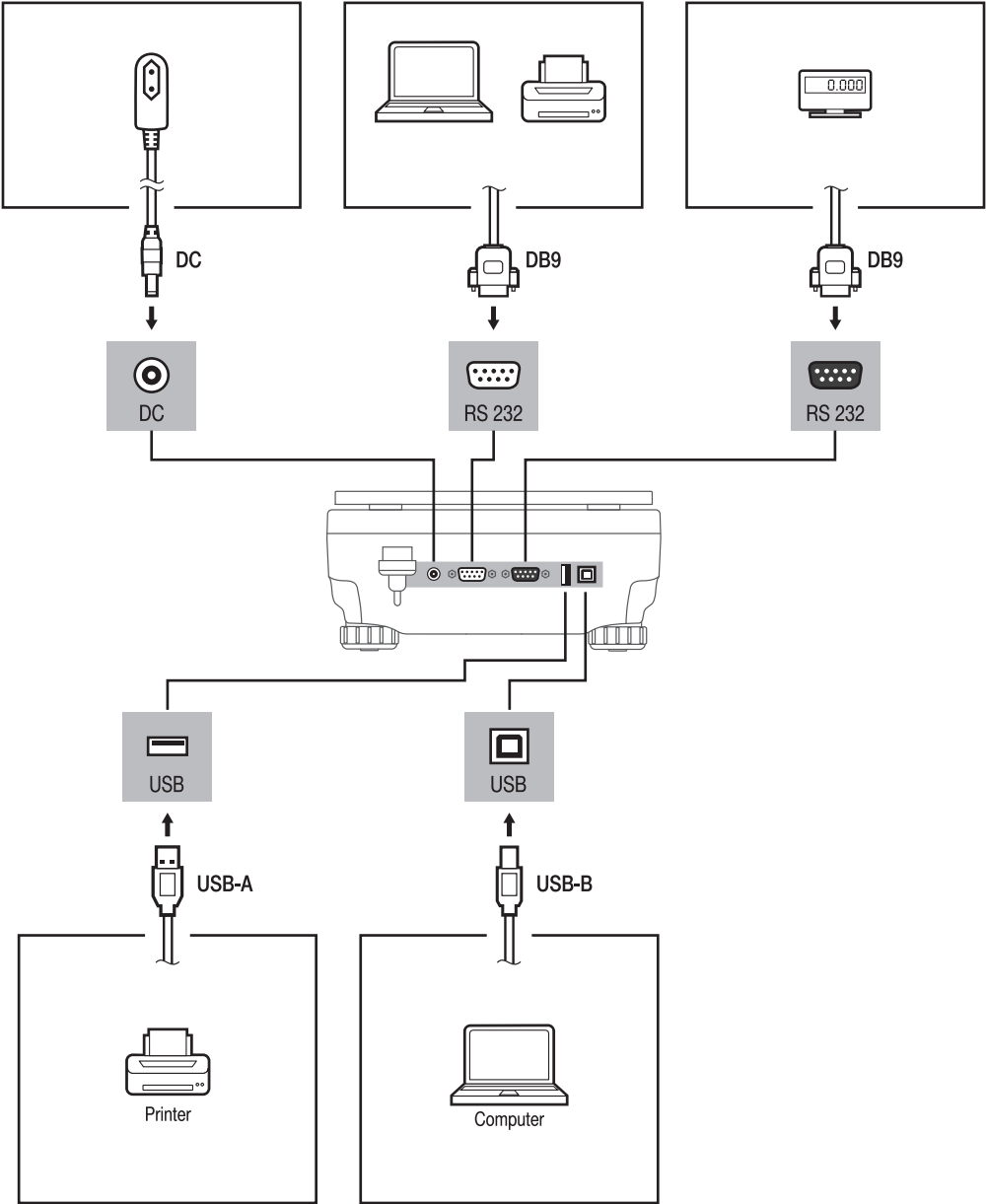

10. DEVICE CLEANING

10.1. General recommendations

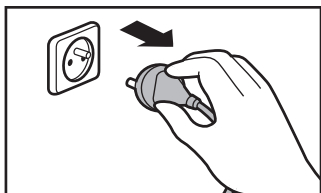

Prior to cleaning, it is necessary to disconnect the balance from the mains.



Do not use aggressive cleaning agents (e.g. solvents, chlorine preparations, corrosive chemicals, bleach).

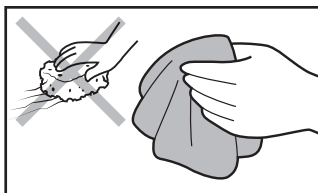

Use soft cloths made of microfiber, natural fiber or man-made fiber. Avoid using abrasive cloths or cloths that might scratch the surface.



Neither use substances of sharp structure nor intended for scrubbing.

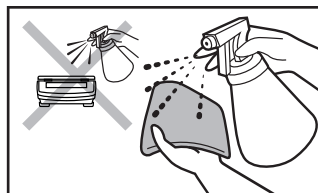

Apply the cleanser onto the cloth first. Avoid applying the cleanser directly onto the device.



Make sure that neither dust nor liquid gets inside the weighing system (device inside).

10.2. Cleaning instructions

- **GLASS PANES AND COMPONENTS** can be cleaned using window cleaner.
- **WEIGHING PANS AND STAINLESS STEEL OR ALUMINIUM COMPONENTS** can be cleaned using a cloth slightly soaked in a solution of water and gentle cleanser (e.g. soap or dishwashing liquid).
- **OPERATION PANEL AND HOUSING** can be cleaned using a cloth slightly soaked in a solution of water and gentle cleanser (e.g. soap or dishwashing liquid).
- Dry sample leftovers can be removed using either brush or handheld vacuum cleaner.
- Clean components can be dried using soft cloth or dust-free paper towel, with this the remaining moist will be absorbed.
- **Install all the components providing they are completely dry.**



RADWAG BALANCES AND SCALES
ADVANCED WEIGHING TECHNOLOGIES

www.radwag.com